

Wildcat Lake
305 acres
38' max. depth.

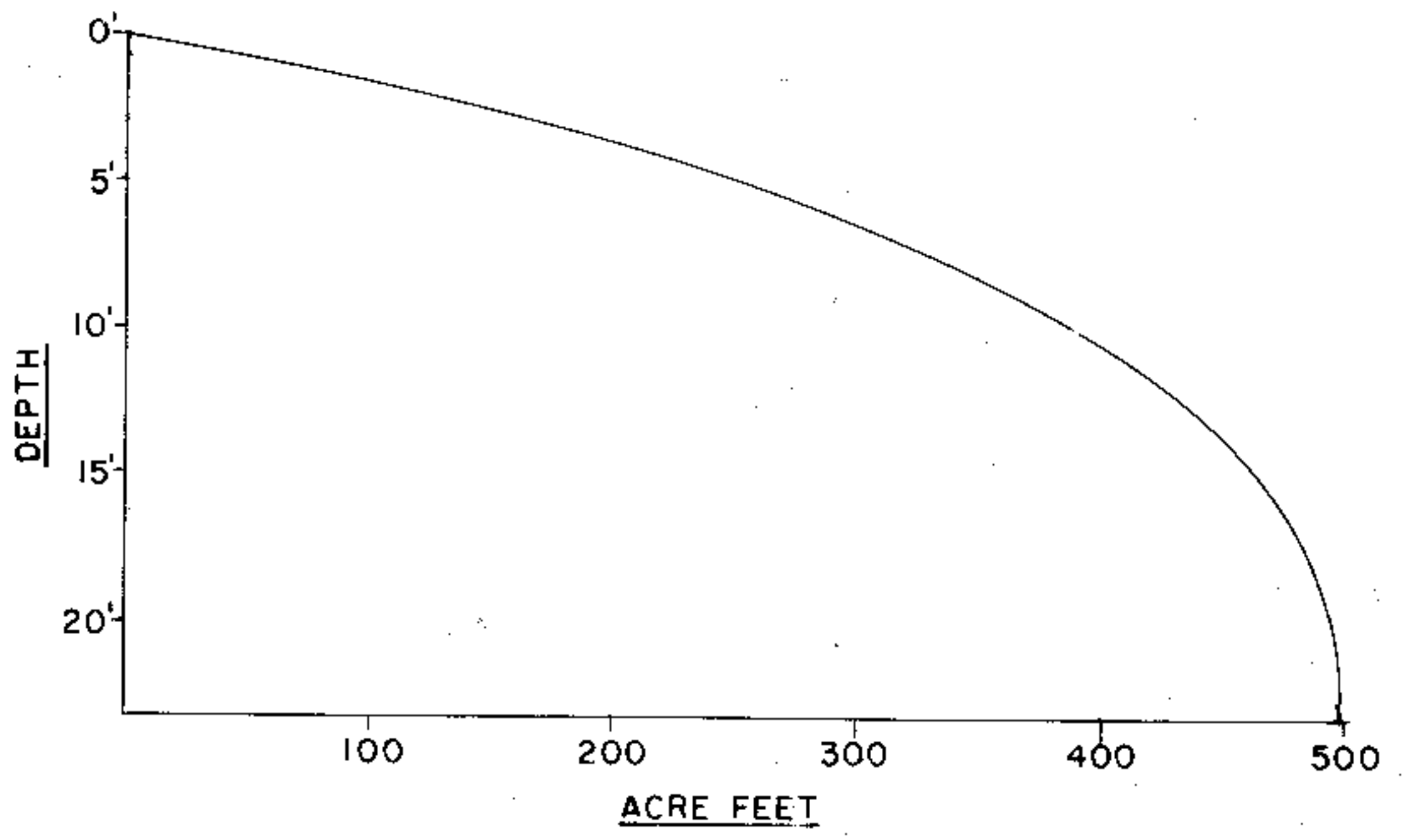

For bench mark info. see Wildcat Lake map.

Sec 33
Sec 34

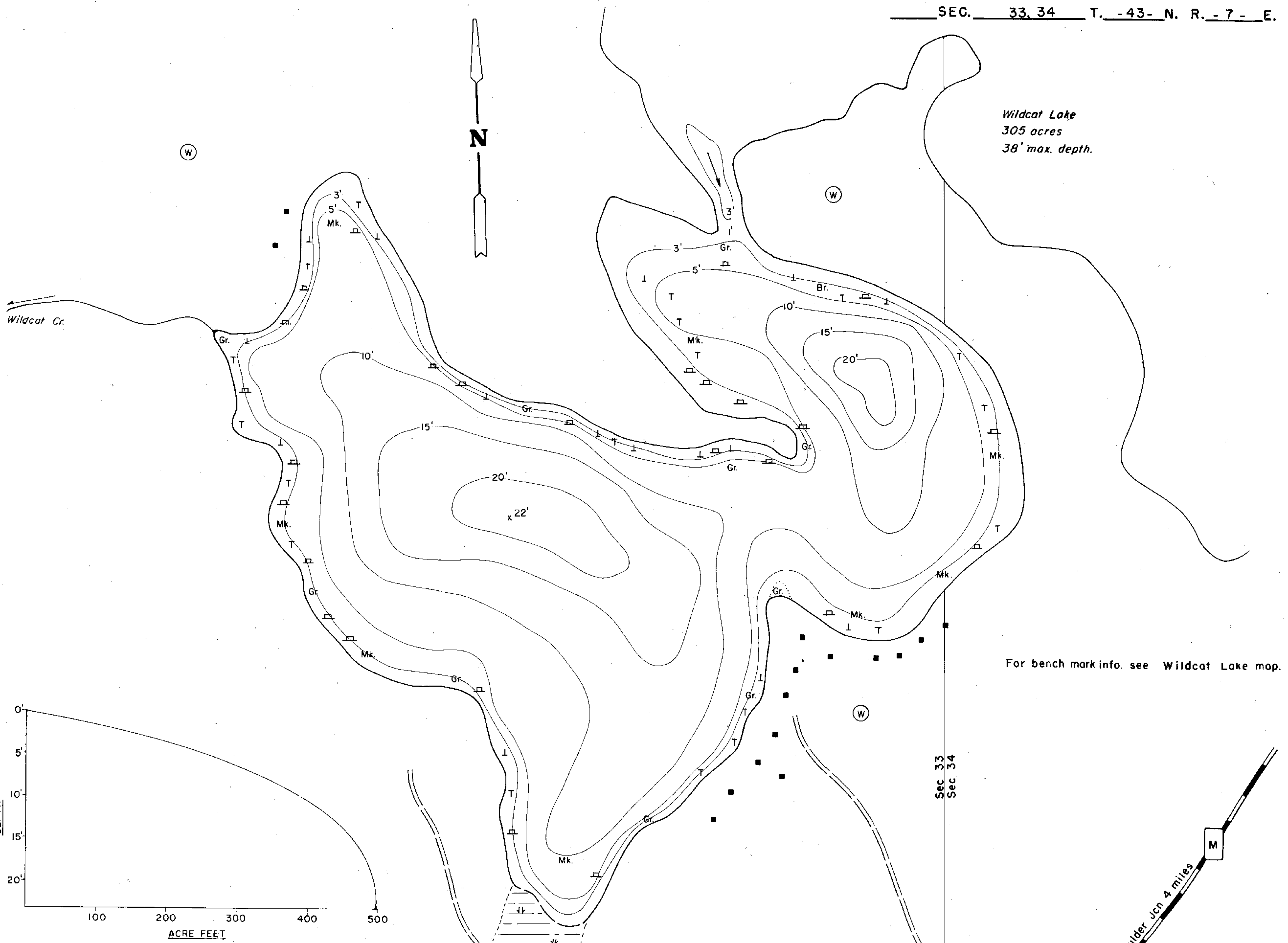
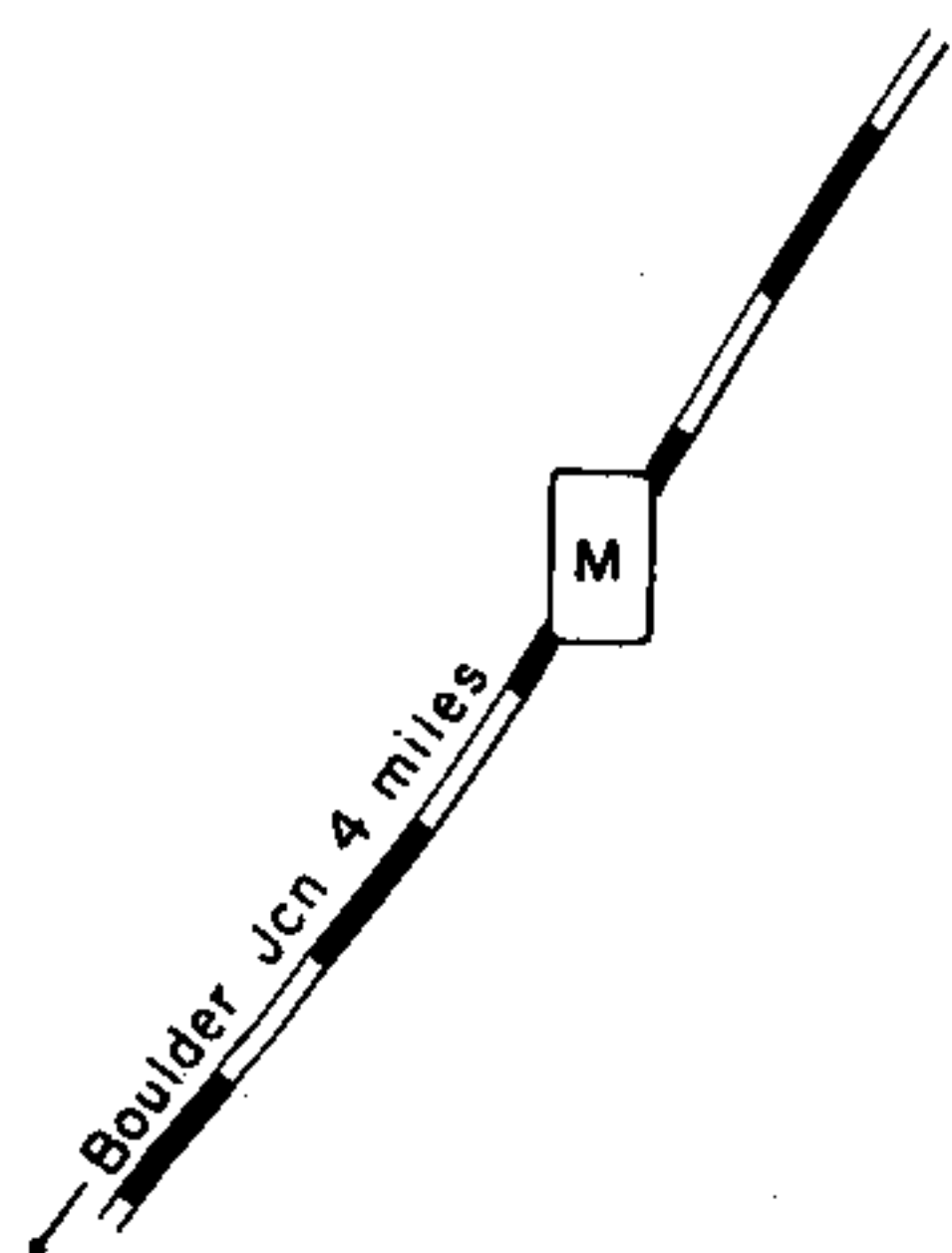

EQUIPMENT RECORDING SONAR MAPPED JULY 1969

- TOPOGRAPHIC SYMBOLS
- (B) Brush
 - (PW) Partially wooded
 - (W) Wooded
 - (C) Cleared
 - (P) Pastured
 - (A) Agricultural
 - B.M. Bench Mark
 - Dwelling
 - Resort
 - Camp
 - ||||| Steep slope
 - - - Indefinite shoreline
 - Marsh
 - Spring
 - Intermittent stream
 - Permanent inlet
 - Permanent outlet
 - Dam
 - D.N.R. State owned land

- LAKE BOTTOM SYMBOLS
- P. Peat
 - Mk. Muck
 - C. Clay
 - M. Marl
 - Sd. Sand
 - St. Silt
 - Gr. Gravel
 - R. Rubble
 - Br. Bedrock
 - B Boulders
 - Stumps & Snags
 - Rock danger to navigation
 - T Submergent vegetation
 - Emergent vegetation
 - Floating vegetation
 - Brush shelters



Access Access with Parking Boat Livery
 Drawn by: W. Snyders
 Field work by: J. Smith

SPECIES OF FISH	Abundance		
	Abundant	Common	Present
Muskie		X	
N. Pike			X
Walleye			X
L.M. Bass	X		
S.M. Bass	X		
Panfish	X		
Trout			

WATER AREA 54.6 ACRES
 UNDER 3 FT. 14 %
 OVER 20 FT. 4 %
 MAX. DEPTH 22 FEET.
 TOTAL ALK. 68 P.P.M.
 VOLUME 498.8 ACRE FT.
 SHORELINE 1.79 MILES

Source: Wisconsin Department of Natural Resources 608-266-2621
Big Kitten Lake - Vilas County, Wisconsin DNR Lake Map
Date – Jul 1969 - Historical Lake Map - Not for Navigation
A Public Document - Please Identify the Source when using it.