

LAKE SURVEY MAP

CRAWLING STONE LAKE VILAS COUNTY
SEC. 16, 17, 18, 19, 20, 21, 28 T. - 40 - N. R. - 5 - E.
Sheet 1 of 2 sheets

LONG INTERLAKEN LAKE
368 ACRES
MAXIMUM DEPTH 65'

2 Miles to Lac du Flambeau

Department of Natural Resources Bench Mark 1176-A is a bronze tablet set in top of concrete post 29' southeast of centerline of County Trunk Highway "D", between Big Crawling Stone and Long Interlaken lakes. Elevation 100.00' Water elevation 91.40'

Section 18
Section 19

Section 16
Section 21

LITTLE CRAWLING STONE LAKE
116 ACRES
MAXIMUM DEPTH 48'

EQUIPMENT RECORDING SONAR MAPPED APRIL 1968
TOPOGRAPHIC SYMBOLS MONTH YEAR
LAKE BOTTOM SYMBOLS

- (B) Brush
- (PW) Partially wooded
- (W) Wooded
- (C) Cleared
- (P) Pastured
- (A) Agricultural
- B.M. Bench Mark
- Dwelling
- Resort
- Camp
- Steep slope
- Indefinite shoreline
- Marsh
- Spring
- Intermittent stream
- Permanent inlet
- Permanent outlet
- Dam
- D.N.R. State owned land

- P. Peat
- Mk. Muck
- C. Clay
- M. Marl
- Sd. Sand
- Sl. Silt
- Gr. Gravel
- R. Rubble
- Br. Bedrock
- B Boulders
- Stumps & Snags
- Rock danger to navigation
- Submergent vegetation
- Emergent vegetation
- Floating vegetation
- Brush shelters



Access Access with Parking Boat Livery
Drawn by: J. Roth
Field work by: P. Michelson

SPECIES OF FISH	Abundant Common Present		
	Abundant	Common	Present
Muskie			X
N. Pike			X
Walleye	X		X
L.M. Bass			X
S.M. Bass	X		
Panfish	X		
Trout			
Cisco	X		

WATER AREA 1466 ACRES
UNDER 3 FT. 10 %
OVER 20 FT. 61 %
MAX. DEPTH 87 FEET.
TOTAL ALK. 34 P.P.M.
VOLUME 45694 ACRE FT.
SHORELINE 9.5 MILES
9.1 Miles of shoreline excluding island

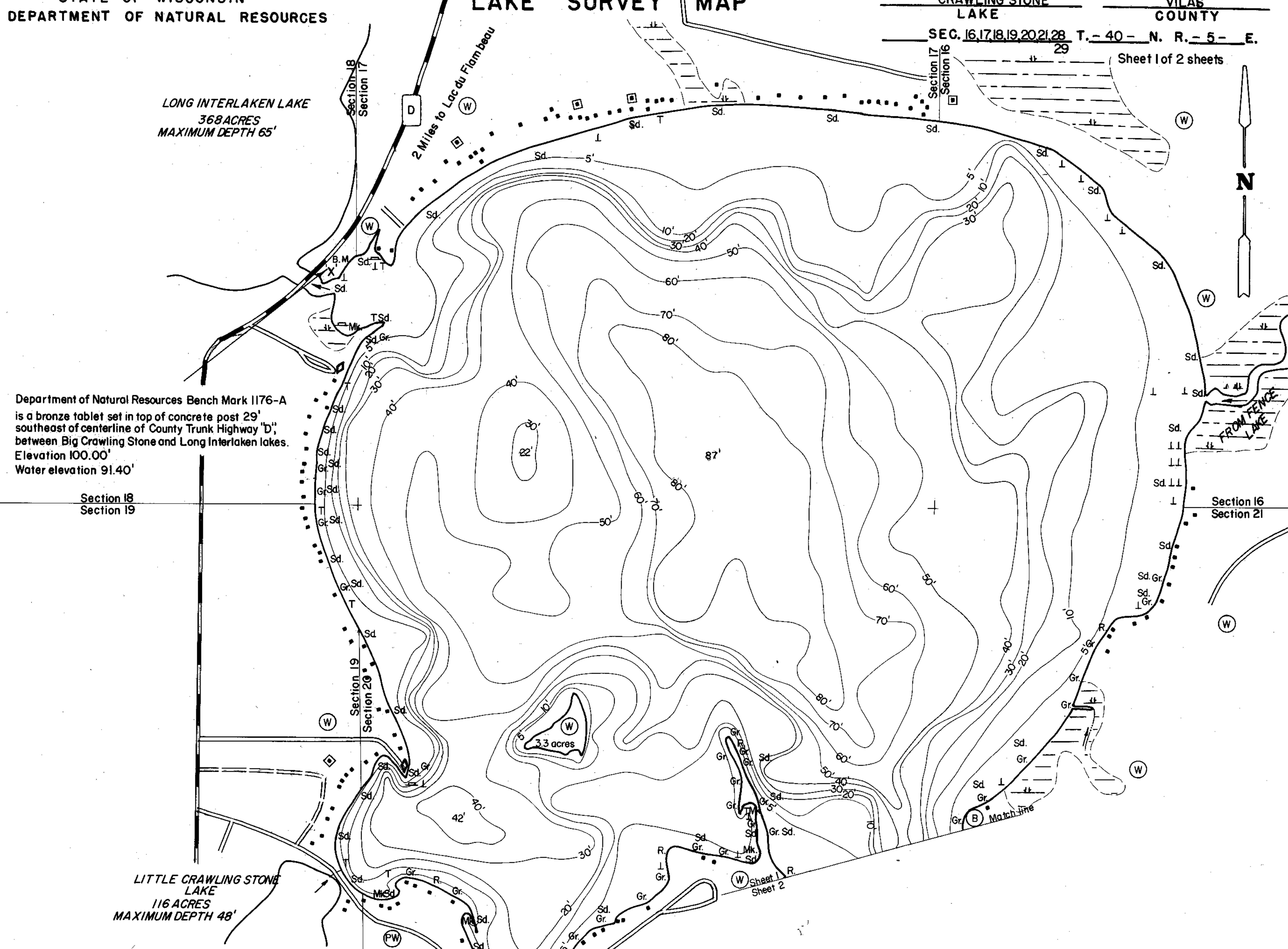

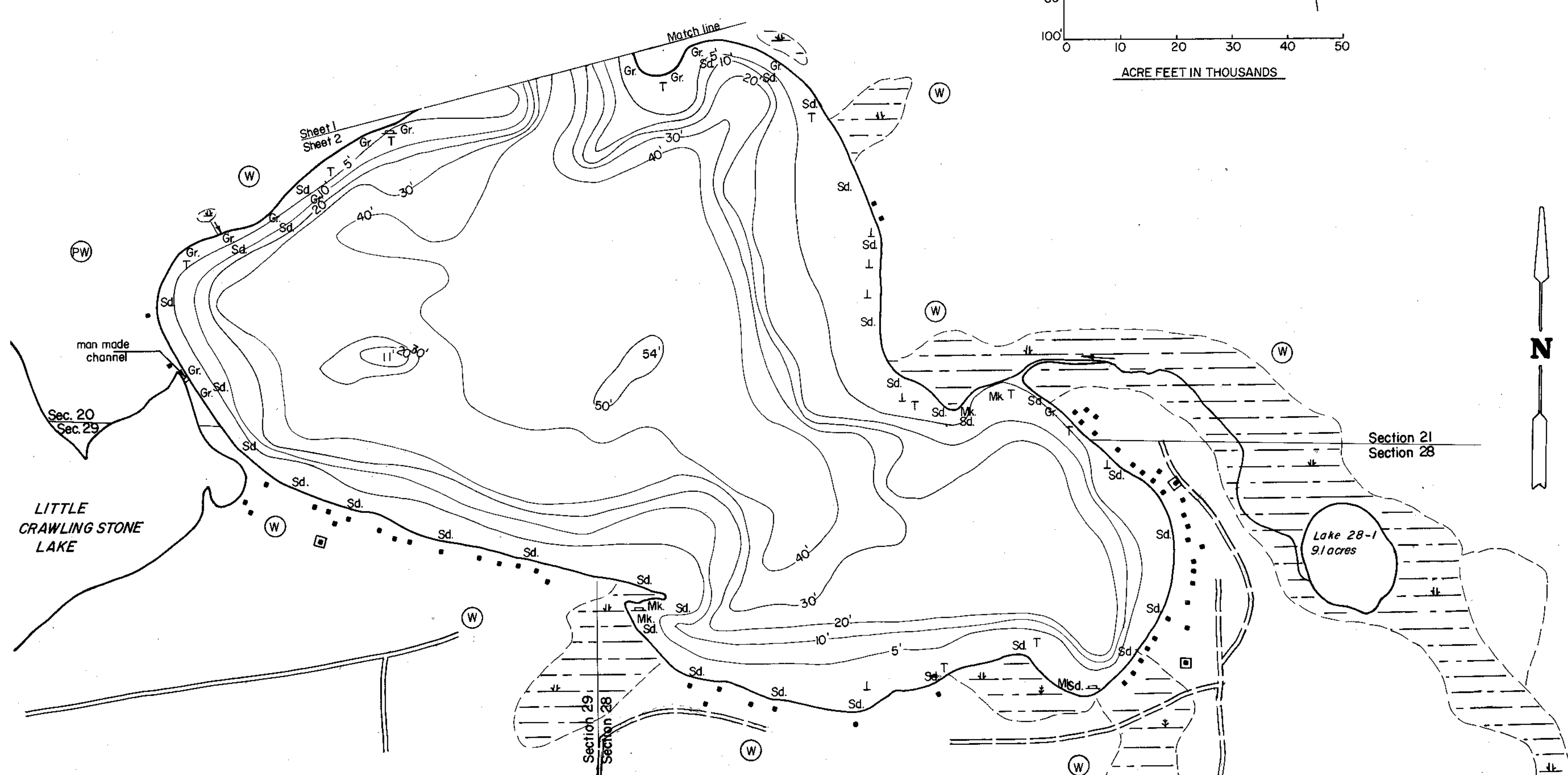
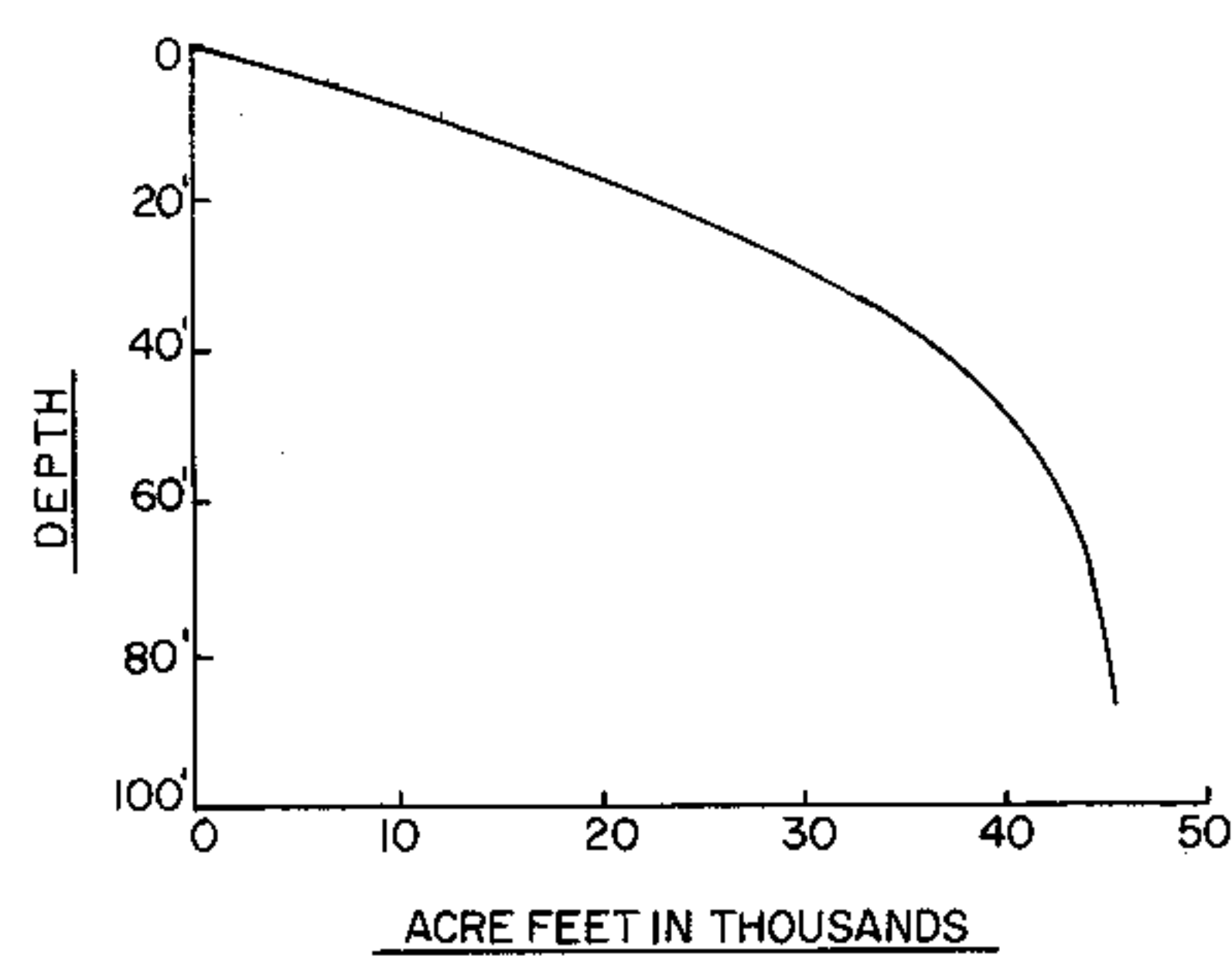

EQUIPMENT RECORDING SONAR MAPPED APRIL 1968

TOPOGRAPHIC SYMBOLS		LAKE BOTTOM SYMBOLS	
(B) Brush	Steep slope	P. Peat	B Boulders
(PW) Partially wooded	----- Indefinite shoreline	Mk. Muck	o Stumps & Snags
(W) Wooded	----- Marsh	C. Clay	o Rock danger to navigation
(C) Cleared	o Spring	M. Marl	T Submergent vegetation
(P) Pastured	----- Intermittent stream	Sd. Sand	⊥ Emergent vegetation
(A) Agricultural	----- Permanent inlet	St. Silt	⊥ Floating vegetation
B.M. Bench Mark	----- Permanent outlet	Gr. Gravel	⊥ Brush shelters
■ Dwelling	⊥ Dam	R. Rubble	
□ Resort	----- D.N.R. State owned land	Br. Bedrock	
□ Camp			



◆ Access ◀ Access with Parking ▶ Boat Livery
 Drawn by: J. Rath
 Field work by: P. Michelson

SPECIES OF FISH	Abundance		
	Abundant	Common	Present
Muskie			X
N. Pike			X
Walleye	X		
L.M. Bass			X
S.M. Bass	X		
Panfish	X		
Trout			
Cisco			X

WATER AREA 1466 ACRES
 UNDER 3 FT. 10 %
 OVER 20 FT. 61 %
 MAX. DEPTH 87 FEET.
 TOTAL ALK. 34 P.P.M.
 VOLUME 45,694 ACRE FT.
 SHORELINE 9.5 MILES
 9.1 Miles of shoreline excluding island

Source: Wisconsin Department of Natural Resources 608-266-2621
Crawling Stone Lake - Vilas County, Wisconsin DNR Lake Map
Date – Apr 1968 - Historical Lake Map - Not for Navigation
A Public Document - Please Identify the Source when using it.