

# LAKE SURVEY MAP

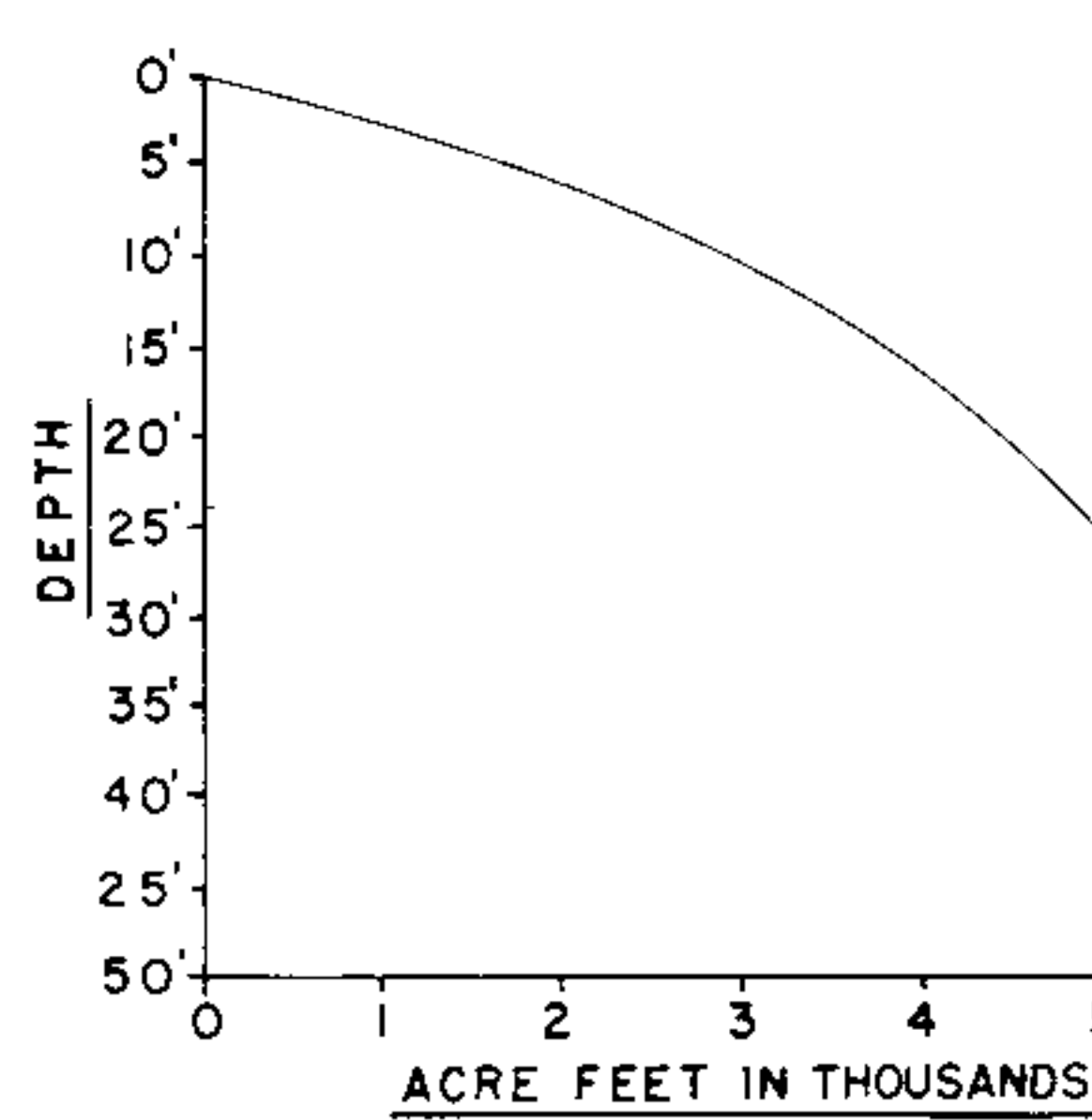
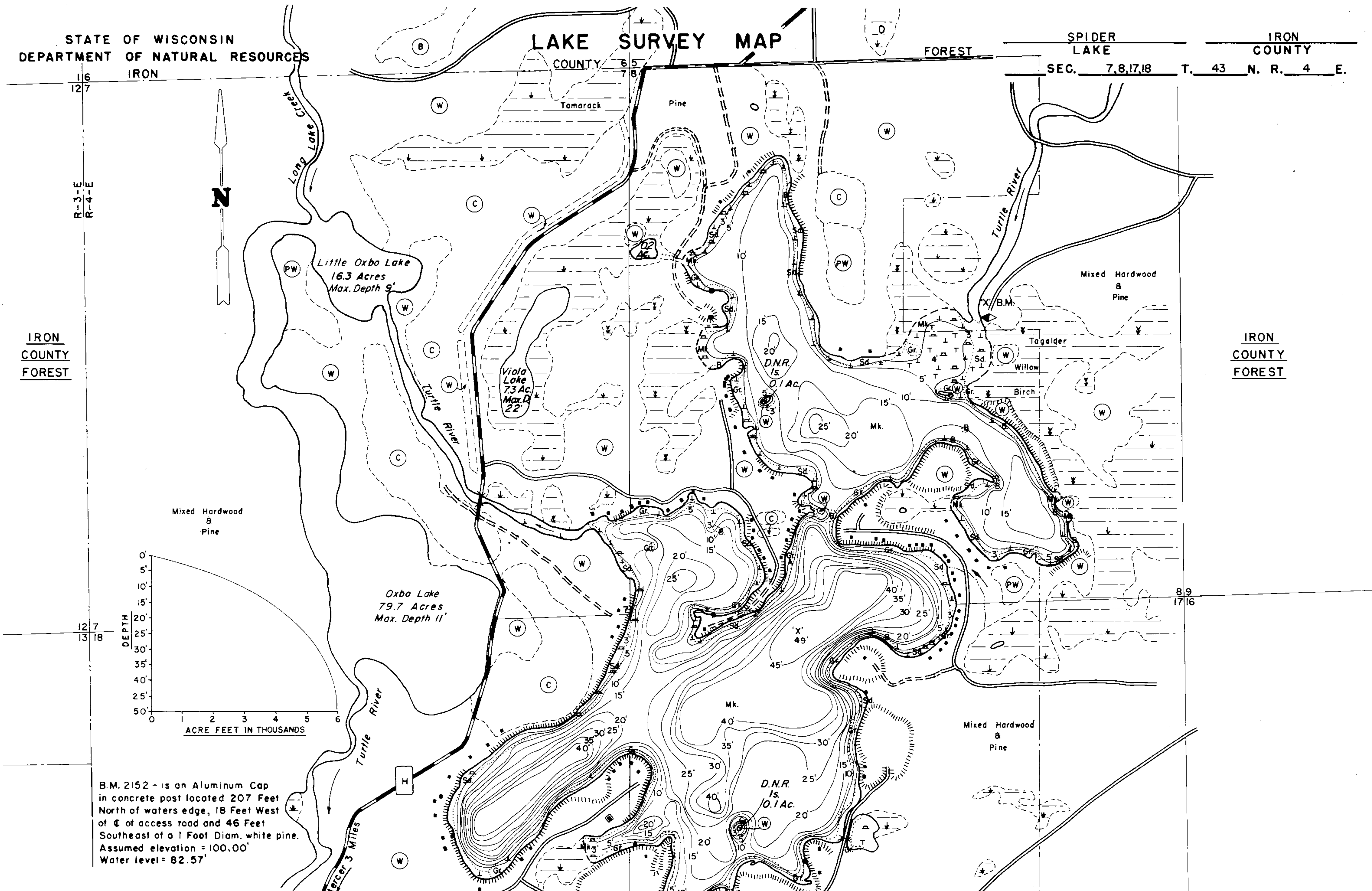

B.M. 2152 - is an Aluminum Cap in concrete post located 207 Feet North of waters edge, 18 Feet West of C of access road and 46 Feet Southeast of a 1 Foot Diam. white pine. Assumed elevation = 100.00' Water level = 82.57'

EQUIPMENT RECORDING SONAR MAPPED SEPT 1974

- | TOPOGRAPHIC SYMBOLS   |                               | LAKE BOTTOM SYMBOLS |                             |
|-----------------------|-------------------------------|---------------------|-----------------------------|
| (B) Brush             | Steep slope                   | P. Peat             | B Boulders                  |
| (PW) Partially wooded | ----- Indefinite shoreline    | Mk. Muck            | ☼ Stumps & Snags            |
| (W) Wooded            | ----- Marsh                   | C. Clay             | ⚡ Rock danger to navigation |
| (C) Cleared           | ----- Spring                  | M. Marl             | T Submergent vegetation     |
| (P) Pastured          | ----- Intermittent stream     | Sd. Sand            | ⊥ Emergent vegetation       |
| (A) Agricultural      | ----- Permanent inlet         | St. Silt            | ⊥ Floating vegetation       |
| B.M. Bench Mark       | ----- Permanent outlet        | Gr. Gravel          | ⊥ Brush shelters            |
| ■ Dwelling            | ----- Dam                     | R. Rubble           |                             |
| □ Resort              | ----- D.N.R. State owned land | Br. Bedrock         |                             |
| □ Camp                |                               |                     |                             |

SPECIES OF FISH	Abundance		
	Abundant	Common	Present
Muskie			X
N. Pike			X
Walleye	X		X
L. M. Bass			X
S. M. Bass			X
Panfish			X
Trout			X
Burbot			X

WATER AREA 351.65 ACRES  
 UNDER 3 FT. 12 %  
 OVER 20 FT. 33 %  
 MAX. DEPTH 49' FEET.  
 TOTAL ALK. 35 P.P.M.  
 VOLUME 5984.14 ACRE FT.  
 MAIN SHORELINE 7.1 MI.  
 ISLAND SHORELINE 0.22 MI.

0.2 Acres Max. Depth 10'  
 SCALE 0' 600' 1200' 1800' 2400'  
 Access Access with Parking Boat Livery  
 Drawn by: G. Thuesen  
 Field work by: C. Busch, K. Cable, L. Sather

Source: Wisconsin Department of Natural Resources 608-266-2621  
Spider Lake - Iron County, Wisconsin DNR Lake Map  
Date: Sep 1974 - Historical Lake Map - Not for Navigation  
A Public Document - Please Identify the Source when using it.