

B.M. 'X' IS a chise mark on the upstream lip of east culvert located at the outlet on the S.W. end of lake near public landing Assumed Elev. 100.00' Water Elev. 95.41'

EQUIPMENT RECORDING SONAR MAPPED OCTOBER 1973

- | TOPOGRAPHIC SYMBOLS | | LAKE BOTTOM SYMBOLS | |
|-----------------------|----------------------------|---------------------|-----------------------------|
| (B) Brush | Steep slope | P. Peat | B Boulders |
| (PW) Partially wooded | - - - Indefinite shoreline | Mk. Muck | o Stumps & Snags |
| (W) Wooded | Marsh | C. Clay | o Rock danger to navigation |
| (C) Cleared | o Spring | M. Marl | T Submergent vegetation |
| (P) Pastured | - - - Intermittent stream | Sd. Sand | ↓ Emergent vegetation |
| (A) Agricultural | ==== Permanent inlet | St. Silt | ↑ Floating vegetation |
| B.M. Bench Mark | ==== Permanent outlet | Gr. Gravel | ⊕ Brush shelters |
| ■ Dwelling | ⊕ Dam | R. Rubble | |
| □ Resort | □ D.N.R. State owned land | Br. Bedrock | |
| □ Camp | | | |



Access Access with Parking Boat Livery
 Drawn by: E. Eaton
 Field work by: C. Busch, K. Cable, L. Sather

SPECIES OF FISH	Abundant Common Present		
	Abundant	Common	Present
Muskie			X
N. Pike			X
Walleye	X		
L.M. Bass			X
S.M. Bass			X
Panfish	X		
Trout			

WATER AREA 396.4 ACRES
 UNDER 3 FT. 11 %
 OVER 20 FT. 15 %
 MAX. DEPTH 34 FEET.
 TOTAL ALK. 42 P.P.M.
 VOLUME 4,914.2 ACRE FT.
 MAIN SHORELINE 11.59 MI.
 ISLAND SHORELINE .95 MI.

LAKE SURVEY MAP

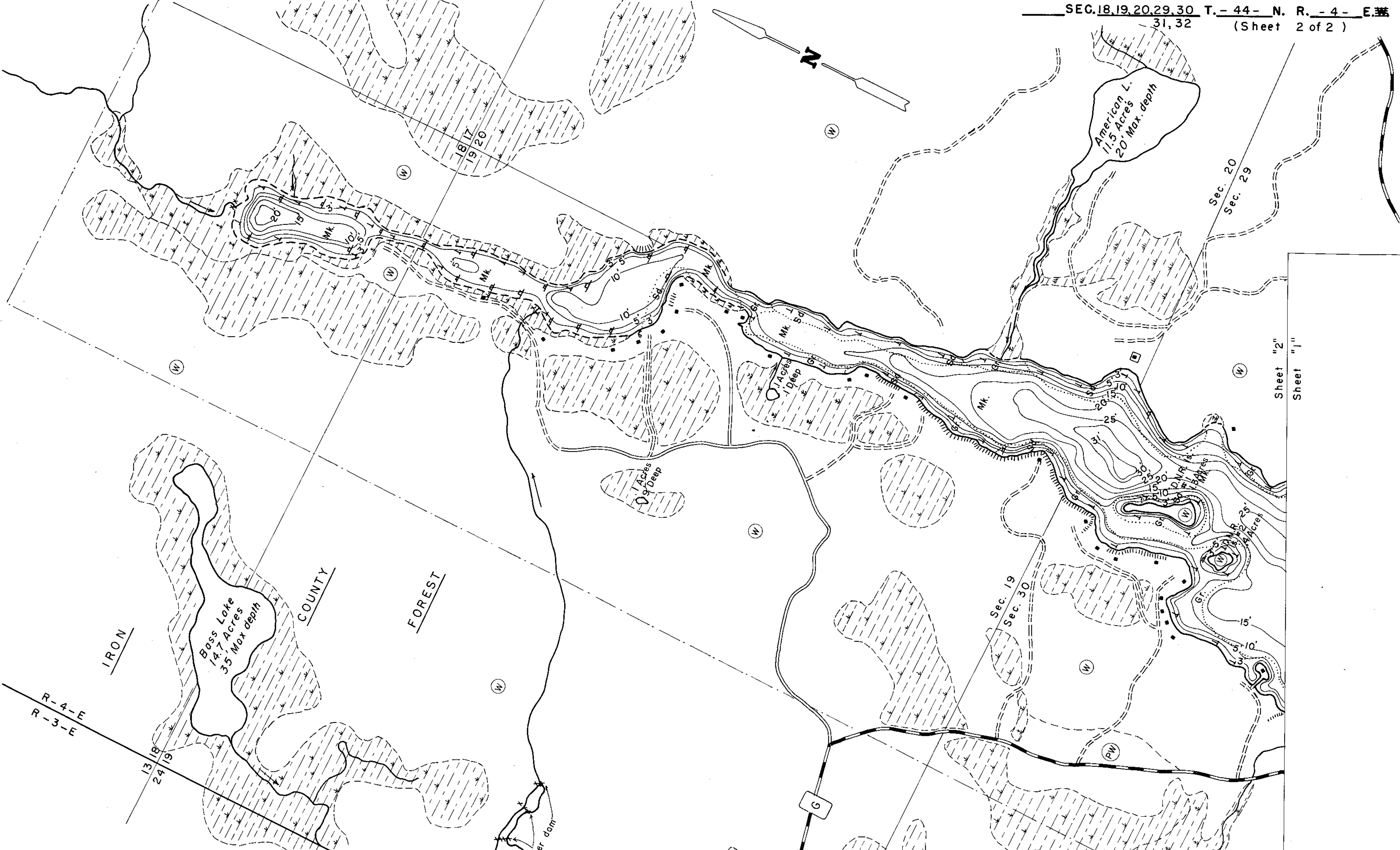

EQUIPMENT RECORDING SONAR MAPPED OCTOBER 1973
MONTH YEAR

- | TOPOGRAPHIC SYMBOLS | | LAKE BOTTOM SYMBOLS | |
|-----------------------|----------------------------|---------------------|-----------------------------|
| (B) Brush | Steep slope | P. Peat | B Boulders |
| (PW) Partially wooded | - - - Indefinite shoreline | Mk. Muck | % Stumps & Snags |
| (W) Wooded | Marsh | C. Clay | ⊙ Rock danger to navigation |
| (C) Cleared | o Spring | M. Marl | T Submergent vegetation |
| (P) Pastured | --- Intermittent stream | Sd. Sand | ⊥ Emergent vegetation |
| (A) Agricultural | ==== Permanent inlet | St. Silt | ⊥ Floating vegetation |
| B.M. Bench Mark | ==== Permanent outlet | Gr. Gravel | ⊕ Brush shelters |
| ■ Dwelling | ⊥ Dam | R. Rubble | |
| □ Resort | D.N.R. State owned land | Br. Bedrock | |
| □ Camp | | | |



SCALE
 ◆ Access ◀ Access with Parking ◆ Boat Livery

Drawn by: E. Eaton
 Field work by: C. Busch, K. Cable, L. Sather

SPECIES OF FISH	Abundance		
	Abundant	Common	Present
Muskie			X
N. Pike			X
Walleye	X		
L.M. Bass			X
S.M. Bass			X
Panfish	X		
Trout			

WATER AREA 396.4 ACRES
 UNDER 3 FT. 11 %
 OVER 20 FT. 15 %
 MAX. DEPTH 34 FEET.
 TOTAL ALK. 42 P.P.M.
 VOLUME 4,914.2 ACRE FT.
 MAIN SHORELINE 11.59 MI.
 ISLAND SHORELINE .95 MI.

Sheet "2"
Sheet "1"

Source: Wisconsin Department of Natural Resources 608-266-2621
Long Lake - Iron County, Wisconsin DNR Lake Map
Date: Oct 1973 - Historical Lake Map - Not for Navigation
A Public Document - Please Identify the Source when using it.