

P.S.C. 1185-A
B.M. 'X' Square cut in S.W. corner of concrete step of fourth cottage W. of boat landing on Birches Resort. 260' W. of the landing, 43' N.E. of triple trunked Maple, 51' N.E. of fire place.
Assumed elevation 100.00'
Water level 91.30' Taken July 1967

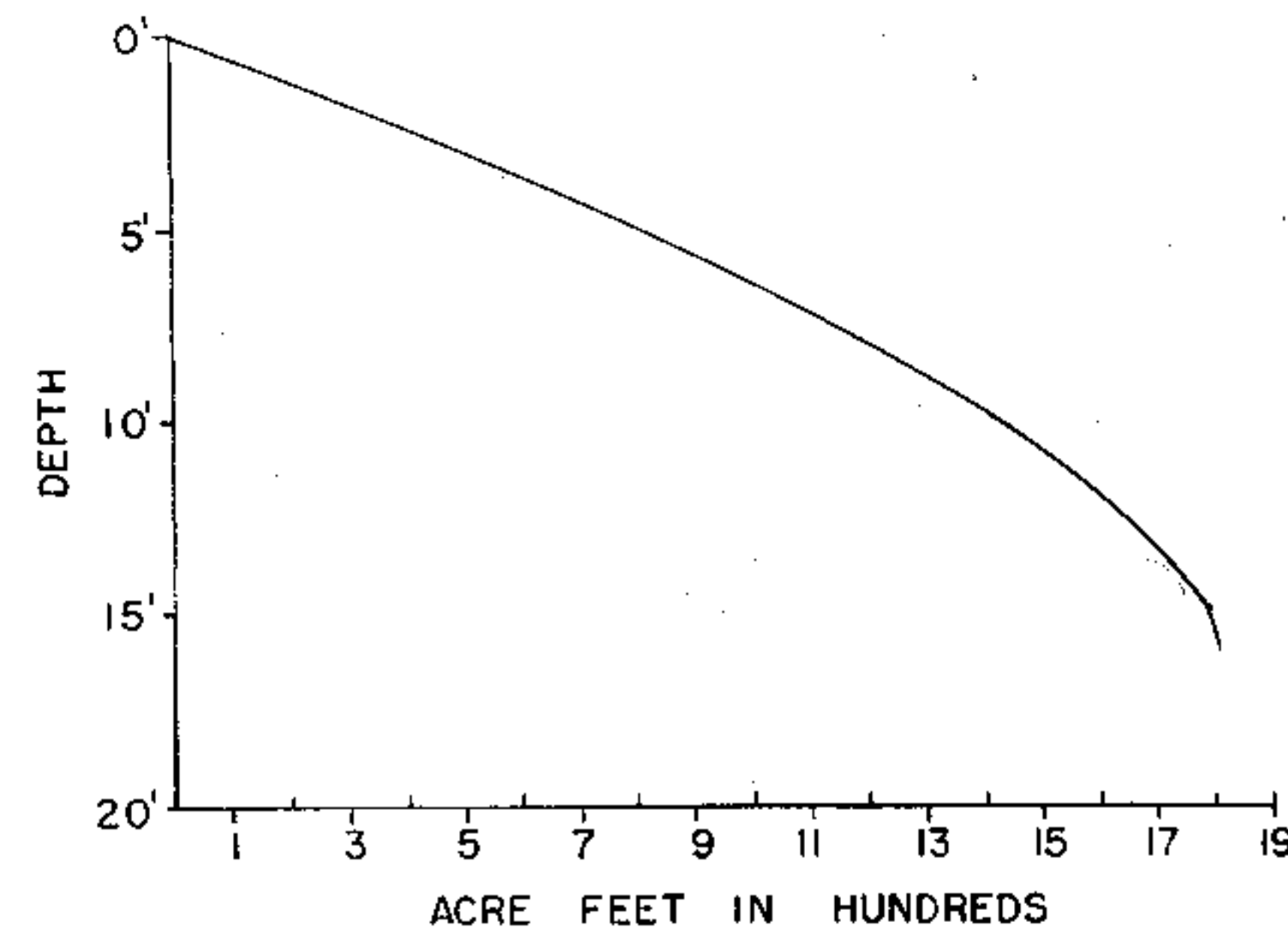

7 8
18 17

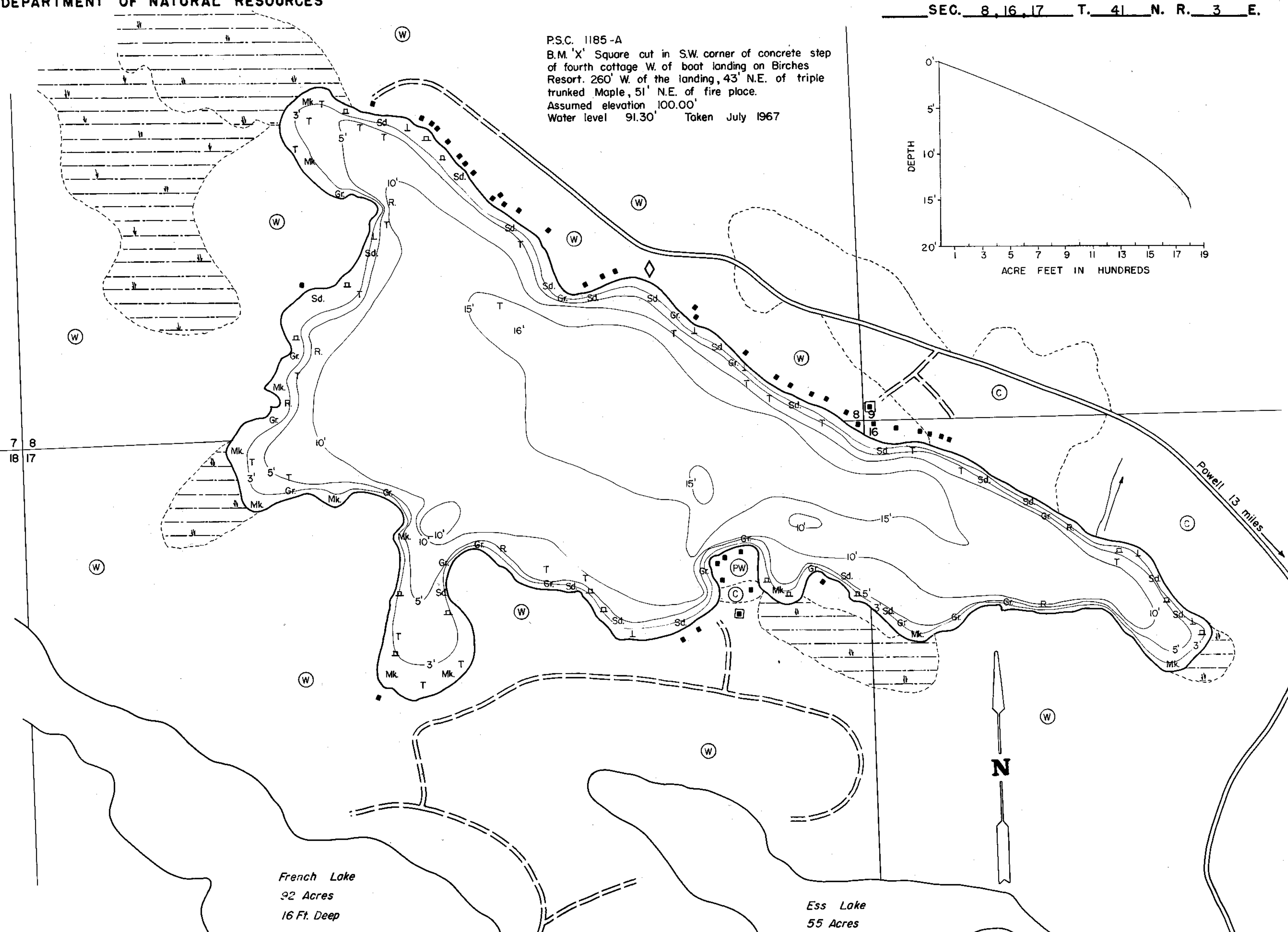

Powell 13 miles



EQUIPMENT RECORDING SONAR MAPPED MARCH 1968
MONTH YEAR
LAKE BOTTOM

- | TOPOGRAPHIC SYMBOLS | | LAKE BOTTOM SYMBOLS | |
|-----------------------|-------------------------------|---------------------|-----------------------------|
| (B) Brush | Steep slope | P. Peat | B Boulders |
| (PW) Partially wooded | ----- Indefinite shoreline | Mk. Muck | o Stumps & Snags |
| (W) Wooded | ----- Marsh | C. Clay | o Rock danger to navigation |
| (C) Cleared | ----- Spring | M. Marl | T Submergent vegetation |
| (P) Pastured | ----- Intermittent stream | Sd. Sand | l Emergent vegetation |
| (A) Agricultural | ----- Permanent inlet | Sl. Silt | h Floating vegetation |
| B.M. Bench Mark | ----- Permanent outlet | Gr. Gravel | u Brush shelters |
| ■ Dwelling | ----- Dam | R. Rubble | |
| ■ Resort | ----- D.N.R. State owned land | Bc. Bedrock | |
| □ Camp | | | |



SCALE
◆ Access ◆ Access with Parking ◆ Boat Livery

Drawn by: C. Holt
Field work by: J. Smith, P. Michelson

SPECIES OF FISH	ABUNDANCE	
	Abundant	Common
Muskie	X	X
N. Pike	X	X
Walleye	X	X
L. M. Bass	X	X
S. M. Bass	X	X
Panfish	X	X
Trout		

WATER AREA 179.5 ACRES
UNDER 3 FT. 12.5 %
OVER 20 FT. 0 %
MAX. DEPTH 16 FEET.
TOTAL ALK. 43 P.P.M.
VOLUME 1808.1 ACRE FT.
SHORELINE 3.52 MILES

Source: Wisconsin Department of Natural Resources 608-266-2621
Boot Lake- Iron County, Wisconsin DNR Lake Map
Date: Mar 1968 - Historical Lake Map - Not for Navigation
A Public Document - Please Identify the Source when using it.