

LAKE SURVEY MAP

SCHNUR LAKE PRICE COUNTY
SEC. 4, 5, 8 T. 40 N. R. 1 W.

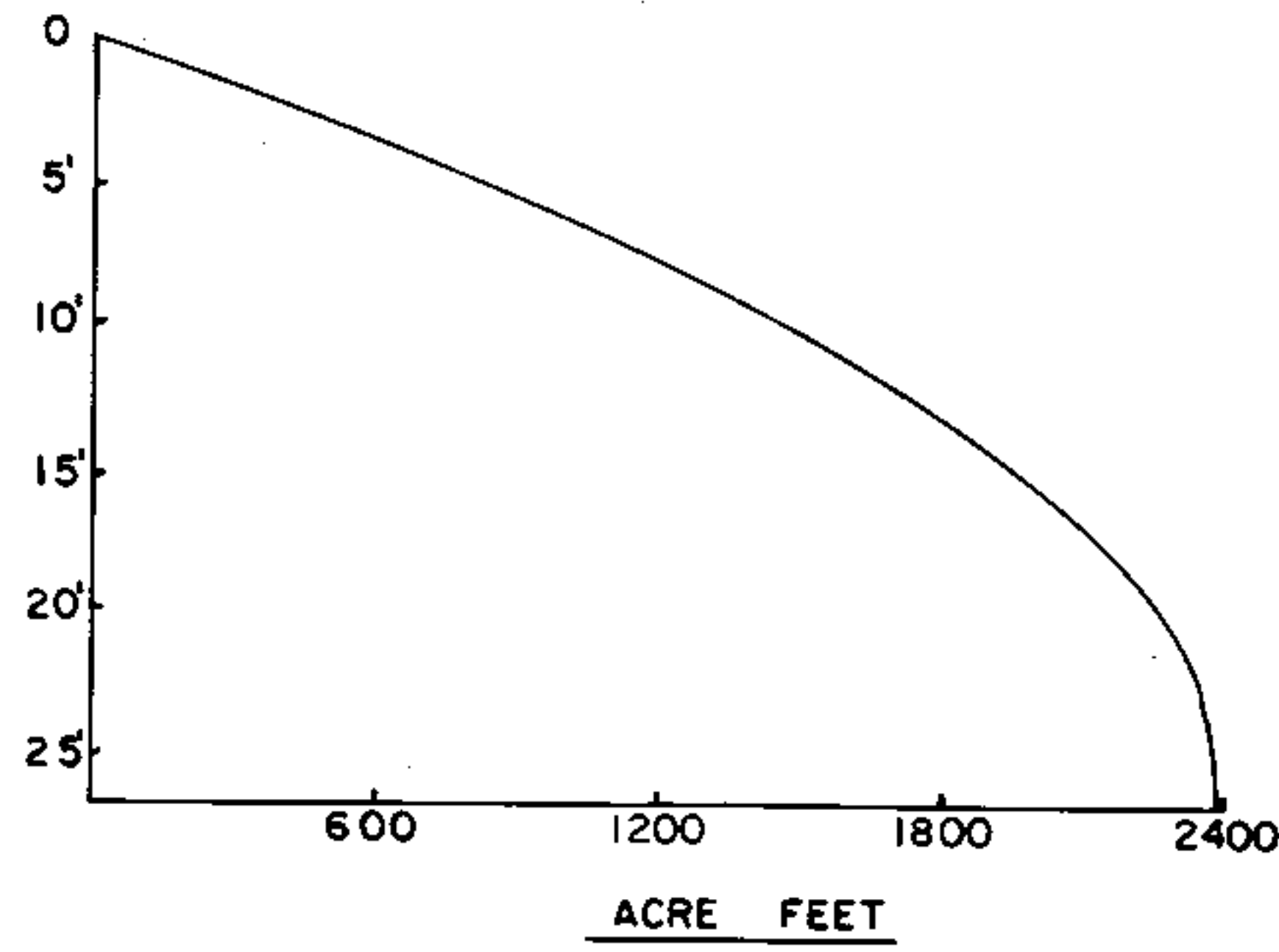

Butternut Lake
1,006 acres
32' max. depth

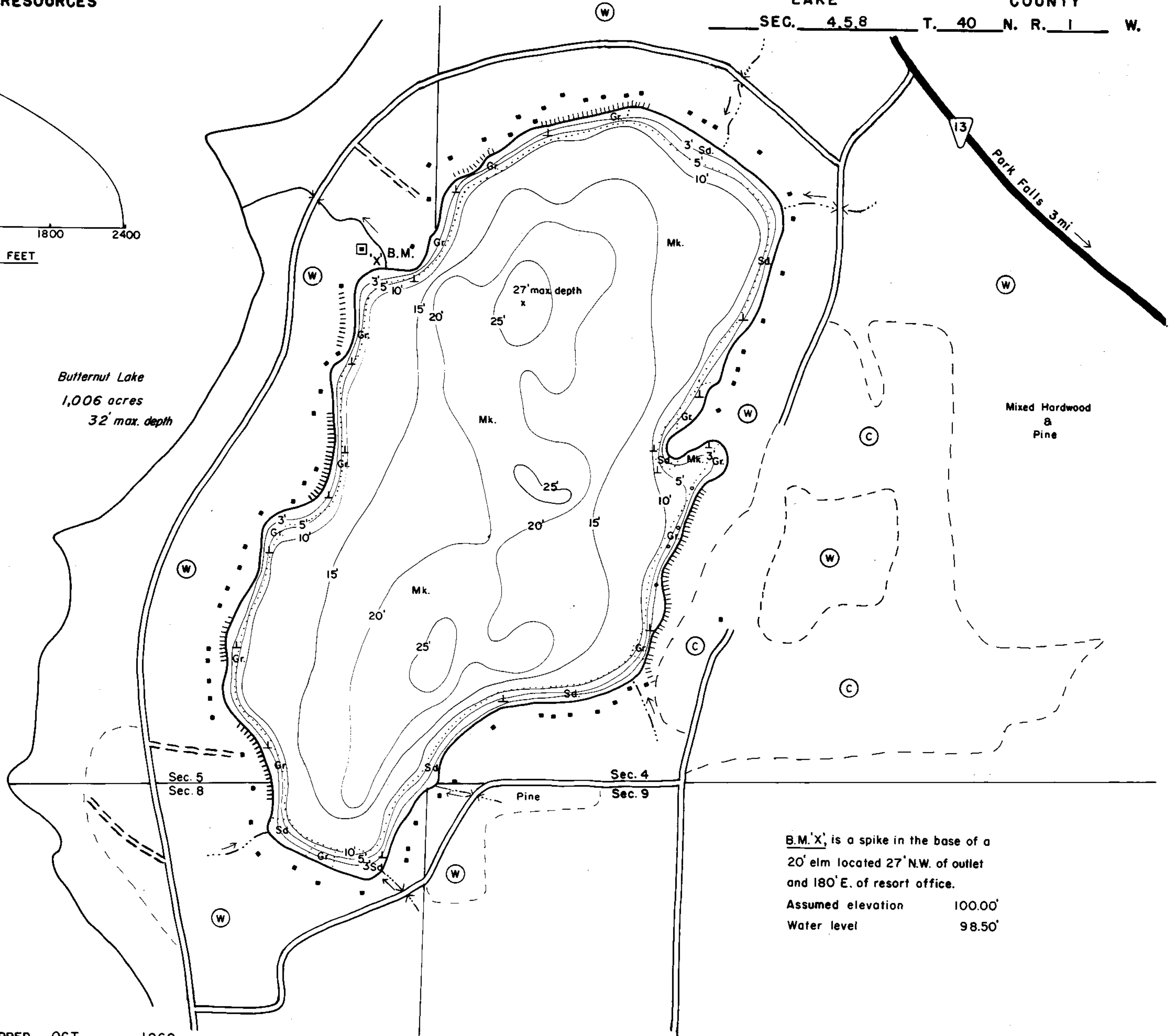

Mixed Hardwood & Pine

B.M. 'X' is a spike in the base of a 20' elm located 27' N.W. of outlet and 180' E. of resort office.
Assumed elevation 100.00'
Water level 98.50'

EQUIPMENT RECORDING SONAR MAPPED OCT 1969
MONTH YEAR

- | TOPOGRAPHIC SYMBOLS | | LAKE BOTTOM SYMBOLS | |
|-----------------------|---------------------------|---------------------|-----------------------------|
| (B) Brush | Steep slope | P. Peat | B Boulders |
| (PW) Partially wooded | ~ Indefinite shoreline | Mk. Muck | ⚓ Stumps & Snags |
| (W) Wooded | ~ Marsh | C. Clay | ⚠ Rock danger to navigation |
| (C) Cleared | ~ Spring | M. Marl | T Submergent vegetation |
| (P) Pastured | ~ Intermittent stream | Sd. Sand | ⌋ Emergent vegetation |
| (A) Agricultural | ~ Permanent inlet | Sl. Silt | ⌋ Floating vegetation |
| B.M. Bench Mark | ~ Permanent outlet | Gr. Gravel | ⌋ Brush shelters |
| ■ Dwelling | ~ Dam | R. Rubble | |
| ■ Resort | ~ D.N.R. State owned land | Bc. Bedrock | |
| ■ Camp | | | |



Access Access with Parking Boat Livery
Drawn by: T. Ginder
Field work by: C. Busch, G. Lund, & S. Johannes

SPECIES OF FISH	Abundance		
	Abundant	Common	Present
Muskie			X
N. Pike			X
Walleye	X		
L. M. Bass			X
S. M. Bass			X
Panfish	X		
Trout			
Sturgeon			X

WATER AREA 158 ACRES
UNDER 3 FT. 5 %
OVER 20 FT. 23 %
MAX. DEPTH 27 FEET.
TOTAL ALK. 38 P.P.M.
VOLUME 2383.9 ACRE FT.
SHORELINE 2.22 MILES

Source: Wisconsin Department of Natural Resources 608-266-2621
Schnur Lake – Price County, Wisconsin DNR Lake Map
Date – Oct 1969 - Historical Lake Map - Not for Navigation
A Public Document - Please Identify the Source when using it.