

LAKE SURVEY MAP

ROUND LAKE PRICE COUNTY
SEC. 26, 25, 23, 24, 14 T. 40 N. R. 3 E.

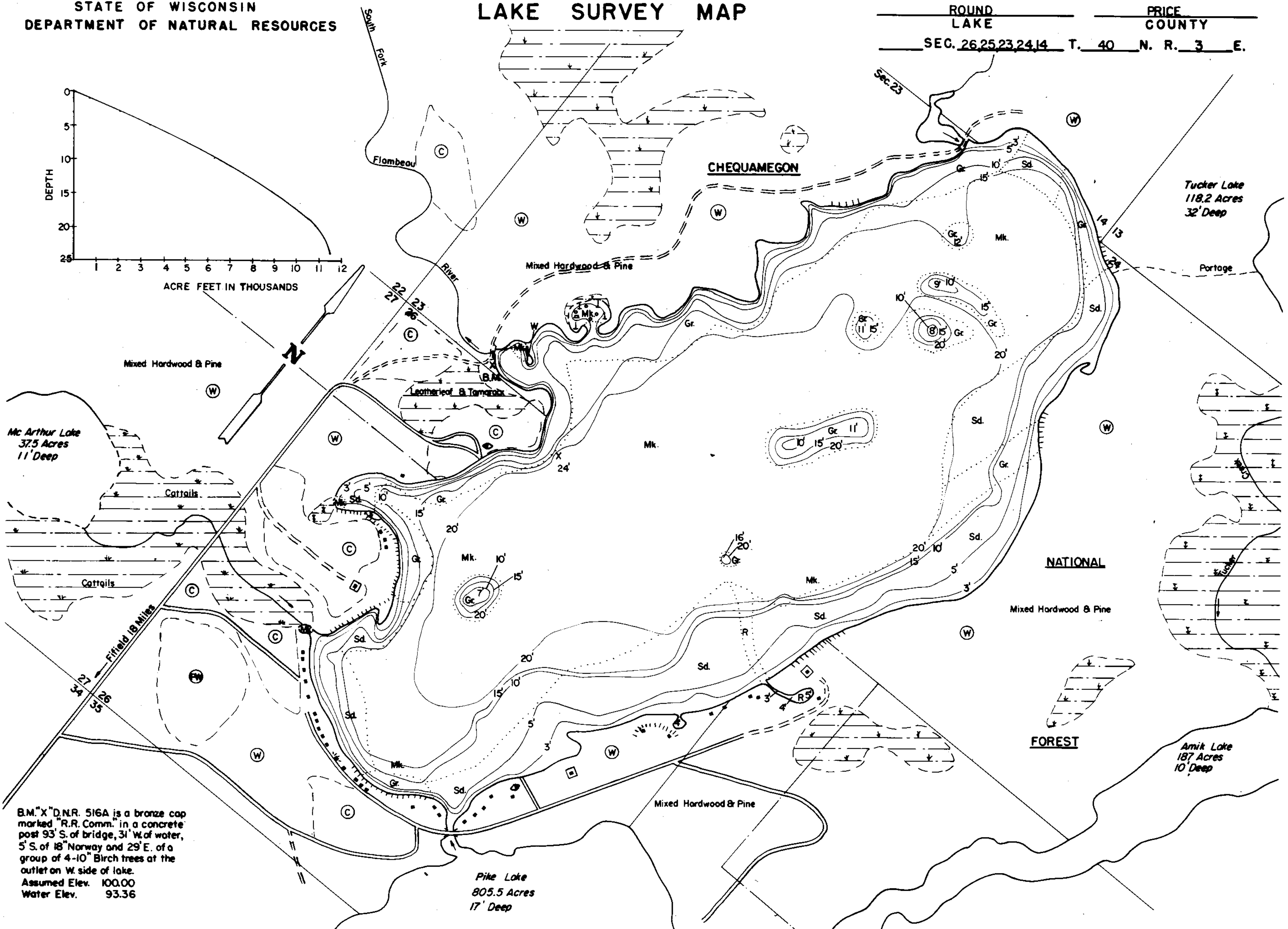
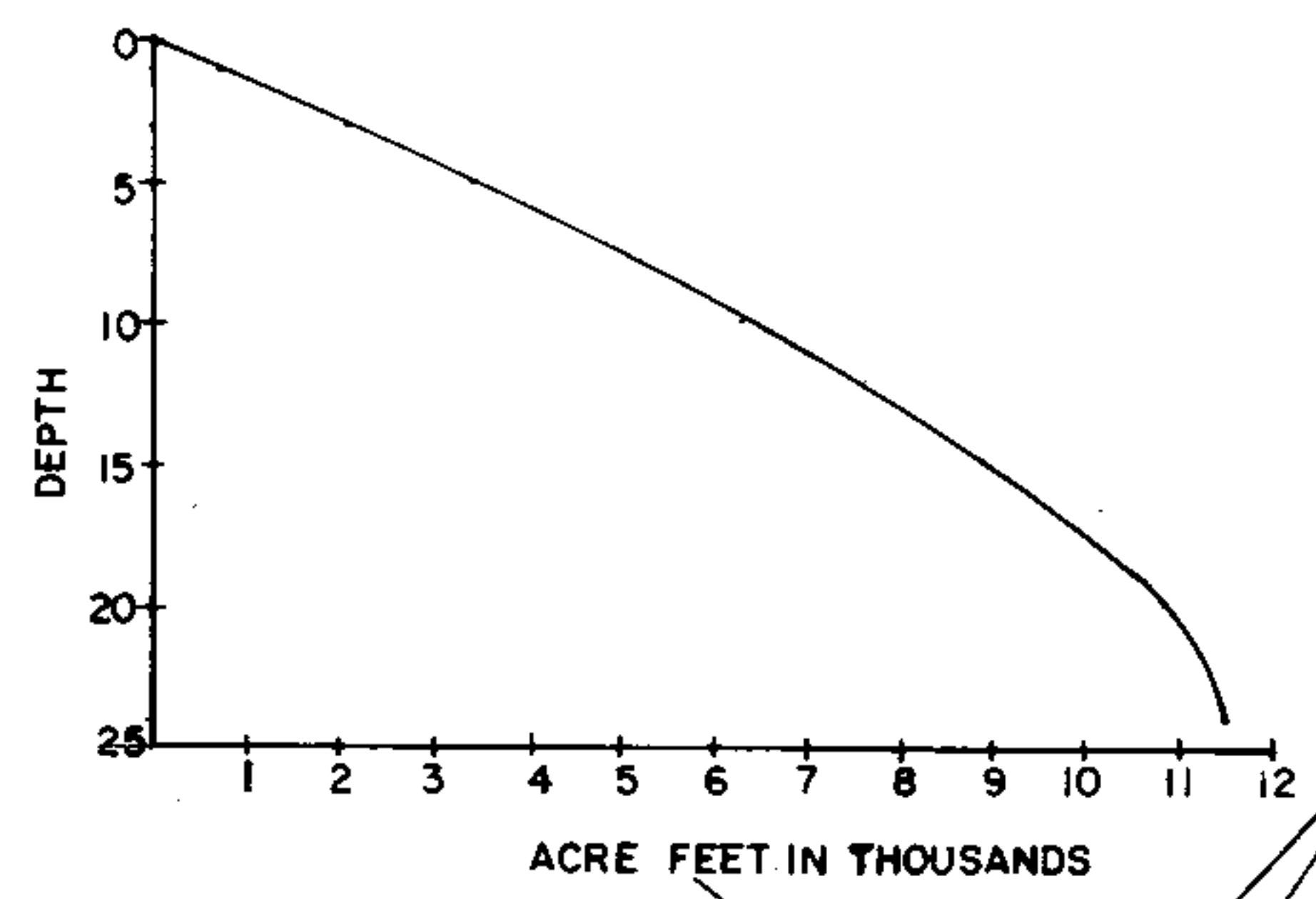

B.M. "X" D.N.R. 516A is a bronze cap marked "R.R. Comm." in a concrete post 93' S. of bridge, 31' W. of water, 5' S. of 18" Norway and 29' E. of a group of 4-10" Birch trees at the outlet on W. side of lake.
Assumed Elev. 100.00
Water Elev. 93.36

EQUIPMENT RECORDING SONAR MAPPED SEPTEMBER 1972
MONTH YEAR

- | TOPOGRAPHIC SYMBOLS | | LAKE BOTTOM SYMBOLS | |
|----------------------|---------------------------|---------------------|-----------------------------|
| (B) Brush | Steep slope | P. Peat | B Boulders |
| (W) Partially wooded | ~ Indefinite shoreline | Mk. Muck | ☼ Stumps & Snags |
| (W) Wooded | ~ Marsh | C. Clay | ☼ Rock danger to navigation |
| (C) Cleared | ~ Spring | M. Marl | T Submergent vegetation |
| (P) Pastured | ~ Intermittent stream | Sd. Sand | ⊥ Floating vegetation |
| (A) Agricultural | ~ Permanent inlet | St. Silt | ~ Floating vegetation |
| B.M. Bench Mark | ~ Permanent outlet | Gr. Gravel | ~ Brush shelters |
| □ Dwelling | ~ Dam | R. Rubble | |
| ■ Resort | ~ D.N.R. State owned land | Bc. Bedrock | |
| ■ Camp | | | |

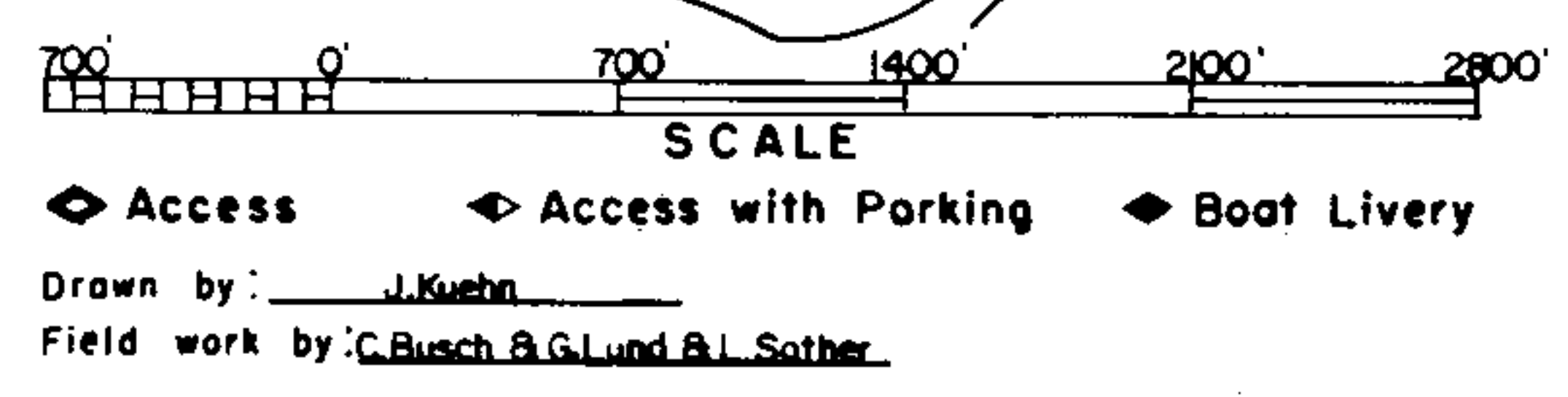

SPECIES OF FISH	Abundance		
	Abundant	Common	Present
Muskie		X	
N. Pike		X	
Walleye	X		
L. M. Bass			X
S. M. Bass			X
Panfish	X		
Trout			
L. Shroener			X

WATER AREA 725.6 ACRES
UNDER 3 FT. 6 %
OVER 20 FT. 43 %
MAX. DEPTH 24 FEET.
TOTAL ALK. 21 P.P.M.
VOLUME 11528.2 ACRE FT.
SHORELINE 5.08 MILES

Source: Wisconsin Department of Natural Resources 608-266-2621
Round Lake – Price County, Wisconsin DNR Lake Map
Date – Sep 1972 - Historical Lake Map - Not for Navigation
A Public Document - Please Identify the Source when using it.