

LAKE SURVEY MAP

LAKE PICKERAL FORM F-117
 SECTION 1
 TOWNSHIP 31 N
 RANGE 8 W
 TOWN OF CLEVELAND BIRCHCREEK
 COUNTY CHIPPEWA

WISCONSIN CONSERVATION DEPARTMENT
 BIOLOGY DIVISION
 LAKE AND STREAM IMPROVEMENT SECTION

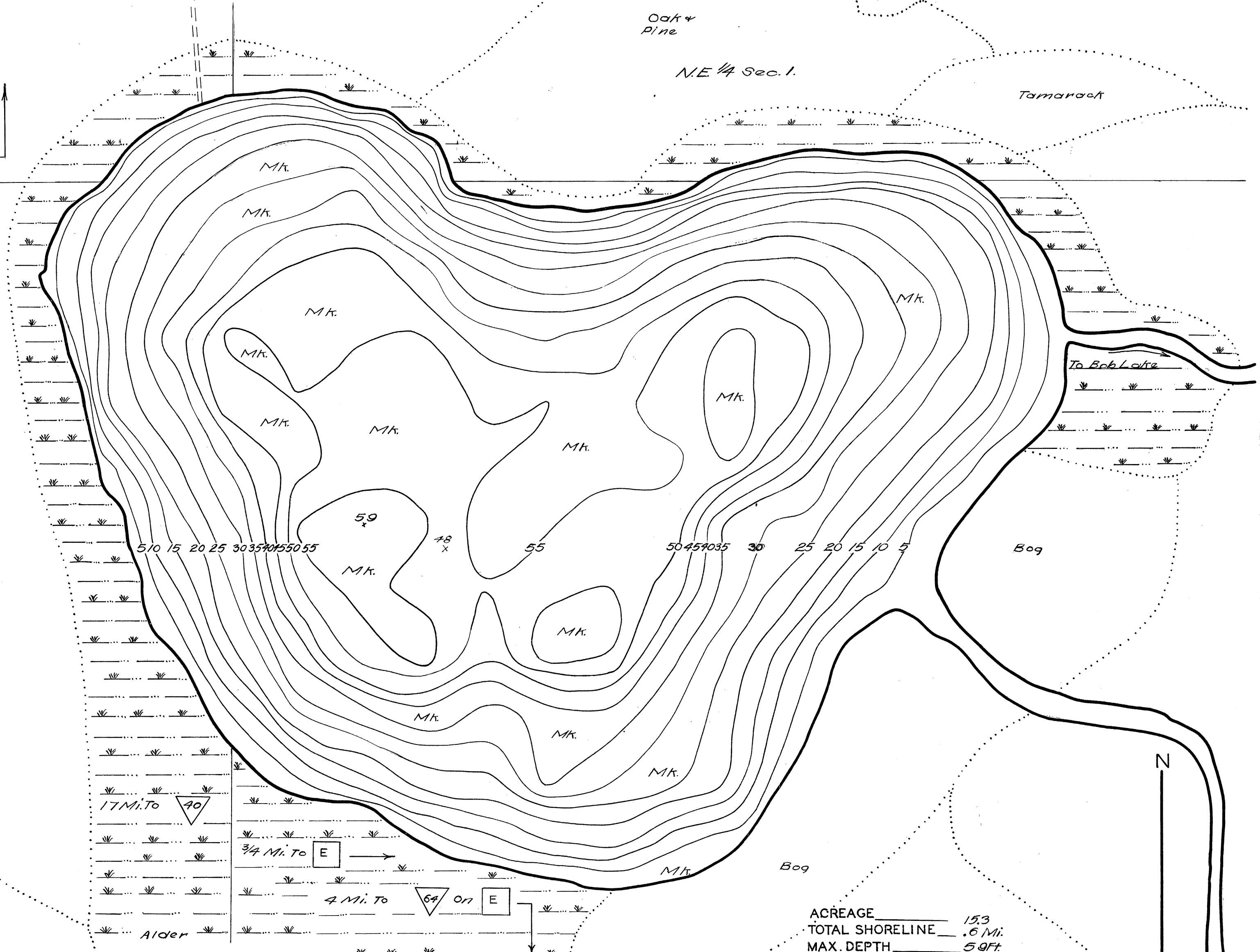

3 Mi. To M

17 Mi. To 40

3/4 Mi. To E

4 Mi. To 64 on E

ACREAGE 15.3
 TOTAL SHORELINE .6 Mi.
 MAX. DEPTH 50 Ft.

SCALE 1 inch Equals 82.5 Ft.

DATE May 23 1941
 COMPILED BY _____
 TRACED BY W. T. Z. (W.P.A.)
 SOURCE OF INFORMATION _____
W.P.A. Lake Survey Project
 SOUNDINGS 60 Ft. intervals
 DATES OF MAP REVISION _____
 WORK AGENCY W. P. A.

LAKE IMPROVEMENT RECORD	
TYPE	DATE
BRUSH REFUGES	_____
SAPLING TANGLES	_____
SPAWNING BOXES	_____
MINNOW SPAWNERS	_____
TOTAL	_____

LEGEND	
WEED BEDS	
ROCKY SHOALS	
<u>Sd.</u> SAND	
<u>Cl.</u> CLAY	
<u>Gr.</u> GRAVEL	
<u>Mk.</u> MUCK	
DWELLING	
ABANDONED DWELLING	
RESORT	

CHECKED BY
 WRS-2011
 5-29-21

Source: Wisconsin Department of Natural Resources 608-266-2621
Pickeral Lake – Chippewa County, Wisconsin DNR Lake Map
Date – May 1941 - Historical Lake Map - Not for Navigation
A Public Document - Please Identify the Source when using it.