

# LAKE SURVEY MAP

LAKE TAMARACK  
 SECTION 11  
 TOWNSHIP 31 N  
 RANGE 8 W  
 TOWN OF CLEVELAND  
 COUNTY CHIPPEWA

FORM F1-117

WISCONSIN CONSERVATION DEPARTMENT  
 BIOLOGY DIVISION  
 LAKE AND STREAM IMPROVEMENT SECTION

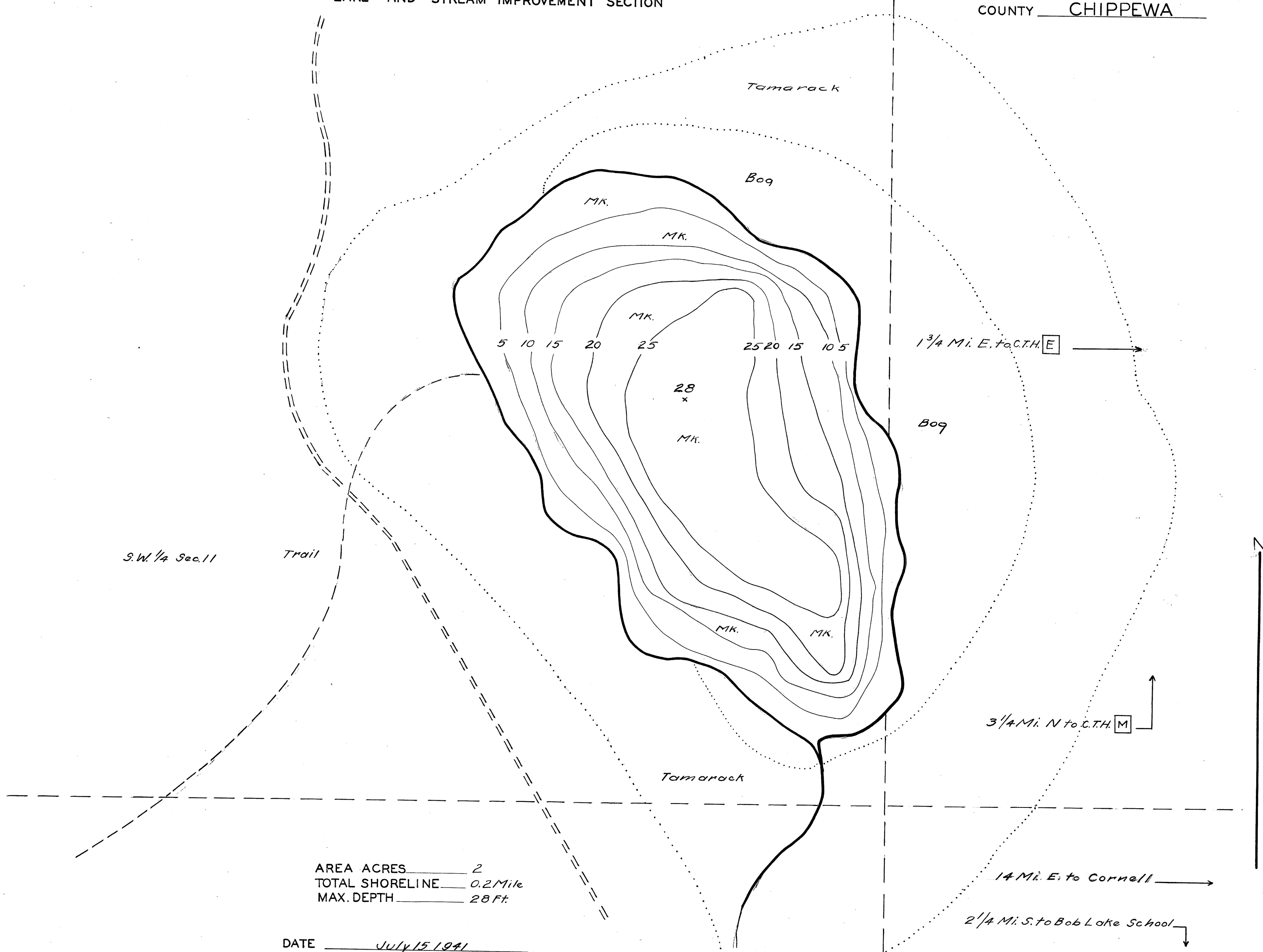

AREA ACRES 2  
 TOTAL SHORELINE 0.2 Mile  
 MAX. DEPTH 28 Ft.

DATE July 15, 1941  
 COMPILED BY \_\_\_\_\_  
 TRACED BY W.T.Z. (W.P.A.)  
 SOURCE OF INFORMATION \_\_\_\_\_  
W.P.A. Lake Survey Project  
 \_\_\_\_\_  
 SOUNDINGS 66 Ft. intervals  
 \_\_\_\_\_  
 DATES OF MAP REVISION \_\_\_\_\_  
 \_\_\_\_\_  
 WORK AGENCY W.P.A.

*Checked*  
*W.P.S.*  
*E.M.K.*  
*7/29/41*

LAKE IMPROVEMENT RECORD	
TYPE	DATE
○ BRUSH REFUGES	_____
— SAPLING TANGLES	_____
□ SPAWNING BOXES	_____
* MINNOW SPAWNERS	_____
TOTAL	_____

SCALE 1 inch Equals 55 Ft.  
 0 50 100 200 Ft.

- LEGEND
- WEED BEDS
  - ROCKY SHOALS
  - sd* SAND
  - cl* CLAY
  - gr* GRAVEL
  - Mk* MUCK
  - DWELLING
  - ABANDONED DWELLING
  - ▣ RESORT

Source: Wisconsin Department of Natural Resources 608-266-2621  
Tamarack Lake – Chippewa County, Wisconsin DNR Lake Map  
Date – Jul 1941 - Historical Lake Map - Not for Navigation  
A Public Document - Please Identify the Source when using it.