

# LAKE SURVEY MAP

LAKE HAY MEADOW  
 SECTION 14  
 TOWNSHIP 31 N  
 RANGE 8 W  
 TOWN OF CLEVELAND  
 COUNTY CHIPPEWA

FORM FI-117

WISCONSIN CONSERVATION DEPARTMENT  
 BIOLOGY DIVISION  
 LAKE AND STREAM IMPROVEMENT SECTION

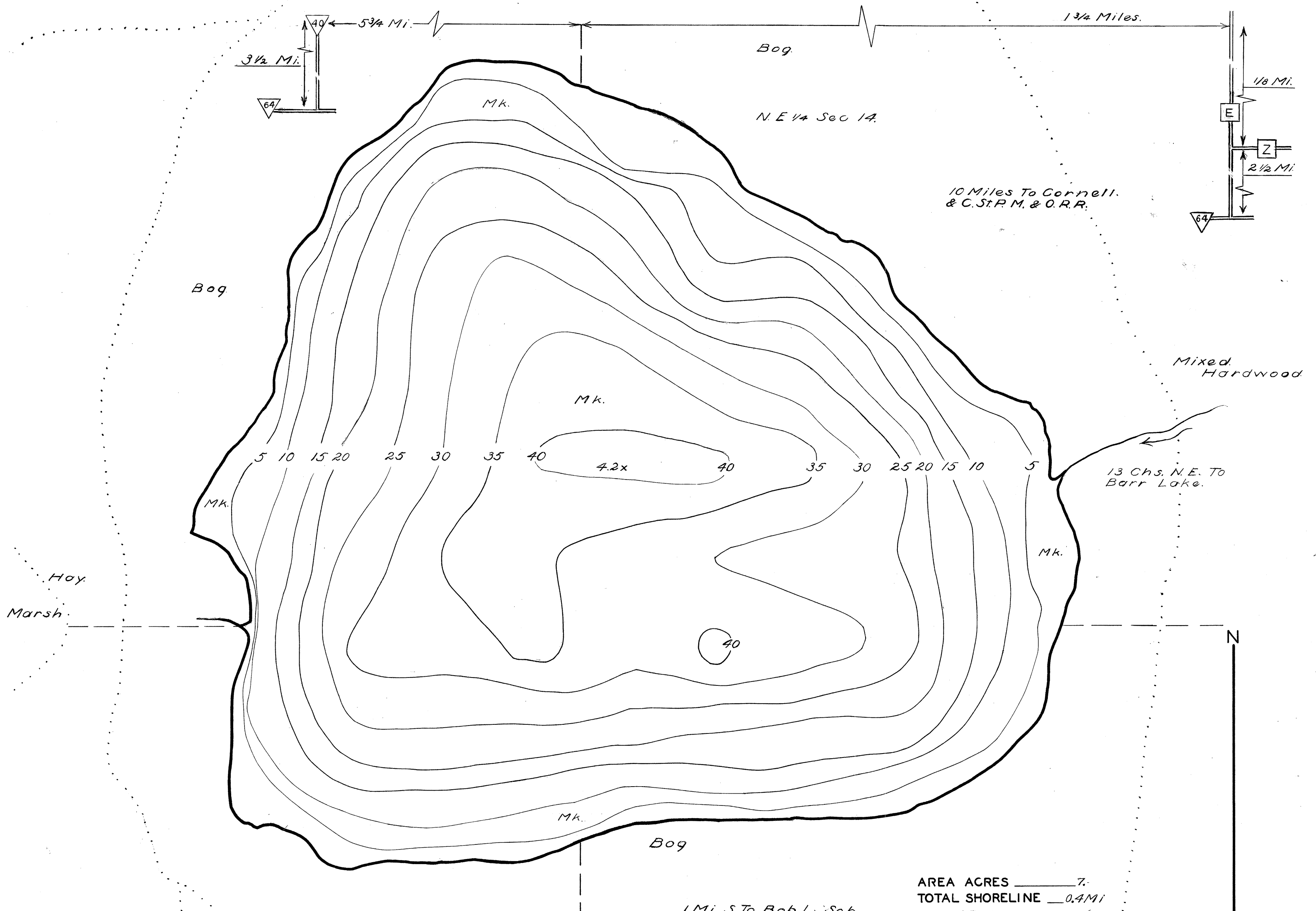

AREA ACRES 7.  
 TOTAL SHORELINE 0.4 MI  
 MAX. DEPTH 42 Ft.

SCALE 1 inch Equals 55 Ft.  
 0 50 100 150 200 250

DATE April 30, 1941  
 COMPILED BY \_\_\_\_\_  
 TRACED BY N.L.M. (W.P.A.)  
 SOURCE OF INFORMATION \_\_\_\_\_  
W.P.A. Lake Survey Project  
 \_\_\_\_\_  
 \_\_\_\_\_  
 SOUNDINGS At 66 Ft. Intervals  
 \_\_\_\_\_  
 \_\_\_\_\_  
 DATES OF MAP REVISION \_\_\_\_\_  
 \_\_\_\_\_  
 WORK AGENCY W. P. A.

### LAKE IMPROVEMENT RECORD

TYPE	DATE			
⊕ BRUSH REFUGES	_____	_____	_____	_____
~ SAPLING TANGLES	_____	_____	_____	_____
□ SPAWNING BOXES	_____	_____	_____	_____
* MINNOW SPAWNERS	_____	_____	_____	_____
TOTAL	_____	_____	_____	_____

### LEGEND

⊕ WEED BEDS	☼ ROCKY SHOALS
So. SAND	Cl. CLAY
Gr. GRAVEL	Mk. MUCK
■ DWELLING	□ ABANDONED DWELLING
■ RESORT	

Aspen.  
 CHECKED BY  
 W.P.A. G.S.P.  
 6-5-41

Source: Wisconsin Department of Natural Resources 608-266-2621  
Hay Meadow Lake - Chippewa County, Wisconsin DNR Lake Map  
Date: Apr 1941 - Historical Lake Map - Not for Navigation  
A Public Document - Please Identify the Source when using it.