

LAKE SURVEY MAP

WISCONSIN CONSERVATION DEPARTMENT
BIOLOGY DIVISION
LAKE AND STREAM IMPROVEMENT SECTION

LAKE WEST FORM F-117
SECTION 4-33
TOWNSHIP 31-32 N
RANGE 8 W
TOWN OF SAMPSON-WEST CLEVELAND
COUNTY CHIPPEWA

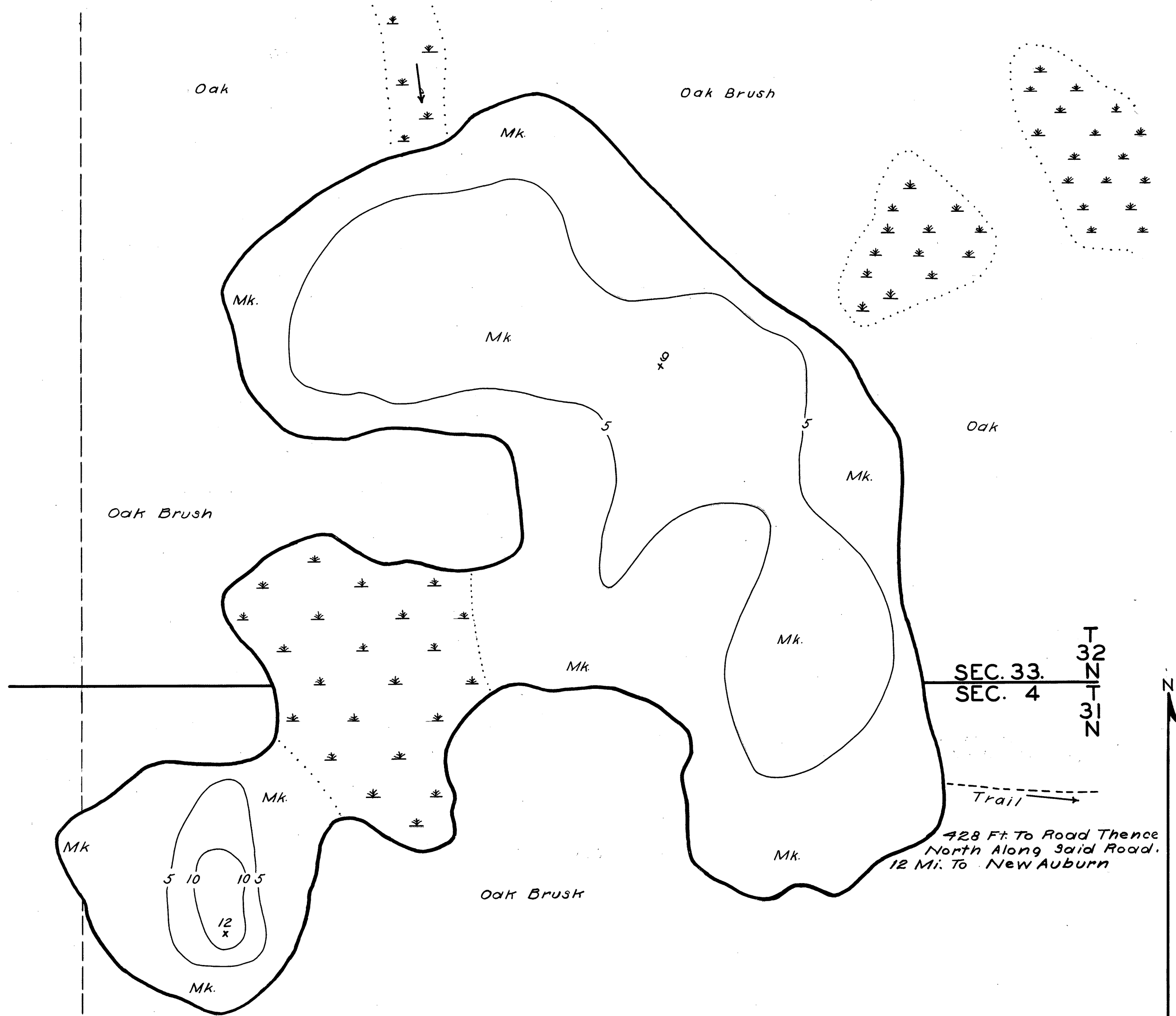

AREA 8 ACRES
SHORELINE 0.7 Mi.
MAX. DEPTH 12 FT.

DATE May 14, 1940
COMPILED BY O.S.B.
TRACED BY R.C.H. (W.P.A.)
SOURCE OF INFORMATION W.P.A. Lake Survey Project.

SOUNDINGS At 99 Ft. Intervals

DATES OF MAP REVISION April 8, 1940
WORK AGENCY W.P.A.
CHECKED BY W.P.S.
328-41

LAKE IMPROVEMENT RECORD			
TYPE	DATE		
BRUSH REFUGES			
SAPLING TANGLES			
SPAWNING BOXES			
MINNOW SPAWNS			
TOTAL			

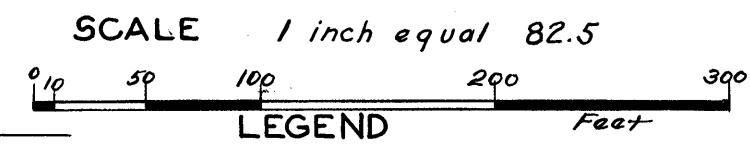

- LEGEND
- WEED BEDS
 - ROCKY SHOALS
 - Sd.* SAND
 - Cl.* CLAY
 - Gr.* GRAVEL
 - Mk.* MUCK
 - DWELLING
 - ABANDONED DWELLING
 - RESORT

Source: Wisconsin Department of Natural Resources 608-266-2621
West Lake – Chippewa County, Wisconsin DNR Lake Map
Date – May 1940 - Historical Lake Map - Not for Navigation
A Public Document - Please Identify the Source when using it.