

LAKE SURVEY MAP

CORNELL
LAKE

CHIPPEWA
COUNTY

SEC. 3, 35 T. 30, 31 N. R. 8 W.

B.M. 'X' Two nails in notch in base of 16"
Norway Pine, 25' E. of dam & 15' N. of shoreline
Assumed elevation 100.06'
Water level 96.47'

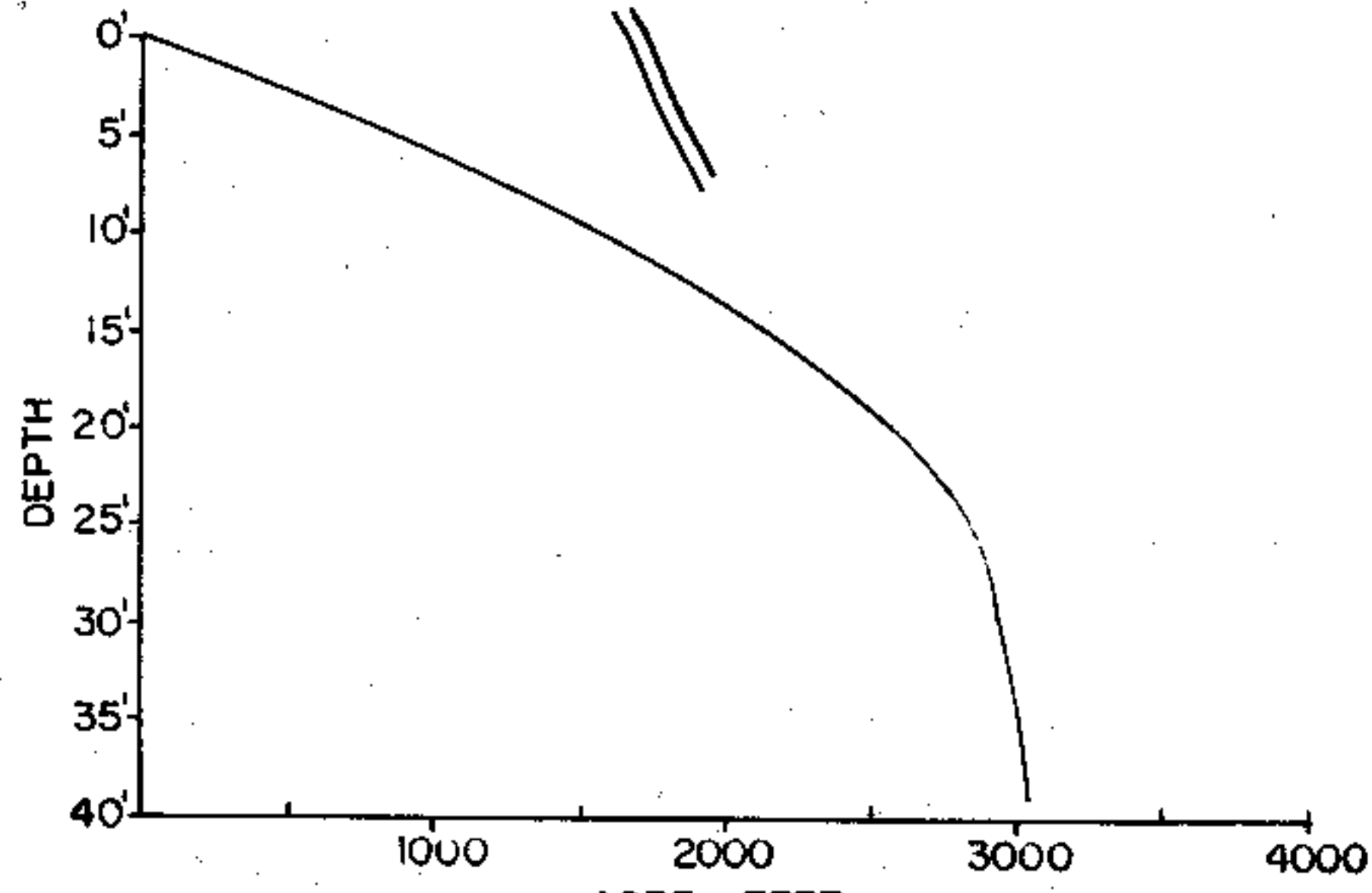

Mixed Hardwood & Pine

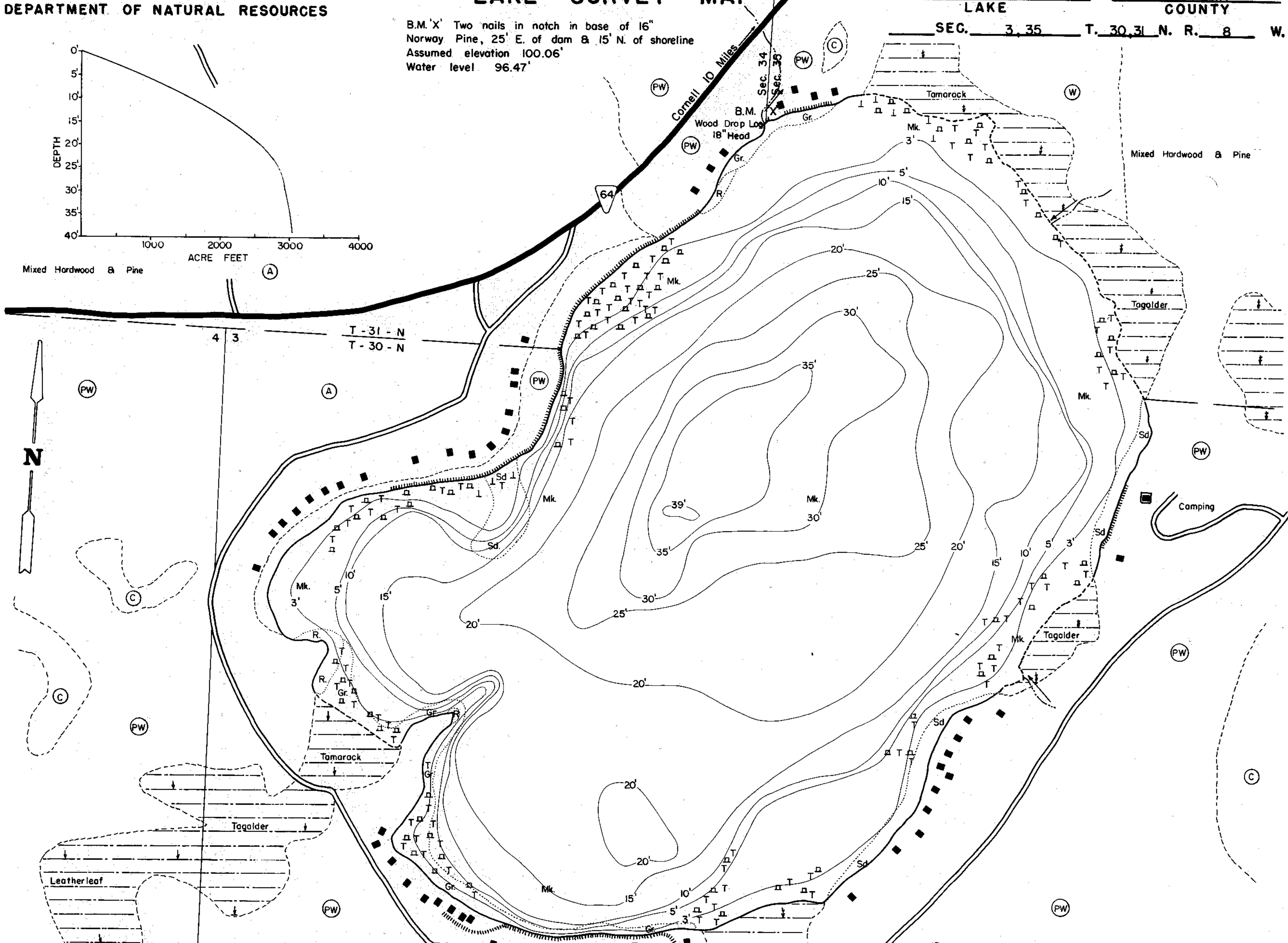

EQUIPMENT RECORDING SONAR MAPPED AUG 1969
MONTH YEAR

- TOPOGRAPHIC SYMBOLS**
- (B) Brush
 - (PW) Partially wooded
 - (W) Wooded
 - (C) Cleared
 - (P) Pastured
 - (A) Agricultural
 - B.M. Bench Mark
 - Dwelling
 - Resort
 - Camp

- LAKE BOTTOM SYMBOLS**
- P. Peat
 - Mk. Muck
 - C. Clay
 - M. Marl
 - Sd. Sand
 - St. Silt
 - Gr. Gravel
 - R. Rubble
 - Bc. Bedrock

- LAKE BOTTOM SYMBOLS**
- ▬ Steep slope
 - - - Indefinite shoreline
 - ▬ Marsh
 - Spring
 - Intermittent stream
 - Permanent inlet
 - Permanent outlet
 - Dam
 - D.N.R. State owned land
 - Boulders
 - ⊙ Stumps & Snags
 - ⊙ Rock danger to navigation
 - T Submergent vegetation
 - ⊥ Emergent vegetation
 - ⊥ Floating vegetation
 - ⊥ Brush shelters

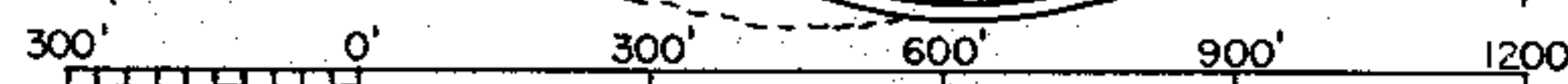

◆ Access ◆ Access with Parking ◆ Boat Livery

Drawn by: C. Holt
Field work by: S. Johannes, C. Busch, C. Belter

SPECIES OF FISH	ABUNDANCE		
	Abundant	Common	Present
Muskie			
N. Pike	X		
Walleye	X	X	
L. M. Bass	X		
S. M. Bass	X		
Panfish	X		
Trout			

WATER AREA 193.5 ACRES
 UNDER 3 FT. 14 %
 OVER 20 FT. 35 %
 MAX. DEPTH 39 FEET.
 TOTAL ALK. 54 P.P.M.
 VOLUME 3039.5 ACRE FT.
 SHORELINE 2.3 MILES

Source: Wisconsin Department of Natural Resources 608-266-2621
Cornell Lake – Chippewa County, Wisconsin DNR Lake Map
Date – Aug 1969 - Historical Lake Map - Not for Navigation
A Public Document - Please Identify the Source when using it.