

LAKE SURVEY MAP

LAKE _____ LONG _____
 SECTION 26-27-34 35
 TOWNSHIP 31 N
 RANGE 8 W
 TOWN OF CLEVELAND
 COUNTY CHIPPEWA

FORM FH17

WISCONSIN CONSERVATION DEPARTMENT
 BIOLOGY DIVISION
 LAKE AND STREAM IMPROVEMENT SECTION

Aspen & Birch

Aspen & Birch

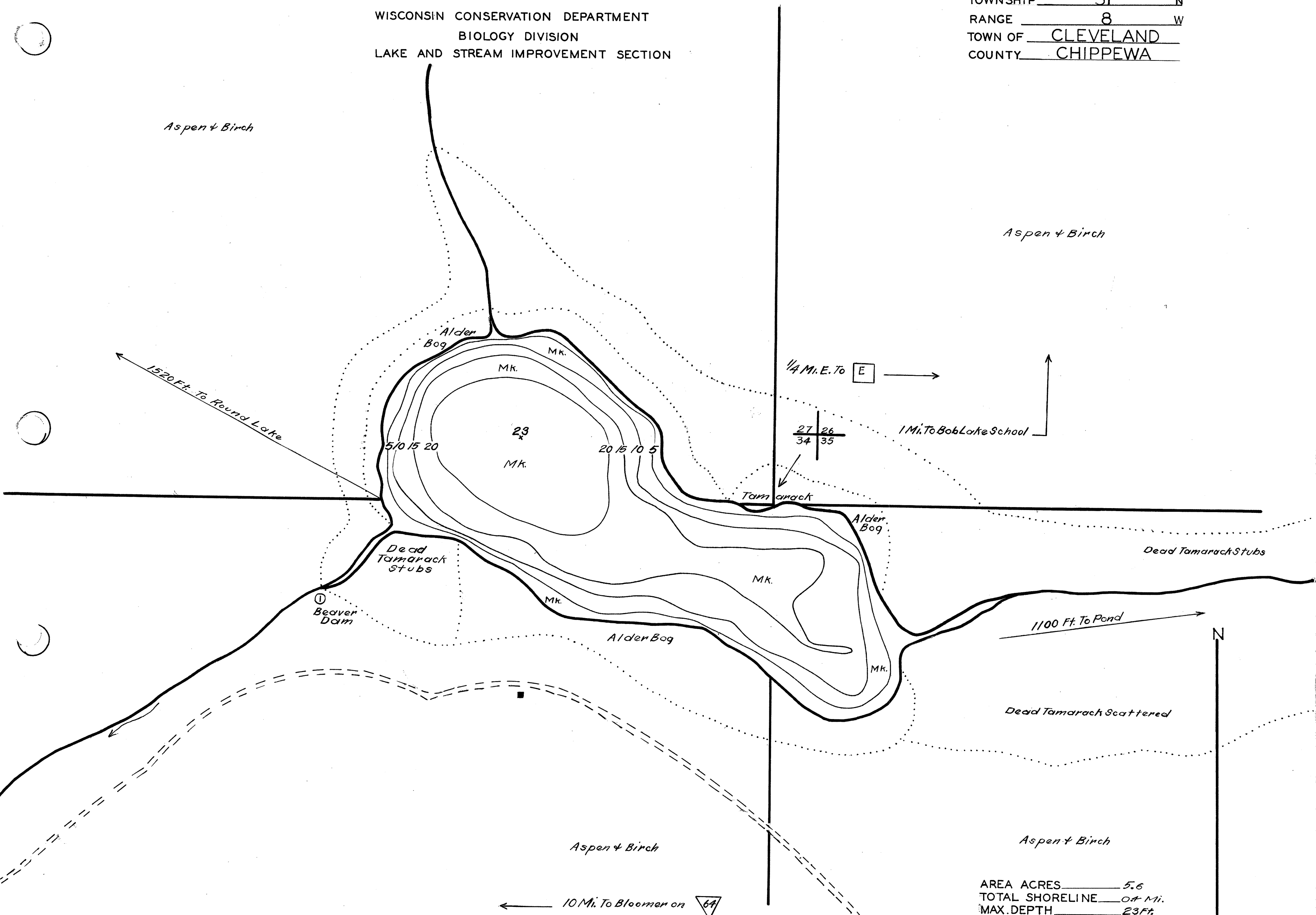

DATE June 6, 1941
 COMPILED BY _____
 TRACED BY W.T.Z. (W.P.A.)
 SOURCE OF INFORMATION W.P.A. Lake Survey Project
 SOUNDING 66 Ft intervals
 DATES OF MAP REVISION _____
 WORK AGENCY W.P.A.

*CHECKED BY
 W.P.S. - E.M.K.
 5-5-41*

LAKE IMPROVEMENT RECORD	
TYPE	DATE
☉ BRUSH REFUGES	_____
□ SPAWNING BOXES	_____
⋄ SAPLING TANGLES	_____
* MINNOW SPAWNERS	_____
TOTAL	_____

AREA ACRES 5.6
 TOTAL SHORELINE 0.4 Mi.
 MAX. DEPTH 23 Ft.

SCALE 1 inch Equals 110 Ft.
 0 50 100 200 300 400 Ft.

- LEGEND**
- ☉ WEED BEDS
 - ⋄ ROCKY SHOALS
 - Sd SAND
 - Cl. CLAY
 - Gn GRAVEL
 - Mk MUCK
 - DWELLING
 - ABANDONED DWELLING
 - ▣ RESORT

Source: Wisconsin Department of Natural Resources 608-266-2621
Long Lake – Chippewa County, Wisconsin DNR Lake Map
Date – Jun 1941 - Historical Lake Map - Not for Navigation
A Public Document - Please Identify the Source when using it.