

LAKE SURVEY MAP

B16

LAKE BUCK  
 SECTION 15  
 TOWNSHIP 31 N  
 RANGE 8 W  
 TOWN OF CLEVELAND  
 COUNTY CHIPPEWA

FORM F1-117

T.31.N-

WISCONSIN CONSERVATION DEPARTMENT  
 BIOLOGY DIVISION  
 LAKE AND STREAM IMPROVEMENT SECTION

S.W. 1/4 SEC. 15

N.W. 1/4 SEC. 15

R.8.W.

S.E. 1/4 SEC. 15

N.E. 1/4 SEC. 15

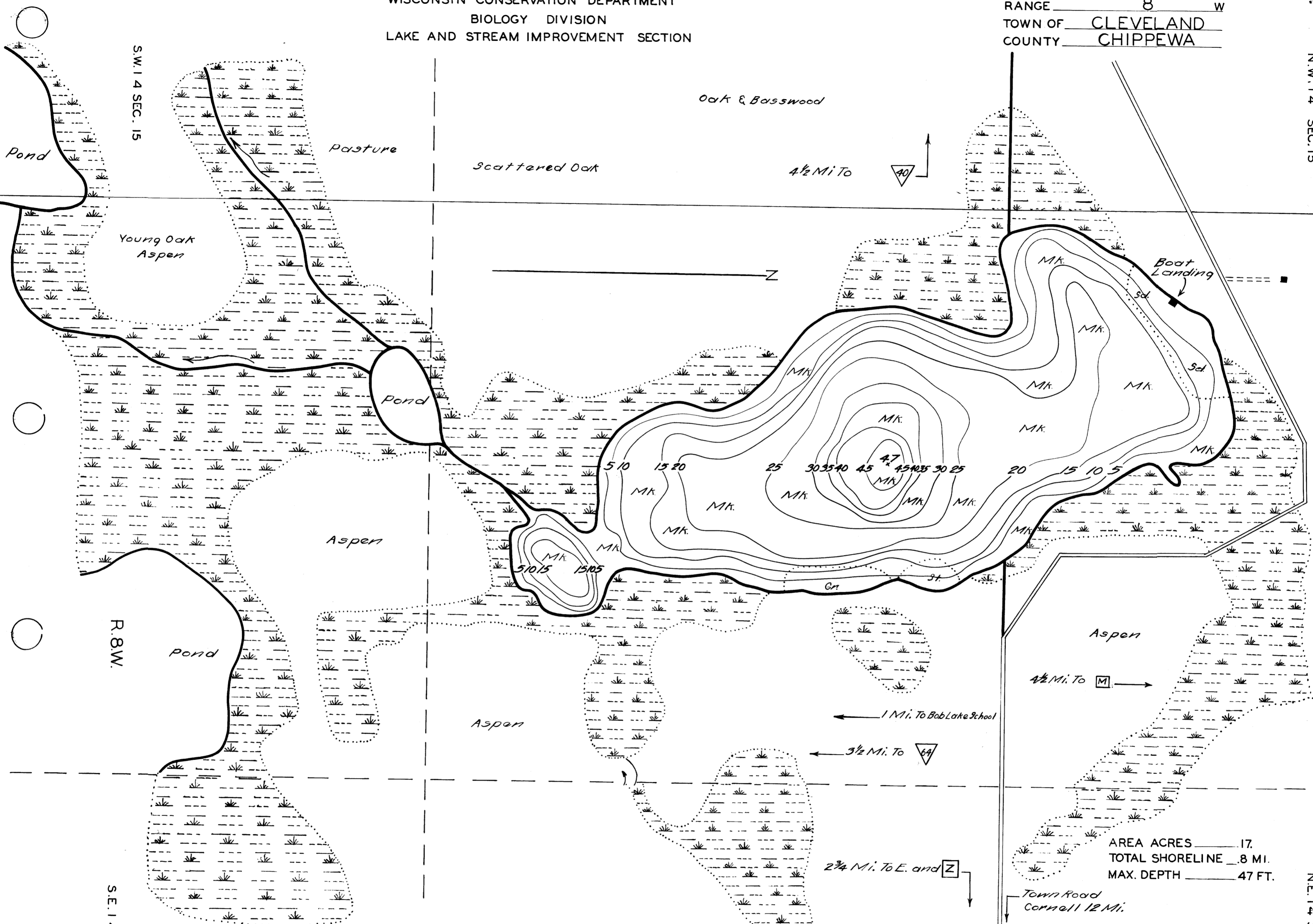

Oak & Basswood

Scattered Oak

4 1/2 Mi To



Boat Landing

Pond

Young Oak Aspen

Pasture

Pond

Aspen

Pond

Aspen

Aspen

4 1/2 Mi. To [M]

1 Mi. To Bob Lake School

3 1/2 Mi. To [6A]

2 3/4 Mi. To E. and [Z]

AREA ACRES 17  
 TOTAL SHORELINE 8 MI.  
 MAX. DEPTH 47 FT.

Town Road  
 Cornell 12 Mi.

DATE July 31, 1941  
 COMPILED BY \_\_\_\_\_  
 TRACED BY W.T.Z. (W.P.A.)  
 SOURCE OF INFORMATION W.P.A. Lake Survey Project  
 SOUNDINGS 90 Ft. intervals  
 DATES OF MAP REVISION \_\_\_\_\_  
 WORK AGENCY W. P. A.

LAKE IMPROVEMENT RECORD

TYPE	DATE		
○ BRUSH REFUGES			
- SAPLING TANGLES			
□ SPAWNING BOXES			
* MINNOW SPAWNERS			
TOTAL			

LEGEND

- WEED BEDS
- ROCKY SHOALS
- Sd. SAND
- Cl. CLAY
- Gr. GRAVEL
- Mk. MUCK
- DWELLING
- ABANDONED DWELLING
- RESORT
- St. SILT

SCALE 1 inch Equals 165 Ft.

Checked  
 W.P.A.  
 L.M.A.  
 8/6/41

Source: Wisconsin Department of Natural Resources 608-266-2621  
Big Buck Lake – Chippewa County, Wisconsin DNR Lake Map  
Date – Jul 1941 - Historical Lake Map - Not for Navigation  
A Public Document - Please Identify the Source when using it.