

LAKE SURVEY MAP

LAKE RED CEDAR
SECTIONS 2,3,10,11,15,22,27
TOWNSHIP T-36-N
RANGE R-10-W
TOWN CEDAR LAKE
COUNTY BARRON

(Sheet 1 of 2)

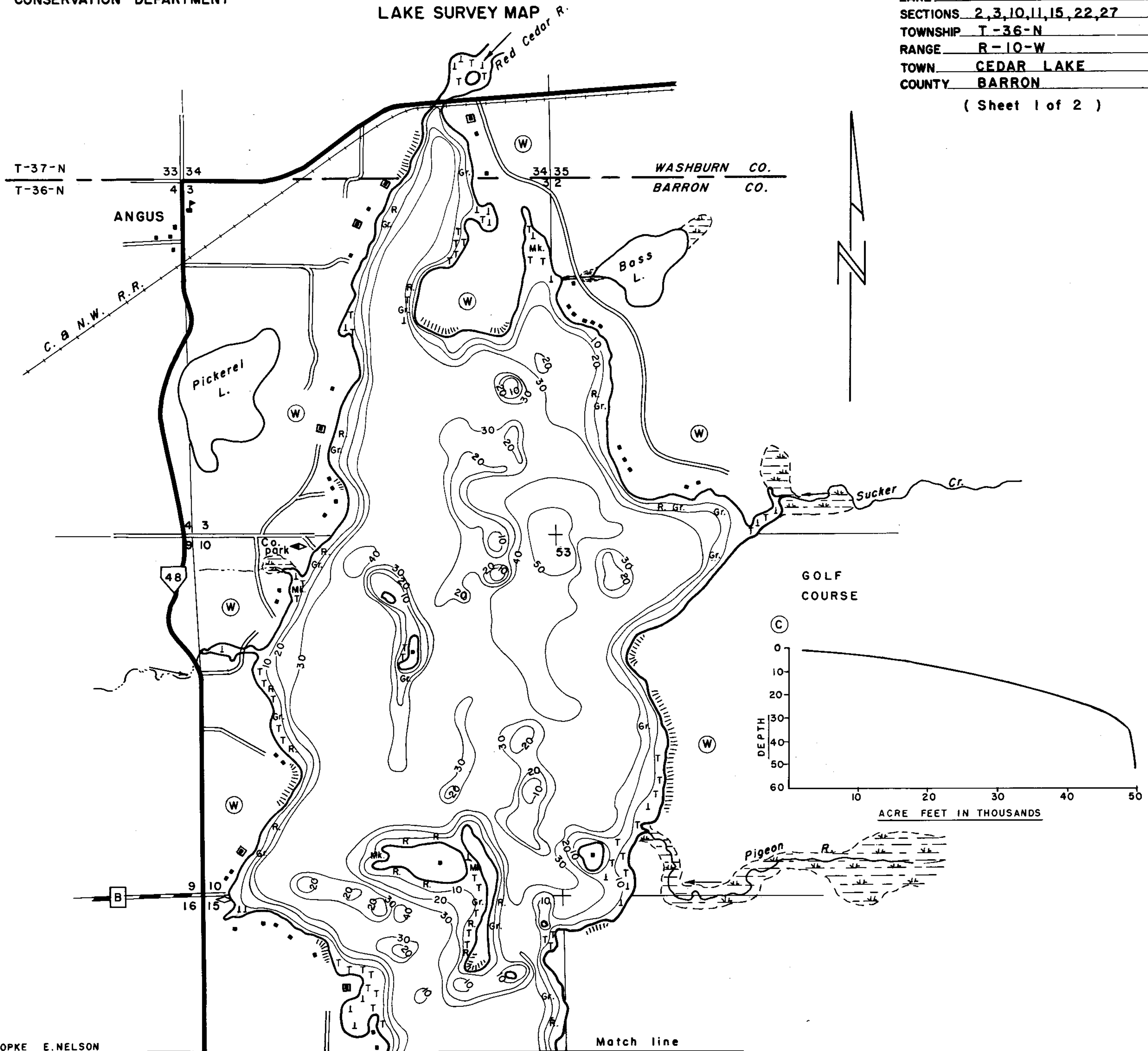

FIELD WORK BY: R.HOPKE E.NELSON
DRAWN BY: E.EATON
LAKE MAPPED OCTOBER 1964
SOURCE OF INFORMATION W.C.D.
SOUNDINGS RECORDING SONAR
TOTAL ALK. 66 P.P.M.

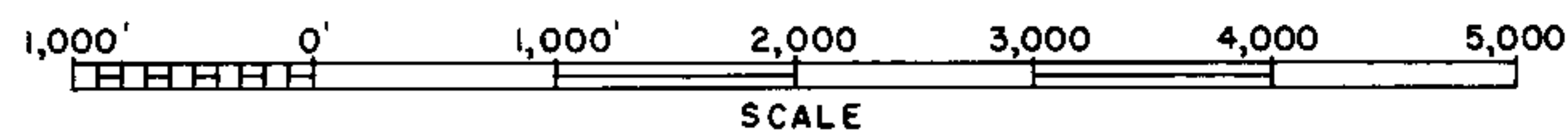

◇ ACCESS ◇ ACCESS WITH PARKING ◆ BOAT LIVERY

AREA 1,841 ACRES
TOTAL SHORELINE 15.9 MILES
MAX. DEPTH 53 FEET
SCALE: AS SHOWN

LAKE SURVEY MAP

LAKE RED CEDAR
 SECTIONS 2,3,10,11,14,15,22,27
 TOWNSHIP T-36-N
 RANGE R-10-W
 TOWN CEDAR LAKE
 COUNTY BARRON
 (Sheet 2 of 2)

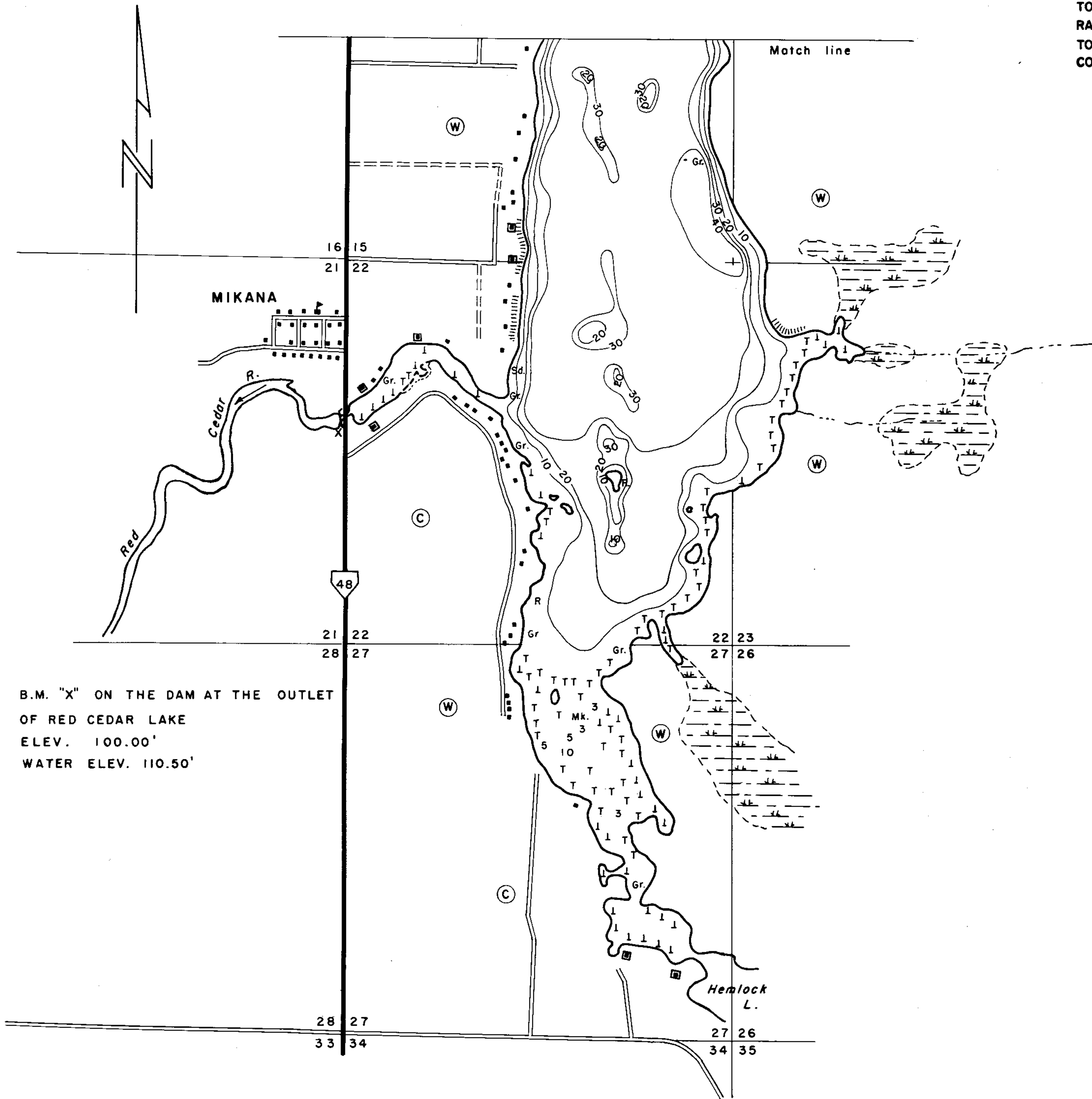

- LEGEND**
- TOPOGRAPHIC SYMBOLS**
- (B) Brush
 - (PW) Partially wooded
 - (W) Wooded
 - (C) Cleared
 - (P) Pastured
 - (A) Agricultural
 - B.M. Bench Mark
 - Dwelling
 - ▣ Resort
 - ||||| Steep slope
 - - - Indefinite shoreline
 - Marsh
 - Spring
 - Intermittent stream
 - Permanent inlet
 - Permanent outlet
 - Dam

- LAKE BOTTOM SYMBOLS**
- P. Peat Mk. Muck
 - C. Clay M. Marl
 - Sd. Sand Gr. Gravel
 - Br. Bedrock R. Rubble
 - T Submergent vegetation
 - I Emergent vegetation

SPECIES OF FISH			
	Abundant	Common	Rare
Muskie			
N. Pike		X	
Walleye	X		
L.M. Bass		X	
S.M. Bass		X	
Panfish			X
Trout			
Cisco			X

B.M. "X" ON THE DAM AT THE OUTLET OF RED CEDAR LAKE
 ELEV. 100.00'
 WATER ELEV. 110.50'

LAKE MAPPED OCTOBER 1964
 SOURCE OF INFORMATION W.C.D.
 SOUNDINGS RECORDING SONAR
 TOTAL ALK. 66 P.P.M.

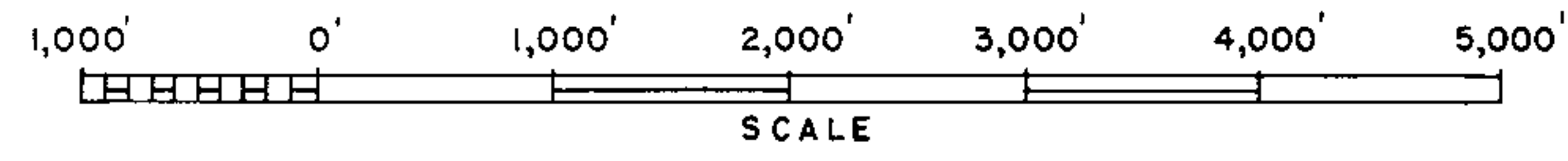

AREA 1,841 ACRES
 TOTAL SHORELINE 15.9 MILES
 MAX. DEPTH 53 FEET
 SCALE: AS SHOWN

Source: Wisconsin Department of Natural Resources 608-266-2621
Red Cedar Lake – Barron County, Wisconsin DNR Lake Map
Date – Oct 1964 - Historical Lake Map - Not for Navigation
A Public Document - Please Identify the Source when using it.