

# LAKE SURVEY MAP

WISCONSIN CONSERVATION DEPARTMENT  
BIOLOGY DIVISION  
LAKE AND STREAM IMPROVEMENT SECTION

LAKE BEAVER (UNNAMED) FORM FH-17  
SECTION 27-28  
TOWNSHIP 32 N  
RANGE 7 W  
TOWN OF BIRCHCREEK  
COUNTY CHIPPEWA

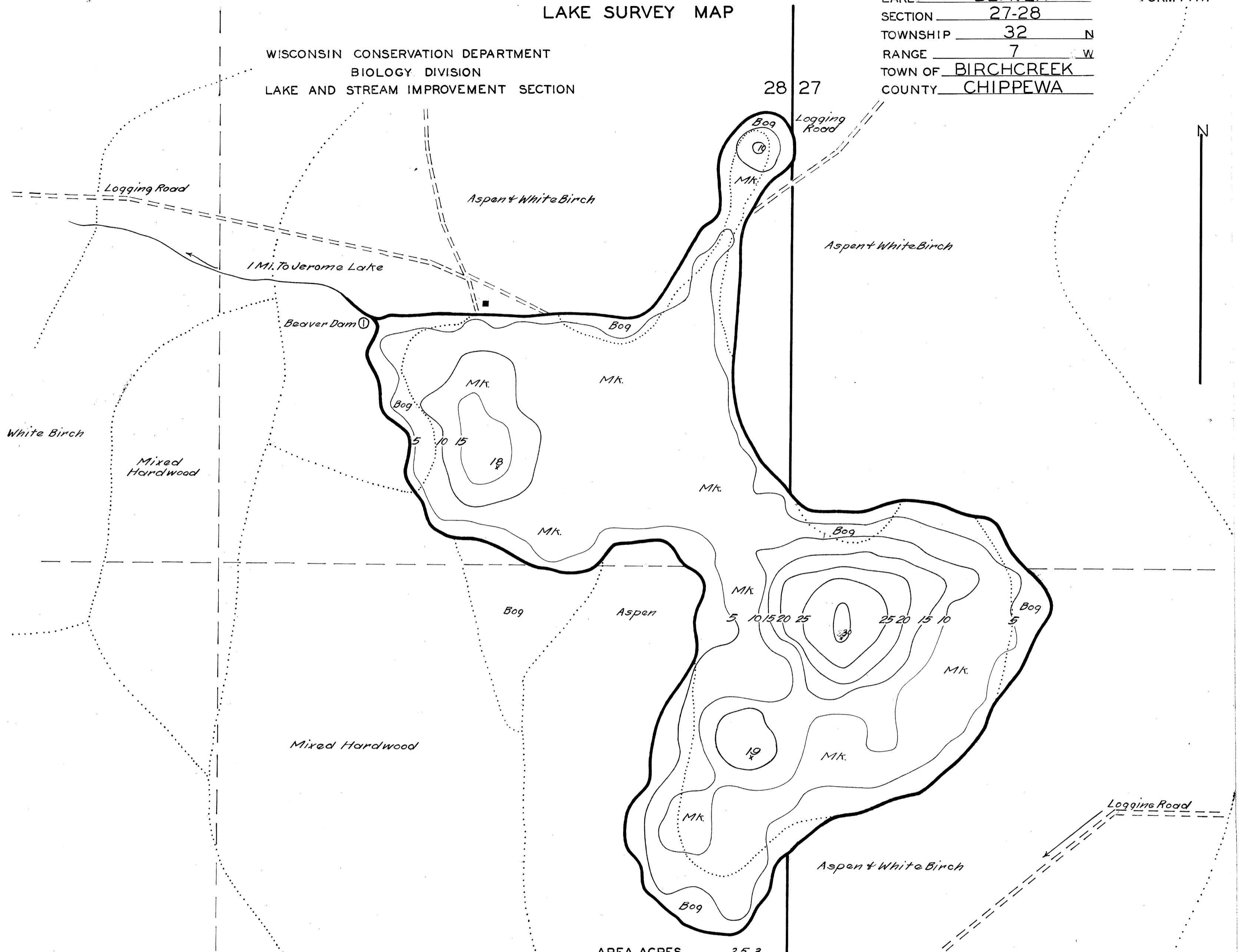

AREA ACRES 25.3  
TOTAL SHORELINE 1.1 Mi.  
MAX. DEPTH 30 Ft.

SCALE 1 inch Equals 165 Ft.  
0 10 50 100 200 300 400 500 Ft.

Checked  
W.P.S  
D.A.B  
7/9/41

DATE July 7 1941  
COMPILED BY \_\_\_\_\_  
TRACED BY W.T.Z. (W.P.A.)  
SOURCE OF INFORMATION \_\_\_\_\_  
W.P.A. Lake Survey Project  
SOUNDINGS 66 Ft. intervals  
DATES OF MAP REVISION \_\_\_\_\_  
WORK AGENCY W. P. A.

LAKE IMPROVEMENT RECORD	
TYPE	DATE
○ BRUSH REFUGES	_____
⊖ SAPLING TANGLES	_____
□ SPAWNING BOXES	_____
* MINNOW SPAWNERS	_____
TOTAL	_____

LEGEND	
	WEED BEDS
	ROCKY SHOALS
	SAND
	CLAY
	GRAVEL
	MUCK
	DWELLING
	ABANDONED DWELLING
	RESORT

Source: Wisconsin Department of Natural Resources 608-266-2621  
Un-Named Lake (Beaver Lake) – Chippewa County, Wisconsin DNR Lake Map  
Date – Jul 1941 - Historical Lake Map - Not for Navigation  
A Public Document - Please Identify the Source when using it.