

LAKE SURVEY MAP

LAKE KIESOW
 SECTION 6-5
 TOWNSHIP 31 N
 RANGE 8 W
 TOWN OF BLOOMER
 COUNTY CHIPPEWA

FORM FH-17

WISCONSIN CONSERVATION DEPARTMENT
 BIOLOGY DIVISION
 LAKE AND STREAM IMPROVEMENT SECTION

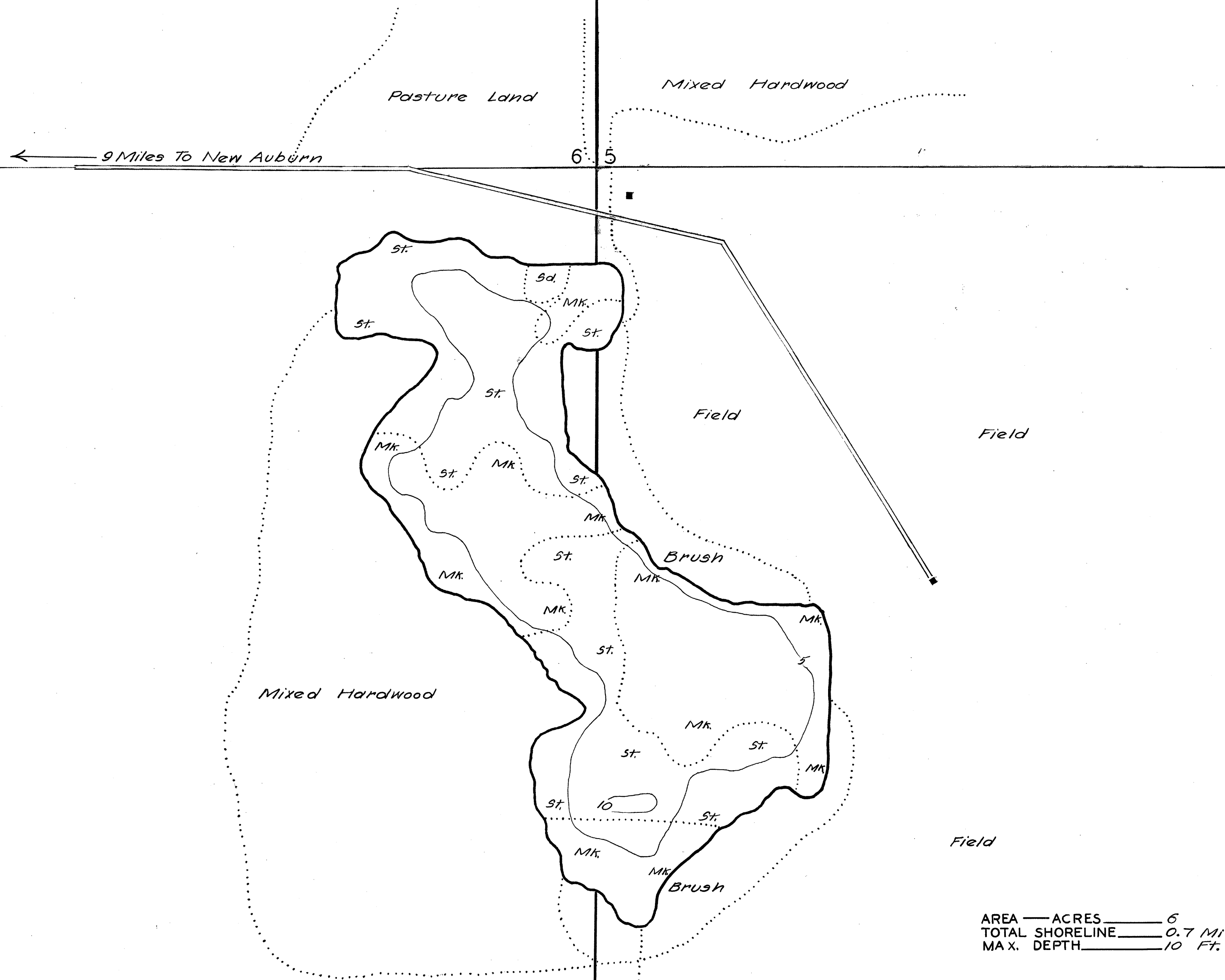

← 9 Miles To New Auburn

AREA — ACRES 6
 TOTAL SHORELINE 0.7 MI
 MAX. DEPTH 10 FT.

DATE Mar. 17 1941
 COMPILED BY _____
 TRACED BY W.R.S. (W.P.A.)
 SOURCE OF INFORMATION W.P.A. Lake Survey Project

 SOUNDINGS At 4 Rod Intervals

 DATES OF MAP REVISION _____

 WORK AGENCY W. P. A.

LAKE IMPROVEMENT RECORD	
TYPE	DATE
⊙ BRUSH REFUGES	_____
~ SAPLING TANGLES	_____
□ SPAWNING BOXES	_____
* MINNOW SPAWNERS	_____
TOTAL	_____

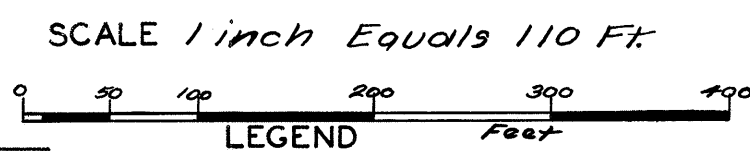

- LEGEND
- ⊙ WEED BEDS
 - ⊙ ROCKY SHOALS
 - Sd SAND
 - Cl CLAY
 - Gk GRAVEL
 - Mk MUCK
 - DWELLING
 - ABANDONED DWELLING
 - ▣ RESORT

*CHECKED BY
 W.P.S. - E.M.K.
 5/14/41*

Source: Wisconsin Department of Natural Resources 608-266-2621
Un-Named Lake (Kiesow Lake) – Chippewa County, Wisconsin DNR Lake Map
Date – Mar 1941 - Historical Lake Map - Not for Navigation
A Public Document - Please Identify the Source when using it.