

LAKE NO. 3

20.7	ACRES WITH ISLAND
20.0	ACRES WITHOUT IS.
1.3	MILES SHORELINE
15 %	UNDER 3'
0 %	OVER 20'
20'	MAX. DEPTH

COUNTY  
FOREST

Mixed Hardwood

2A  
D.N.R.

7A  
W

20.7 ACRES WITH ISLAND  
20.0 ACRES WITHOUT IS.  
1.3 MILES SHORELINE  
15 % UNDER 3'  
0 % OVER 20'  
20' MAX. DEPTH

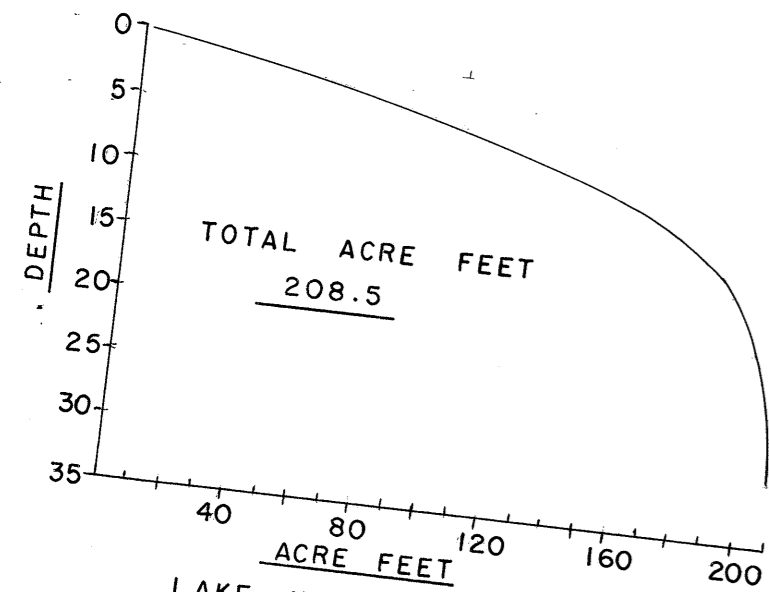
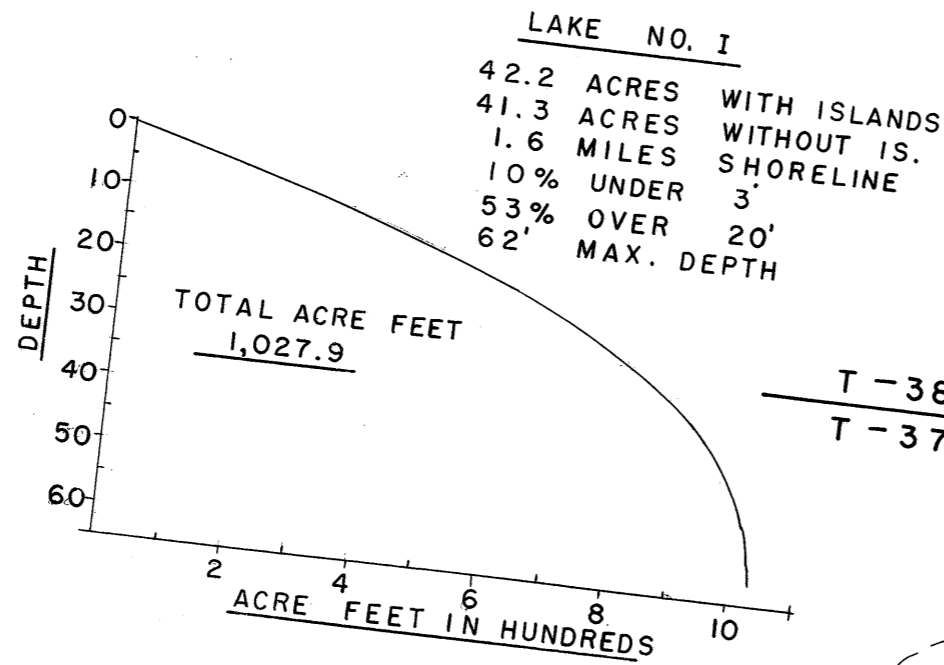
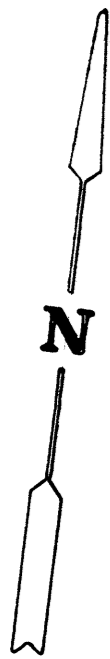

LAKE NO. 4  
24.5 ACRES WITH ISLAND  
23.6 ACRES WITHOUT IS.  
1.5 MILES SHORELINE  
9% UNDER 3'  
9% OVER 20'  
30' MAX. DEPTH

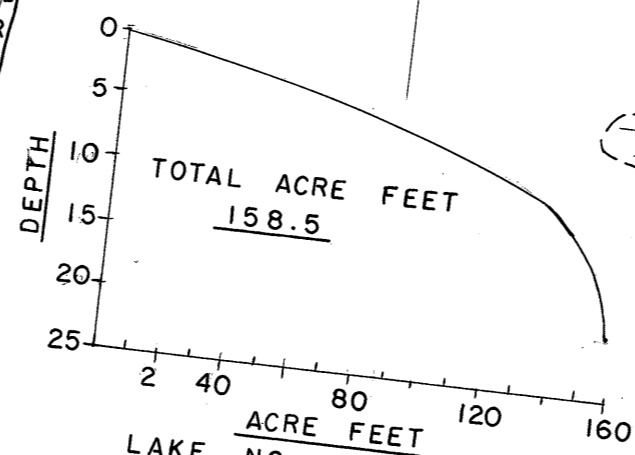

LAKE NO. 3  
20.7 ACRES WITH ISLAND  
20.0 ACRES WITHOUT IS.  
1.3 MILES SHORELINE  
15% UNDER 3'  
0% OVER 20'  
20' MAX. DEPTH

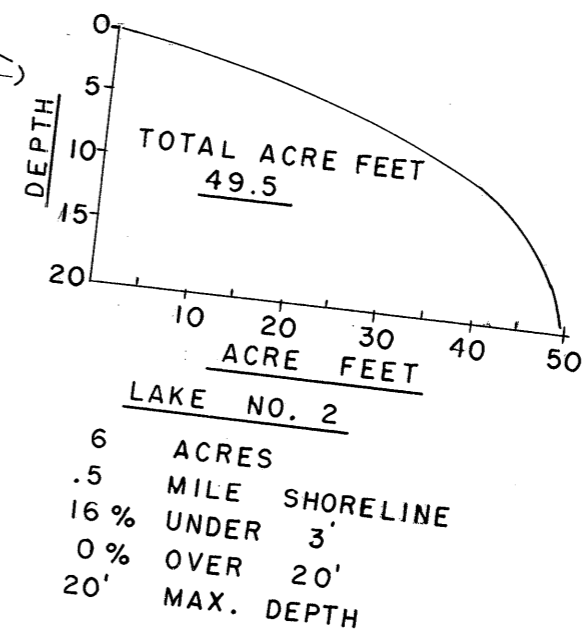

LAKE NO. 2  
6 ACRES  
.5 MILE SHORELINE  
16% UNDER 3'  
0% OVER 20'  
20' MAX. DEPTH

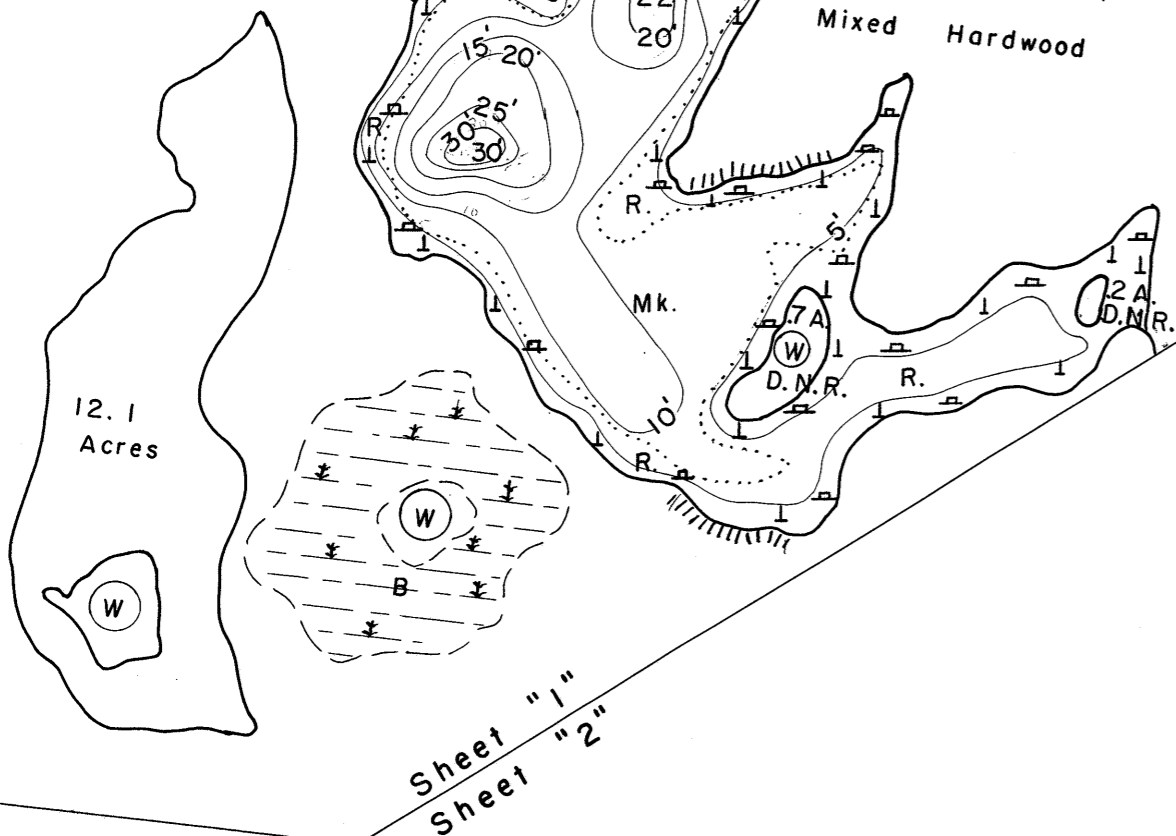

COUNTY  
FOREST

D.N.R. B.M. 'X' 1092 - A BRONZE TABLET  
SET IN TOP OF CONCRETE POST 45' FROM  
EAST SHORE OF LAKE NO. 1, SOUTH  
OF INLET.  
ASSUMED ELEV. 100.00'  
WATER ELEV. 91.98'

SPECIES OF FISH		
	Abundant	Rare
Muskie		
N. Pike	X	
Walleye		X
L.M. Bass	X	
S.M. Bass		
Panfish	X	
Trout		

EQUIPMENT RECORDING SONAR MAPPED AUGUST 1967  
MO. YR.

WATER ELEV. 91.98

TOPOGRAPHIC SYMBOLS		LAKE BOTTOM SYMBOLS	
(B) Brush	Steep slope	P. Peat	Gr. Gravel
(PW) Partially wooded	~ Indefinite shoreline	Mk. Muck	R. Rubble
(W) Wooded	Marsh	C. Clay	Br. Bedrock
(C) Cleared	o Spring	T Submergent vegetation	
(P) Pastured	~ Intermittent stream	l Emergent vegetation	
(A) Agricultural	== Permanent inlet	± Floating vegetation	
B.M. Bench Mark	== Permanent outlet		
■ Dwelling	∧ Dam	Sd. Sand	
□ Resort	D.N.R. State owned land	St. Silt	

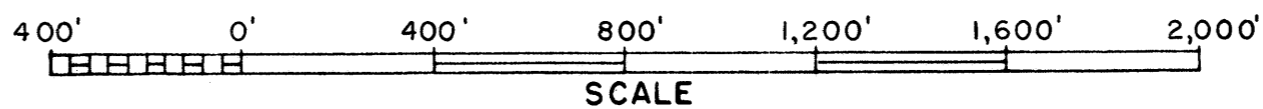

◇ Access      ◈ Access with Parking      ◆ Boat Livery

Field work by C. Busch, N. Pokorney, L. Sather Drawn by: E. Eaton

(TOTALS) 290.1 WITH ISLANDS  
AREA 261.5 ACRES  
UNDER 3FT. 9%  
OVER 20FT. 24%  
VOLUME 3,806.7 ACRE FT.  
TOTAL ALK. 13 P.P.M.  
SHORELINE 10.6 MILES  
MAX. DEPTH 62 FEET

# LAKE SURVEY MAP

SPIDER LAKE CHAIN  
LAKE  
WASHBURN COUNTY  
SEC. 35, 23, 10 T. 37, 38-N. R. 10- P.W.  
(Sheet 2 of 2)



4 3  
9 10  
ELBOW  
36.3 ACRES  
25' DEPTH

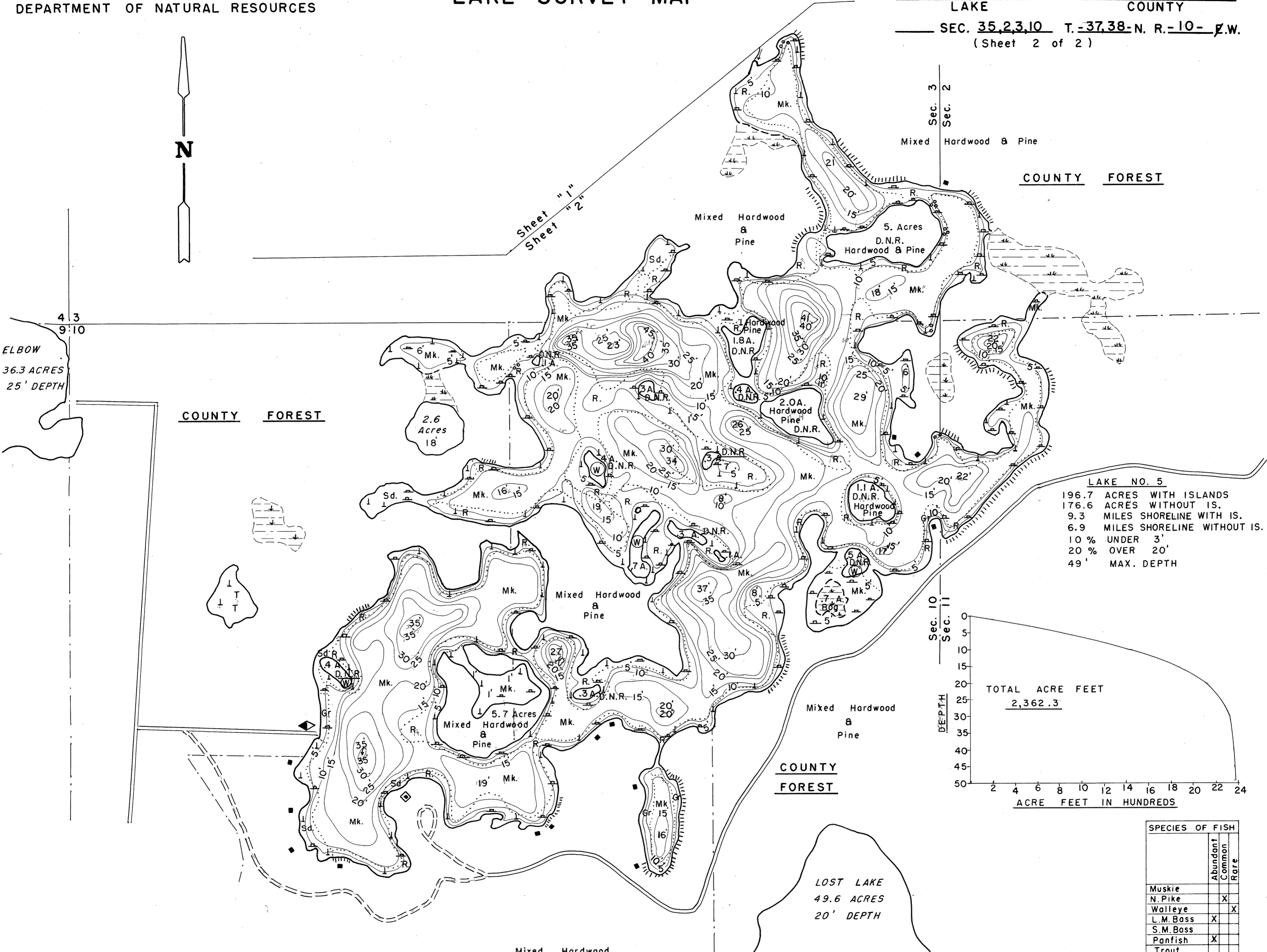

**LAKE NO. 5**  
196.7 ACRES WITH ISLANDS  
176.6 ACRES WITHOUT IS.  
9.3 MILES SHORELINE WITH IS.  
6.9 MILES SHORELINE WITHOUT IS.  
10% UNDER 3'  
20% OVER 20'  
49' MAX. DEPTH

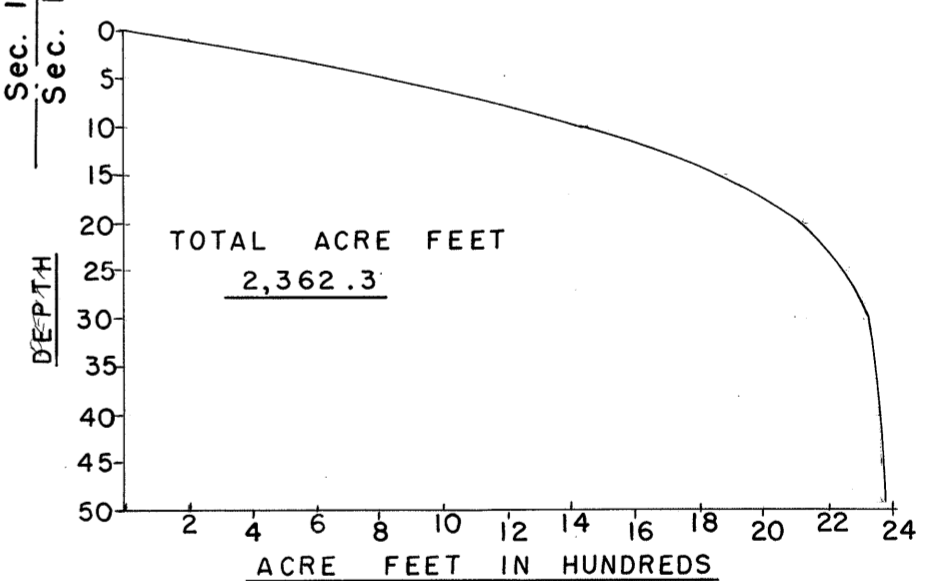

SPECIES OF FISH		
	Abundant	Rare
Muskie		
N. Pike	X	
Walleye		X
L.M. Bass	X	
S.M. Bass		
Panfish	X	
Trout		

LOST LAKE  
49.6 ACRES  
20' DEPTH

EQUIPMENT RECORDING SONAR MAPPED AUGUST 1967  
MO. YR.

- TOPOGRAPHIC SYMBOLS**
- (B) Brush
  - (PW) Partially wooded
  - (W) Wooded
  - (C) Cleared
  - (P) Pastured
  - (A) Agricultural
  - B.M. Bench Mark
  - Dwelling
  - Resort
  - ||||| Steep slope
  - - - Indefinite shoreline
  - Marsh
  - Spring
  - Intermittent stream
  - Permanent inlet
  - Permanent outlet
  - Dam
  - D.N.R. State owned land

- LAKE BOTTOM SYMBOLS**
- P. Peat
  - Gr. Gravel
  - Stumps & Snags
  - Mk. Muck
  - R. Rubble
  - Br. Bedrock
  - M. Marl
  - T Submergent vegetation
  - Sd. Sand
  - Emergent vegetation
  - St. Silt
  - Floating vegetation

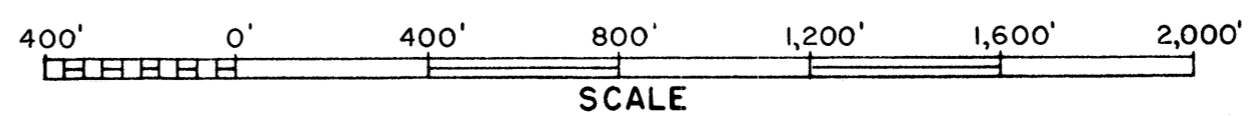

◇ Access      ◈ Access with Parking      ◆ Boat Livery  
Field work by C. Busch, N. Pokorney, L. Sather Drawn by: E. Eaton

(TOTALS) 290.1 WITH ISLAND  
AREA 261.5 ACRES  
UNDER 3FT. 9%  
OVER 20FT. 24%  
VOLUME 3,806.7 ACRE FT.  
TOTAL ALK. 13 P.P.M.  
SHORELINE 10.6 14.2 MILES WITH IS.  
MAX. DEPTH 62 FEET

Source: Wisconsin Department of Natural Resources 608-266-2621  
Spider Lake #3 - Washburn County, Wisconsin DNR Lake Map  
Date – Aug 1967 - Historical Lake Map - Not for Navigation  
A Public Document - Please Identify the Source when using it.