

LAKE SURVEY MAP

WISCONSIN CONSERVATION DEPARTMENT
BIOLOGY DIVISION
LAKE AND STREAM IMPROVEMENT SECTION

LAKE Ripley
SECTION 19-30
TOWNSHIP 38 N
RANGE 11 W
TOWN OF MADGE
COUNTY WASHBURN

FORM F1-117

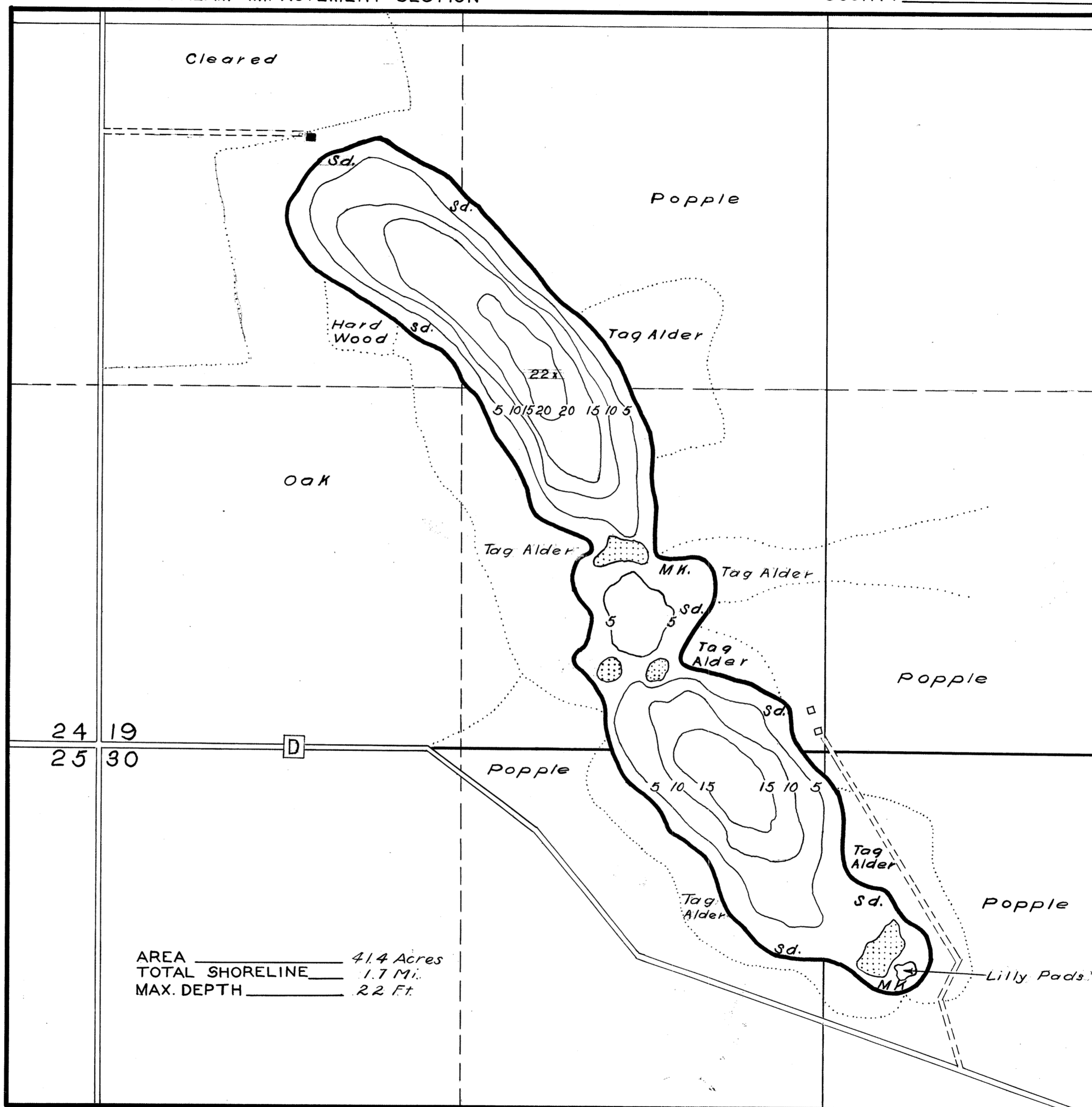

AREA _____ 41.4 Acres
TOTAL SHORELINE _____ 1.7 Mi.
MAX. DEPTH _____ 22 Ft.

DATE Nov. 14. 1939
COMPILED BY _____
TRACED BY R.C. (W.P.A.)
SOURCE OF INFORMATION
W.P.A. Lake Improvement Project
SOUNDINGS Intervals 150 Ft.
DATES OF MAP REVISION _____
WORK AGENCY W.P.A.

SCALE 1 inch Equal 330 Ft.

LAKE IMPROVEMENT RECORD

TYPE	DATE	_____	_____	_____	_____
⊗ BRUSH REFUGES	_____	_____	_____	_____	_____
~ SAPLING TANGLES	_____	_____	_____	_____	_____
□ SPAWNING BOXES	_____	_____	_____	_____	_____
* MINNOW SPAWNERS	_____	_____	_____	_____	_____
TOTAL	_____	_____	_____	_____	_____

LEGEND
 ⊗ WEED BEDS
 // ROCKY SHOALS
 sd. SAND
 cl. CLAY
 gr. GRAVEL
 MH. MUCK
 ■ DWELLINGS
 □ ABANDONED DWELLING
 ⊠ RESORT

Source: Wisconsin Department of Natural Resources 608-266-2621
Ripley Lake - Washburn County, Wisconsin DNR Lake Map
Date - Nov 1939 - Historical Lake Map - Not for Navigation
A Public Document - Please Identify the Source when using it.