

LAKE SURVEY MAP

LAKE METCALF & RAT
 SECTION 3-34
 TOWNSHIP 31-32 N
 RANGE 8 W
 TOWN OF CLEVELAND
 COUNTY CHIPPEWA

FORM FI-117

1/2 Mile N To M

WISCONSIN CONSERVATION DEPARTMENT
 BIOLOGY DIVISION
 LAKE AND STREAM IMPROVEMENT SECTION

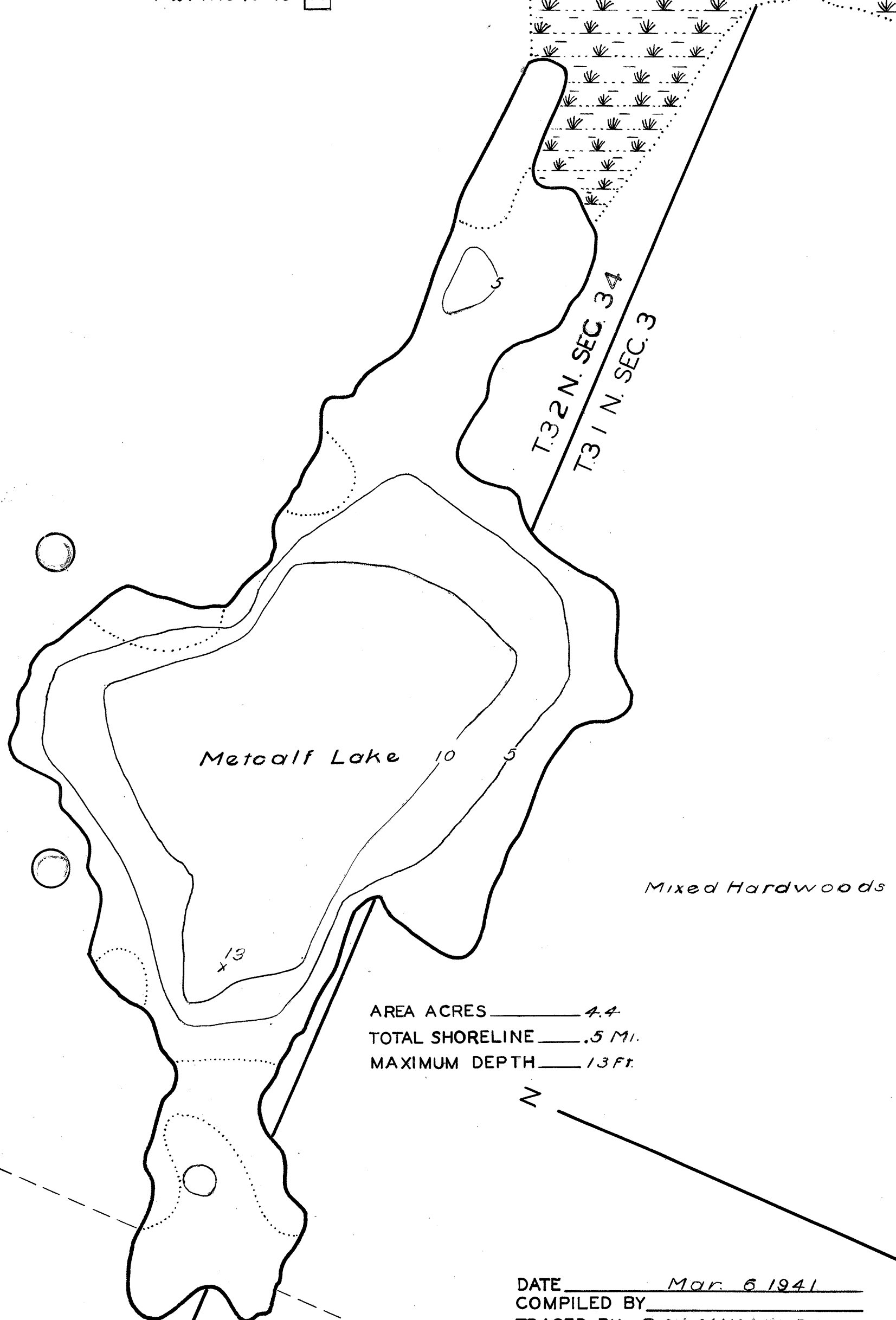

AREA ACRES 4.4
 TOTAL SHORELINE .5 Mi.
 MAXIMUM DEPTH 13 Ft.

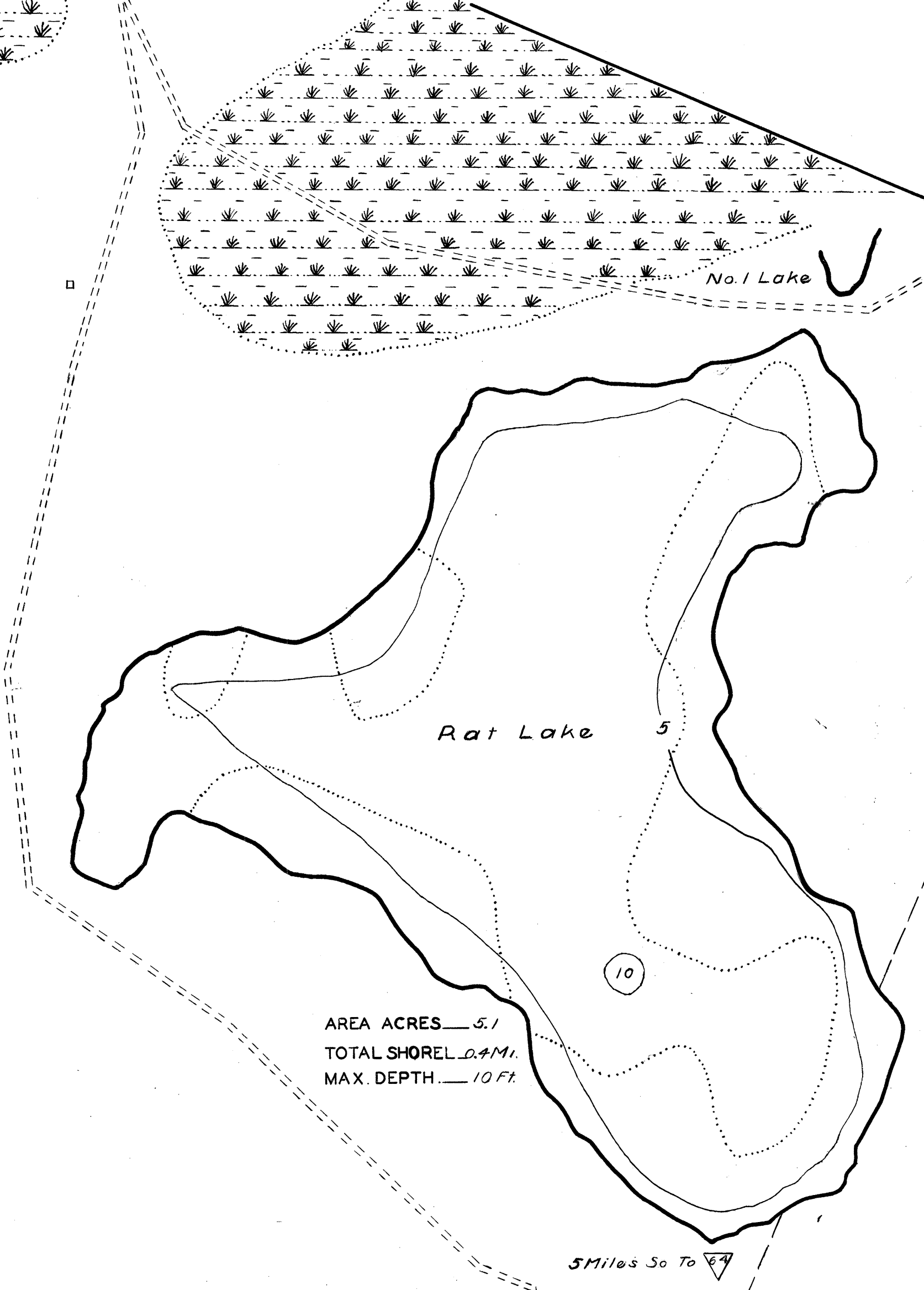

AREA ACRES 5.1
 TOTAL SHORELINE 0.9 Mi.
 MAX. DEPTH 10 Ft.

DATE Mar 6 1941
 COMPILED BY _____
 TRACED BY RA. M. M. (WPA)
 SOURCE OF INFORMATION W.P.A. Lake Survey
Project Jan 1941
 SOUNDINGS At 66" Intervals
 DATES OF MAP REVISION _____
 WORK AGENCY W.P.A.

5 Mi. W To 40

CHECKED BY
 W.P.S.-C.E.V.
 6-11-41

LAKE IMPROVEMENT RECORD

TYPE	DATE			
⊕ BRUSH REFUGES				
~ SAPLING TANGLES				
□ SPAWNING BOXES				
* MINNOW SPAWNERS				
TOTAL				

SCALE 1 inch Equals 82 1/2"



- LEGEND
- WEED BEDS
 - ROCKY SHOALS
 - SAND
 - CLAY
 - GRAVEL
 - MUCK
 - DWELLING
 - ABANDONED DWELLING
 - RESORT

Source: Wisconsin Department of Natural Resources 608-266-2621
Rat Lake – Chippewa County, Wisconsin DNR Lake Map
Date – Mar 1941 - Historical Lake Map - Not for Navigation
A Public Document - Please Identify the Source when using it.