

# LAKE SURVEY MAP

WISCONSIN CONSERVATION DEPARTMENT  
BIOLOGY DIVISION  
LAKE AND STREAM IMPROVEMENT SECTION

LAKE NUT  
SECTION 6  
TOWNSHIP 31 N  
RANGE 7 W  
TOWN OF CLEVELAND  
COUNTY CHIPPEWA

FORM FI-117

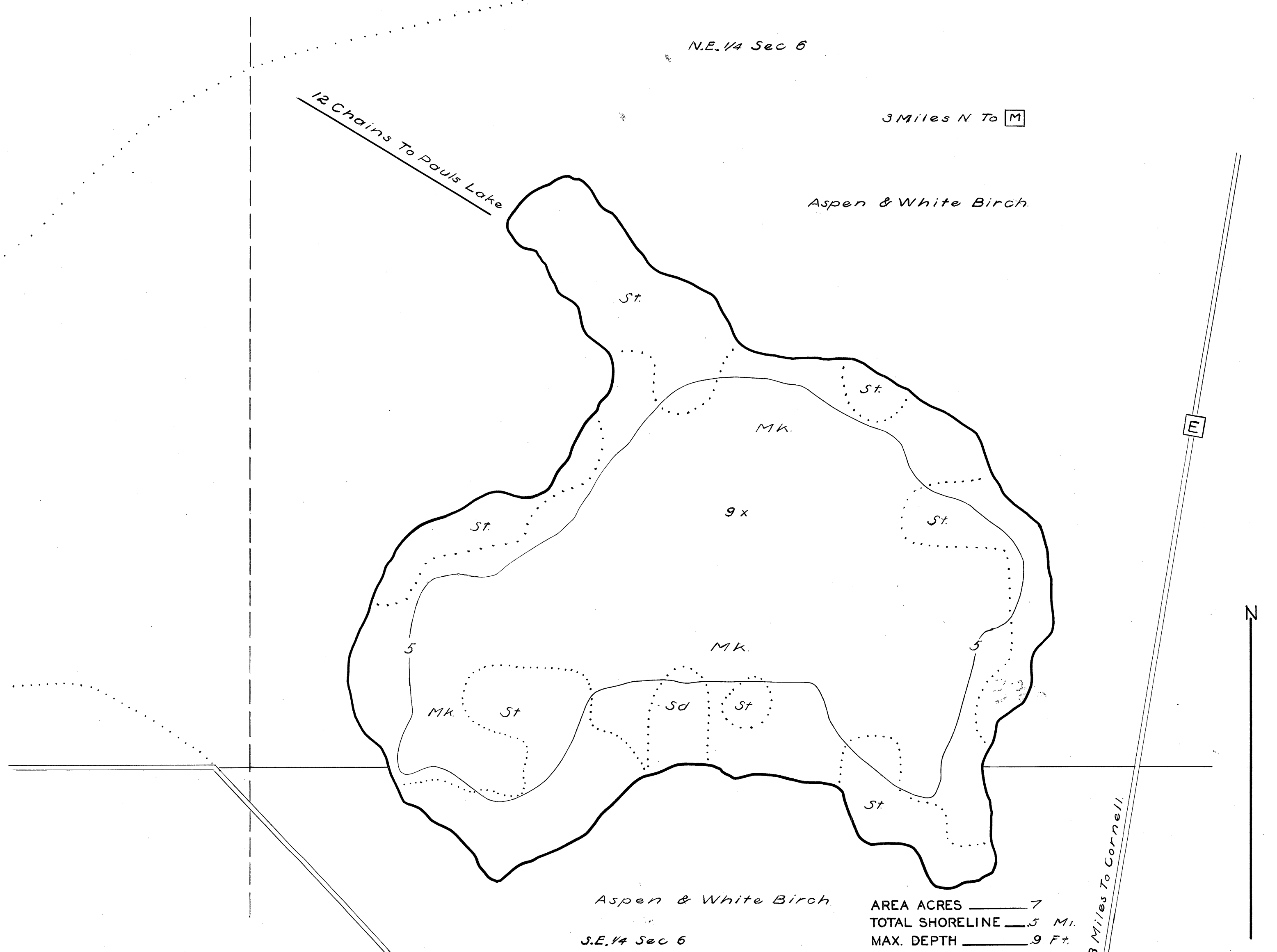

Aspen & White Birch  
S.E. 1/4 Sec 6

AREA ACRES 7  
TOTAL SHORELINE .5 MI.  
MAX. DEPTH 9 FT.

DATE April 9 1941  
COMPILED BY \_\_\_\_\_  
TRACED BY N.L.M. (W.P.A.)  
SOURCE OF INFORMATION W.P.A. Lake Survey Project  
SOUNDINGS At 66 Ft. Intervals  
DATES OF MAP REVISION \_\_\_\_\_  
WORK AGENCY W. P. A.

*CHECKED BY  
K.P.S - E.M.W.  
6-13-41*

LAKE IMPROVEMENT RECORD				LEGEND	
TYPE	DATE	_____	_____	_____	_____
⊕	BRUSH REFUGES	_____	_____	⊙	WEED BEDS
~	SAPLING TANGLES	_____	_____	⊙	ROCKY SHOALS
□	SPAWNING BOXES	_____	_____	Sd	SAND
*	MINNOW SPAWNERS	_____	_____	Cl	CLAY
TOTAL _____				Gr	GRAVEL
				Mk	MUCK
				■	DWELLING
				□	ABANDONED DWELLING
				■	RESORT
				St	SPW.

SCALE 1 inch Equals 82 1/2 Ft.

Source: Wisconsin Department of Natural Resources 608-266-2621  
Nut Lake – Chippewa County, Wisconsin DNR Lake Map  
Date – Apr 1941 - Historical Lake Map - Not for Navigation  
A Public Document - Please Identify the Source when using it.