

B.M. 'X' Square cut in base of pump at
wayside N. of county "Hy A", 105' N. of
centerline of county "Hy A" and 145' N. of
waters edge at access of lake
Access elevation 100.00'
Water level 93.63'

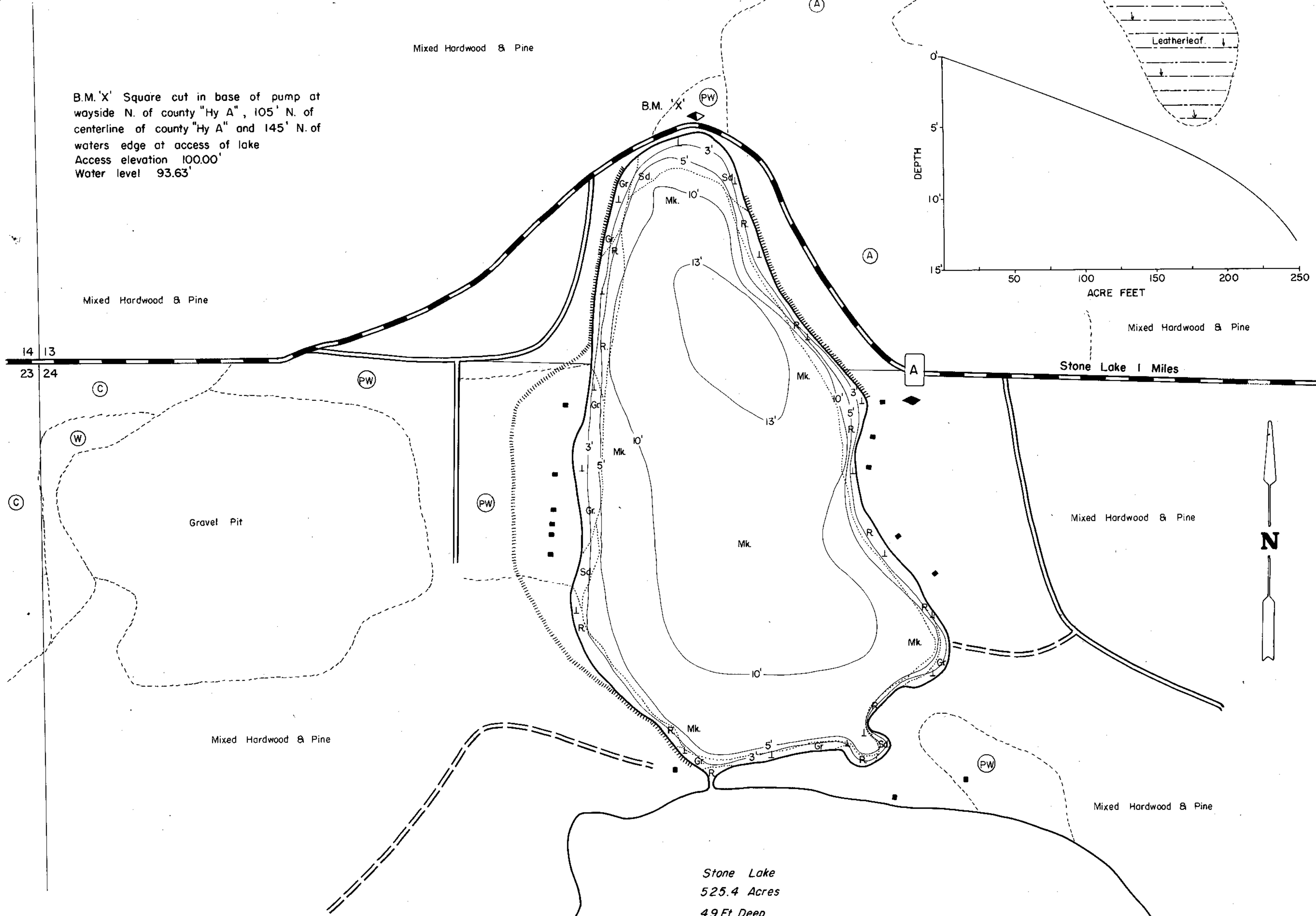
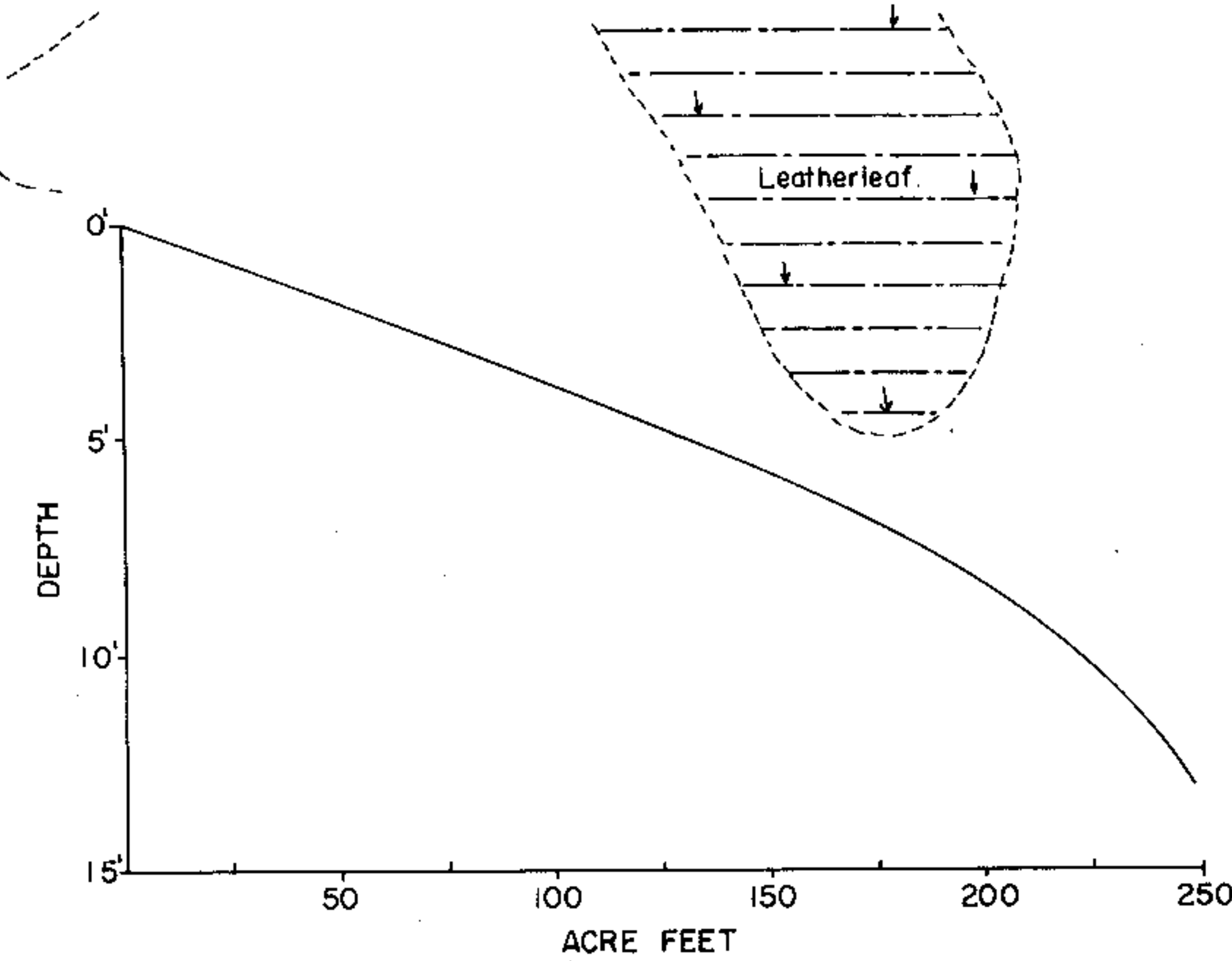

Stone Lake 1 Miles

Stone Lake
525.4 Acres
49 Ft. Deep

EQUIPMENT RECORDING SONAR MAPPED JUNE 1969

TOPOGRAPHIC SYMBOLS		LAKE BOTTOM SYMBOLS	
(B) Brush	() Steep slope	P. Peat	B Boulders
(PW) Partially wooded	(---) Indefinite shoreline	Mk. Muck	o Stumps & Snags
(W) Wooded	(---) Marsh	C. Clay	⊗ Rock danger to navigation
(C) Cleared	(---) Spring	M. Marl	T Submergent vegetation
(P) Pastured	(---) Intermittent stream	Sd. Sand	L Emergent vegetation
(A) Agricultural	(---) Permanent inlet	St. Silt	⊥ Floating vegetation
B.M. Bench Mark	(---) Permanent outlet	Gr. Gravel	⊕ Brush shelters
■ Dwelling	(---) Dam	R. Rubble	
□ Resort	(---) D.N.R. State owned land	Br. Bedrock	
⊠ Camp			

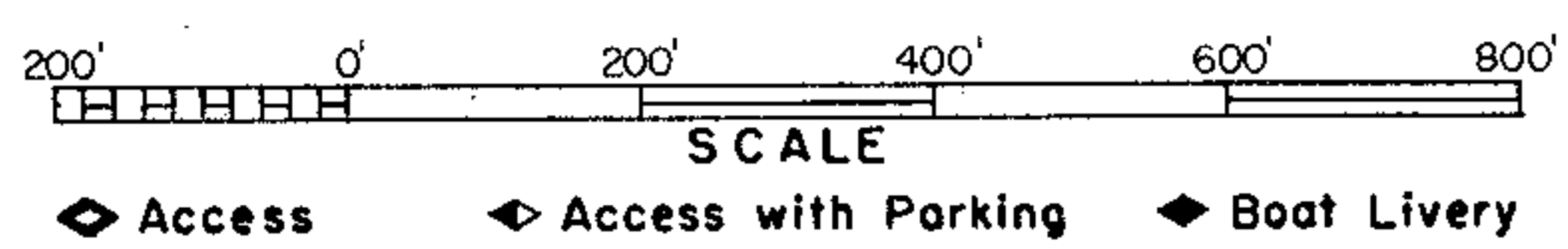

Drawn by: C. Holt
Field work by: C. Busch, C. Beller, S. Johannes.

SPECIES OF FISH	ABUNDANCE		
	Abundant	Common	Present
Muskie			
N. Pike			X
Walleye	X		
L. M. Bass	X		
S. M. Bass	X		
Panfish	X		
Trout			

WATER AREA 27.0 ACRES
UNDER 3 FT. 5 %
OVER 20 FT. 0 %
MAX. DEPTH 13 FEET.
TOTAL ALK. 16 P.P.M.
VOLUME 248.9 ACRE FT.
SHORELINE 0.91 MILES

Source: Wisconsin Department of Natural Resources 608-266-2621
Little Stone Lake - Washburn County, Wisconsin DNR Lake Map
Date – Jun 1969 - Historical Lake Map - Not for Navigation
A Public Document - Please Identify the Source when using it.