

LAKE SURVEY MAP

B.M. 'X' D.N.R. 1362-A Square cut in 4'x5' boulder 54' N. of house, 65' W of water, on W. side of lake
Assumed elevation 10000'
Water level 95.34'

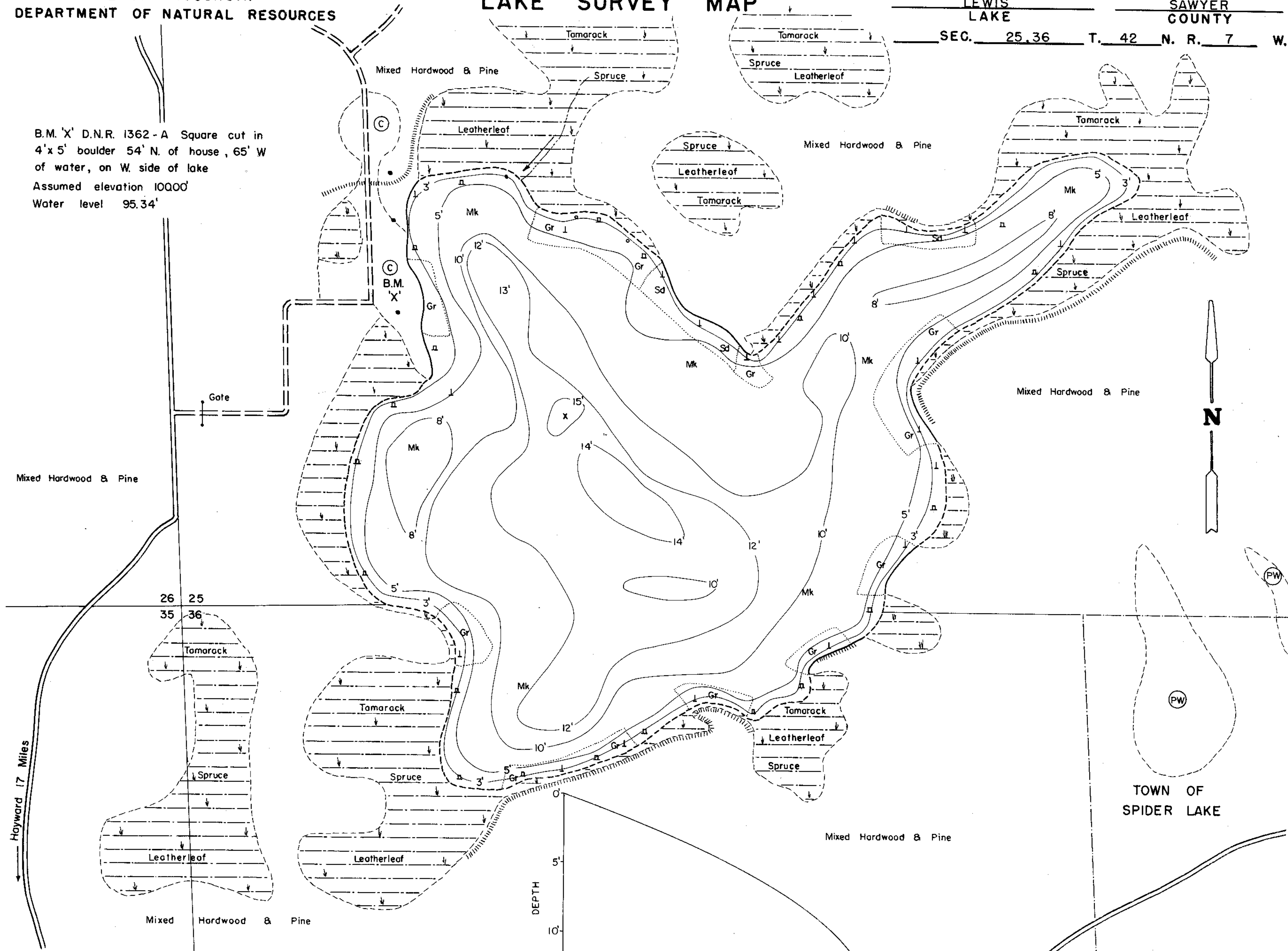

EQUIPMENT RECORDING SONAR MAPPED

OCT. 1972
MONTH YEAR
LAKE BOTTOM SYMBOLS

- TOPOGRAPHIC SYMBOLS**
- (B) Brush
 - (PW) Partially wooded
 - (W) Wooded
 - (C) Cleared
 - (P) Pastured
 - (A) Agricultural
 - B.M. Bench Mark
 - Dwelling
 - Resort
 - Camp
 - ||||| Steep slope
 - - - Indefinite shoreline
 - Marsh
 - Spring
 - Intermittent stream
 - Permanent inlet
 - Permanent outlet
 - Dam
 - D.N.R. State owned land

- P. Peat
- Mk. Muck
- C. Clay
- M. Marl
- Sd. Sand
- St. Silt
- Gr. Gravel
- R. Rubble
- Br. Bedrock
- B Boulders
- Stumps & Snags
- Rock danger to navigation
- T Submergent vegetation
- Emergent vegetation
- Floating vegetation
- Brush shelters

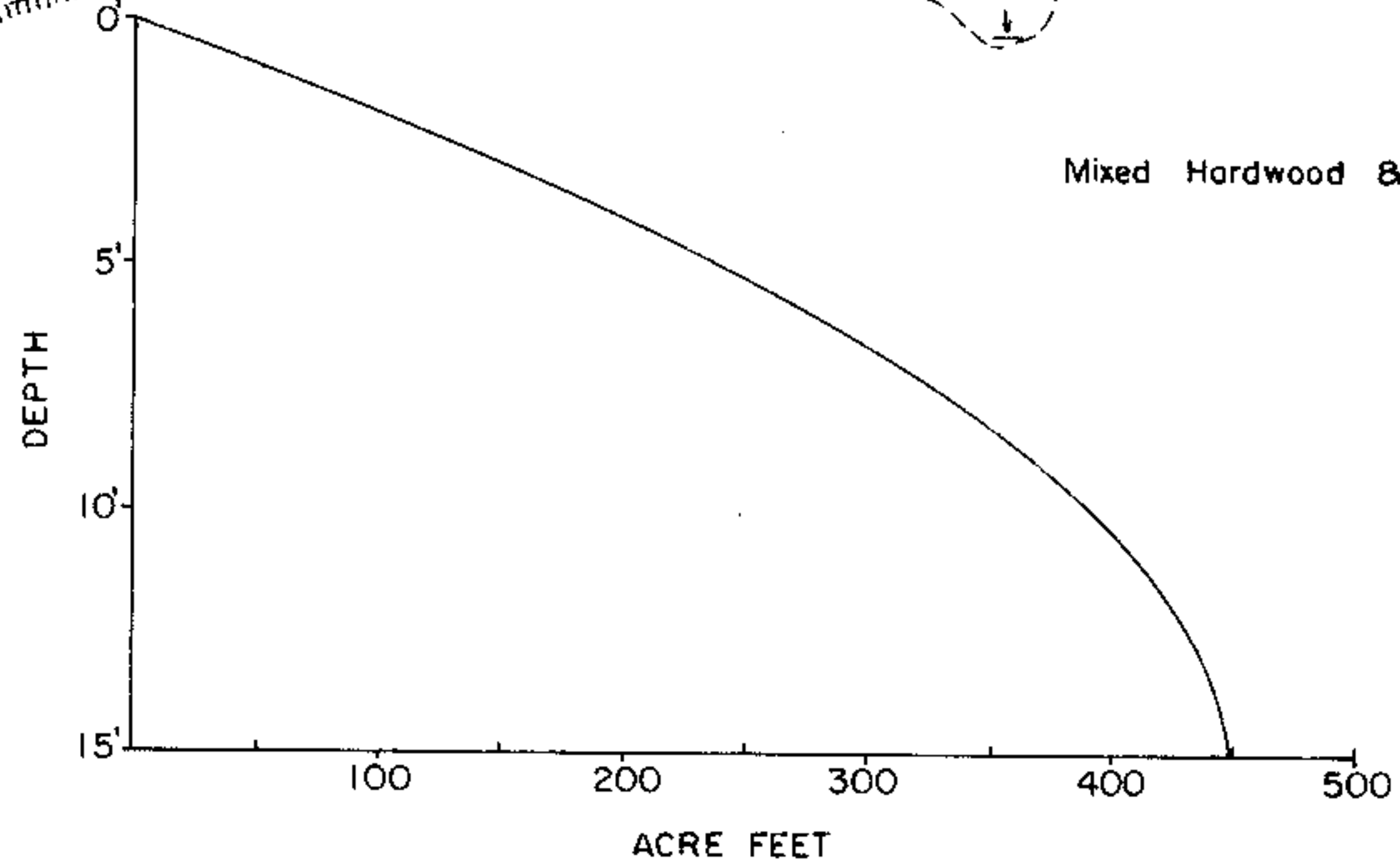

◆ Access ◆ Access with Parking ◆ Boat Livery

Drawn by: C. Holt
Field work by: C. Busch, G. Lund, L. Sother

SPECIES OF FISH	ABUNDANCE		
	Abundant	Common	Present
Muskie			
N. Pike			
Walleye	X		
L.M. Bass	X		
S.M. Bass			
Panfish	X		
Trout			

WATER AREA 51.7 ACRES
UNDER 3 FT. 7 %
OVER 20 FT. 0 %
MAX. DEPTH 15 FEET.
TOTAL ALK. 11 P.P.M.
VOLUME 449 ACRE FT.
SHORELINE 1.48 MILES

Source: Wisconsin Department of Natural Resources 608-266-2621
Lewis Lake – Sawyer County, Wisconsin DNR Lake Map
Date – Oct 1972 - Historical Lake Map - Not for Navigation
A Public Document - Please Identify the Source when using it.