

# LAKE SURVEY MAP

LAKE HARWOOD 1-2-3-4  
 SECTION 26-35  
 TOWNSHIP 32 N  
 RANGE 8 W  
 TOWN OF SAMPSON  
 COUNTY CHIPPewa

FORM FH17

WISCONSIN CONSERVATION DEPARTMENT  
 BIOLOGY DIVISION  
 LAKE AND STREAM IMPROVEMENT SECTION

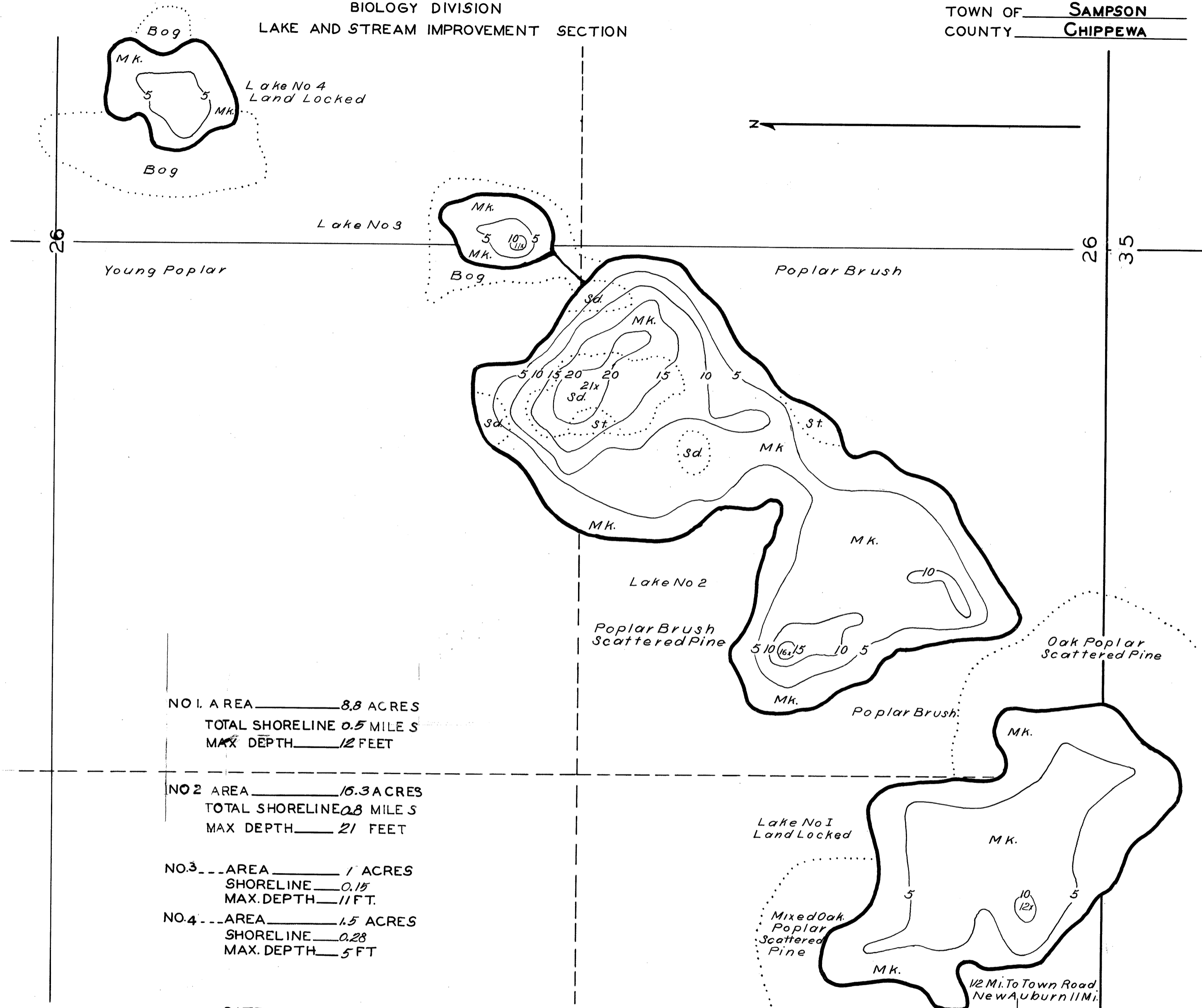

NO. 1 AREA 8.8 ACRES  
 TOTAL SHORELINE 0.5 MILE S  
 MAX. DEPTH 12 FEET

NO. 2 AREA 16.3 ACRES  
 TOTAL SHORELINE 0.8 MILE S  
 MAX. DEPTH 21 FEET

NO. 3 AREA 1 ACRES  
 SHORELINE 0.15  
 MAX. DEPTH 11 FT.

NO. 4 AREA 1.5 ACRES  
 SHORELINE 0.28  
 MAX. DEPTH 5 FT.

DATE March 29 1940  
 COMPILED BY \_\_\_\_\_  
 TRACED BY R.C. (W.P.A.)  
 SOURCE OF INFORMATION \_\_\_\_\_  
W.P.A. Lake Survey Project

SOUNDINGS At 6-3 Rod Intervals

DATES OF MAP REVISION \_\_\_\_\_

WORK AGENCY W.P.A.

CHECKED BY W.P.S.  
3-20-41

### LAKE IMPROVEMENT RECORD

TYPE	DATE			
BRUSH REFUGES				
SAPLING TANGLES				
SPAWNING BOXES				
* MINNOW SPAWNERS				
TOTAL				

SCALE 1 inch Equal 200 Ft.



### LEGEND

- BRUSH REFUGES
- SAPLING TANGLES
- SPAWNING BOXES
- \* MINNOW SPAWNERS
- WEED BEDS
- ROCKY SHOALS
- Sd.* SAND
- Cl.* CLAY
- Gr.* GRAVEL
- Mk.* MUCK
- DWELLING
- ABANDONED DWELLING
- RESORT
- St.* SILT

Source: Wisconsin Department of Natural Resources 608-266-2621  
Harwood Lake No.3 – Chippewa County, Wisconsin DNR Lake Map  
Date – Mar 1940 - Historical Lake Map - Not for Navigation  
A Public Document - Please Identify the Source when using it.