

LAKE SURVEY MAP

LAKE HARWOOD 1-2-3-4
 SECTION 26-35
 TOWNSHIP 32 N
 RANGE 8 W
 TOWN OF SAMPSON
 COUNTY CHIPPEWA

FORM FH17

WISCONSIN CONSERVATION DEPARTMENT
 BIOLOGY DIVISION
 LAKE AND STREAM IMPROVEMENT SECTION

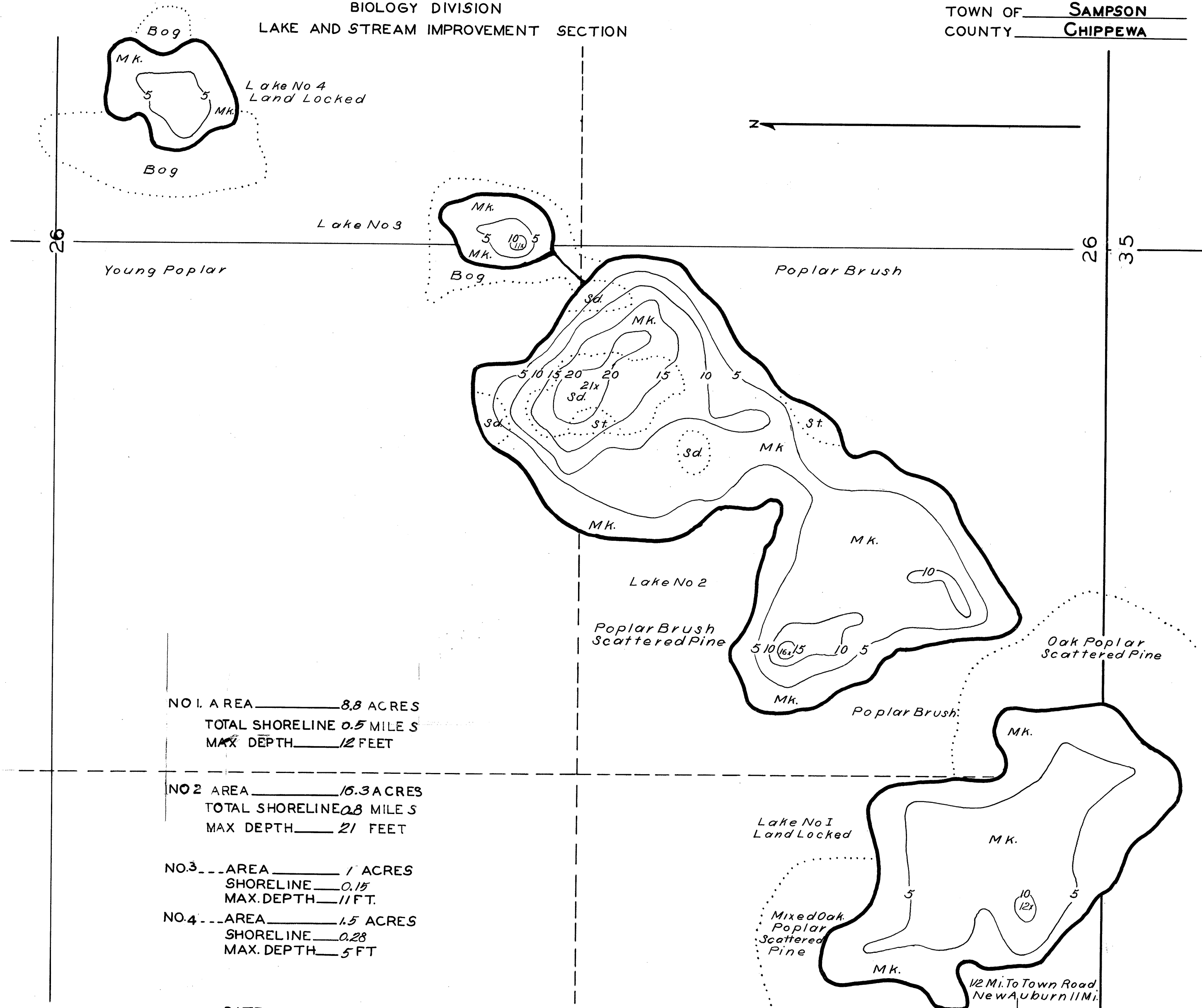

NO. 1 AREA 8.8 ACRES
 TOTAL SHORELINE 0.5 MILE S
 MAX. DEPTH 12 FEET

NO. 2 AREA 16.3 ACRES
 TOTAL SHORELINE 0.8 MILE S
 MAX. DEPTH 21 FEET

NO. 3 AREA 1 ACRES
 SHORELINE 0.15
 MAX. DEPTH 11 FT.

NO. 4 AREA 1.5 ACRES
 SHORELINE 0.28
 MAX. DEPTH 5 FT.

DATE March 29 1940
 COMPILED BY _____
 TRACED BY R.C. (W.P.A.)
 SOURCE OF INFORMATION _____
W.P.A. Lake Survey Project

SOUNDINGS At 6-3 Rod Intervals

DATES OF MAP REVISION _____

WORK AGENCY W.P.A.

CHECKED BY W.P.S.
3-20-41

LAKE IMPROVEMENT RECORD

TYPE	DATE			
BRUSH REFUGES				
SAPLING TANGLES				
SPAWNING BOXES				
* MINNOW SPAWNERS				
TOTAL				

SCALE 1 inch Equal 200 Ft.



LEGEND

- BRUSH REFUGES
- SAPLING TANGLES
- SPAWNING BOXES
- * MINNOW SPAWNERS
- WEED BEDS
- ROCKY SHOALS
- Sd. SAND
- Cl. CLAY
- Gr. GRAVEL
- Mk. MUCK
- DWELLING
- ABANDONED DWELLING
- RESORT
- St. SILT

Source: Wisconsin Department of Natural Resources 608-266-2621
Harwood Lake No.2 – Chippewa County, Wisconsin DNR Lake Map
Date – Mar 1940 - Historical Lake Map - Not for Navigation
A Public Document - Please Identify the Source when using it.