

LAKE SURVEY MAP

WISCONSIN CONSERVATION DEPARTMENT
BIOLOGY DIVISION
LAKE AND STREAM IMPROVEMENT SECTION

LAKE EVANS
SECTION 15
TOWNSHIP 31 N
RANGE 8 W
TOWN OF CLEVELAND
COUNTY CHIPPEWA

FORM EI-117

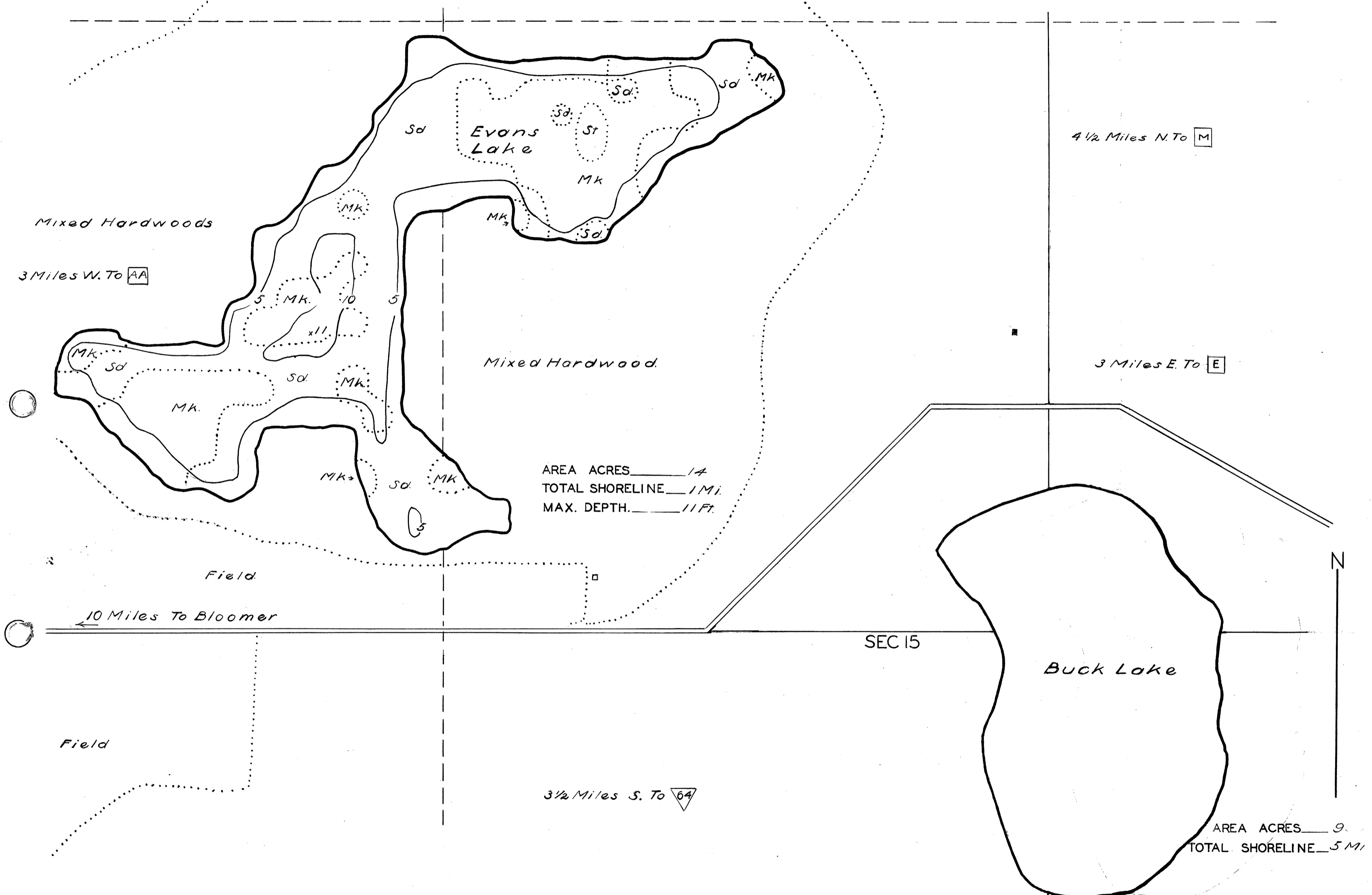

AREA ACRES 14
TOTAL SHORELINE 1 MI.
MAX. DEPTH. 11 FT.

AREA ACRES 9
TOTAL SHORELINE 5 MI.

DATE Mar 31 1941
COMPILED BY _____
TRACED BY RA-NLM (WPA)
SOURCE OF INFORMATION WPA Lake Survey Project
SOUNDINGS At 66 Ft Intervals

DATES OF MAP REVISION _____

WORK AGENCY W. P. A.

*RECEIVED BY
W.P.S. - E.M.K.
6-11-41*

LAKE IMPROVEMENT RECORD			
TYPE	DATE		
⊗ BRUSH REFUGES	_____	_____	_____
~ SAPLING TANGLES	_____	_____	_____
□ SPAWNING BOXES	_____	_____	_____
* MINNOW SPAWNERS	_____	_____	_____

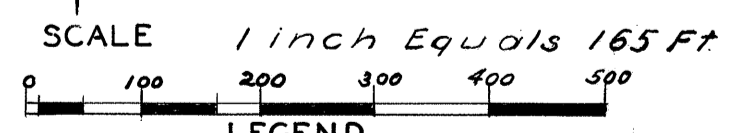

- LEGEND
- ⊗ WEED BEDS
 - ~ ROCKY SHOALS
 - Sd SAND
 - Cl CLAY
 - Gr GRAVEL
 - Mk MUCK
 - DWELLING
 - ABANDONED DWELLING
 - ▣ RESORT
 - St Silt

Source: Wisconsin Department of Natural Resources 608-266-2621
Evans Lake – Chippewa County, Wisconsin DNR Lake Map
Date – Mar 1941 - Historical Lake Map - Not for Navigation
A Public Document - Please Identify the Source when using it.