

LAKE SURVEY MAP

WISCONSIN CONSERVATION DEPARTMENT
 BIOLOGY DIVISION
 LAKE AND STREAM IMPROVEMENT SECTION

LAKE CLEAR
 SECTION 23
 TOWNSHIP 31 N
 RANGE 8 W
 TOWN OF CLEVELAND
 COUNTY CHIPPEWA

FORM FH17

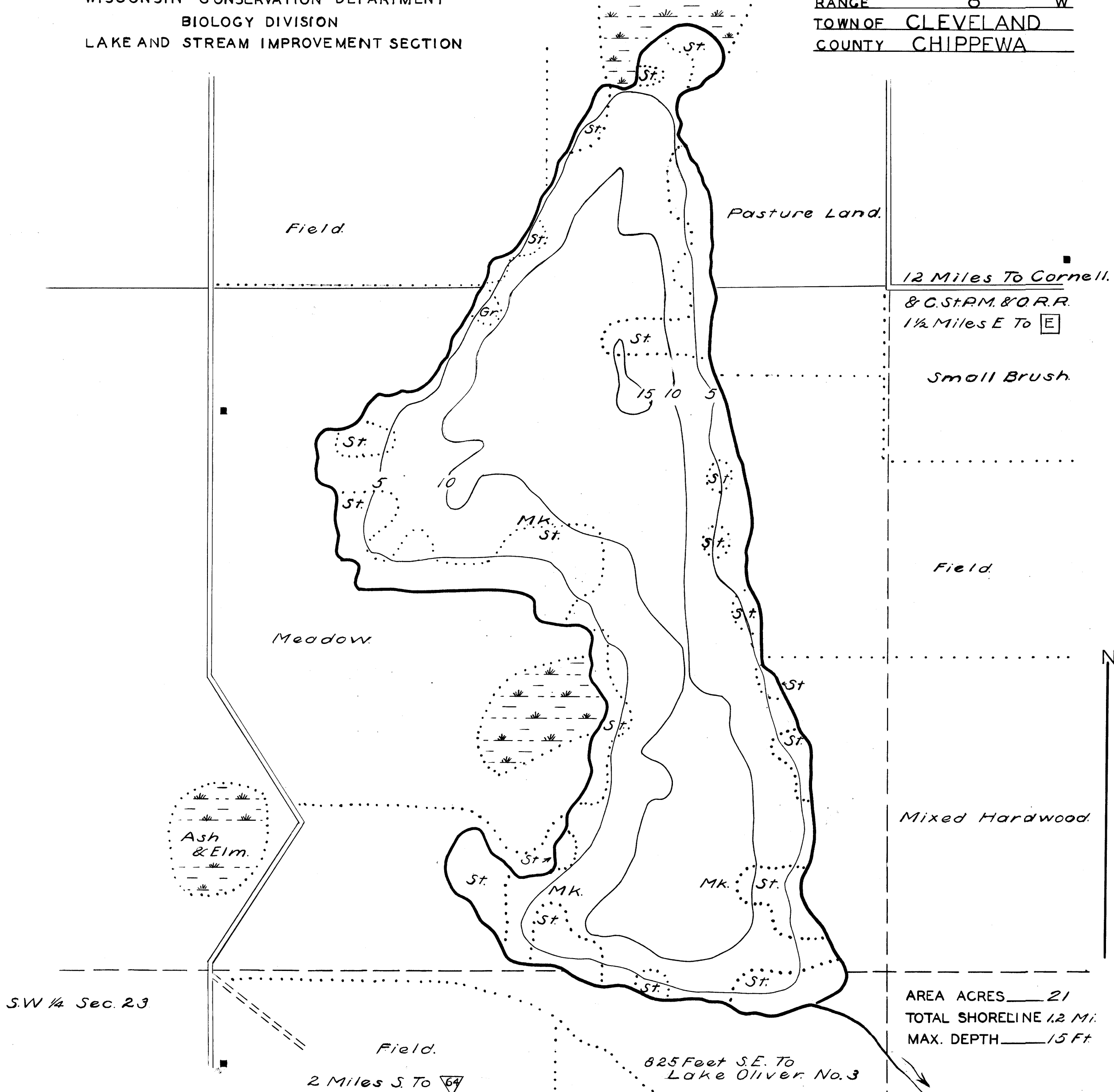

S.W. 1/4 Sec. 23

AREA ACRES 21
 TOTAL SHORELINE 1.2 Mi.
 MAX. DEPTH 15 Ft.

DATE April 7 1941
 COMPILED BY _____
 TRACED BY R.A. NLM (WPA)
 SOURCE OF INFORMATION
WPA Lake Survey
Project
 SOUNDINGS At 66 Ft Intervals
 DATES OF MAP REVISION _____
 WORK AGENCY W. P. A.

LAKE IMPROVEMENT RECORD

TYPE	DATE				
⊕ BRUSH REFUGES	—	—	—	—	—
~ SAPLING TANGLES	—	—	—	—	—
□ SPAWNING BOXES	—	—	—	—	—
* MINNOW SPAWNERS	—	—	—	—	—
TOTAL	—	—	—	—	—

SCALE 1 inch Equals 165.
 0 50 100 200 300 400 500

LEGEND
 ○ WEED BEDS
 ⊛ ROCKY SHOALS
 Sd. SAND
 Cl. CLAY
 Gr. GRAVEL
 Mk. MUCK
 ■ DWELLING
 □ ABANDONED DWELLING
 ◻ RESORT
 St. SILT

Source: Wisconsin Department of Natural Resources 608-266-2621
Clear Lake – Chippewa County, Wisconsin DNR Lake Map
Date – Apr 1941 - Historical Lake Map - Not for Navigation
A Public Document - Please Identify the Source when using it.