

LAKE SURVEY MAP

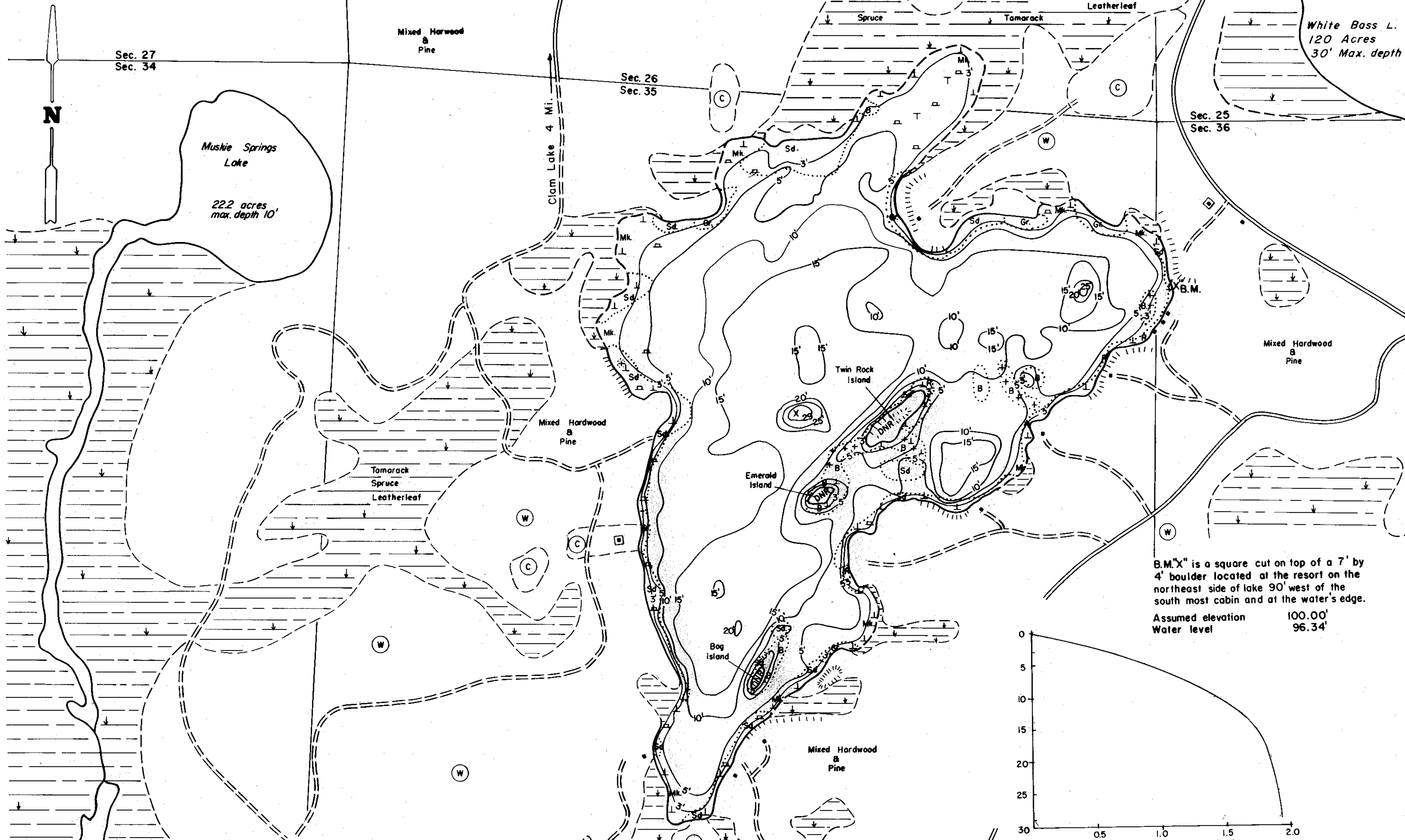

B.M. "X" is a square cut on top of a 7' by 4' boulder located at the resort on the northeast side of lake 90' west of the south most cabin and at the water's edge.
Assumed elevation 100.00'
Water level 96.34'

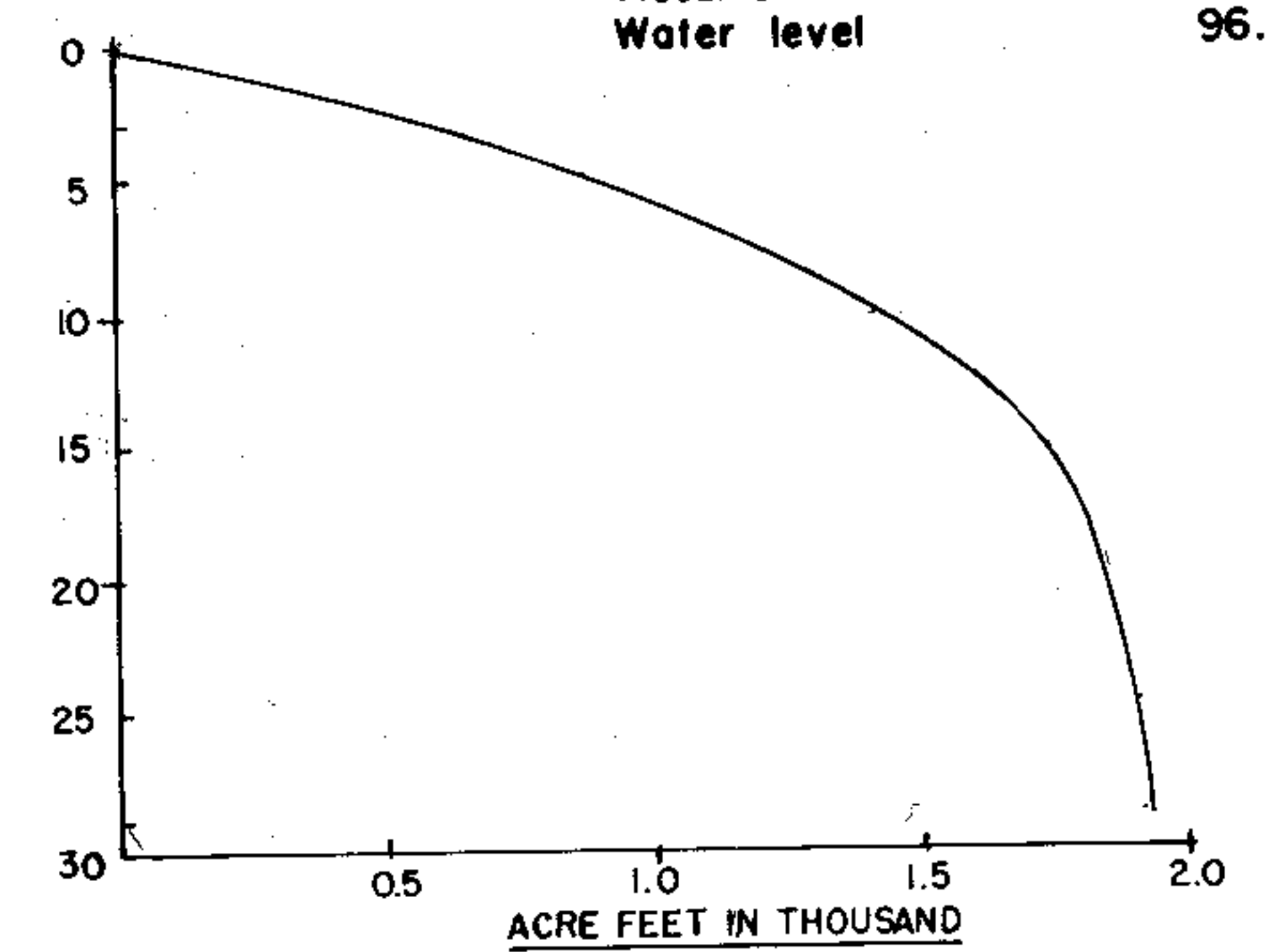

EQUIPMENT RECORDING SONAR MAPPED SEPT. 1976
MONTH YEAR

- | TOPOGRAPHIC SYMBOLS | | LAKE BOTTOM SYMBOLS | |
|-----------------------|----------------------------|---------------------|---------------------------|
| (B) Brush | Steep slope | P. Peat | B. Boulders |
| (PW) Partially wooded | - - - Indefinite shoreline | Mk. Muck | o Stumps & Snags |
| (W) Wooded | Marsh | C. Clay | Rock danger to navigation |
| (C) Cleared | Spring | M. Marl | T Submergent vegetation |
| (P) Pastured | Intermittent stream | Sd. Sand | I Emergent vegetation |
| (A) Agricultural | Permanent inlet | St. Silt | F Floating vegetation |
| B.M. Bench Mark | Permanent outlet | Gr. Gravel | Brush shelters |
| Dwelling | Dam | R. Rubble | |
| Resort | D.N.R. State owned land | Br. Bedrock | |



Drawn by R. Williams
Field work by C. Busch, K. Cable, L. Sather

SPECIES OF FISH	Abundance		
	Abundant	Common	Present
Muskie		X	
N. Pike			X
Walleye			X
L.M. Bass		X	
S.M. Bass			X
Panfish	X		
Trout			

WATER AREA	179.4	ACRES
UNDER 3 FT.	8	%
OVER 20 FT.	1	%
MAX. DEPTH	29	FEET.
TOTAL ALK.	4	P.P.M.
VOLUME	1853.5	ACRE FT.
MAIN SHORELINE	2.96	MI.
ISLAND SHORELINE	.37	MI.

Source: Wisconsin Department of Natural Resources 608-266-2621
Buffalo Lake – Bayfield County, Wisconsin DNR Lake Map
Date – Sep 1976 - Historical Lake Map - Not for Navigation
A Public Document - Please Identify the Source when using it.