

LAKE SURVEY MAP

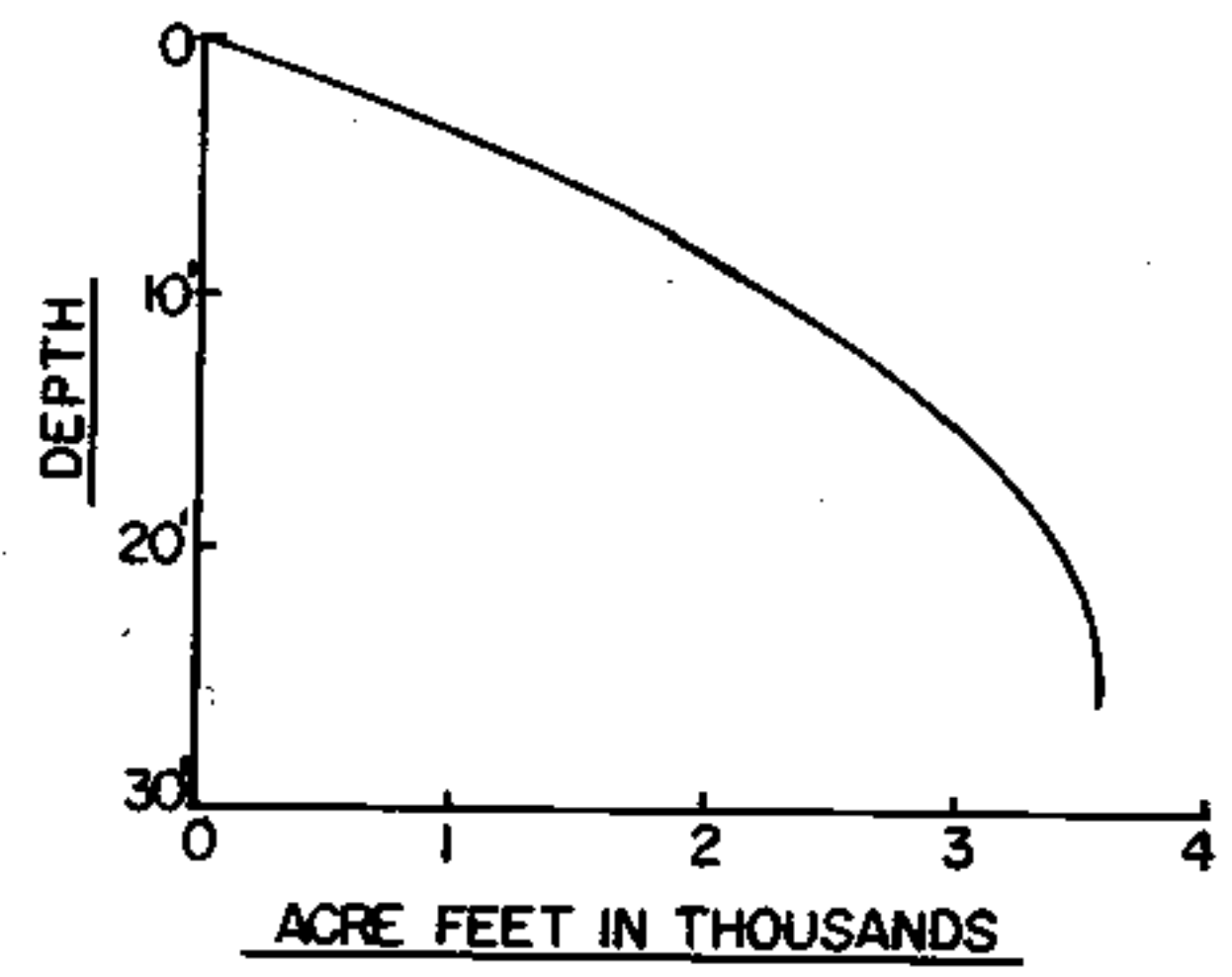

- EQUIPMENT RECORDING SONAR MAPPED JULY 1968
- | TOPOGRAPHIC SYMBOLS | | LAKE BOTTOM SYMBOLS | |
|----------------------|-------------------------------|---------------------|-----------------------------|
| (B) Brush | () Steep slope | P. Peat | B Boulders |
| (W) Partially wooded | (---) Indefinite shoreline | Mk. Muck | ⚬ Stumps & Snags |
| (W) Wooded | (---) Marsh | C. Clay | ⚬ Rock danger to navigation |
| (C) Cleared | (---) Spring | M. Marl | T Submergent vegetation |
| (P) Pastored | (---) Intermittent stream | Sd. Sand | ⚬ Emergent vegetation |
| (A) Agricultural | (---) Permanent inlet | St. Silt | ⚬ Floating vegetation |
| D.M. Beach Mark | (---) Permanent outlet | Gr. Gravel | ⚬ Brush shelters |
| (■) Dwelling | (---) Dam | R. Rubble | |
| (■) Resort | (---) D.N.R. State owned land | Bc Bedrock | |
| (■) Camp | | | |

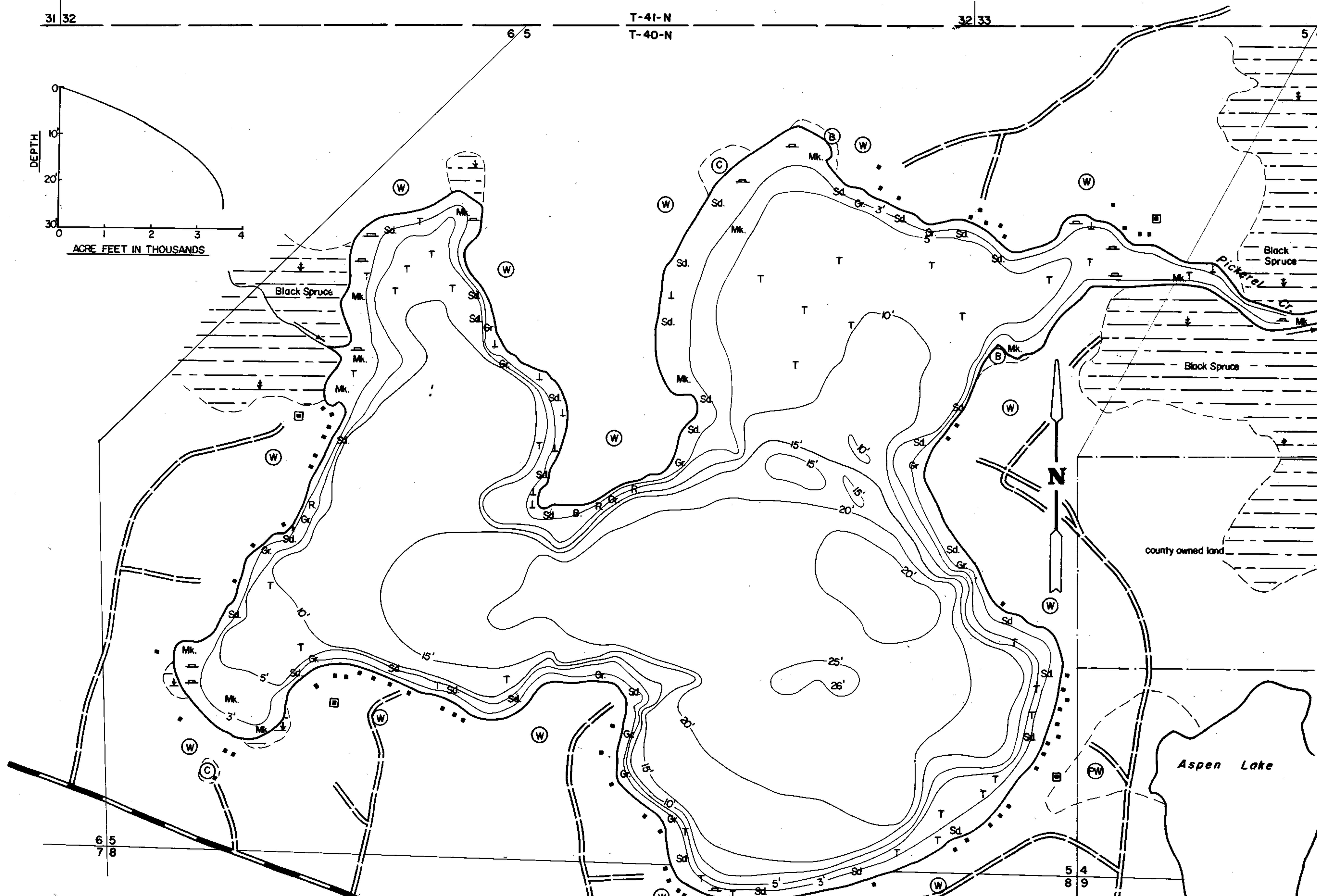
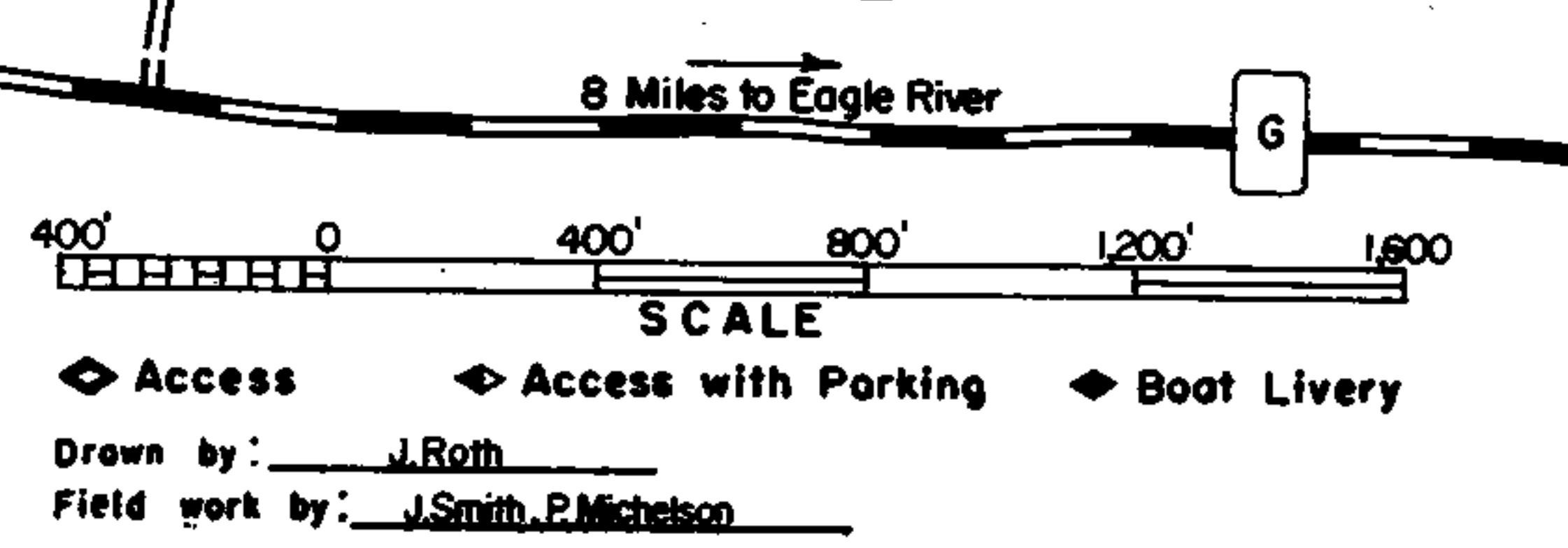

SPECIES OF FISH	ABUNDANCE		
	Abundant	Common	Present
Muskie		X	
N. Pike	X	X	
Walleye	X	X	
L.M. Bass	X	X	
S.M. Bass	X	X	
Perch	X		
Trout			

WATER AREA 293.0 ACRES
 UNDER 3 FT. 13 %
 OVER 20 FT. 23 %
 MAX. DEPTH 26 FEET.
 TOTAL ALK. 36 P.P.M.
 VOLUME 3,555.3 ACRE FT.
 SHORELINE 4.4 MILES

Source: Wisconsin Department of Natural Resources 608-266-2621
Pickerel Lake - Vilas County, Wisconsin DNR Lake Map
Date – Jul 1968 - Historical Lake Map - Not for Navigation
A Public Document - Please Identify the Source when using it.