

LAKE SURVEY MAP

WISCONSIN CONSERVATION DEPARTMENT
BIOLOGY DIVISION
LAKE AND STREAM IMPROVEMENT SECTION

LAKE LONESTONE
SECTION 11.14
TOWNSHIP 39 N
RANGE 11 E
TOWN OF THREE LAKES
COUNTY ONEIDA

FORM FI-117

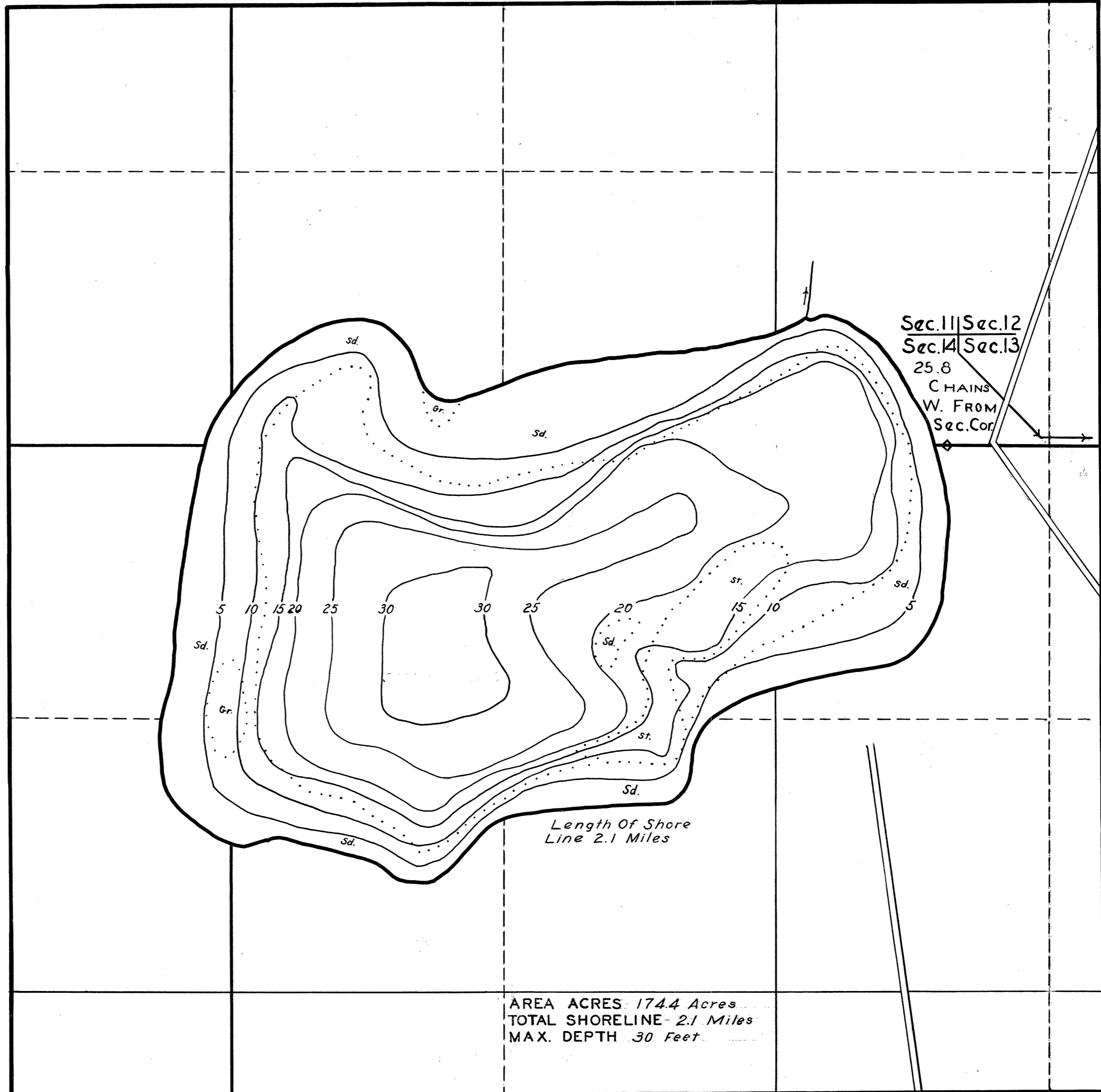

DATE July.13. 1939
COMPILED BY _____
TRACED BY R.F.F.
SOURCE OF INFORMATION
U.S. Forest Service Lake And Stream Survey
SOUNDINGS At 5' Intervals
U.S. Forest Service Lake And Stream Survey
DATES OF MAP REVISION _____
WORK AGENCY _____

SCALE: 1" = 440 ft.

LAKE IMPROVEMENT RECORD

TYPE	DATE	_____	_____	_____
⊗ BRUSH REFUGES	_____	_____	_____	_____
~ SAPLING TANGLES	_____	_____	_____	_____
□ SPAWNING BOXES	_____	_____	_____	_____
* MINNOW SPAWNERS	_____	_____	_____	_____
TOTAL	_____	_____	_____	_____

LEGEND

- ⊗ WEED BEDS
- ⊗ ROCKY SHOALS
- sd. SAND
- cl. CLAY
- gr. GRAVEL
- mk. MUCK
- DWELLING
- ABANDONED DWELLING
- ⊗ RESORT

Source: Wisconsin Department of Natural Resources 608-266-2621
Lonestone Lake – Oneida County, Wisconsin DNR Lake Map
Date – Jul 1939 - Historical Lake Map - Not for Navigation
A Public Document - Please Identify the Source when using it.