

LAKE SURVEY MAP

WISCONSIN CONSERVATION DEPARTMENT
BIOLOGY DIVISION
LAKE AND STREAM IMPROVEMENT SECTION

LAKE VENUS
SECTION 30
TOWNSHIP 36 N
RANGE 11 E
TOWN OF MONICO
COUNTY ONEIDA

FORM FI-117

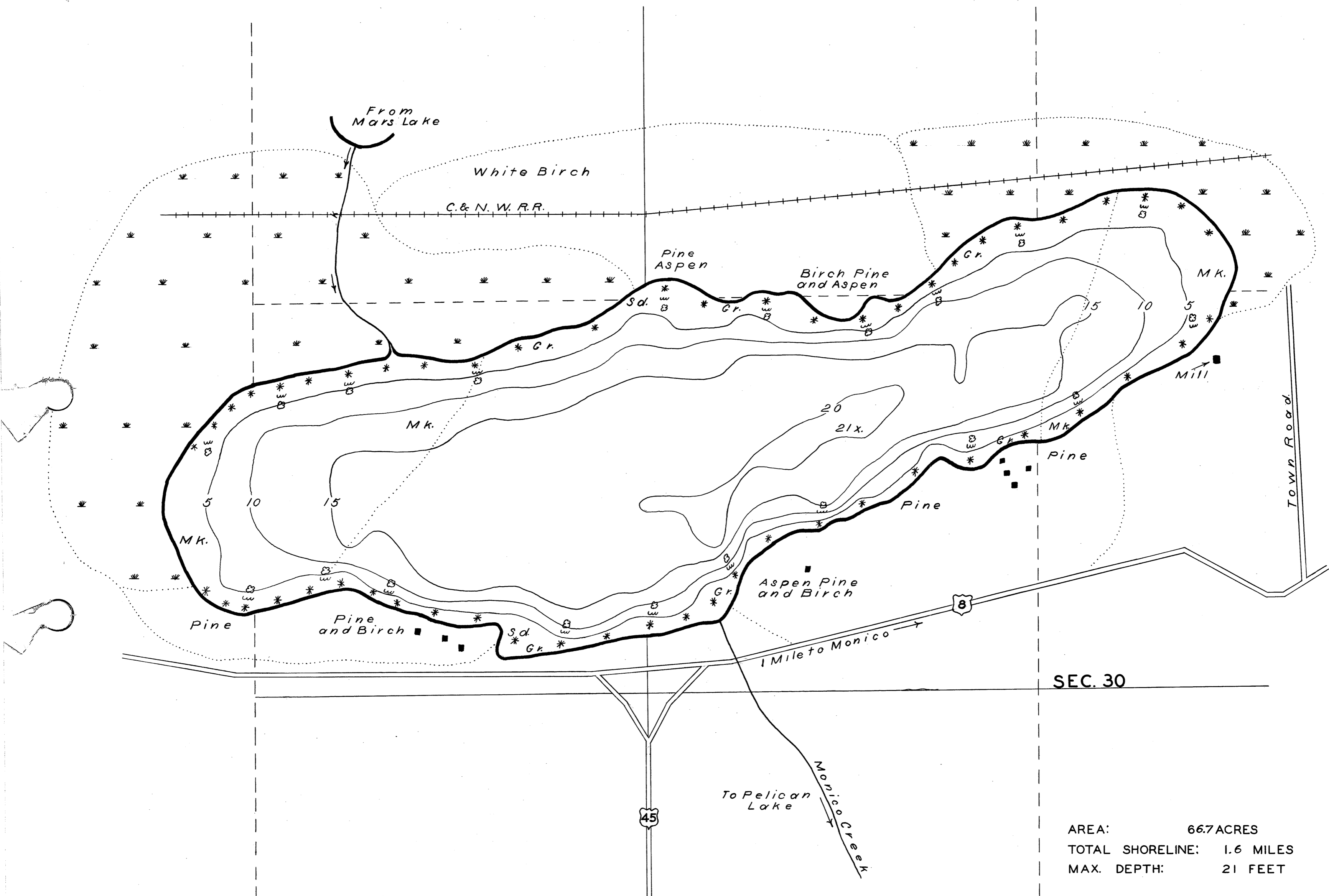

AREA: 66.7 ACRES
TOTAL SHORELINE: 1.6 MILES
MAX. DEPTH: 21 FEET

DATE March 15 1939
COMPILED BY P.A.B. C.C.C.
TRACED BY R.C. (W.P.A.)
SOURCE OF INFORMATION
Aerial Photograph
W.P.A. Lake Survey Project
SOUNDINGS At 125 Ft Intervals
DATES OF MAP REVISION _____
WORK AGENCY W.P.A.

LAKE IMPROVEMENT RECORD		
TYPE	DATE	1939
BRUSH REFUGES	20	
SAPLING TANGLES	60	
SPAWNING BOXES		
MINNOW SPAWNERS	270	
TOTAL	350	

SCALE 1 inch Equal 250 Ft.

LEGEND

- WEED BEDS
- ROCKY SHOALS
- Sd. SAND
- Cl. CLAY
- Gr. GRAVEL
- Mk. MUCK
- DWELLING
- ABANDONED DWELLING
- RESORT

Source: Wisconsin Department of Natural Resources 608-266-2621
Venus Lake – Oneida County, Wisconsin DNR Lake Map
Date – Mar 1939 - Historical Lake Map - Not for Navigation
A Public Document - Please Identify the Source when using it.