

LAKE HILT  
 SECTIONS 10,11,14,15  
 TOWNSHIP T-35-N  
 RANGE R-8-E  
 TOWN HARRISON  
 COUNTY LINCOLN

- LEGEND
- TOPOGRAPHIC SYMBOLS
- B Brush
  - PW Partially wooded
  - W Wooded
  - P Pastured
  - A Agricultural
  - B.M. Bench Mark
  - ||||| Steep slope
  - - - Indefinite shoreline
  - ↖ ↗ Marsh
  - o Spring
  - Permanent inlet
  - ← Permanent outlet

- LAKE BOTTOM SYMBOLS
- Mk. Muck
  - Sd. Sand
  - Gr. Gravel
  - Br. Bedrock
  - T Submergent vegetation
  - I Emergent vegetation

SPECIES OF FISH						
	Muskie	N. Pike	Walleye	L.M. Bass	S.M. Bass	Panfish
Abundant						
Common	X	X	X	X		X
Rare				X		

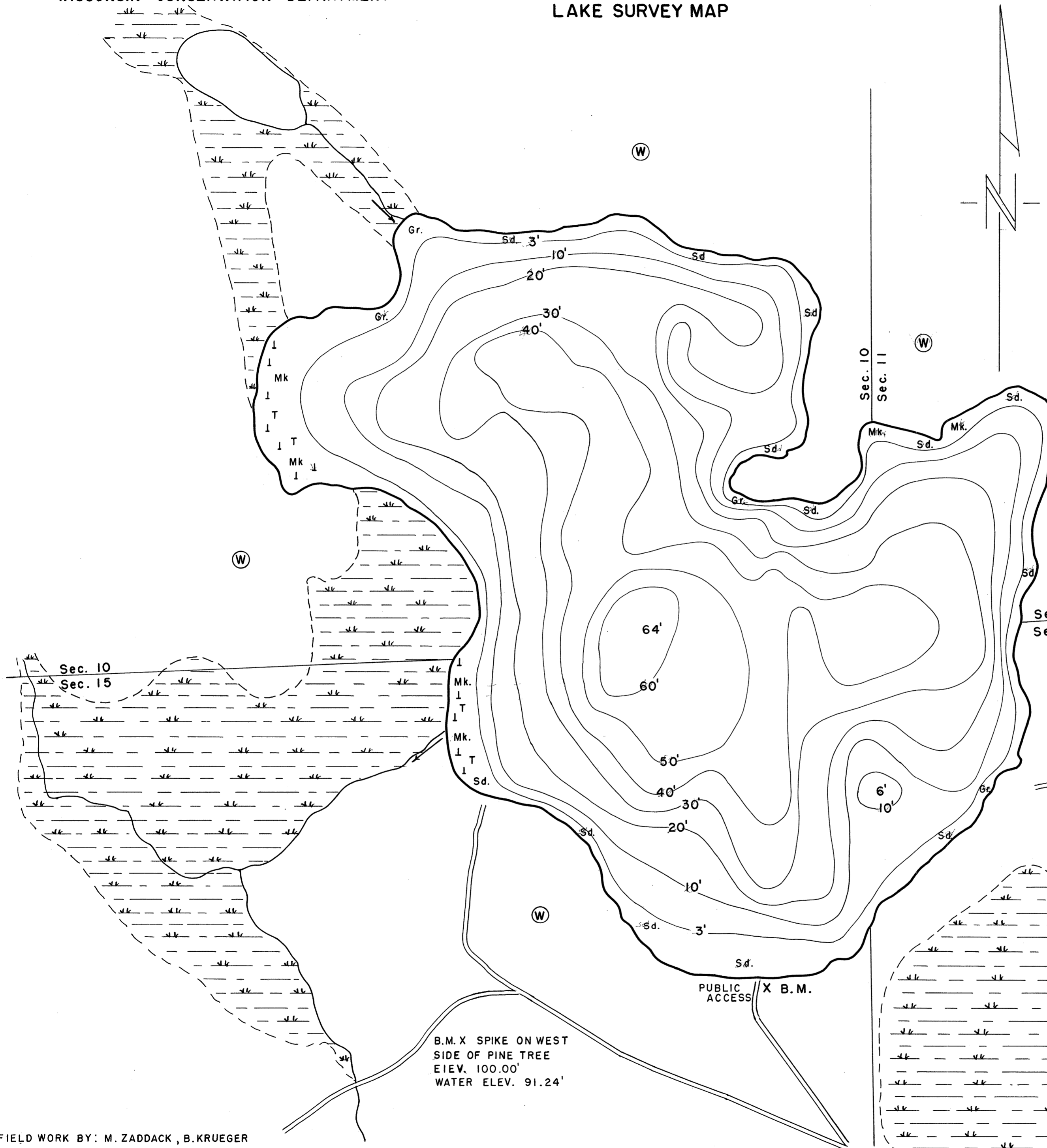

Sec. 11  
 Sec. 14

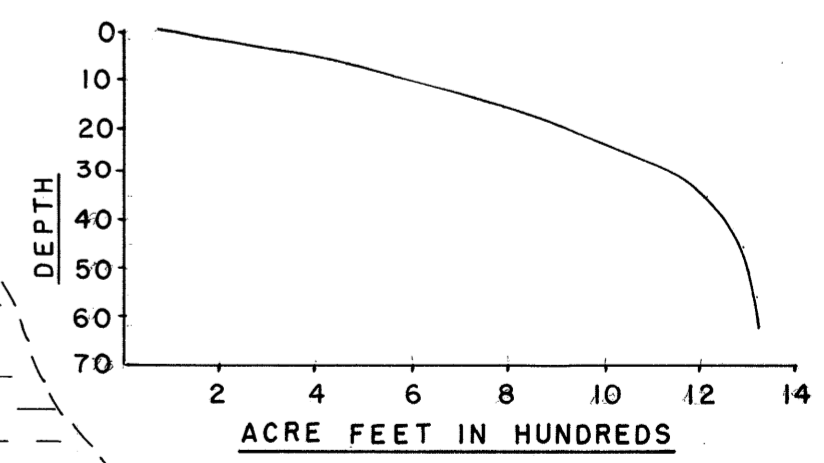

B.M. X SPIKE ON WEST  
 SIDE OF PINE TREE  
 ELEV. 100.00'  
 WATER ELEV. 91.24'

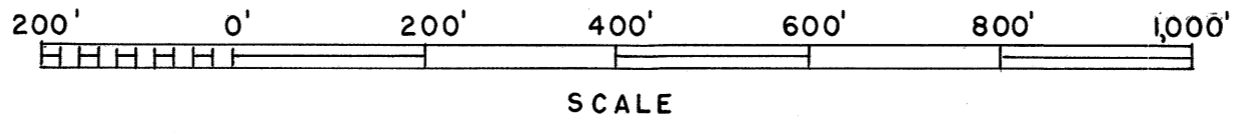

FIELD WORK BY: M. ZADDACK, B. KRUEGER  
 DRAWN BY: E. EATON  
 LAKE MAPPED JULY 1962  
 SOURCE OF INFORMATION W.C.D.  
 SOUNDINGS ECHO SOUNDER

AREA 58.5 ACRES  
 TOTAL SHORELINE 1.5 MILES  
 MAX. DEPTH 64 FEET  
 SCALE: AS SHOWN

Source: Wisconsin Department of Natural Resources 608-266-2621  
Hilt Lake - Lincoln County, Wisconsin DNR Lake Map  
Date – Jul. 1962 - Historical Lake Map - Not for Navigation  
A Public Document - Please Identify the Source when using it.