

LAKE SURVEY MAP

WISCONSIN CONSERVATION DEPARTMENT
BIOLOGY DIVISION
LAKE AND STREAM IMPROVEMENT SECTION

LAKE CLEAR
SECTION 10-11
TOWNSHIP 35 N
RANGE 6 E
TOWN OF BRADLEY
COUNTY LINCOLN

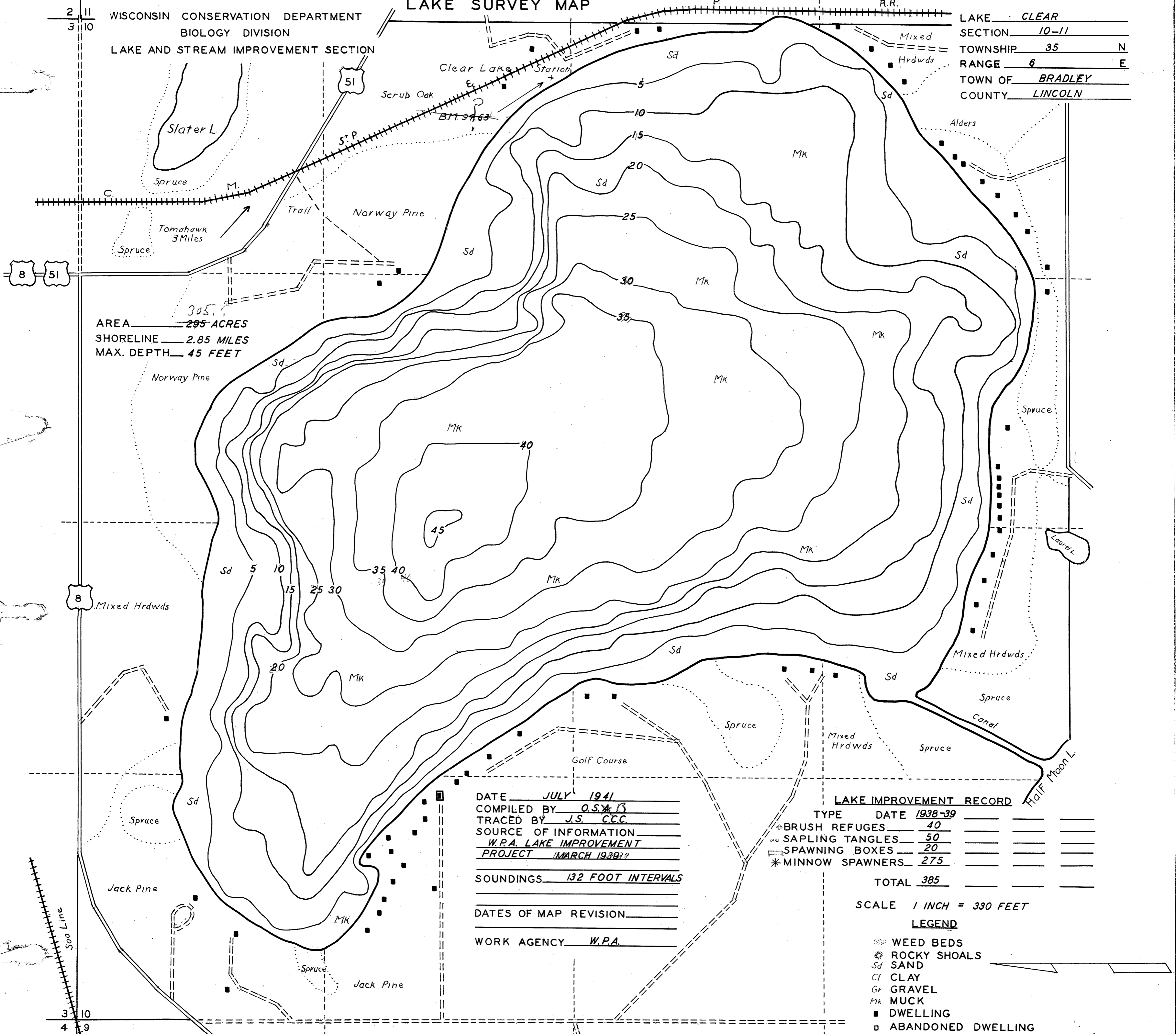

AREA 295 ACRES
SHORELINE 2.85 MILES
MAX. DEPTH 45 FEET

DATE JULY 1941
COMPILED BY O.S.A.B.
TRACED BY J.S. C.C.C.
SOURCE OF INFORMATION
W.P.A. LAKE IMPROVEMENT PROJECT MARCH 1939
SOUNDINGS 132 FOOT INTERVALS
DATES OF MAP REVISION _____
WORK AGENCY W.P.A.

LAKE IMPROVEMENT RECORD

TYPE	DATE	1938-39		
BRUSH REFUGES		40		
SAPLING TANGLES		50		
SPAWNING BOXES		20		
MINNOW SPAWNERS		275		
TOTAL		385		

SCALE 1 INCH = 330 FEET

LEGEND

- WEED BEDS
- ⊙ ROCKY SHOALS
- Sd SAND
- Cl CLAY
- Gr GRAVEL
- Mk MUCK
- DWELLING
- ABANDONED DWELLING
- ▣ RESORT

Source: Wisconsin Department of Natural Resources 608-266-2621
Clear Lake - Lincoln County, Wisconsin DNR Lake Map
Date - July 1941 - Historical Lake Map - Not for Navigation
A Public Document - Please Identify the Source when using it.