

LAKE SURVEY MAP

TOMAHAWK LAKE ONEIDA COUNTY
SEC. 32, 33, 34, 5, 8 T.-38, 39-N. R.-6, 7-E.

(Sheet 1 of 3)

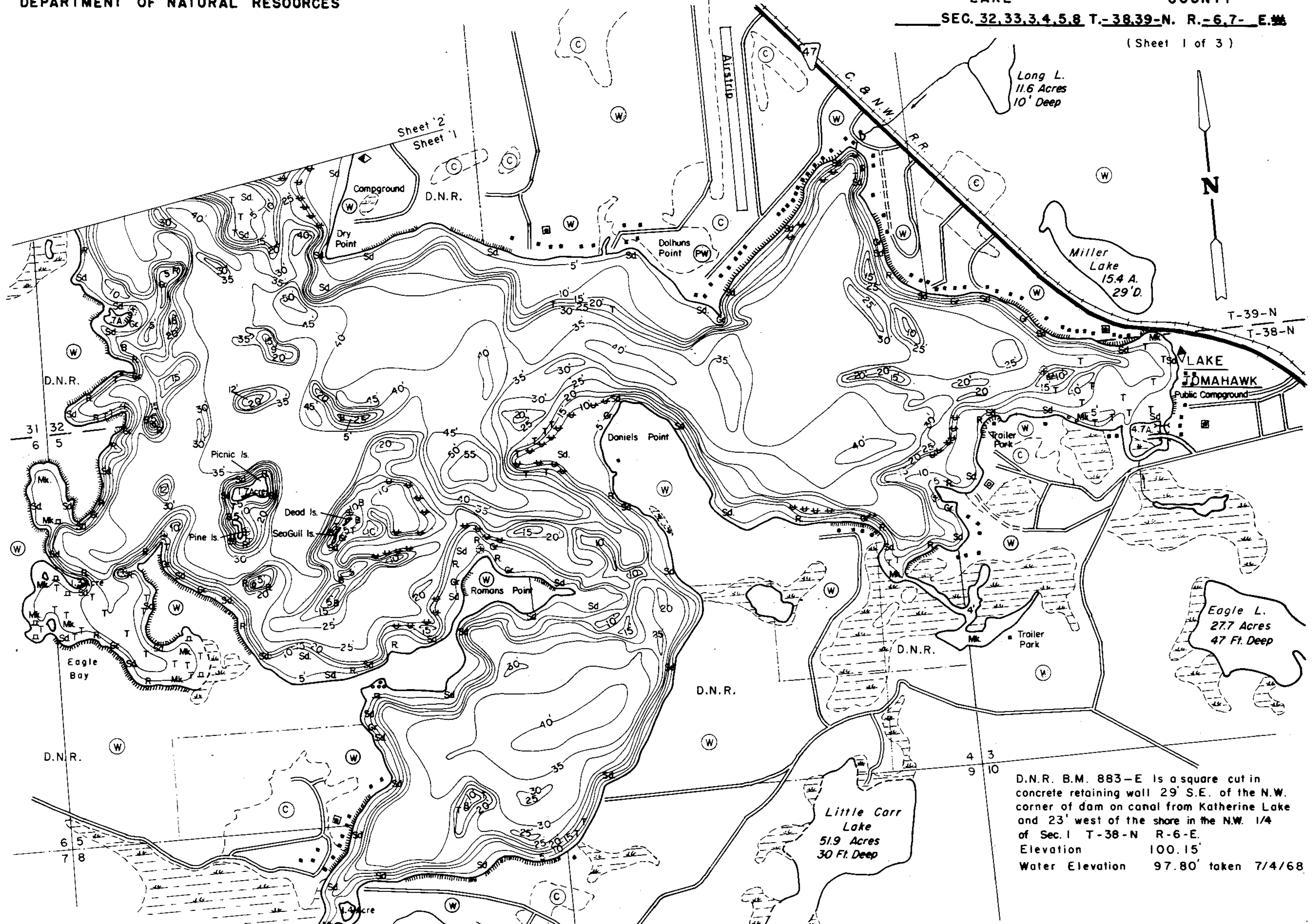

D.N.R. B.M. 883-E is a square cut in concrete retaining wall 29' S.E. of the N.W. corner of dam on canal from Katherine Lake and 23' west of the shore in the N.W. 1/4 of Sec. 1 T-38-N R-6-E.
Elevation 100.15'
Water Elevation 97.80' taken 7/4/68

EQUIPMENT RECORDING SONAR MAPPED AUG 1970 Little Carr Lake Tomahawk L.

- | TOPOGRAPHIC SYMBOLS | | LAKE BOTTOM SYMBOLS | |
|-----------------------|---------------------------|---------------------|-----------------------------|
| (B) Brush | Steep slope | P. Peat | B Boulders |
| (PW) Partially wooded | ~ Indefinite shoreline | Mk. Muck | o Stumps & Snags |
| (W) Wooded | ~ Marsh | C. Clay | ⚡ Rock danger to navigation |
| (C) Cleared | ~ Spring | M. Marl | T Submergent vegetation |
| (P) Pastured | ~ Intermittent stream | Sd. Sand | ⌋ Emergent vegetation |
| (A) Agricultural | ~ Permanent inlet | St. Silt | ~ Floating vegetation |
| B.M. Bench Mark | ~ Permanent outlet | Gr. Gravel | ⌋ Brush shelters |
| ■ Dwelling | ~ Dam | R. Rubble | |
| ▣ Resort | ~ D.N.R. State owned land | Bc. Bedrock | |
| ⊠ Camp | | | |



Access Access with Parking Boat Livery
Drawn by: E. Eaton
Field work by: J. Smith

SPECIES OF FISH	Abundance	
	Common	Present
Muskie		X
N. Pike	X	X
Walleye	X	X
L. M. Bass	X	X
S. M. Bass	X	X
Panfish	X	X
Trot		X
Cisco		X

WATER AREA 3,392 ACRES
UNDER 3 FT. 4 %
OVER 20 FT. 70 %
MAX. DEPTH 84 FEET.
TOTAL ALK. 47 P.P.M.
VOLUME 111,958 ACRE FT.
SHORELINE 30.20 MILES
WITHOUT ISL. 27.33 MILES

LAKE SURVEY MAP

SEC. 29, 30, 31, 32, T.-38, 39-N. R.-6, 7- E. 22

36, 5, 6 (Sheet 2 of 3)

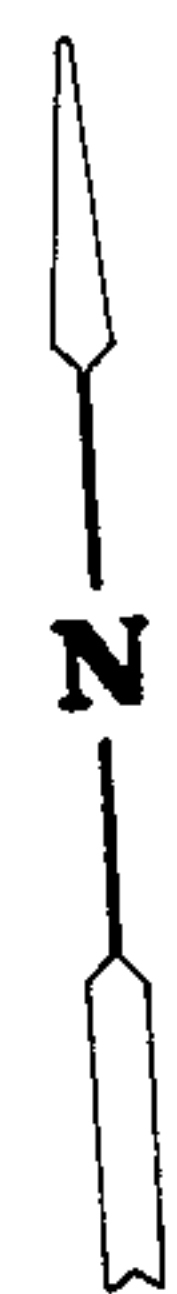
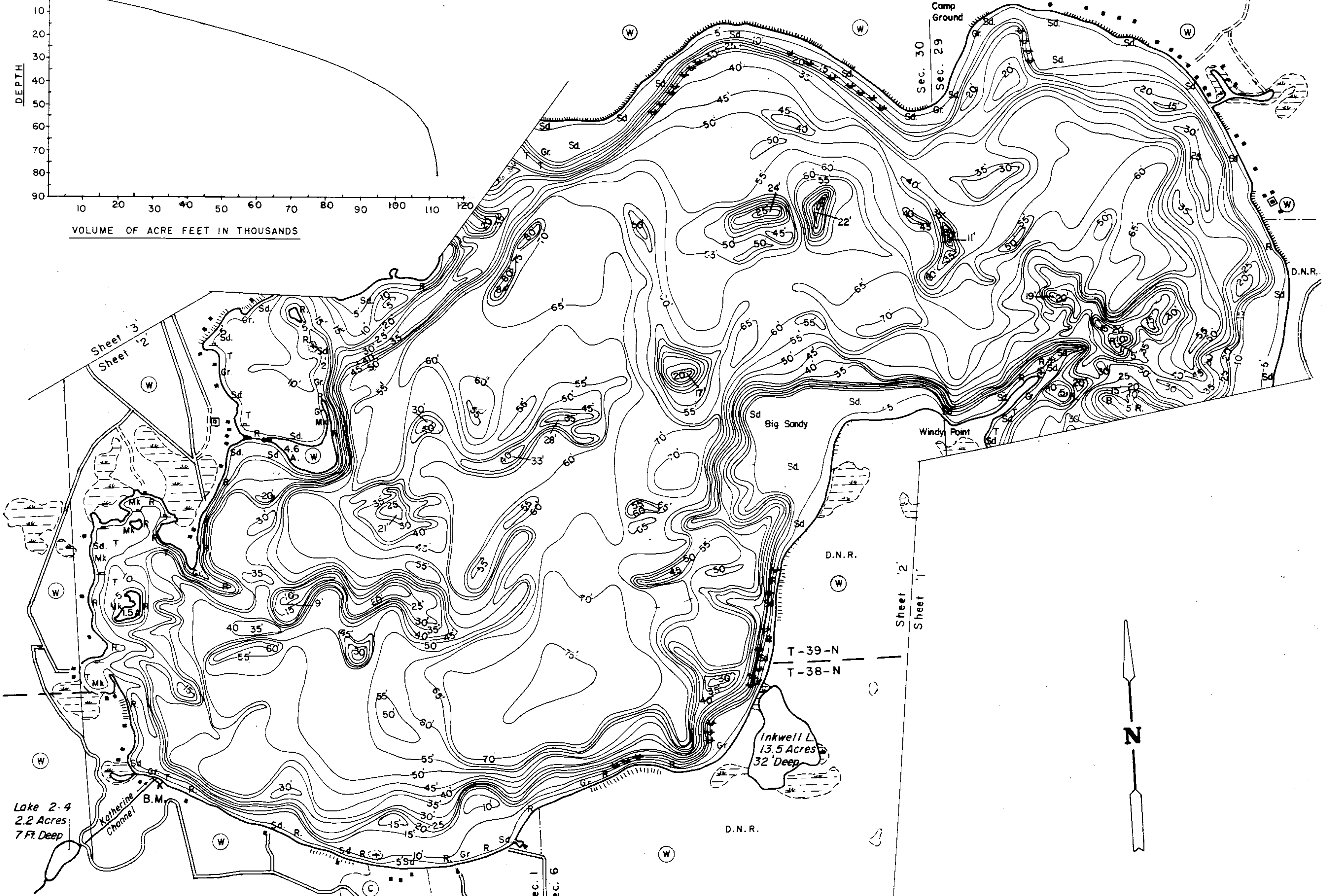
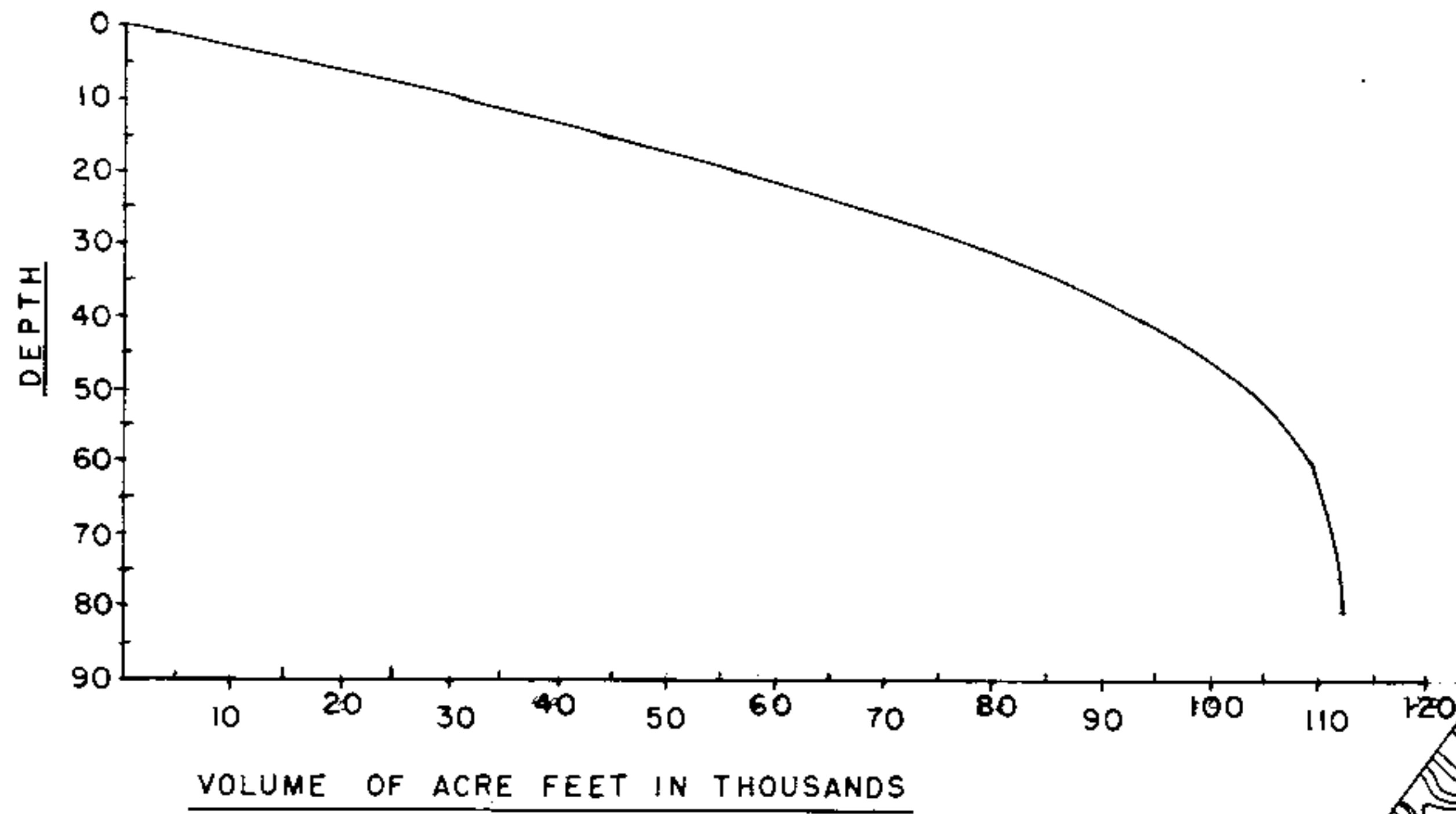

EQUIPMENT RECORDING SONAR MAPPED AUG 1970

- TOPOGRAPHIC SYMBOLS
- (B) Brush
 - (PW) Partially wooded
 - (W) Wooded
 - (C) Cleared
 - (P) Pastured
 - (A) Agricultural
 - B.M. Bench Mark
 - Dwelling
 - Resort
 - Camp
- LAKE BOTTOM SYMBOLS
- P. Peat
 - Mk. Muck
 - C. Clay
 - M. Marl
 - Sd. Sand
 - St. Silt
 - Gr. Gravel
 - R. Rubble
 - Bc. Bedrock
 - B Boulders
 - Stumps & Snags
 - Rock danger to navigation
 - Emergent vegetation
 - Floating vegetation
 - Brush shelters
 - Steep slope
 - Indefinite shoreline
 - Marsh
 - Spring
 - Intermittent stream
 - Permanent inlet
 - Permanent outlet
 - Dam
 - D.N.R. State owned land



◆ Access ◆ Access with Parking ◆ Boat Livery

Drawn by: E. Eaton

Field work by: J. Smith

SPECIES OF FISH	ABUNDANCE		
	Abundant	Common	Present
Muskie			X
N. Pike	X		
Walleye	X		
L. N. Bass	X		
S. W. Bass	X		
Panfish	X		
Trout			X
Cisco			X

WATER AREA 3,392 ACRES

UNDER 3 FT. 4 %

OVER 20 FT. 70 %

MAX. DEPTH 84 FEET

TOTAL ALK. 47 P.P.M.

VOLUME 111,958 ACRE FT.

SHORELINE 30.20 MILES

WITHOUT ISL. 27.33 MILES

LAKE SURVEY MAP

TOMAHAWK LAKE ONEIDA COUNTY
SEC. 24, 25, 36 T.-38, 39-N. R.-6, 7-E. 3E
(Sheet 3 of 3)

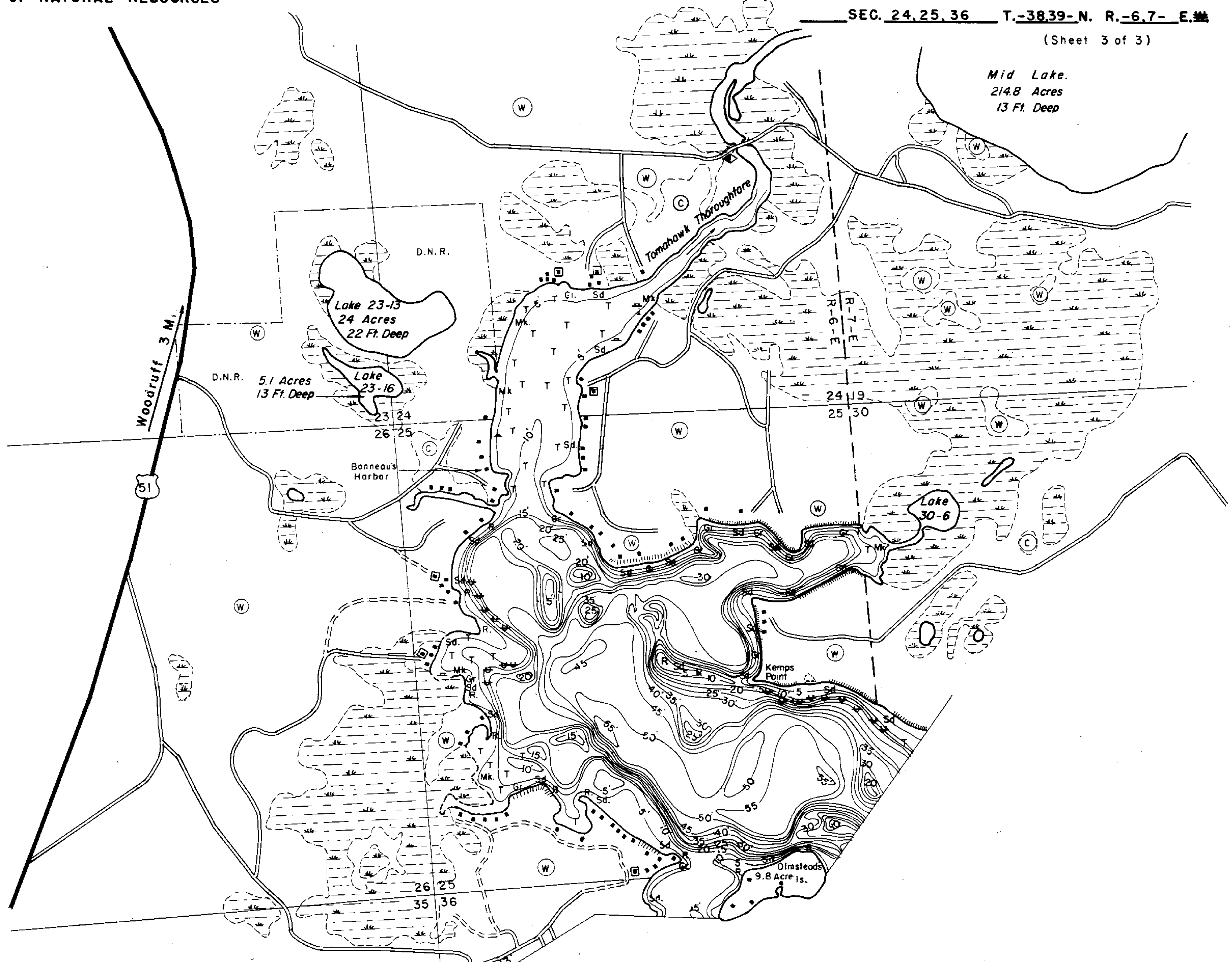
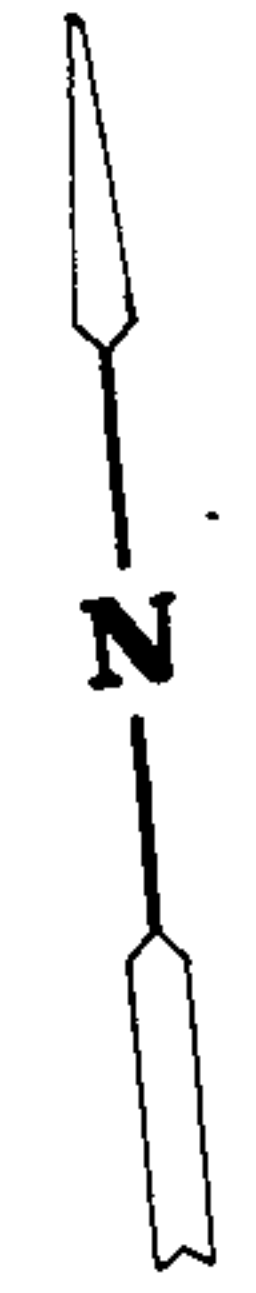

Mid Lake.
214.8 Acres
13 Ft. Deep

EQUIPMENT RECORDING SONAR MAPPED		AUG 1970	
TOPOGRAPHIC SYMBOLS		MONTH	YEAR
		LAKE	BOTTOM
(B) Brush	Steep slope	P. Peat	B Boulders
(PW) Partially wooded	- - - Indefinite shoreline	Mk. Muck	Stumps & Snags
(W) Wooded	Marsh	C. Clay	Rock danger to navigation
(C) Cleared	Spring	M. Marl	T Submergent vegetation
(P) Pastured	Intermittent stream	Sd. Sand	Emergent vegetation
(A) Agricultural	Permanent inlet	Sl. Silt	Floating vegetation
B.M. Bench Mark	Permanent outlet	Gr. Gravel	Brush shelters
■ Dwelling	Dam	R. Rubble	
□ Resort	D.N.R. State owned land	Bc. Bedrock	
□ Camp			

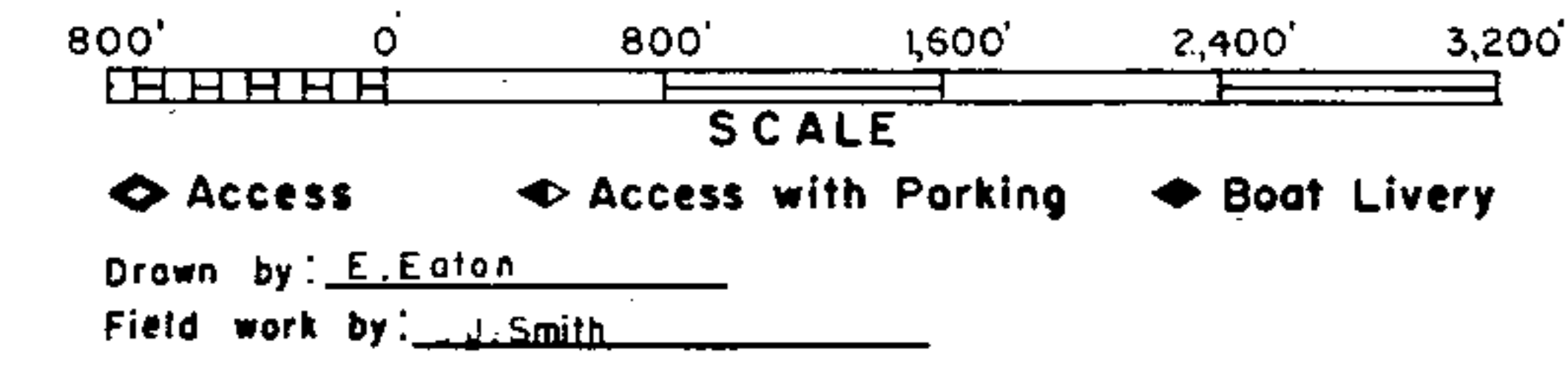

SPECIES OF FISH	ABUNDANCE		
	Abundant	Common	Present
Muskie		X	
N. Pike		X	
Walleye	X		
L. M. Bass	X		
S. M. Bass	X		
Panfish	X		
Trout			X
Cisco			X

WATER AREA 3,392 ACRES
 UNDER 3 FT. 4 %
 OVER 20 FT. 70 %
 MAX. DEPTH 84 FEET.
 TOTAL ALK. 47 P.P.M.
 VOLUME 111,958 ACRE FT.
 SHORELINE 30.20 MILES
 WITHOUT ISL. 27.33 MILES

Source: Wisconsin Department of Natural Resources 608-266-2621
Tomahawk Lake – Oneida County, Wisconsin - DNR Lake Map
Date – Aug 1970 - Historical Lake Map - Not for Navigation
A Public Document - Please Identify the Source when using it.