

LAKE SURVEY MAP

MCCORMICK LAKE ONEIDA COUNTY
SEC. 5, 6, 31, 32 T. 38 N. R. 6 E.

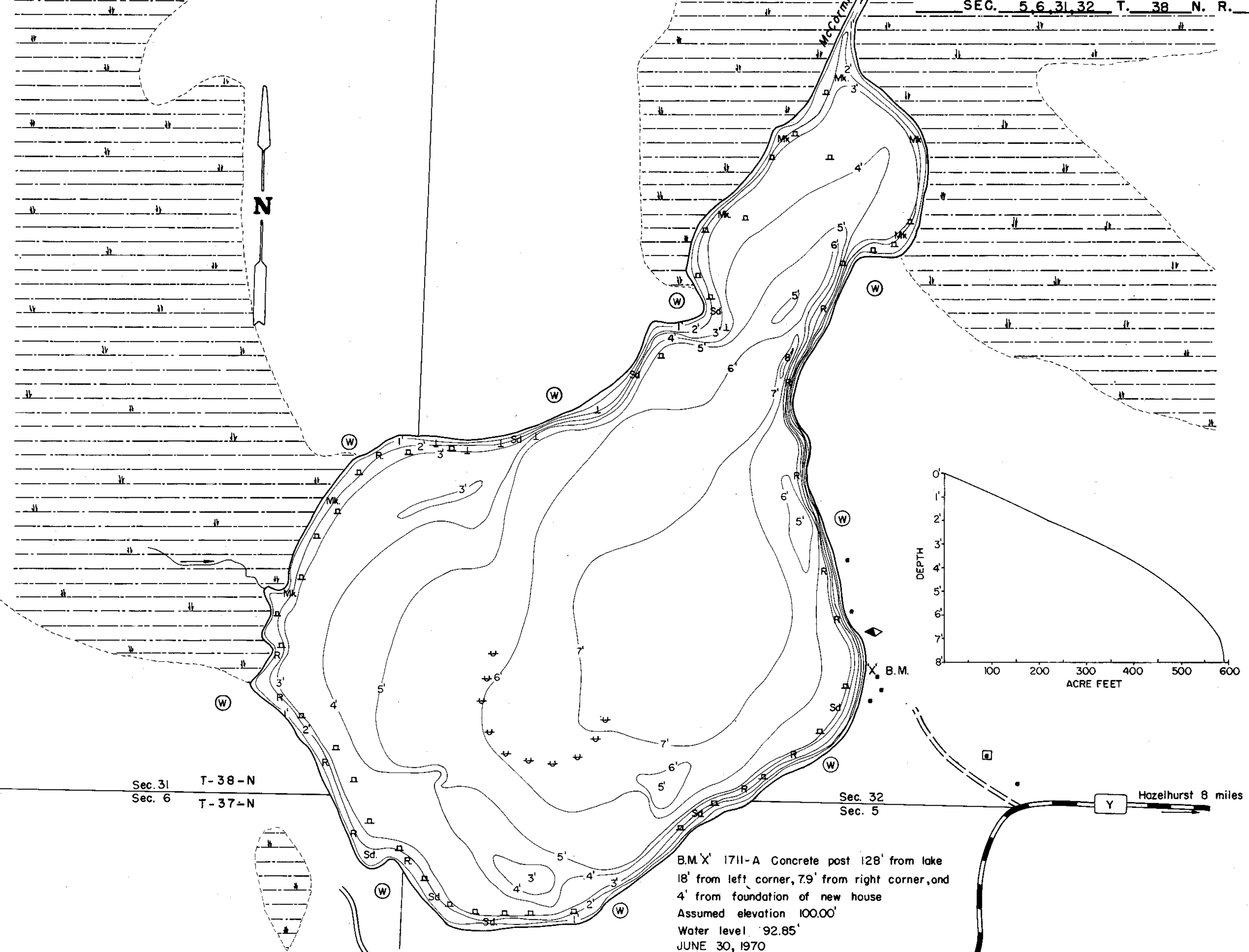

Sec. 31 T-38-N
Sec. 6 T-37-N

Sec. 32 Hazelhurst 8 miles
Sec. 5

B.M. X' 1711-A Concrete post 128' from lake
18' from left corner, 7.9' from right corner, and
4' from foundation of new house
Assumed elevation 100.00'
Water level 92.85'
JUNE 30, 1970

EQUIPMENT RECORDING SONAR MAPPED MAY 1970
MONTH YEAR
LAKE BOTTOM SYMBOLS

TOPOGRAPHIC SYMBOLS		LAKE BOTTOM SYMBOLS	
(B) Brush	Steep slope	P. Peat	B Boulders
(PW) Partially wooded	----- Indefinite shoreline	Mk. Muck	o Stumps & Snags
(W) Wooded	----- Marsh	C. Clay	⊙ Rock danger to navigation
(C) Cleared	----- Spring	M. Marl	T Submergent vegetation
(P) Pastured	----- Intermittent stream	Sd. Sand	⊥ Emergent vegetation
(A) Agricultural	----- Permanent inlet	St. Silt	⊥ Floating vegetation
B.M. Bench Mark	----- Permanent outlet	Gr. Gravel	⊥ Brush shelters
■ Dwelling	----- Dam	R. Rubble	
□ Resort	----- D.N.R. State owned land	Br. Bedrock	
⊠ Camp			

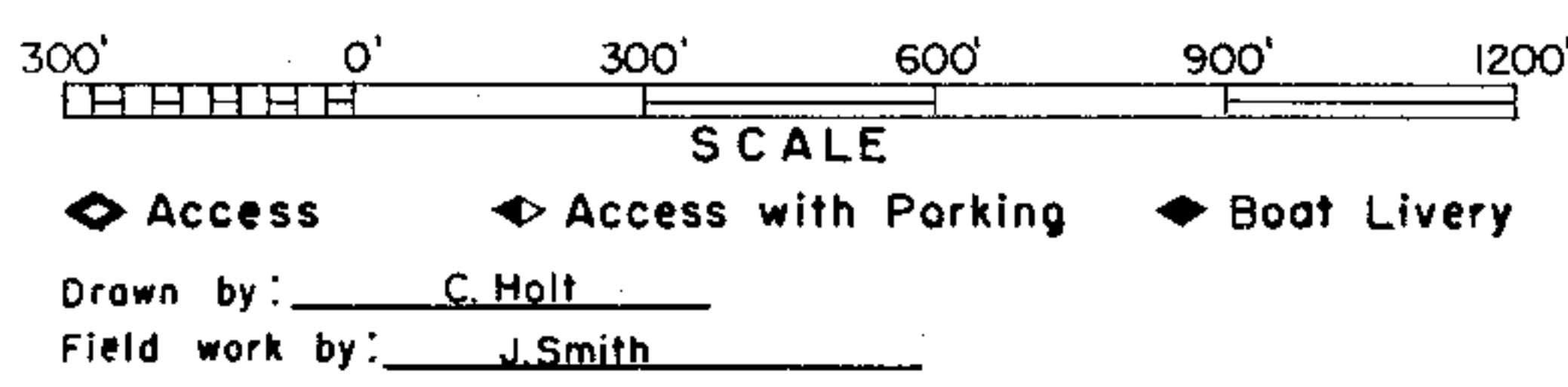

SPECIES OF FISH	Abundance		
	Occasional	Common	Present
Muskie			X
N. Pike			X
Walleye			X
L.M. Bass			X
S.M. Bass			X
Panfish			X
Trout			

WATER AREA 118.4 ACRES
UNDER 3 FT. 9.5 %
OVER 20 FT. 0 %
MAX. DEPTH 8 FEET.
TOTAL ALK. 33 P.P.M.
VOLUME 589 ACRE FT.
SHORELINE 2.14 MILES

Source: Wisconsin Department of Natural Resources 608-266-2621
McCormick Lake – Oneida County, Wisconsin DNR Lake Map
Date – May 1970 - Historical Lake Map - Not for Navigation
A Public Document - Please Identify the Source when using it.