

LAKE SURVEY MAP

WARD MILL POND
LAKE

LINCOLN
COUNTY

SEC. 1, 6, 12

T. 31

N. R. 6, 7 E.

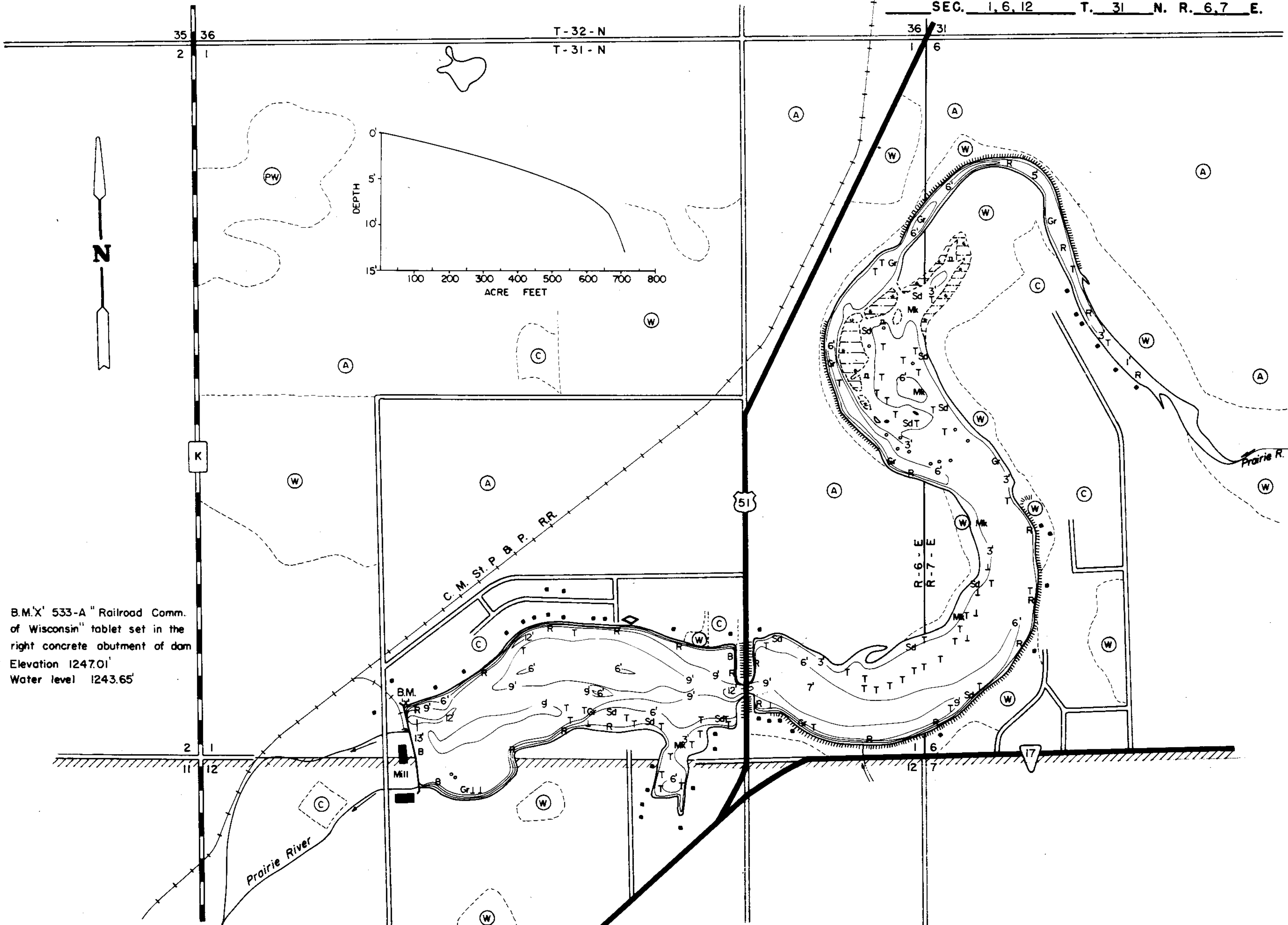

B.M. 'X' 533-A "Railroad Comm. of Wisconsin" tablet set in the right concrete abutment of dam
Elevation 1247.01'
Water level 1243.65'

EQUIPMENT RECORDING SONAR MAPPED JUNE 1972

- | TOPOGRAPHIC SYMBOLS | | LAKE BOTTOM SYMBOLS | |
|-----------------------|---------------------------|---------------------|-----------------------------|
| (B) Brush | Steep slope | P. Peat | B Boulders |
| (PW) Partially wooded | ~ Indefinite shoreline | Mk. Muck | ⚬ Stumps & Snags |
| (W) Wooded | ~ Marsh | C. Clay | ⚬ Rock danger to navigation |
| (C) Cleared | ~ Spring | M. Marl | T Submergent vegetation |
| (P) Pastured | ~ Intermittent stream | Sd. Sand | ⊥ Emergent vegetation |
| (A) Agricultural | ~ Permanent inlet | Sl. Silt | ~ Floating vegetation |
| B.M. Bench Mark | ~ Permanent outlet | Gr. Gravel | ⚬ Brush shelters |
| ■ Dwelling | ~ Dam | R. Rubble | |
| ⊠ Resort | ~ D.N.R. State owned land | Bc. Bedrock | |
| ⊠ Camp | | | |

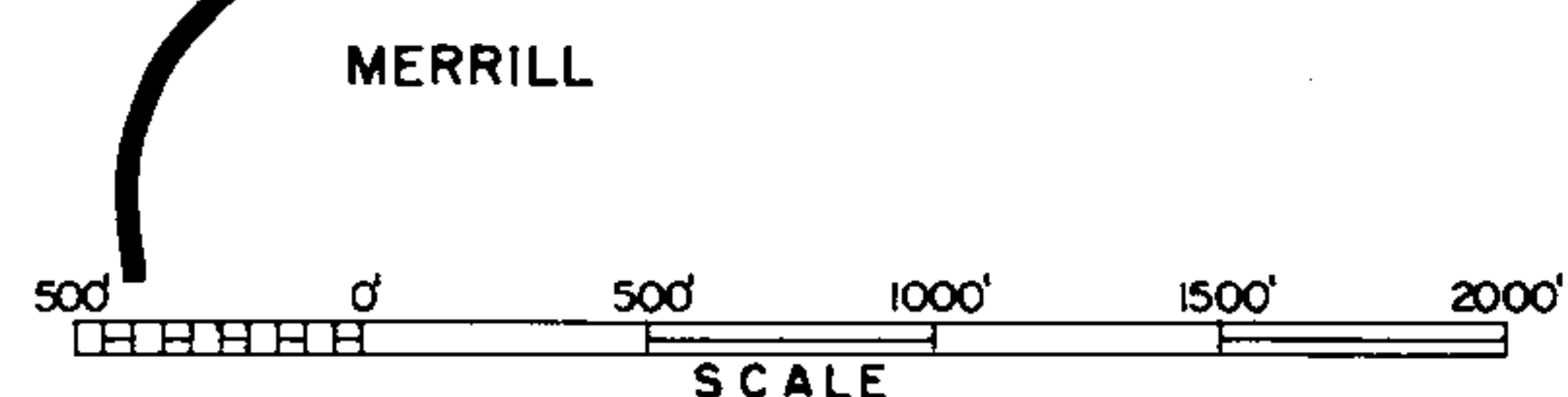

Drawn by: C. Holt
Field work by: W. Evans, J. Smith

SPECIES OF FISH	Abundant Common Present		
	Abundant	Common	Present
Muskie			
N. Pike	X		
Walleye		X	X
L.M. Bass	X		
S.M. Bass			
Panfish	X		
Trout			

WATER AREA 117.5 ACRES
UNDER 3 FT. 20 %
OVER 20 FT. 0 %
MAX. DEPTH 13 FEET.
TOTAL ALK. 84 P.P.M.
VOLUME 709 ACRE FT.
SHORELINE 4.28 MILES

Source: Wisconsin Department of Natural Resources 608-266-2621
Ward Mill Pond - Lincoln County, Wisconsin DNR Lake Map
Date – Jun 1972 - Historical Lake Map - Not for Navigation
A Public Document - Please Identify the Source when using it.