

EQUIPMENT RECORDING SONAR MAPPED AUGUST 1971

TOPOGRAPHIC SYMBOLS		LAKE BOTTOM SYMBOLS	
(B) Brush	Steep slope	P. Peat	B Boulders
(PW) Partially wooded	----- Indefinite shoreline	Mk. Muck	o Stumps & Snags
(W) Wooded	Marsh	C. Clay	Rock danger to navigation
(C) Cleared	Spring	M. Marl	T Submergent vegetation
(P) Pastured	Intermittent stream	Sd. Sand	J Emergent vegetation
(A) Agricultural	Permanent inlet	St. Silt	F Floating vegetation
B.M. Bench Mark	Permanent outlet	Gr. Gravel	Brush shelters
■ Dwelling	Dam	R. Rubble	
□ Resort	D.N.R. State owned land	Br. Bedrock	
□ Camp			



SCALE

◆ Access ◆ Access with Parking ◆ Boat Livery

Drawn by: C. Holt

Field work by: J. Smith

SPECIES OF FISH	Abundant		Present
	Common	Present	
Muskie			
N. Pike	X		
Walleye		X	
L.M. Bass	X		
S.M. Bass			
Panfish	X		
Trout			

WATER AREA 445.0 ACRES
UNDER 3 FT. 19 %
OVER 20 FT. 3 %
MAX. DEPTH 24 FEET.
TOTAL ALK. 153 P.P.M.
VOLUME 4196 ACRE FT.
SHORELINE 18 MILES

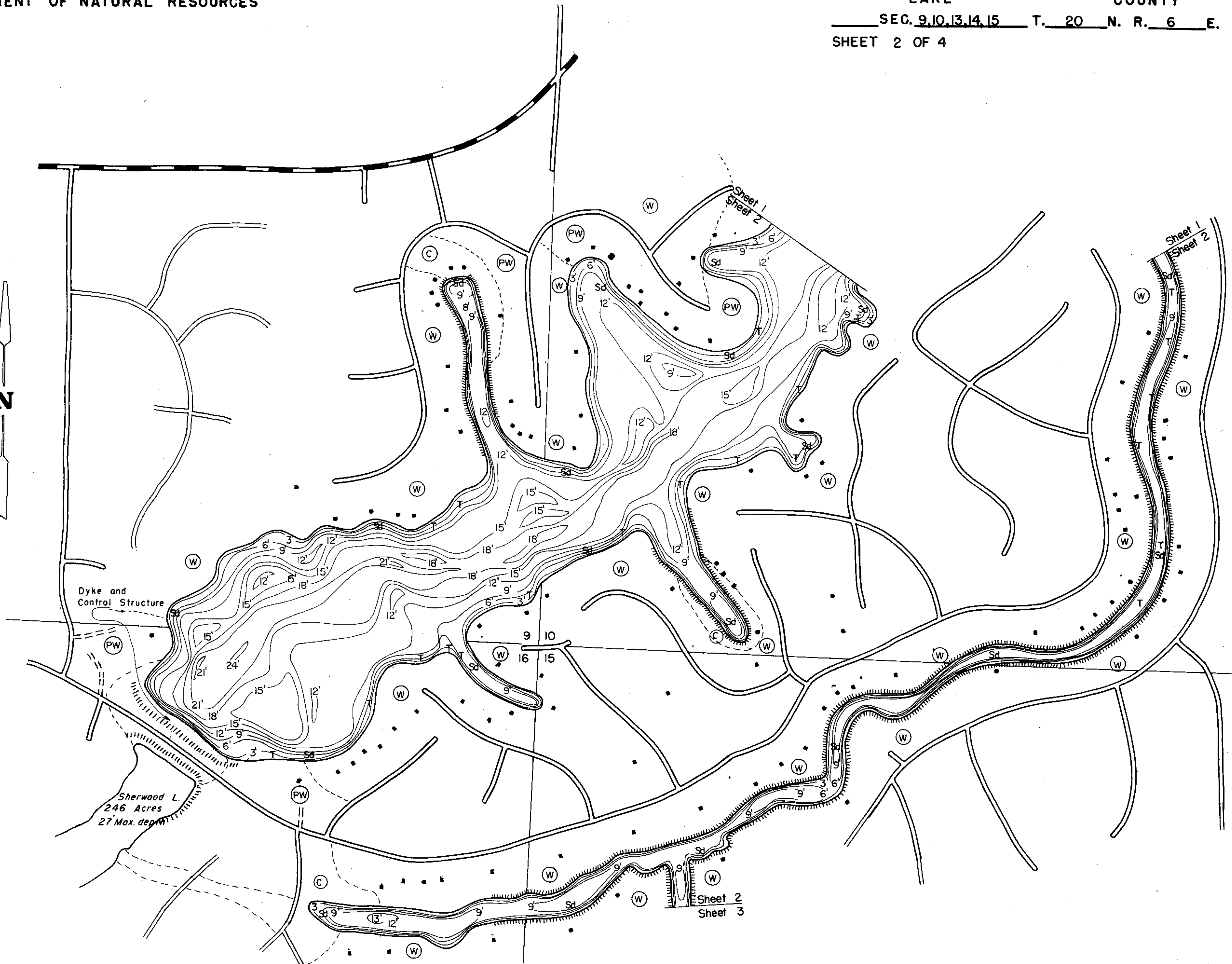

EQUIPMENT RECORDING SONAR MAPPED AUGUST 1971

- TOPOGRAPHIC SYMBOLS**
- (B) Brush
 - (PW) Partially wooded
 - (W) Wooded
 - (C) Cleared
 - (P) Pastured
 - (A) Agricultural
 - B.M. Bench Mark
 - Dwelling
 - Resort
 - Camp
 - ||||| Steep slope
 - ~ Indefinite shoreline
 - Marsh
 - Spring
 - Intermittent stream
 - Permanent inlet
 - Permanent outlet
 - Dam
 - D.N.R. State owned land

- LAKE BOTTOM SYMBOLS**
- P. Peat
 - Mk. Muck
 - C. Clay
 - M. Marl
 - Sd. Sand
 - Sl. Silt
 - Gr. Gravel
 - R. Rubble
 - Br. Bedrock
 - B Boulders
 - Stumps & Snags
 - Rock danger to navigation
 - Submergent vegetation
 - Emergent vegetation
 - Floating vegetation
 - Brush shelters



◆ Access ◆ Access with Parking ◆ Boat Livery
 Drawn by: C. Holt
 Field work by: J. Smith

SPECIES OF FISH	Abundant Common Present		
	Abundant	Common	Present
Muskie			
N. Pike		X	
Walleye			X
L.M. Bass		X	
S.M. Bass			
Panfish	X		
Trout			

WATER AREA 4450 ACRES
 UNDER 3 FT. 19 %
 OVER 20 FT. 3 %
 MAX. DEPTH 24 FEET.
 TOTAL ALK. 153 P.P.M.
 VOLUME 4196 ACRE FT.
 SHORELINE 18 MILES

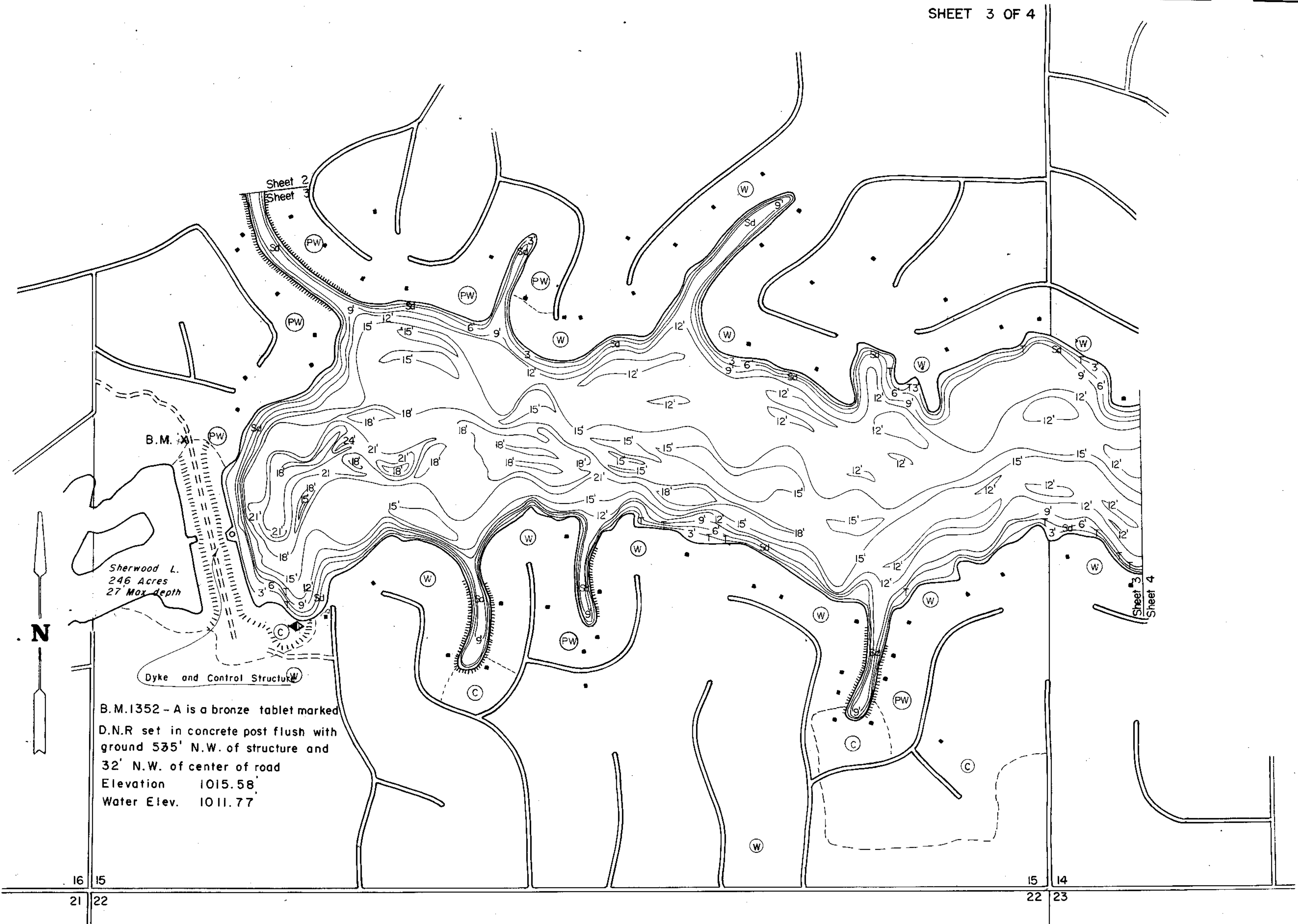

Sherwood L.
246 Acres
27' Max depth

Dyke and Control Structure

B.M. 1352 - A is a bronze tablet marked
D.N.R. set in concrete post flush with
ground 535' N.W. of structure and
32' N.W. of center of road
Elevation 1015.58
Water Elev. 1011.77

EQUIPMENT RECORDING SONAR MAPPED AUGUST 1971

- TOPOGRAPHIC SYMBOLS
- (B) Brush
 - (PW) Partially wooded
 - (W) Wooded
 - (C) Cleared
 - (P) Pastured
 - (A) Agricultural
 - B.M. Bench Mark
 - Dwelling
 - Resort
 - ⊠ Camp
 - ||||| Steep slope
 - - - Indefinite shoreline
 - Marsh
 - Spring
 - Intermittent stream
 - Permanent inlet
 - Permanent outlet
 - Dam
 - D.N.R. State owned land

- LAKE BOTTOM SYMBOLS
- P. Peat
 - Mk. Muck
 - C. Clay
 - M. Marl
 - Sd. Sand
 - St. Silt
 - Gr. Gravel
 - R. Rubble
 - Br. Bedrock
 - B Boulders
 - Stumps & Snags
 - Rock danger to navigation
 - T Submergent vegetation
 - Emergent vegetation
 - Floating vegetation
 - Brush shelters



Access Access with Parking Boat Livery
 Drawn by: C. Holt
 Field work by: J. Smith

SPECIES OF FISH	Abundance		
	Abundant	Common	Present
Muskie			
N. Pike		X	
Walleye		X	X
L.M. Bass		X	
S.M. Bass		X	
Panfish	X		
Trout			

WATER AREA 4450 ACRES
 UNDER 3 FT. 19 %
 OVER 20 FT. 3 %
 MAX. DEPTH 24 FEET.
 TOTAL ALK. 153 P.P.M.
 VOLUME 4196 ACRE FT.
 SHORELINE 18 MILES

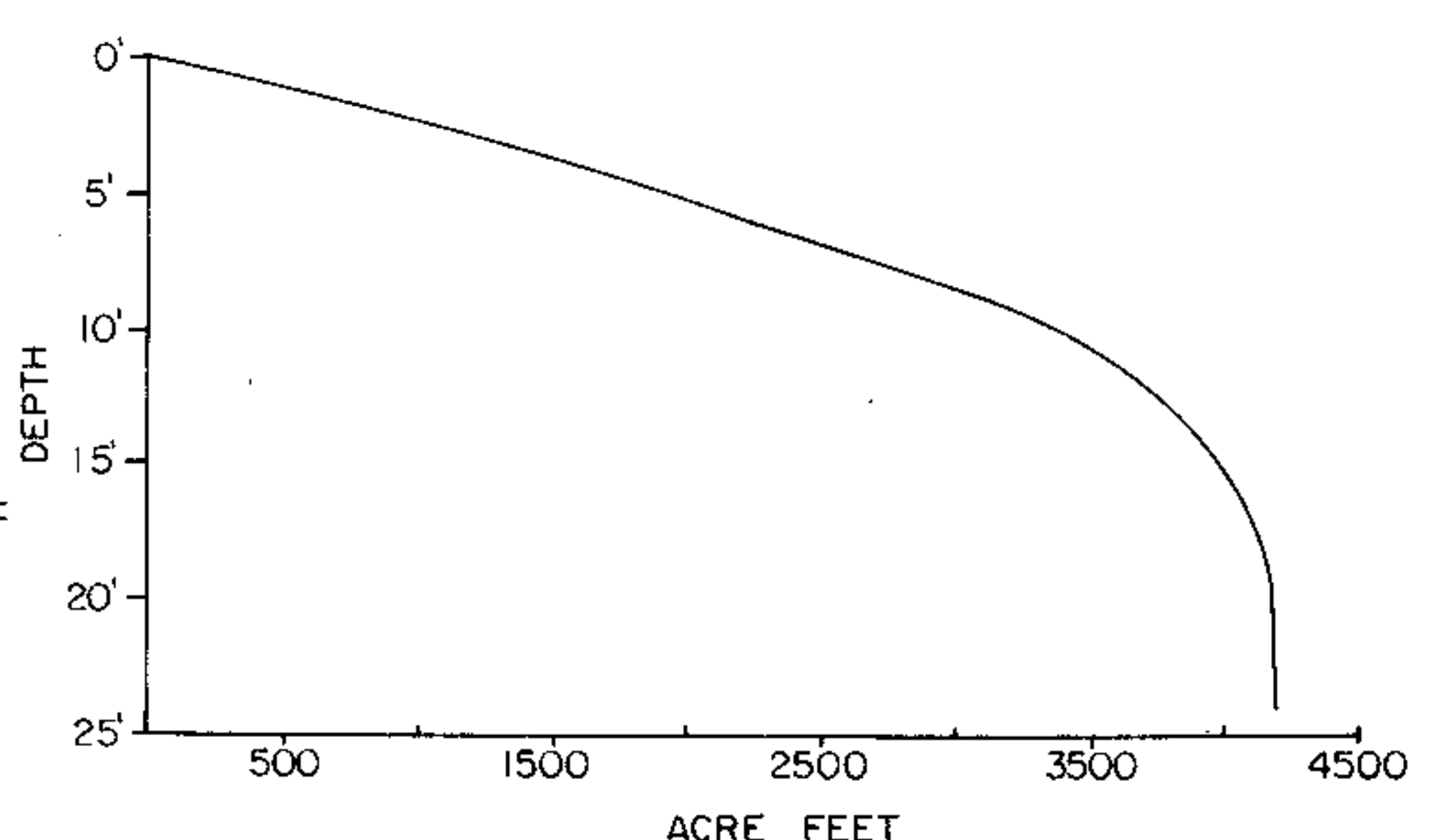
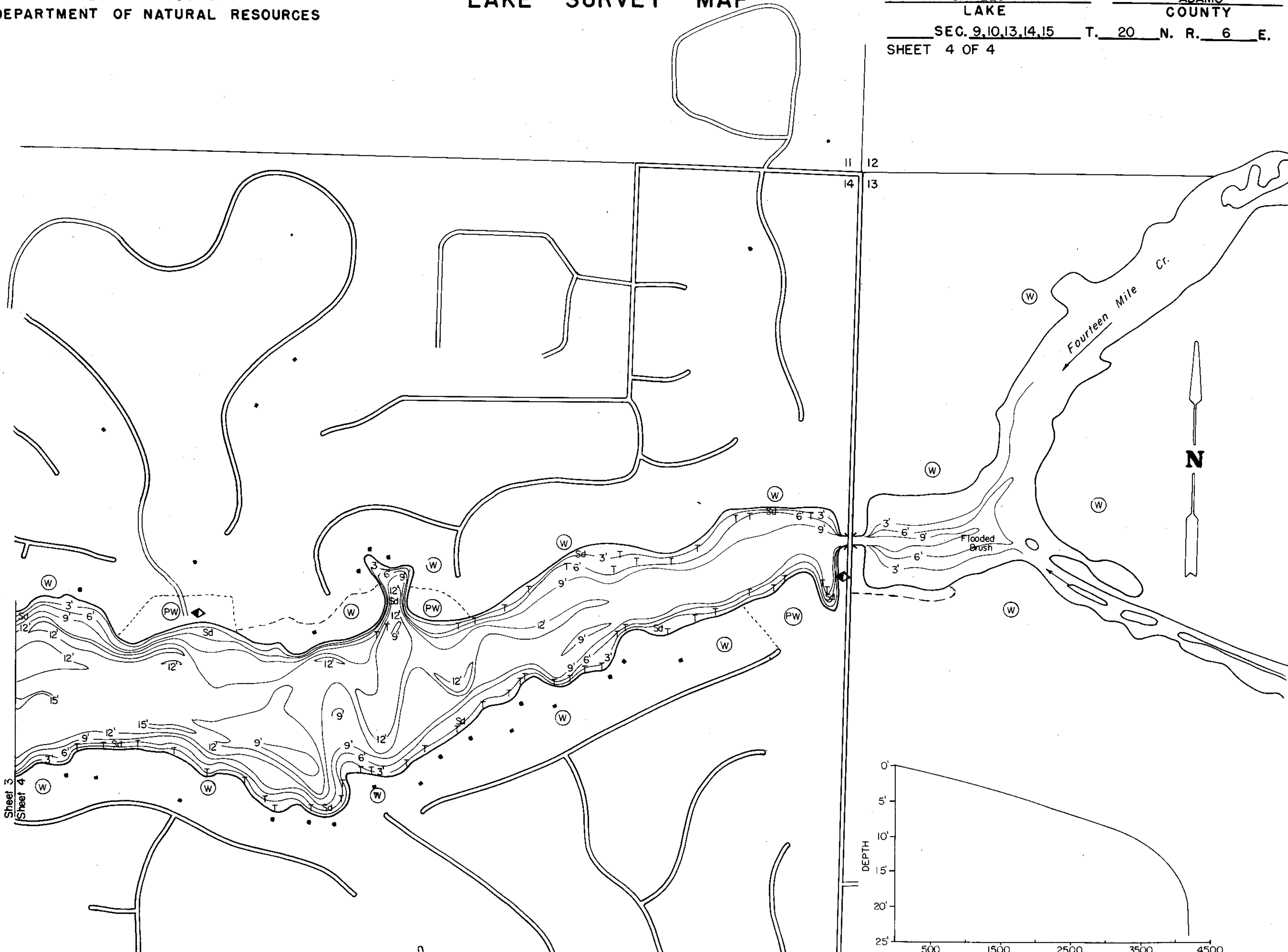

EQUIPMENT RECORDING SONAR MAPPED AUGUST 1971
MONTH YEAR

- TOPOGRAPHIC SYMBOLS**
- (B) Brush
 - (PW) Partially wooded
 - (W) Wooded
 - (C) Cleared
 - (P) Pastured
 - (A) Agricultural
 - B.M. Bench Mark
 - Dwelling
 - Resort
 - Camp

- LAKE BOTTOM SYMBOLS**
- P. Peat
 - Mk. Muck
 - C. Clay
 - M. Marl
 - Sd. Sand
 - St. Silt
 - Gr. Gravel
 - R. Rubble
 - Br. Bedrock
 - ||||| Steep slope
 - - - Indefinite shoreline
 - Marsh
 - Spring
 - Intermittent stream
 - Permanent inlet
 - Permanent outlet
 - Dam
 - D.N.R. State owned land
 - B Boulders
 - Stumps & Snags
 - Rock danger to navigation
 - T Submergent vegetation
 - Emergent vegetation
 - Floating vegetation
 - Brush shelters



◆ Access ◆ Access with Parking ◆ Boat Livery
 Drawn by: C. Holt
 Field work by: J. Smith

SPECIES OF FISH	ABUNDANCE		
	Abundant	Common	Present
Muskie			
N. Pike		X	
Walleye			X
L.M. Bass		X	
S.M. Bass			
Panfish	X		
Trout			

WATER AREA 445.0 ACRES
 UNDER 3 FT. 19 %
 OVER 20 FT. 3 %
 MAX. DEPTH 24 FEET.
 TOTAL ALK. 153 P.P.M.
 VOLUME 4196 ACRE FT.
 SHORELINE 18 MILES

Source: Wisconsin Department of Natural Resources 608-266-2621
Camelot Lake – Adams County, Wisconsin DNR Lake Map
Date – Aug 1971 - Historical Lake Map - Not for Navigation
A Public Document - Please Identify the Source when using it.