

LAKE SURVEY MAP

LAKE SUNDAY FORM FI-117
 SECTION 3-10
 TOWNSHIP 39 N
 RANGE 5 E
 TOWN OF MINOCQUA
 COUNTY ONEIDA

WISCONSIN CONSERVATION DEPARTMENT
 BIOLOGY DIVISION
 LAKE AND STREAM IMPROVEMENT SECTION

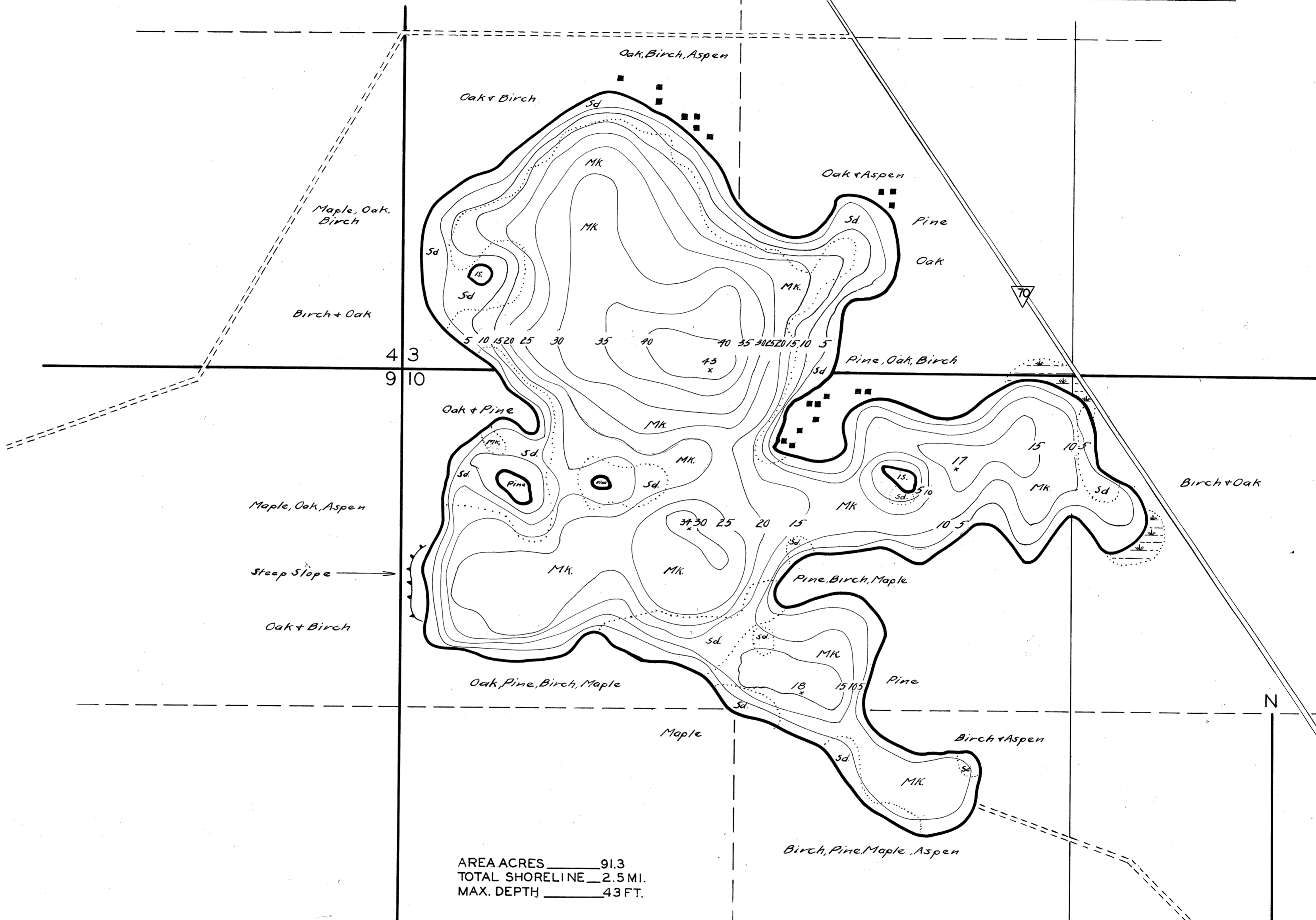

AREA ACRES 91.3
 TOTAL SHORELINE 2.5 MI.
 MAX. DEPTH 43 FT.

DATE AUG 15 1941
 COMPILED BY _____
 TRACED BY E.M.K. (W.P.A.)
 SOURCE OF INFORMATION CAMP BLUE LAKE LAKE SURVEY PROJECT. WPA LAKE IMPROVEMENT PROJECT
 SOUNDINGS AT 150 FT. INTERVALS
 DATES OF MAP REVISION _____
 WORK AGENCY CCC

LAKE IMPROVEMENT RECORD

TYPE	DATE	1936			
BRUSH REFUGES		<u>4</u>			
SAPLING TANGLES		<u>16</u>			
SPAWNING BOXES					
* MINNOW SPAWNERS		<u>56</u>			
TOTAL		<u>76</u>			

SCALE 1 INCH EQUALS 300 FT.

0 100 200 300 400 500 FT.

- LEGEND
- WEED BEDS
 - ROCKY SHOALS
 - SD SAND
 - CL CLAY
 - GR GRAVEL
 - MK MUCK
 - DWELLING
 - ABANDONED DWELLING
 - RESORT
 - STEEP SLOPE

Source: Wisconsin Department of Natural Resources 608-266-2621
Sunday Lake – Oneida County, Wisconsin DNR Lake Map
Date – Aug 1941 - Historical Lake Map - Not for Navigation
A Public Document - Please Identify the Source when using it.