

Elderon 5 miles → 25 30 36 31

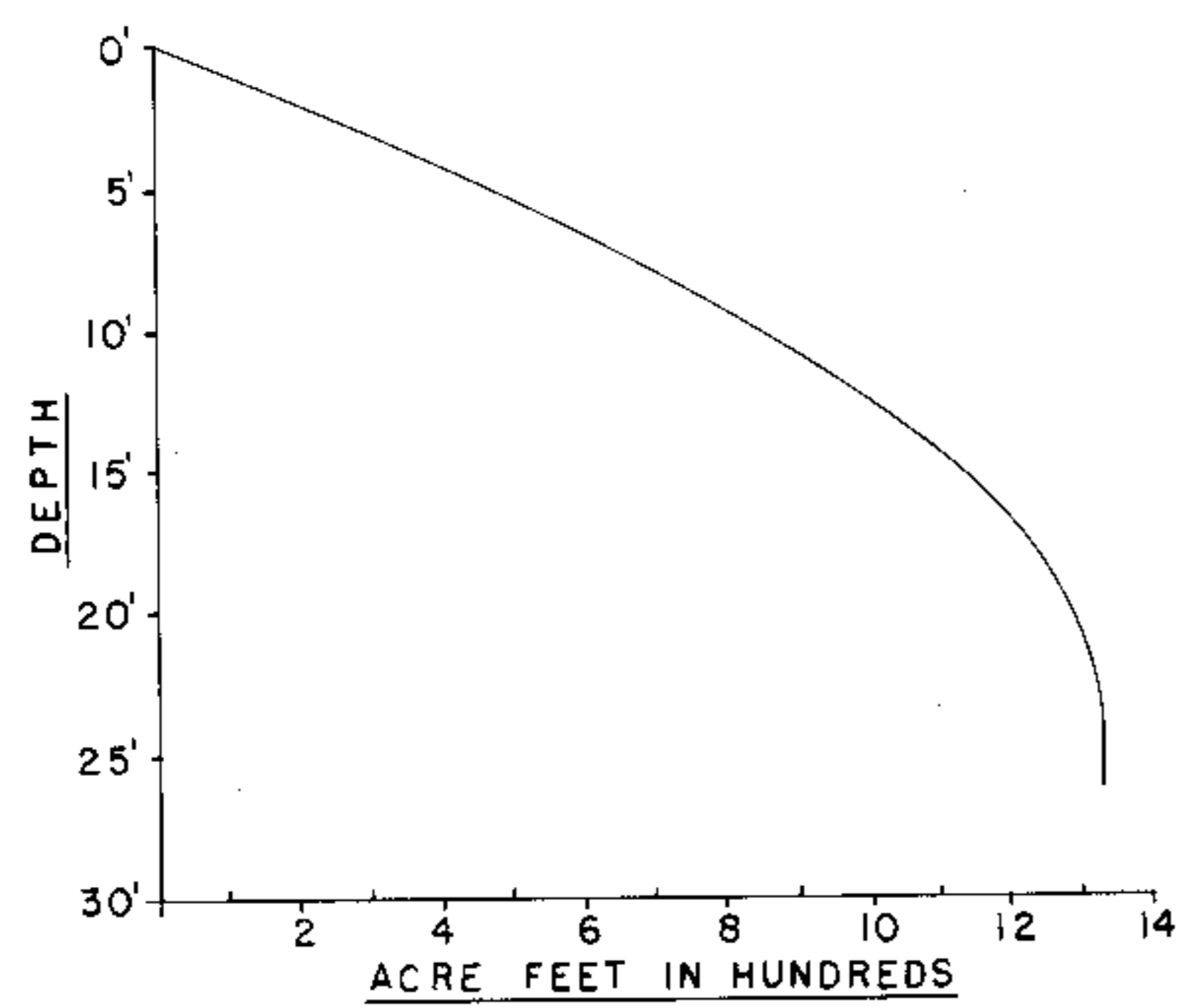
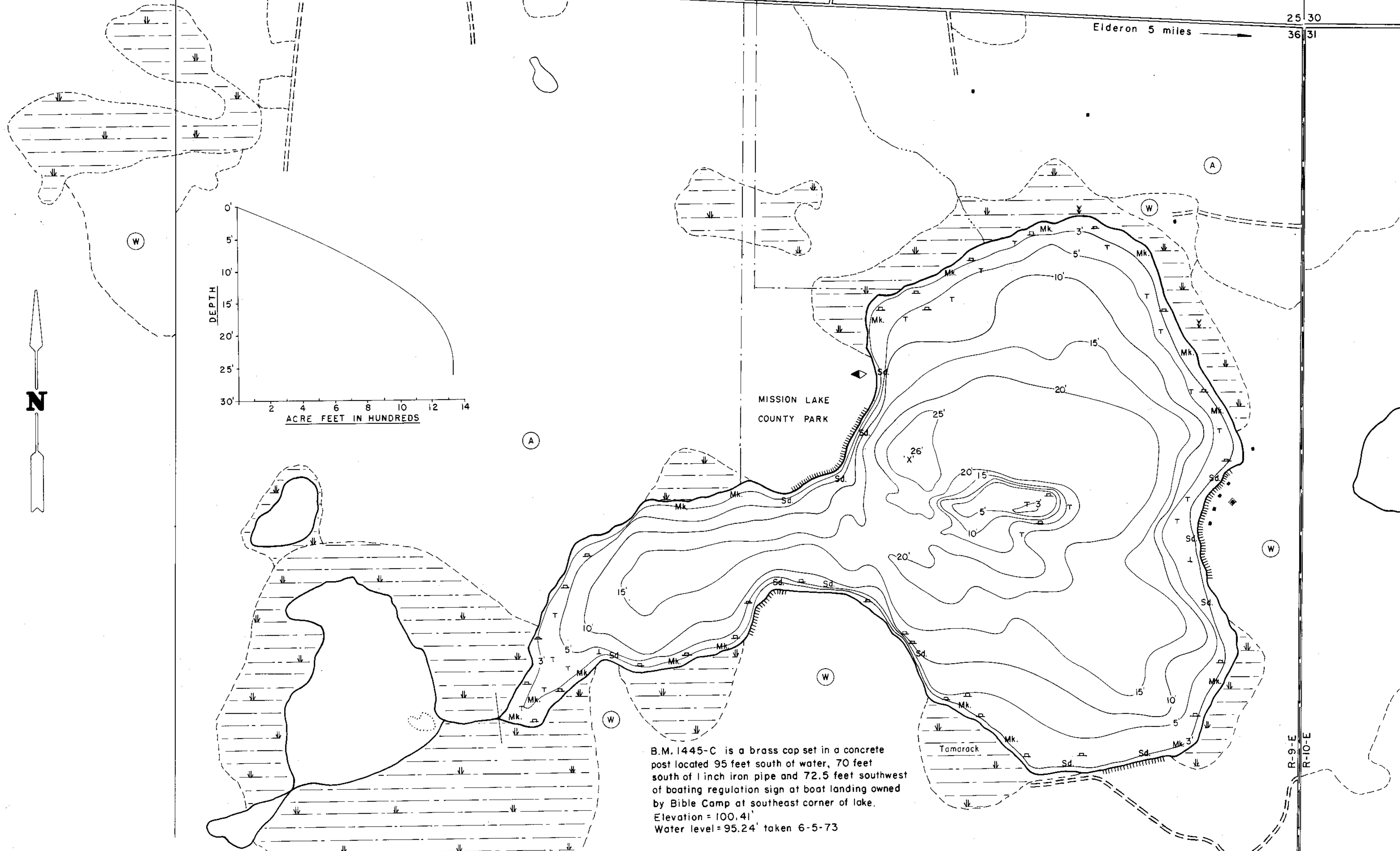

B.M. 1445-C is a brass cap set in a concrete post located 95 feet south of water, 70 feet south of 1 inch iron pipe and 72.5 feet southwest of boating regulation sign at boat landing owned by Bible Camp at southeast corner of lake.
Elevation = 100.41'
Water level = 95.24' taken 6-5-73

EQUIPMENT RECORDING SONAR MAPPED SEPT 1974

- | TOPOGRAPHIC SYMBOLS | | LAKE BOTTOM SYMBOLS | |
|-----------------------|-------------------------------|---------------------|-----------------------------|
| (B) Brush | () Steep slope | P. Peat | B Boulders |
| (PW) Partially wooded | (---) Indefinite shoreline | Mk. Muck | o Stumps & Snags |
| (W) Wooded | (---) Marsh | C. Clay | ⊙ Rock danger to navigation |
| (C) Cleared | (---) Spring | M. Marl | T Submergent vegetation |
| (P) Pastured | (---) Intermittent stream | Sd. Sand | ⊥ Emergent vegetation |
| (A) Agricultural | (---) Permanent inlet | St. Silt | ⊏ Floating vegetation |
| B.M. Bench Mark | (---) Permanent outlet | Gr. Gravel | ⊕ Brush shelters |
| ■ Dwelling | (---) Dam | R. Rubble | |
| ▣ Resort | (---) D.N.R. State owned land | Bc. Bedrock | |
| ▣ Camp | | | |

SPECIES OF FISH	ABUNDANCE		
	Abundant	Common	Present
Muskie		X	
N. Pike			X
Walleye			X
L.M. Bass	X		
S.M. Bass			X
Panfish	X		
Trout			X

WATER AREA 102.84 ACRES
 UNDER 3 FT. 7.7 %
 OVER 20 FT. 16.65 %
 MAX. DEPTH 26 FEET.
 TOTAL ALK. 77 P.P.M.
 VOLUME 1332.12 ACRE FT.
 MAIN SHORELINE 2.12 MI.
 ISLAND SHORELINE 0 MI.



Access Access with Parking Boat Livery
 Drawn by: G. Thuesen
 Field work by: J. Smith, K. Kaplan

Source: Wisconsin Department of Natural Resources 608-266-2621
Mission Lake – Marathon County, Wisconsin DNR Lake Map
Date – Sep 1974 - Historical Lake Map - Not for Navigation
A Public Document - Please Identify the Source when using it.