

Sheet 1 of 2

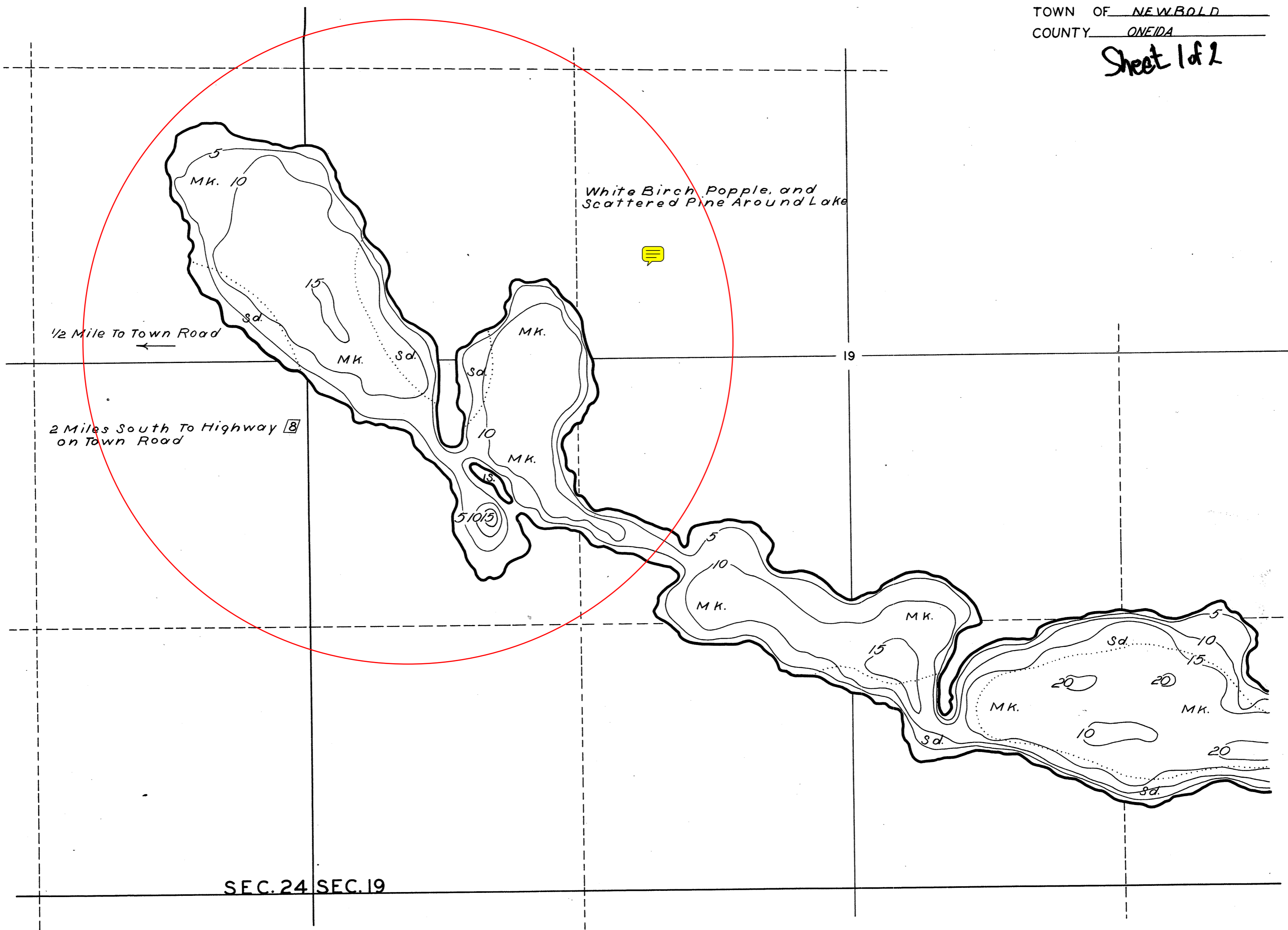

SEC. 24 SEC. 19

AREA: 238 Acres ~~238.0~~  
 TOTAL SHORELINE: 6.5 Miles ~~6.6~~  
 MAX. DEPTH: 4.5 Feet  
 SCALE: 1" = 400'

DATE March 25, 1940  
 COMPILED BY O.S.B.  
 TRACED BY T.I.B. C.C.C.  
 SOURCE OF INFORMATION W.R.A. Lake Improvement  
Aerial Photographs:  
Project F.I.M. BID 9-46; F.I.N. BID 9-7  
 SOUNDINGS 12.5' Intervals  
 DATES OF MAP REVISION \_\_\_\_\_  
March 1940  
 WORK AGENCY W.P.A.

| LAKE IMPROVEMENT RECORD |              |
|-------------------------|--------------|
| TYPE                    | DATE 1936-37 |
| ⊗ BRUSH REFUGES         | <u>37</u>    |
| ∞ SAPLING TANGLES       | <u>18.5</u>  |
| □ SPAWNING BOXES        | _____        |
| * MINNOW SPAWNERS       | <u>296</u>   |
| TOTAL                   | <u>518</u>   |

- LEGEND
- ⊗ WEED BEDS
  - ∞ ROCKY SHOALS
  - Sd SAND
  - Cl CLAY
  - Gr GRAVEL
  - MK MUCK
  - DWELLING
  - ABANDONED DWELLING
  - ▣ RESORT

Sheet 2 of 2

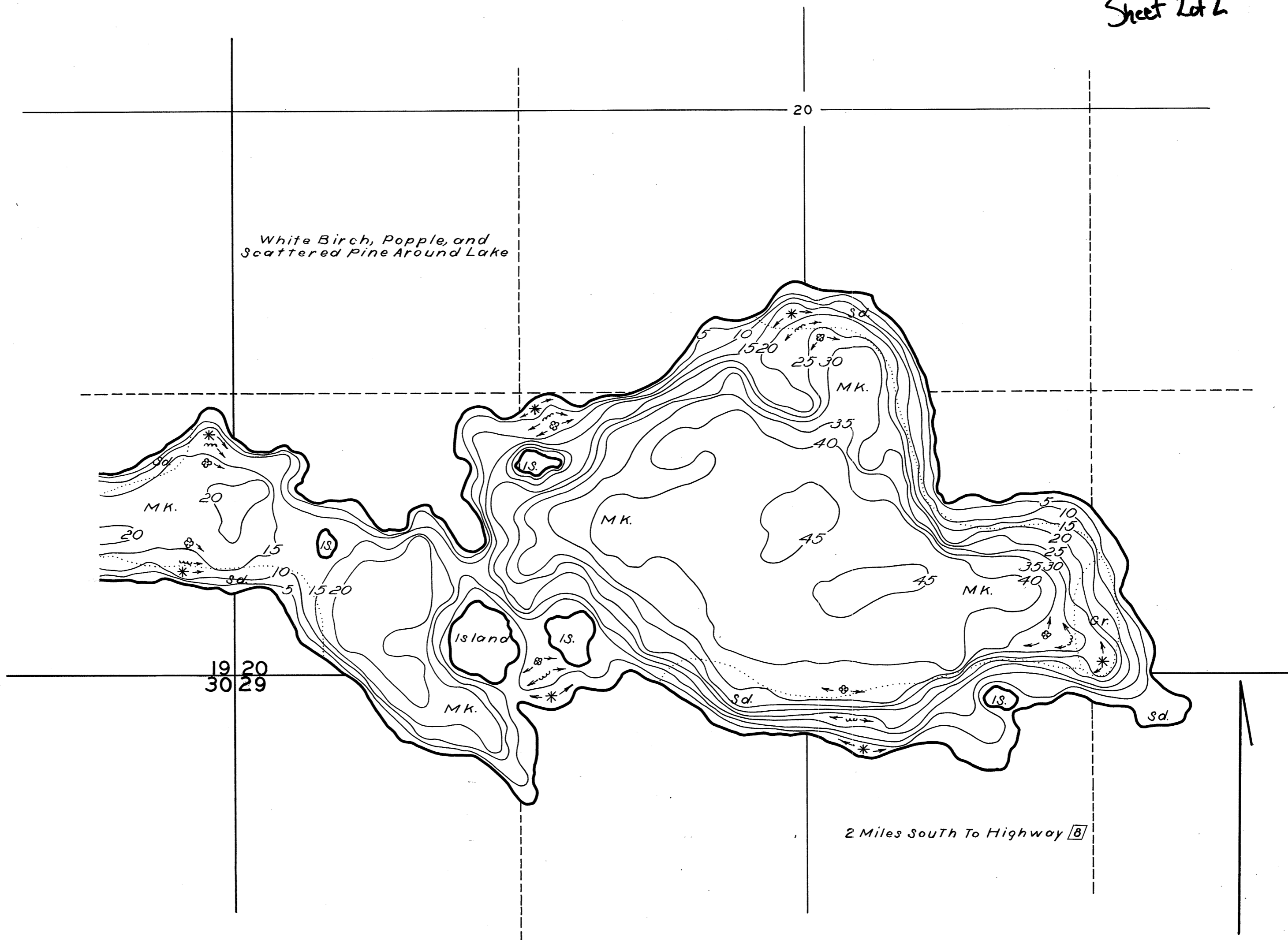

AREA: 238 Acres 238.0  
 TOTAL SHORELINE: 6.5 Miles 6.5  
 MAX. DEPTH: 45 Feet  
 SCALE: 1" = 400'

DATE March 25, 1940  
 COMPILED BY O.S.B.  
 TRACED BY T.J.R. C.C.C.  
 SOURCE OF INFORMATION \_\_\_\_\_  
WPA Lake Improvement  
Project F.L.M. BID 9-16; F.L.N. BID 9-7  
 SOUNDINGS 125' Intervals  
 DATES OF MAP REVISION \_\_\_\_\_  
March 1940  
 WORK AGENCY W.P.A.

| LAKE IMPROVEMENT RECORD |              |
|-------------------------|--------------|
| TYPE                    | DATE 1936-37 |
| ⊗ BRUSH REFUGES         | <u>37</u>    |
| ω SAPLING TANGLES       | <u>185</u>   |
| □ SPAWNING BOXES        | _____        |
| * MINNOW SPAWNERS       | <u>296</u>   |
| TOTAL                   | <u>518</u>   |

| LEGEND |                    |
|--------|--------------------|
| ⊗      | WEED BEDS          |
| ⊙      | ROCKY SHOALS       |
| Sd     | SAND               |
| Cl     | CLAY               |
| Gr     | GRAVEL             |
| MK     | MUCK               |
| ■      | DWELLING           |
| □      | ABANDONED DWELLING |
| ■      | RESORT             |

Source: Wisconsin Department of Natural Resources 608-266-2621  
Mildred Lake – Oneida County, Wisconsin DNR Lake Map  
Date – Mar 1940 - Historical Lake Map - Not for Navigation  
A Public Document - Please Identify the Source when using it.