

LAKE SURVEY MAP

LAKE _____ LONG _____
 SECTION 35, 2
 TOWNSHIP 32, 33 N
 RANGE 10 E
 TOWN OF UPHAM
 COUNTY LANGLADE

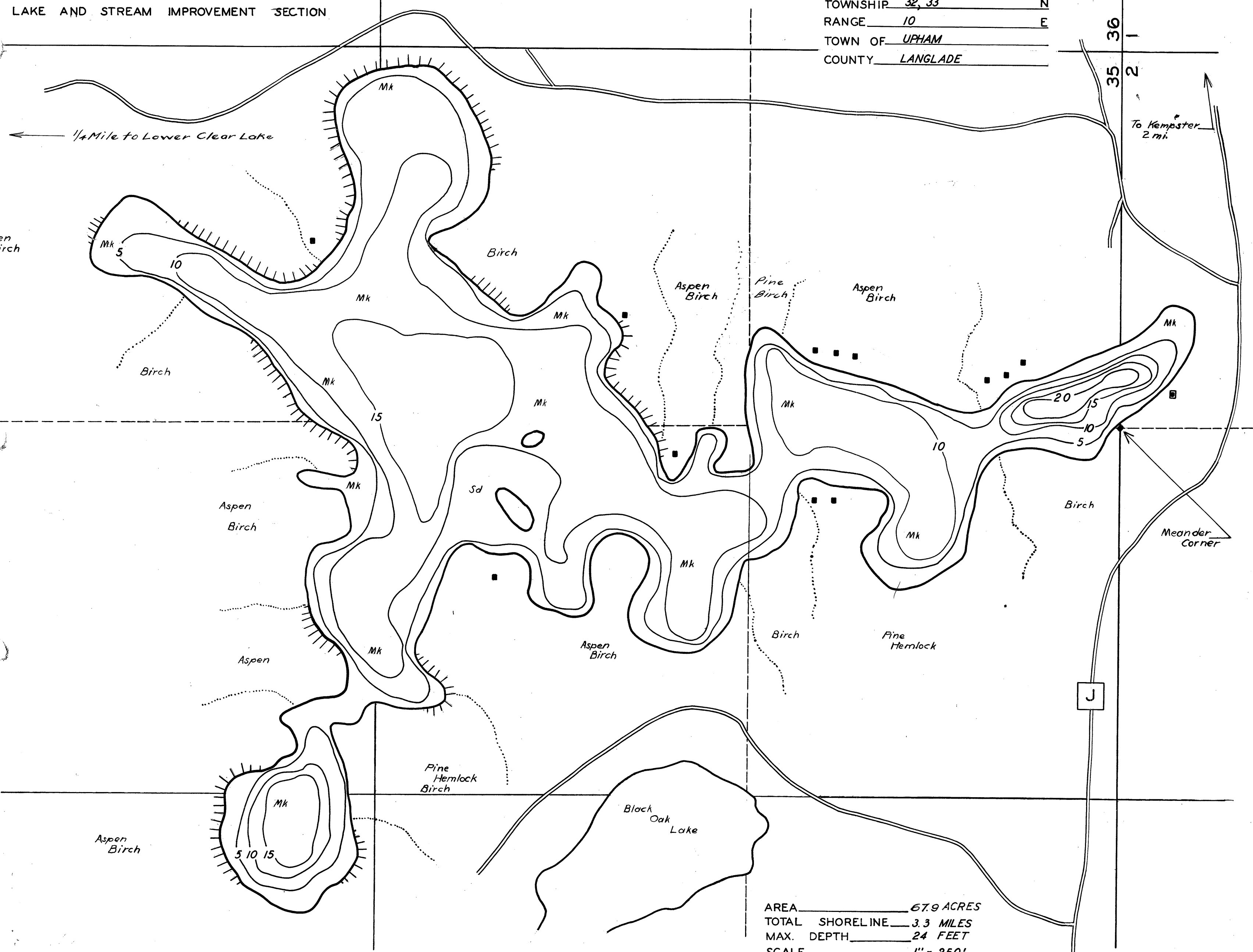

← 1/4 Mile to Lower Clear Lake

To Kempster 2 mi.

J

Meander Corner

AREA _____ 67.9 ACRES
 TOTAL SHORELINE _____ 3.3 MILES
 MAX. DEPTH _____ 24 FEET
 SCALE _____ 1" = 250'

DATE JULY 23 1941
 COMPILED BY L.E.H. C.C.C.
 TRACED BY J.D. C.C.C.
 SOURCE OF INFORMATION _____
CAMP ELCHO LAKE SURVEY PROJ.
WPA LAKE IMPROVEMENT PROJ.
 SOUNDINGS 250 FOOT INTERVALS

 DATES OF MAP REVISION _____
 WORK AGENCY C.C.C. & WPA.

LAKE IMPROVEMENT RECORD

TYPE	DATE	35-36	_____	_____
⊕ BRUSH REFUGES		<u>21</u>	_____	_____
∩ SAPLING TANGLES		<u>105</u>	_____	_____
□ SPAWNING BOXES		_____	_____	_____
* MINNOW SPAWNERS		<u>153</u>	_____	_____
TOTAL		<u>279</u>	_____	_____

LEGEND

- ⊕ WEED BEDS
- ⊙ ROCKY SHOALS
- Sd SAND
- Cl CLAY
- Gr GRAVEL
- Mk MUCK
- DWELLING
- ABANDONED DWELLING
- ▣ RESORT

Source: Wisconsin Department of Natural Resources 608-266-2621
Long Lake- Langlade County, Wisconsin DNR Lake Map
Date Jul 1941 - Historical Lake Map - Not for Navigation
A Public Document - Please Identify the Source when using it.