

LAKE SURVEY MAP

WISCONSIN CONSERVATION DEPARTMENT
BIOLOGY DIVISION
 LAKE AND STREAM IMPROVEMENT SECTION

LAKE HILLIS
 SECTION 35
 TOWNSHIP 40 N
 RANGE 6 E
 TOWN OF ARBOR VITAE
 COUNTY VILAS

FORM FI-117

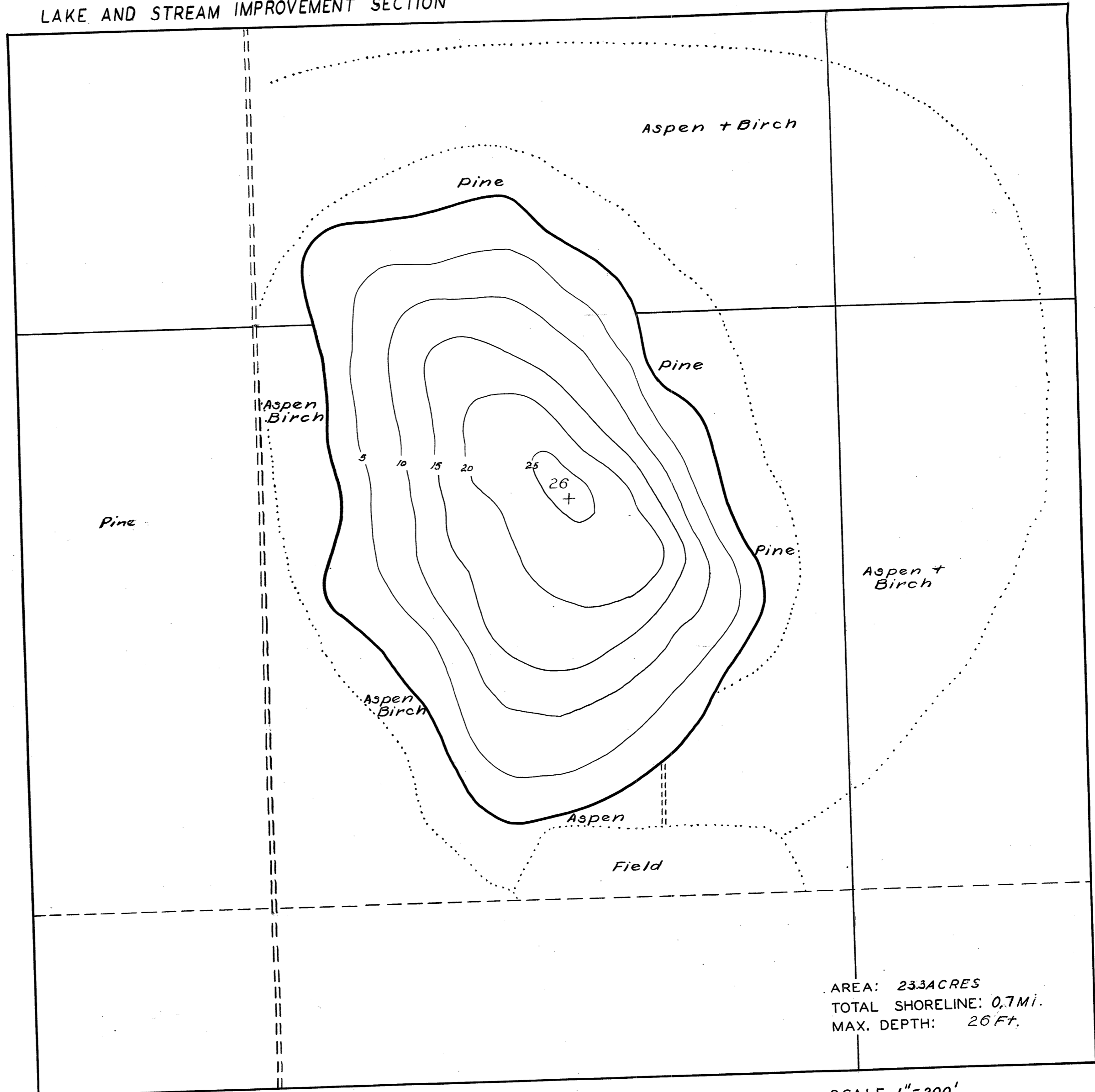

DATE September 1939
 COMPILED BY L.W.
 TRACED BY T.F.B. CCC 84-S
 SOURCE OF INFORMATION
Wis Geol. & Nat. Hist. Survey
WPA Research Project
 SOUNDINGS _____
 DATES OF MAP REVISION _____
 WORK AGENCY _____

LAKE IMPROVEMENT RECORD

TYPE	DATE	_____	_____	_____
BRUSH REFUGES	_____	_____	_____	_____
SAPLING TANGLES	_____	_____	_____	_____
SPAWNING BOXES	_____	_____	_____	_____
MINNOW SPAWNERS	_____	_____	_____	_____
TOTAL	_____	_____	_____	_____

- LEGEND
- WEED BEDS
 - ROCKY SHOALS
 - SAND
 - CLAY
 - GRAVEL
 - MUCK
 - DWELLING
 - ABANDONED DWELLING
 - RESORT

SCALE 1"=200'

Source: Wisconsin Department of Natural Resources 608-266-2621
Hillis Lake – Vilas County, Wisconsin DNR Lake Map
Date – Sep 1939 - Historical Lake Map - Not for Navigation .
A Public Document - Please Identify the Source when using it.