

LAKE SURVEY MAP

NEOSHO MILL POND
LAKE
DODGE COUNTY
SEC. 20, 28, 29 T. 10 N. R. 17 E.

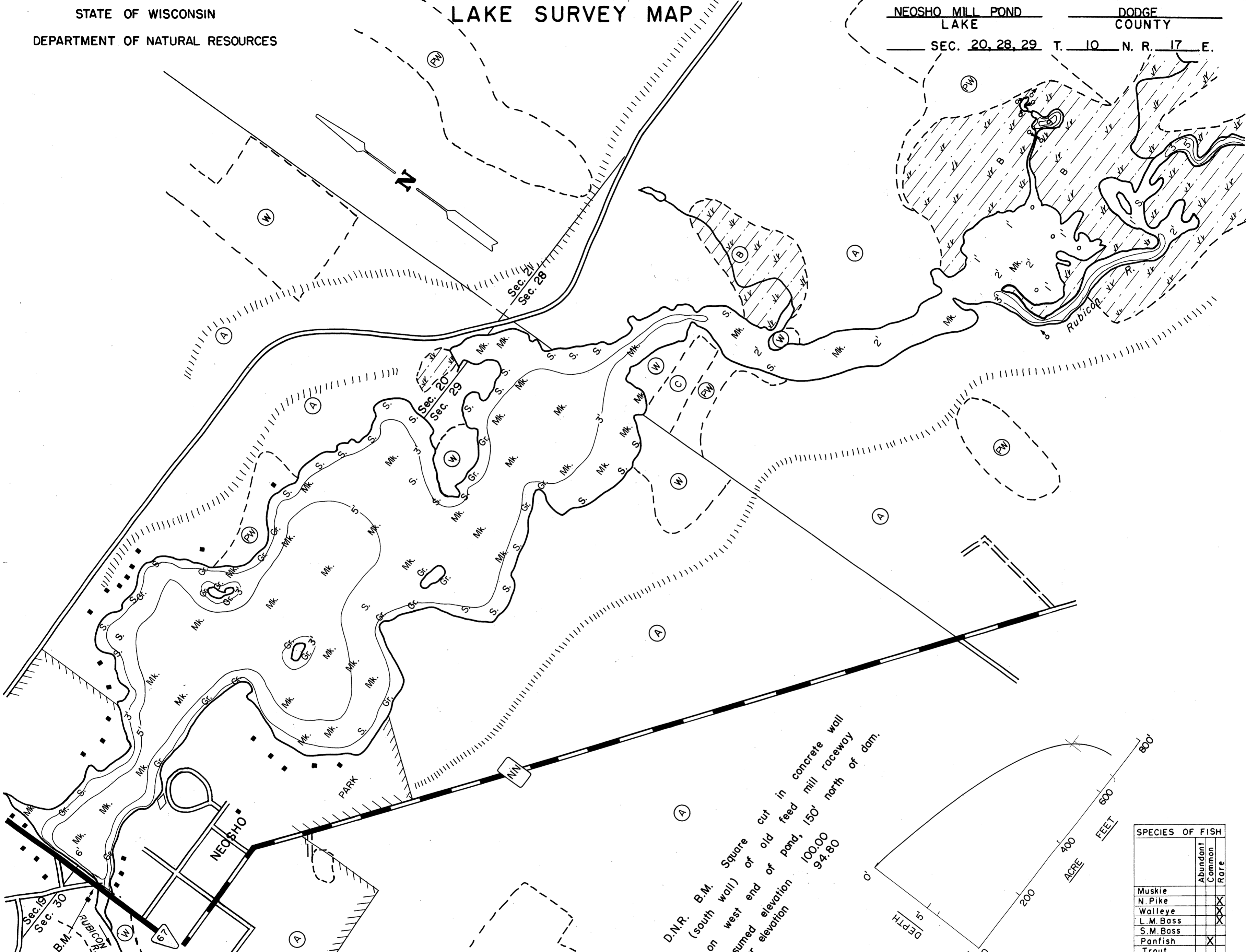

EQUIPMENT RECORDING SONAR MAPPED JUNE 1967
MO. YR.

WATER ELEV. 94.8

- TOPOGRAPHIC SYMBOLS**
- (B) Brush
 - (PW) Partially wooded
 - (W) Wooded
 - (C) Cleared
 - (P) Pastured
 - (A) Agricultural
 - B.M. Bench Mark
 - Dwelling
 - Resort
 - ||||| Steep slope
 - - - Indefinite shoreline
 - Marsh
 - Spring
 - Intermittent stream
 - Permanent inlet
 - Permanent outlet
 - Dam

- LAKE BOTTOM SYMBOLS**
- P. Peat
 - Mk. Muck
 - C. Clay
 - M. Marl
 - Sd. Sand
 - St. Silt
 - Gr. Gravel
 - R. Rubble
 - Br. Bedrock
 - T Submergent vegetation
 - Emergent vegetation
 - Floating vegetation
 - Stumps & Snags

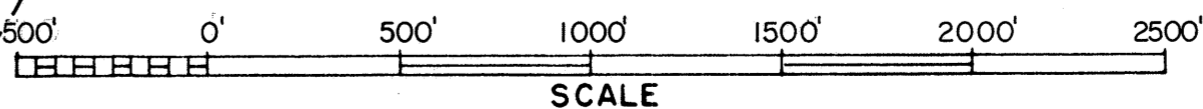

◇ Access ◀ Access with Parking ◆ Boat Livery
Field work by: G. Werdin, L. Rice Drawn by: R. Ripp

D.N.R. B.M. Square cut in concrete wall
(south wall) of old feed mill raceway
on west end of pond, 150' north of dam.
Assumed elevation 100.00
Water elevation 94.80

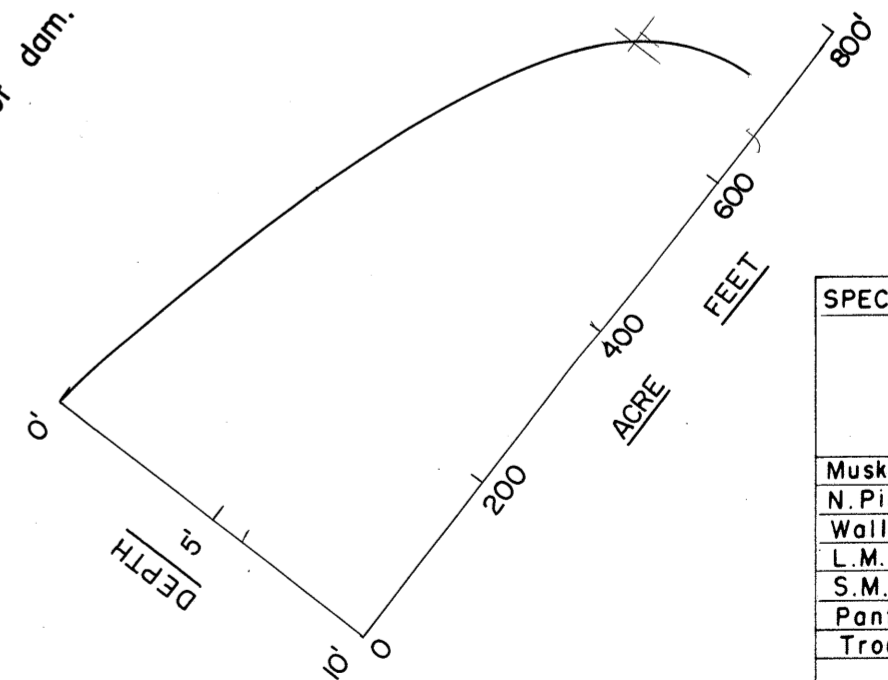

SPECIES OF FISH	Abundance	
	Abundant	Common
Muskie		
N. Pike		X
Walleye		X
L. M. Bass		X
S. M. Bass		X
Panfish	X	
Trout		

AREA 187.4 ACRES
UNDER 3FT. 37.0 %
OVER 20FT. 0.0 %
VOLUME 714.7 ACRE FT.
TOTAL ALK. 146 P.P.M.
SHORELINE 7.7 MILES
MAX. DEPTH 6 FEET

Source: Wisconsin Department of Natural Resources 608-266-2621
Nesho Mill Pond - Dodge County, Wisconsin DNR Lake Map
Date – Jun 1967 - Historical Lake Map - Not for Navigation
A Public Document - Please Identify the Source when using it.