

DATE 6/21/55  
 SOURCE OF INFORMATION W.G.D.  
 \_\_\_\_\_  
 \_\_\_\_\_  
 SOUNDINGS Echo Sounder

Sheet No. 2  
 Sheet No. 3  
 AREA 1,104 Acres (total)  
 TOTAL SHORELINE 12.8 Miles  
 MAX. DEPTH 90 Feet  
 SCALE: 1" = 500'

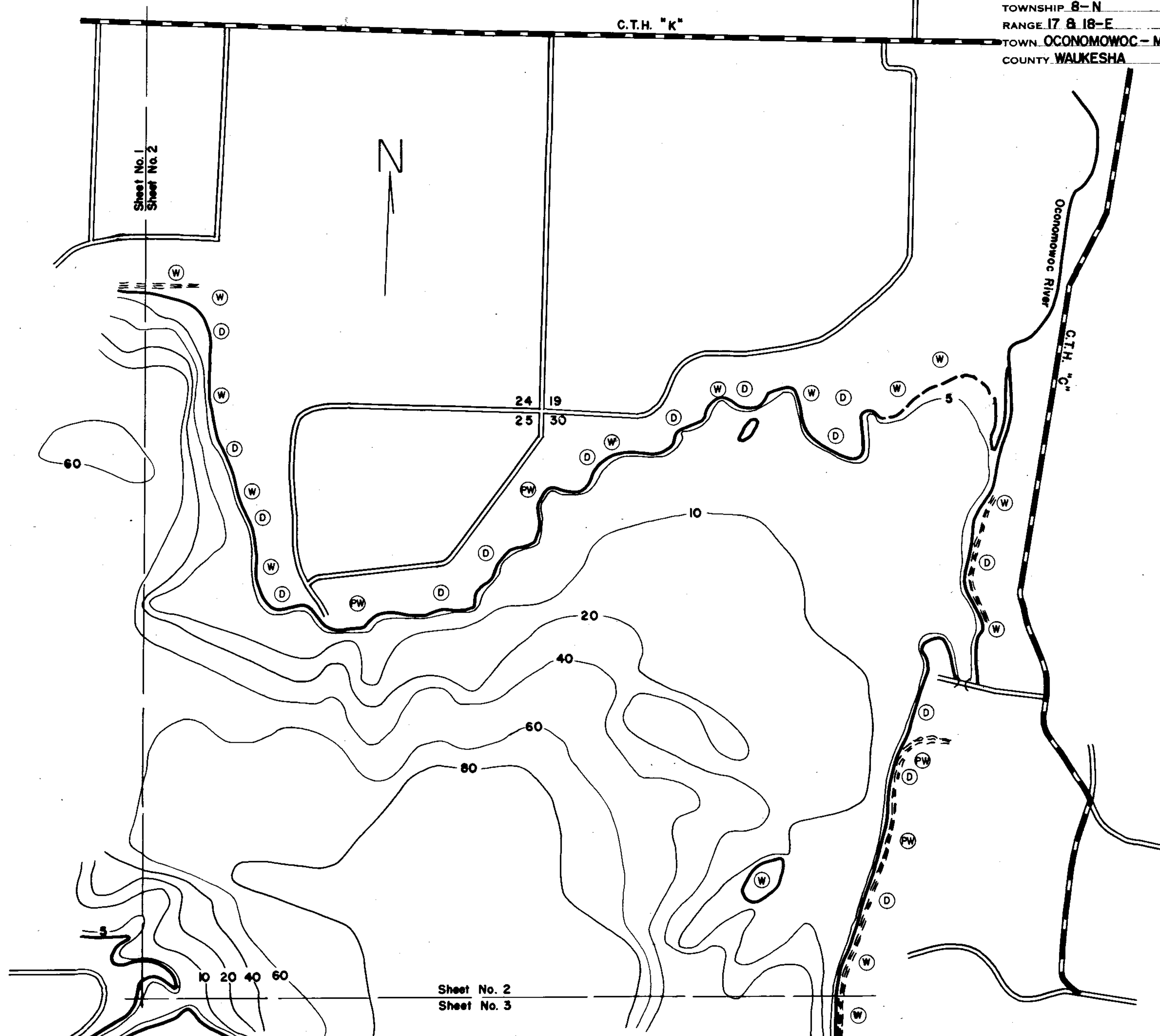

Sheet No. 1  
Sheet No. 2

N

24 19  
25 30

Oconomowoc River

C.T.H. "C"

Sheet No. 2  
Sheet No. 3

DATE 6/21/55

SOURCE OF INFORMATION W.G.D.

SOUNDINGS Echo Sounder

AREA 1,104 Acres (total)

TOTAL SHORELINE 12.8 Miles

MAX. DEPTH 90 Feet

SCALE: 1" = 500'

Sheet No. 1  
Sheet No. 2

Sheet No. 2  
Sheet No. 3

26 25  
35 36

25 30  
36 31

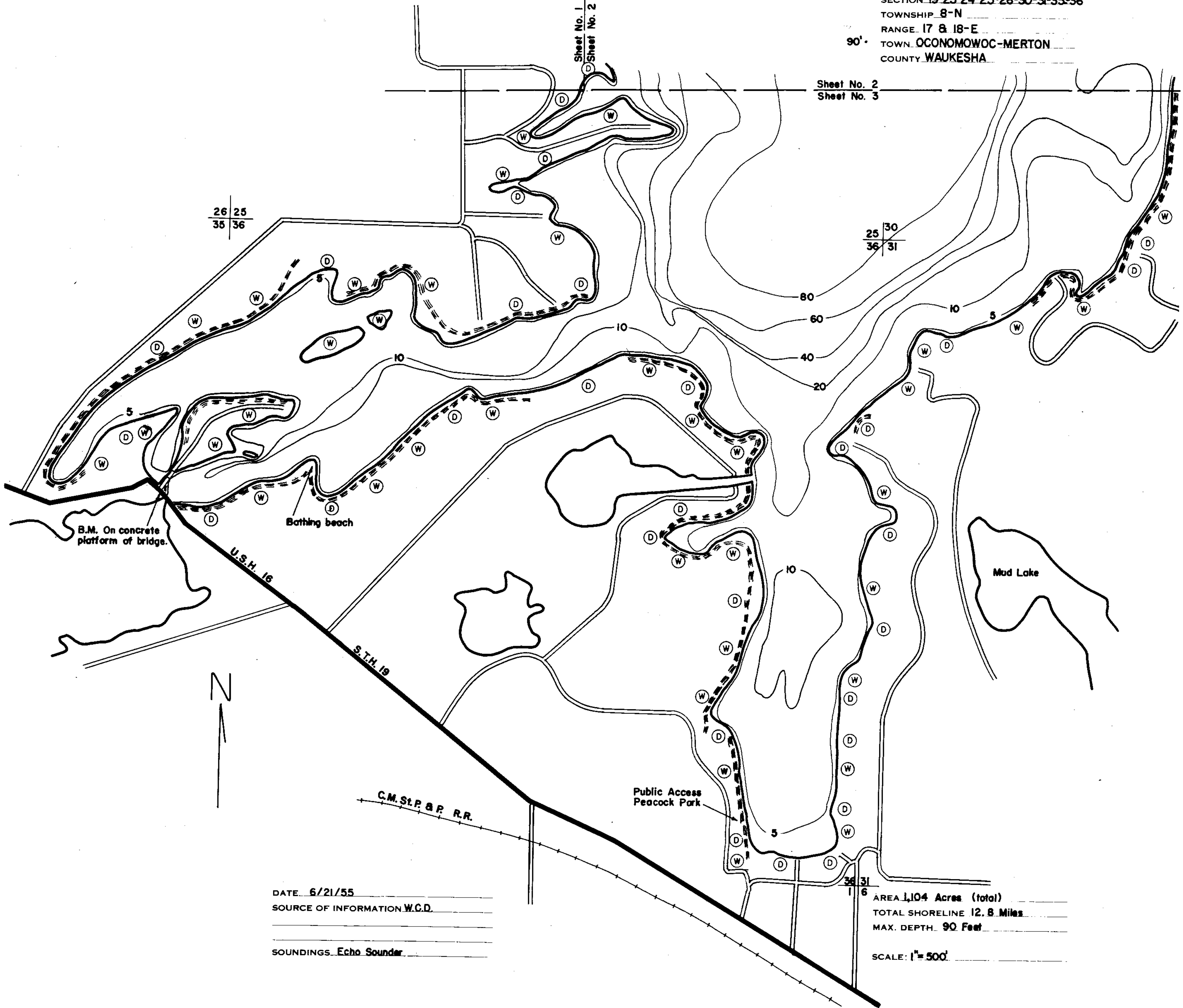

B.M. On concrete platform of bridge.

Bathing beach

U.S.H. 16

S.T.H. 19

C.M. St. P. & P. R.R.

Public Access Peacock Park

Mud Lake



DATE 6/21/55  
 SOURCE OF INFORMATION W.C.D.  
 SOUNDINGS Echo Sounder

AREA 1,104 Acres (total)  
 TOTAL SHORELINE 12.8 Miles  
 MAX. DEPTH 90 Feet  
 SCALE: 1" = 500'

Source: Wisconsin Department of Natural Resources 608-266-2621  
Okauchee Lake – Waukesha County, Wisconsin DNR Lake Map  
Date – Jun 1955 - Historical Lake Map - Not for Navigation  
A Public Document - Please Identify the Source when using it.