

LAKE RED CEDAR
SECTION 16-17-20-21
TOWNSHIP T-6-N
RANGE R-13-E
TOWN OAKLAND
COUNTY JEFFERSON

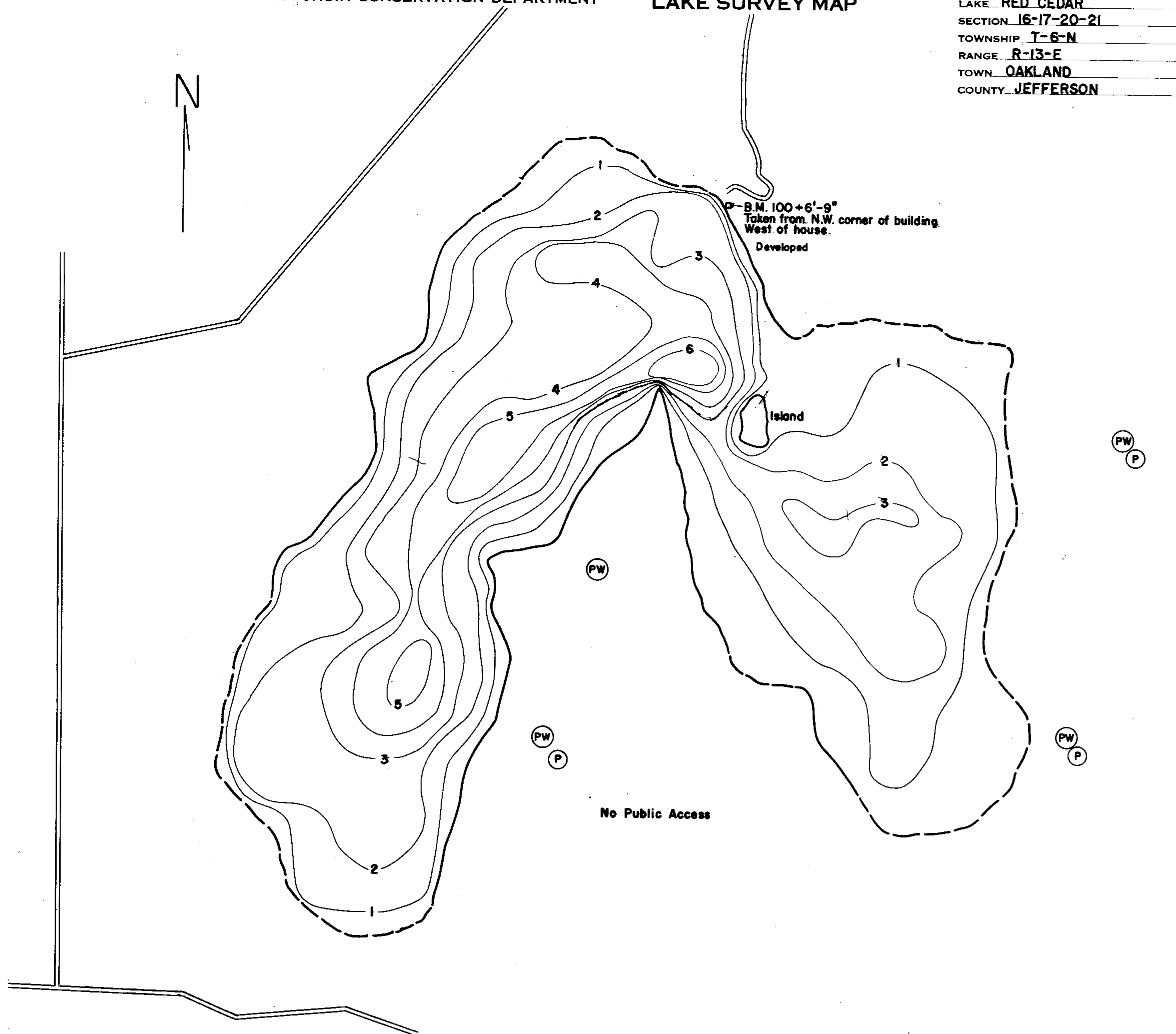

DATE _____
SOURCE OF INFORMATION W.C.D.
Contours at 1' intervals
SOUNDINGS Echo Sounder

AREA 358.6 Acres
TOTAL SHORELINE 4.5 Miles
MAX. DEPTH 6 Feet
SCALE: 1" = 500'

Source: Wisconsin Department of Natural Resources 608-266-2621
Red Cedar Lake – Jefferson County, Wisconsin DNR Lake Map
Date – Unknown - Historical Lake Map - Not for Navigation
A Public Document - Please Identify the Source when using it.