

B.M. 'X' 1344 - A is a 1" X cut in top of gate hitching post, 2' above ground at access on south side of lake & north end of Scout camp  
Assumed Elev. 100.00'  
Water Elev. 93.70'

5 4  
8 9

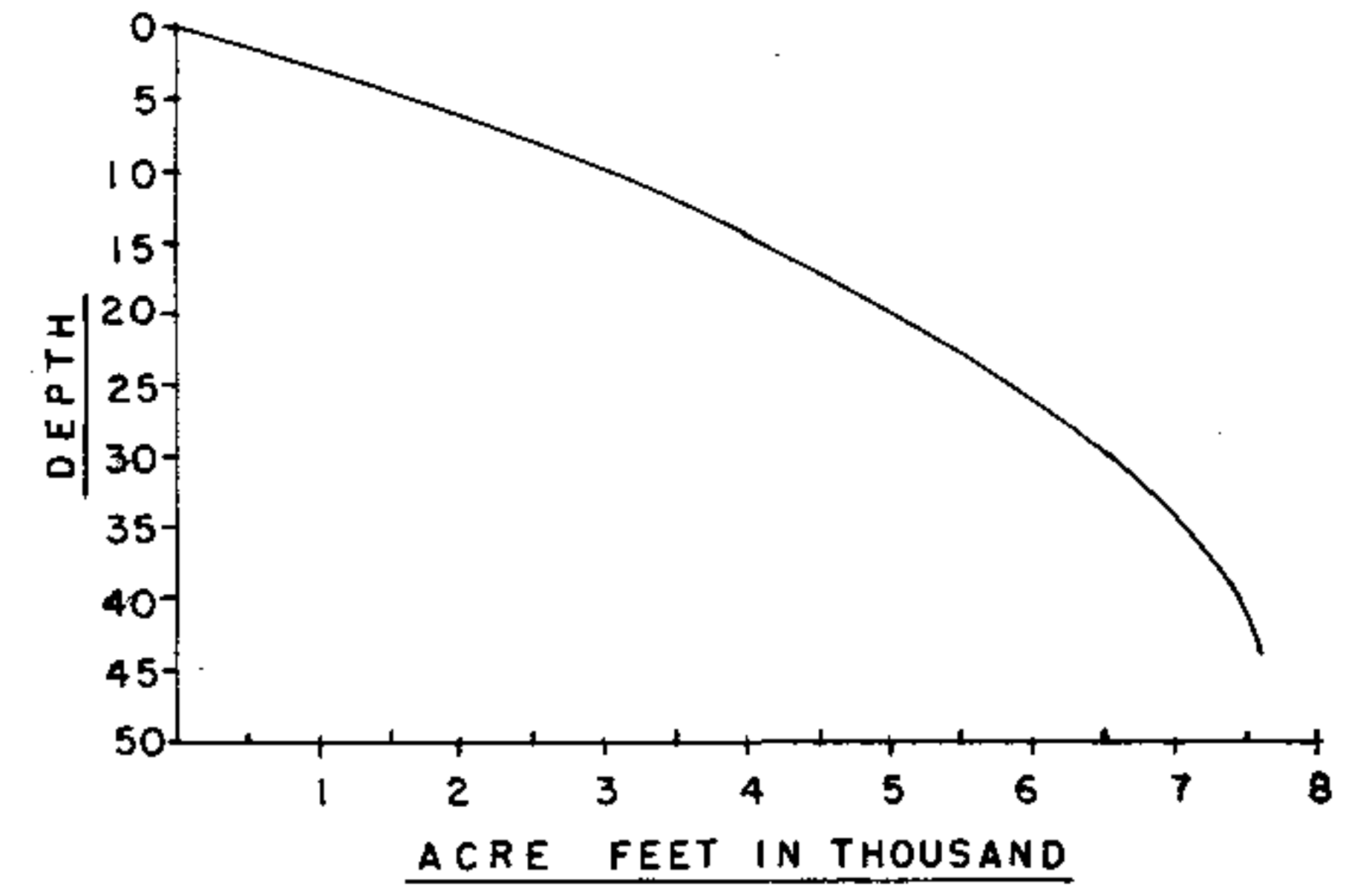
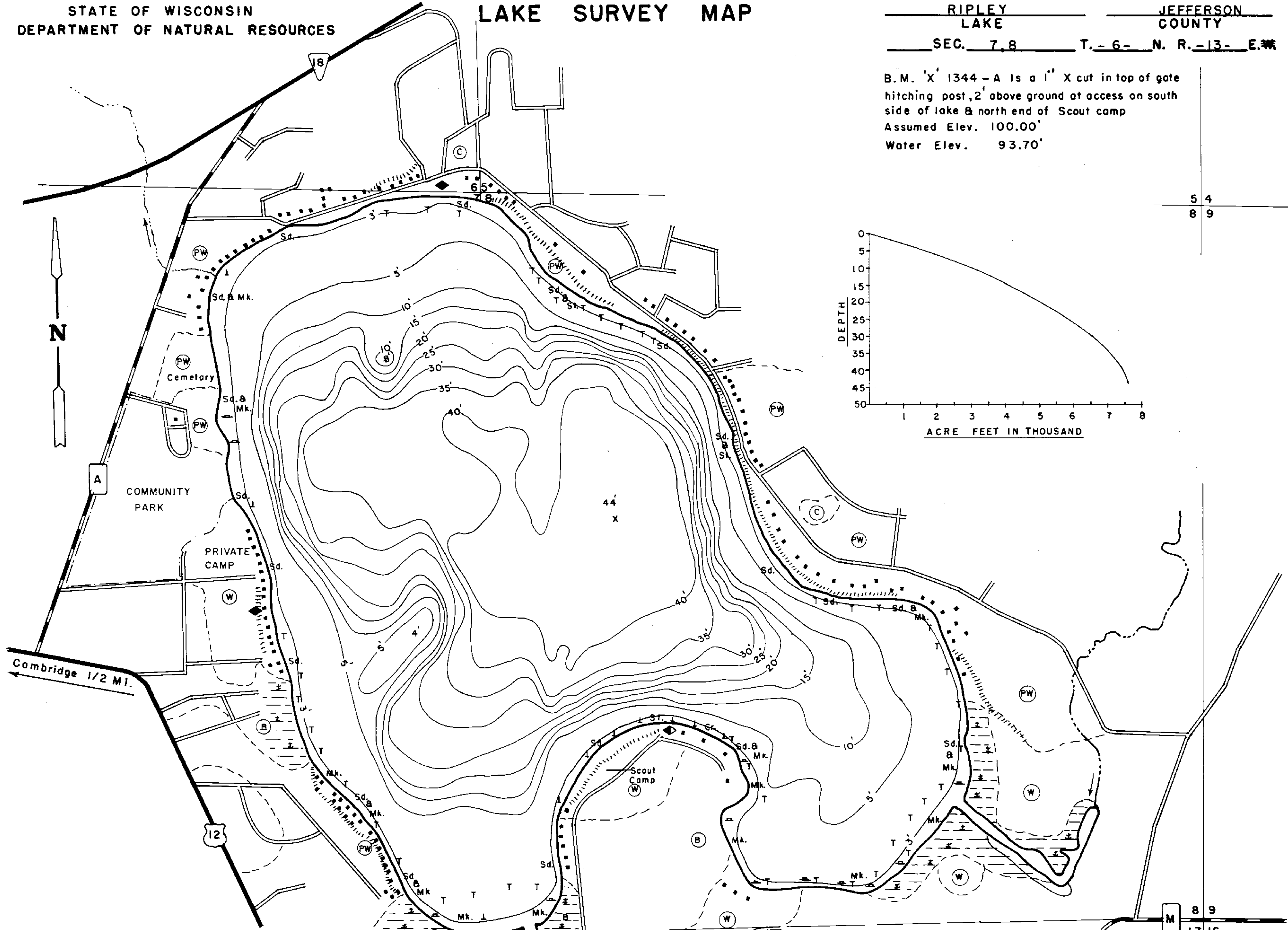

EQUIPMENT RECORDING SONAR MAPPED AUGUST 1970

- TOPOGRAPHIC SYMBOLS
- (B) Brush
  - (PW) Partially wooded
  - (W) Wooded
  - (C) Cleared
  - (P) Pastured
  - (A) Agricultural
  - B.M. Bench Mark
  - Dwelling
  - Resort
  - Camp
- LAKE BOTTOM SYMBOLS
- iiiiiii Steep slope
  - Indefinite shoreline
  - Marsh
  - Spring
  - Intermittent stream
  - Permanent inlet
  - Permanent outlet
  - D.N.R. State owned land
  - P. Peat
  - Mk. Muck
  - C. Clay
  - M. Marl
  - Sd. Sand
  - St. Silt
  - Gr. Gravel
  - R. Rubble
  - Br. Bedrock
  - B Boulders
  - Stumps & Snags
  - Rock danger to navigation
  - T Submergent vegetation
  - l Emergent vegetation
  - Floating vegetation
  - Brush shelters



Drawn by: E. Eaton  
Field work by: M. Ganga, J. Bakken

SPECIES OF FISH	Abundance		
	Abundant	Common	Present
Muskie			
N. Pike		X	
Walleye			X
L. M. Bass	X		
S. M. Bass			
Panfish	X		
Trout			

WATER AREA 418.1 ACRES  
UNDER 3 FT. 8. %  
OVER 20 FT. 41. %  
MAX. DEPTH 44 FEET.  
TOTAL ALK. 220 P.P.M.  
VOLUME 7,561.2 ACRE FT.  
SHORELINE 4.85 MILES  
WITHOUT IS. 4.56 MILES

Source: Wisconsin Department of Natural Resources 608-266-2621  
Ripley Lake – Jefferson County, Wisconsin DNR Lake Map  
Date – Aug 1970 - Historical Lake Map - Not for Navigation  
A Public Document - Please Identify the Source when using it.