

LAKE FOREST
 SECTION 6-31
 TOWNSHIP T-8-N
 RANGE R-18-E
 TOWN MERTON
 COUNTY WAUKESHA

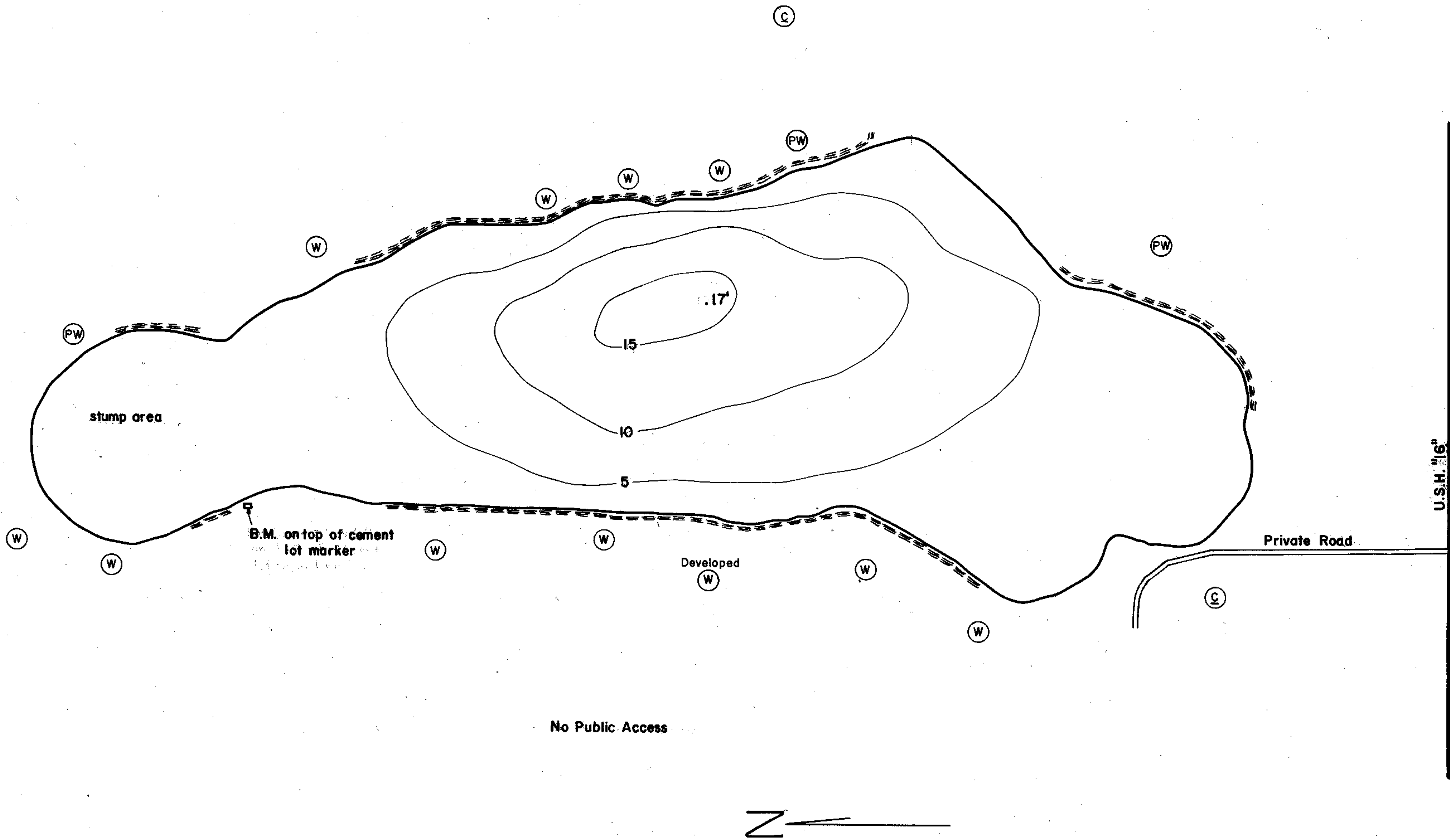

DATE Unknown
 SOURCE OF INFORMATION W.C.D.
Contours at 5' intervals
 SOUNDINGS Echo Sounder

AREA 45.2 Acres
 TOTAL SHORELINE 1.3 Miles
 MAX. DEPTH 17 Feet
 SCALE: 1" = 200'

Source: Wisconsin Department of Natural Resources 608-266-2621
Forest Lake – Waukesha County, Wisconsin DNR Lake Map
Date – Unknown - Historical Lake Map - Not for Navigation
A Public Document - Please Identify the Source when using it.