

B.M. 'X' FX-N-37 Also P.S.C.B.M.
Bronze tablet top center guard rail of S. side
bridge on C.T.H. 'J'
Elevation 814.39

SEC. 4,8,9,17,18 T. -4- N. R. -18- E.#.
(Sheet 1 of 2)

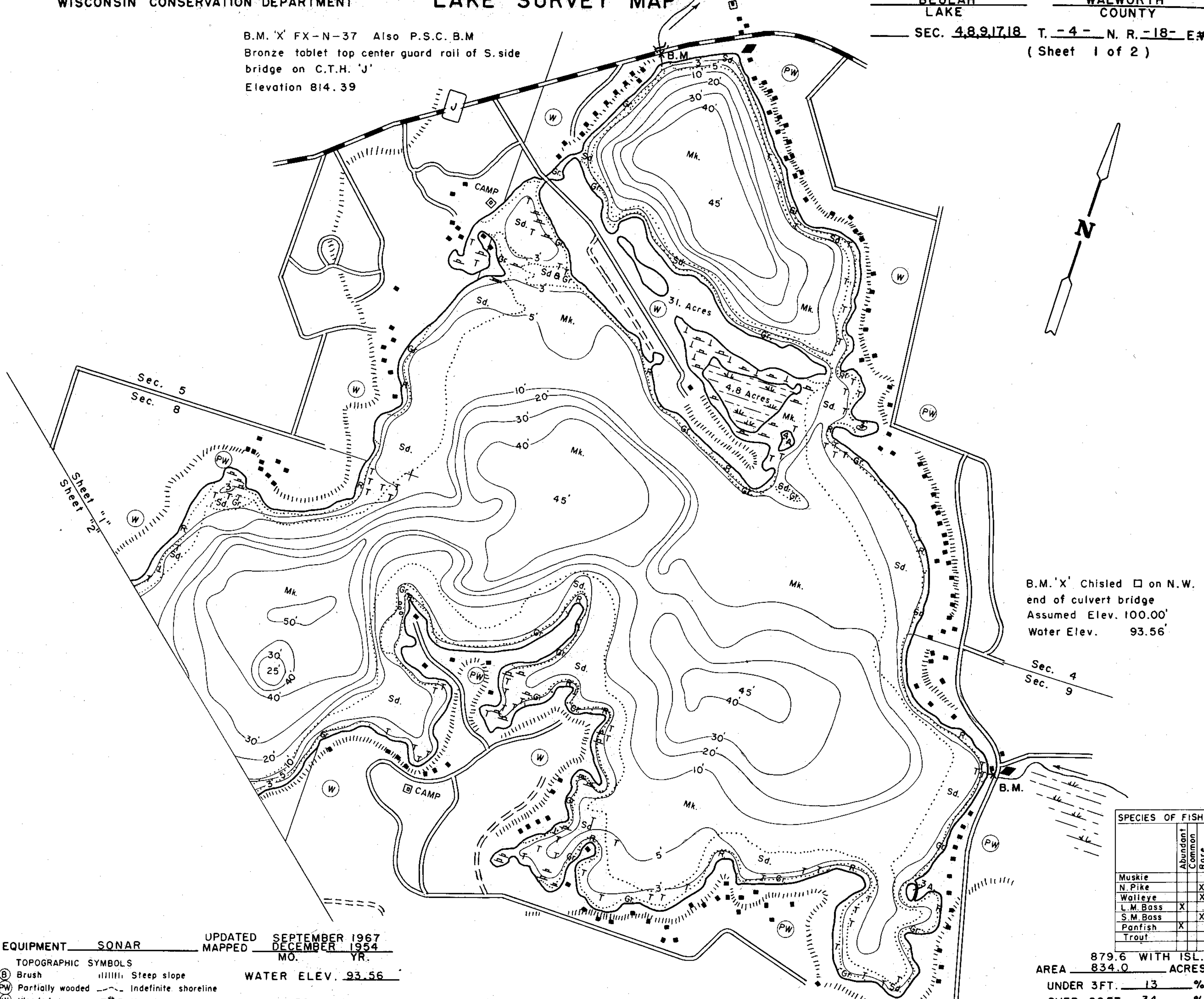

B.M. 'X' Chisled □ on N.W.
end of culvert bridge
Assumed Elev. 100.00'
Water Elev. 93.56'

EQUIPMENT SONAR UPDATED SEPTEMBER 1967
MAPPED DECEMBER 1954
MO. YR.

- TOPOGRAPHIC SYMBOLS
- (B) Brush
 - (PW) Partially wooded
 - (W) Wooded
 - (C) Cleared
 - (P) Pastured
 - (A) Agricultural
 - B.M. Bench Mark
 - Dwelling
 - ⊠ Resort
 - ||||| Steep slope
 - - - Indefinite shoreline
 - ⊠ Marsh
 - Spring
 - - - Intermittent stream
 - ≡ Permanent inlet
 - ≡ Permanent outlet
 - ⊠ Dam

- LAKE BOTTOM SYMBOLS
- P. Peat
 - Mk. Muck
 - C. Clay
 - M. Marl
 - Sd. Sand
 - St. Silt
 - Gr. Gravel
 - R. Rubble
 - Br. Bedrock
 - T Emergent vegetation
 - ⊠ Submergent vegetation
 - ⊠ Floating vegetation
 - ⊠ Stumps & Snags



◇ Access ◇ Access with Parking ◇ Boat Livery
Field work by H. Schwenn, R. Spielman Drawn by E. Eaton

SPECIES OF FISH	Abundance		
	Abundant	Common	Rare
Muskie			
N. Pike			X
Walleye			X
L.M. Bass	X		
S.M. Bass			X
Panfish	X		
Trout			

879.6 WITH ISL.
AREA 834.0 ACRES
UNDER 3FT. 13 %
OVER 20FT. 34 %
VOLUME 14,279.0 ACRE FT.
TOTAL ALK. 168 P.P.M.
SHORELINE 15.3 MILES
MAX. DEPTH 58 FEET

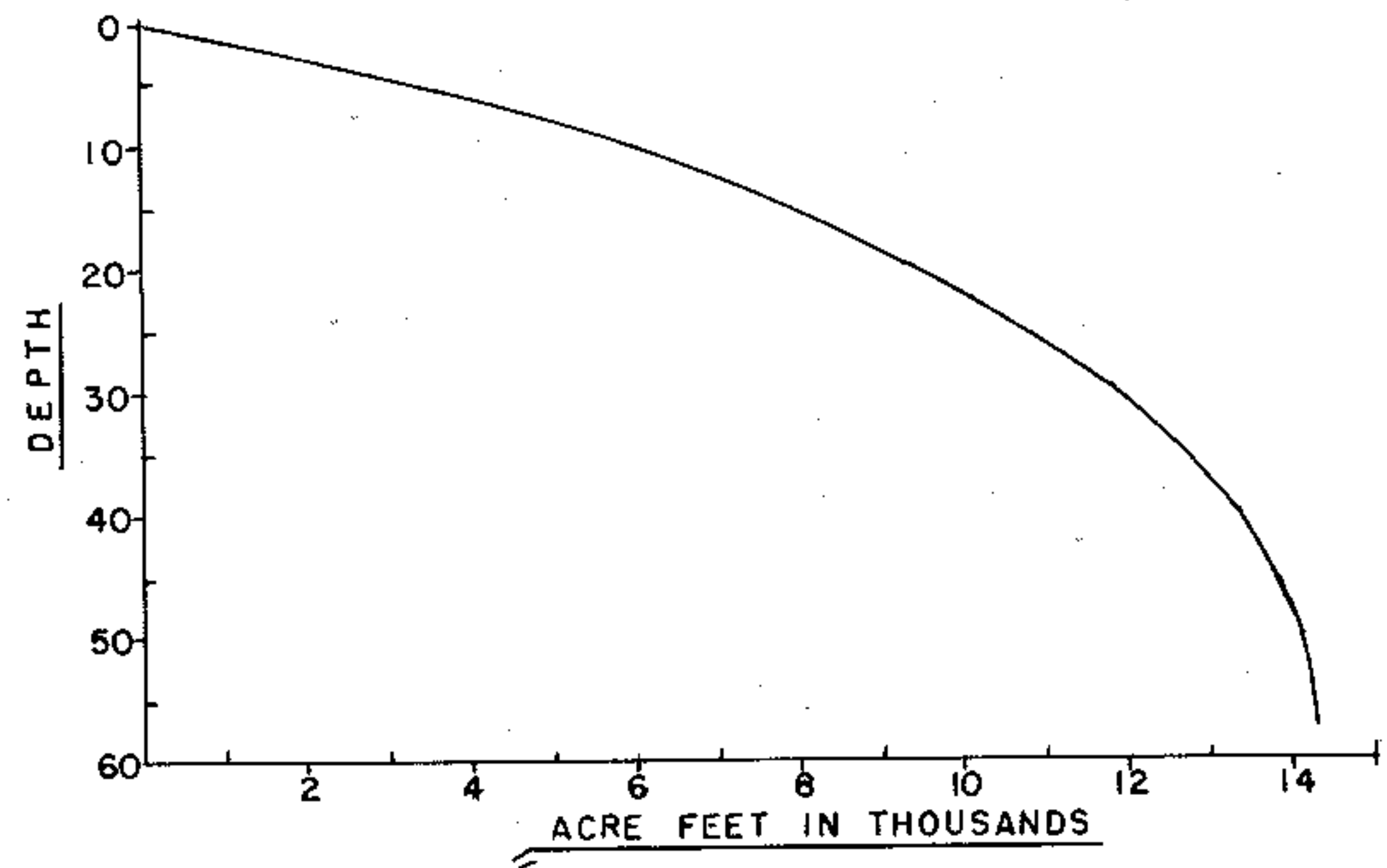
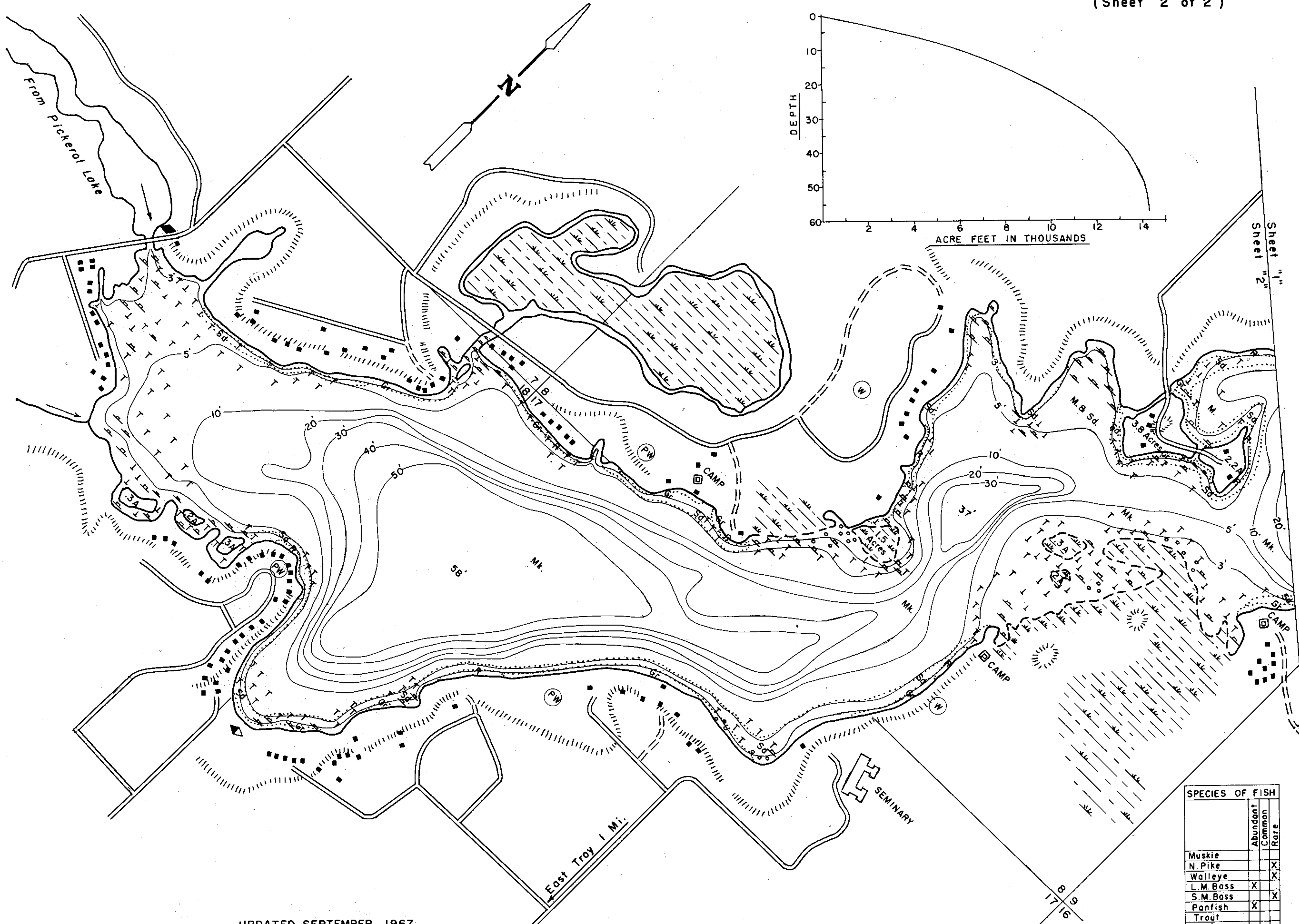

EQUIPMENT SONAR MAPPED SEPTEMBER 1967
 MAPPED DECEMBER 1954
 MO. YR.

- TOPOGRAPHIC SYMBOLS
- (B) Brush
 - (PW) Partially wooded
 - (W) Wooded
 - (C) Cleared
 - (P) Pastured
 - (A) Agricultural
 - B.M. Bench Mark
 - Dwelling
 - Resort

- LAKE BOTTOM SYMBOLS
- P. Peat
 - Mk. Muck
 - C. Clay
 - M. Marl
 - Sd. Sand
 - St. Silt
 - Gr. Gravel
 - R. Rubble
 - Br. Bedrock
 - T Submergent vegetation
 - l Emergent vegetation
 - Floating vegetation
 - Stumps & Snags

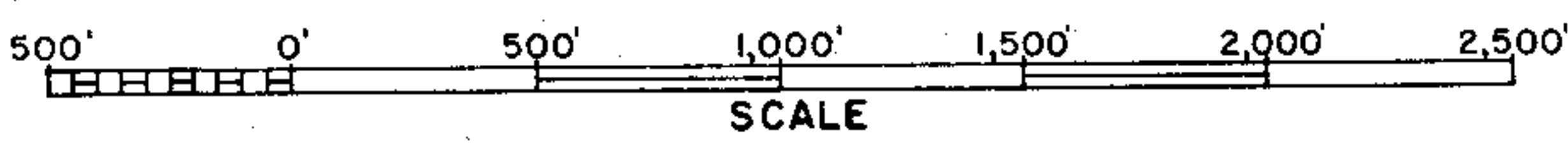

◇ Access ◈ Access with Parking ◆ Boat Livery
 Field work by: H. Schwenn, R. Spielman Drawn by: E. Eaton

SPECIES OF FISH	Abundance	
	Common	Rare
Muskie		
N. Pike		X
Walleye		X
L. M. Bass	X	
S. M. Bass		X
Panfish	X	
Trout		

879.6 WITH ISL.
 AREA 834.0 ACRES
 UNDER 3FT. 13 %
 OVER 20FT. 34 %
 VOLUME 14,279.0 ACRE FT.
 TOTAL ALK. 168 P.P.M.
 SHORELINE 15.3 MILES
 MAX. DEPTH 58 FEET

3

LAKE SURVEY MAP

WISCONSIN CONSERVATION DEPARTMENT
BIOLOGY DIVISION
LAKE AND STREAM IMPROVEMENT SECTION

LAKE MILL
SECTION 4
TOWNSHIP 4 N
RANGE 18 E
TOWN OF EAST TROY
COUNTY WALWORTH

FORM FI-117

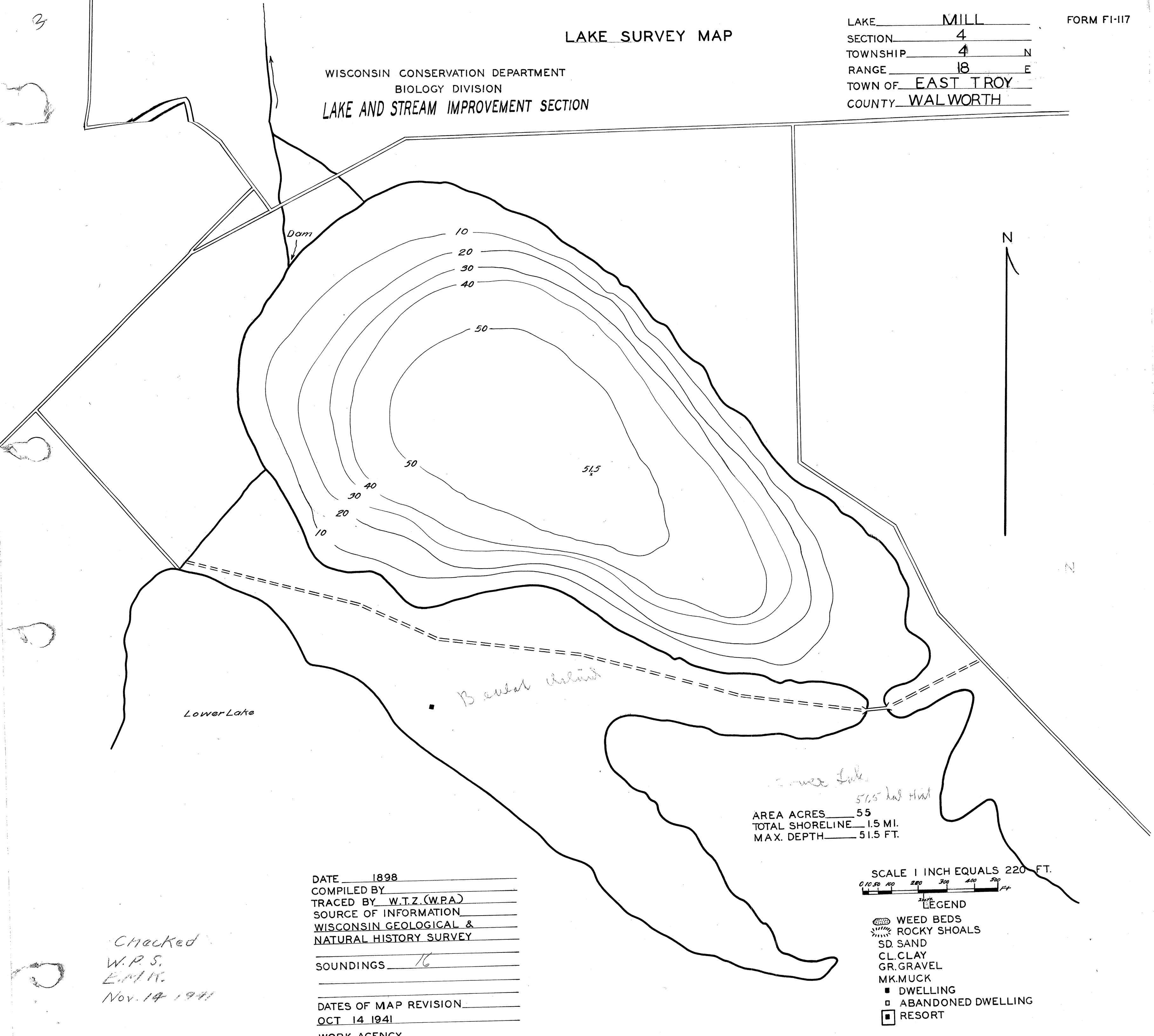

Dam

Lower Lake

Bevelled Island

AREA ACRES 55
TOTAL SHORELINE 1.5 MI.
MAX. DEPTH 51.5 FT.

SCALE 1 INCH EQUALS 220 FT.
0 10 50 100 200 300 400 500 FT.

- LEGEND
- WEED BEDS
 - ROCKY SHOALS
 - SD. SAND
 - CL. CLAY
 - GR. GRAVEL
 - MK. MUCK
 - DWELLING
 - ABANDONED DWELLING
 - RESORT

DATE 1898
 COMPILED BY _____
 TRACED BY W.T.Z. (W.P.A.)
 SOURCE OF INFORMATION _____
WISCONSIN GEOLOGICAL & NATURAL HISTORY SURVEY
 SOUNDINGS 16
 DATES OF MAP REVISION _____
OCT 14 1941
 WORK AGENCY _____

*Checked
W.P.S.
E.M.H.
Nov. 14 1941*

Source: Wisconsin Department of Natural Resources 608-266-2621
Beulah Lake (Mill Lake North end of Beulah)– Walworth County, Wisconsin DNR Lake Map
Date – Sep 1967 - Historical Lake Map - Not for Navigation
A Public Document - Please Identify the Source when using it.