

NICOLET NATIONAL FOREST

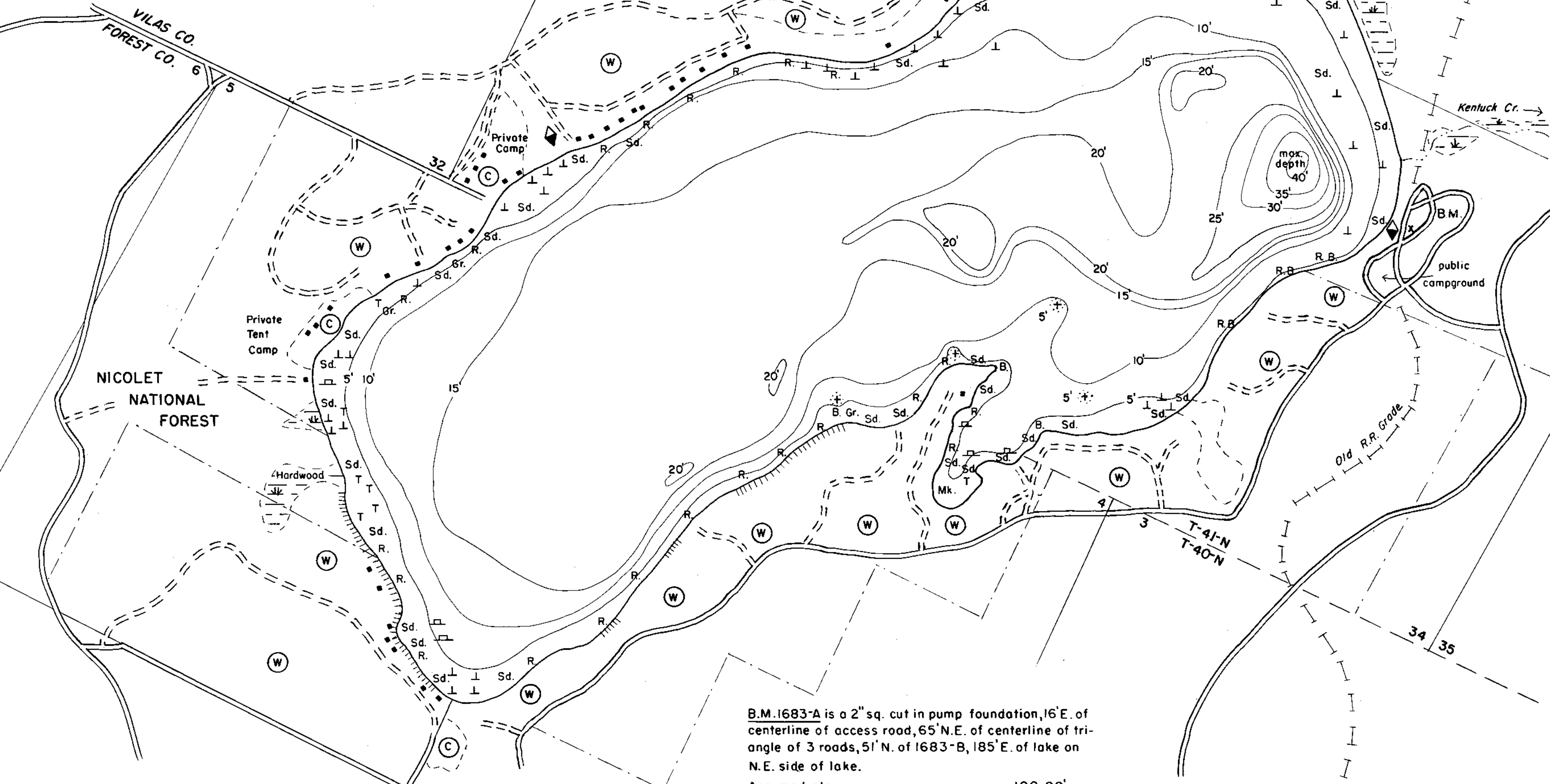
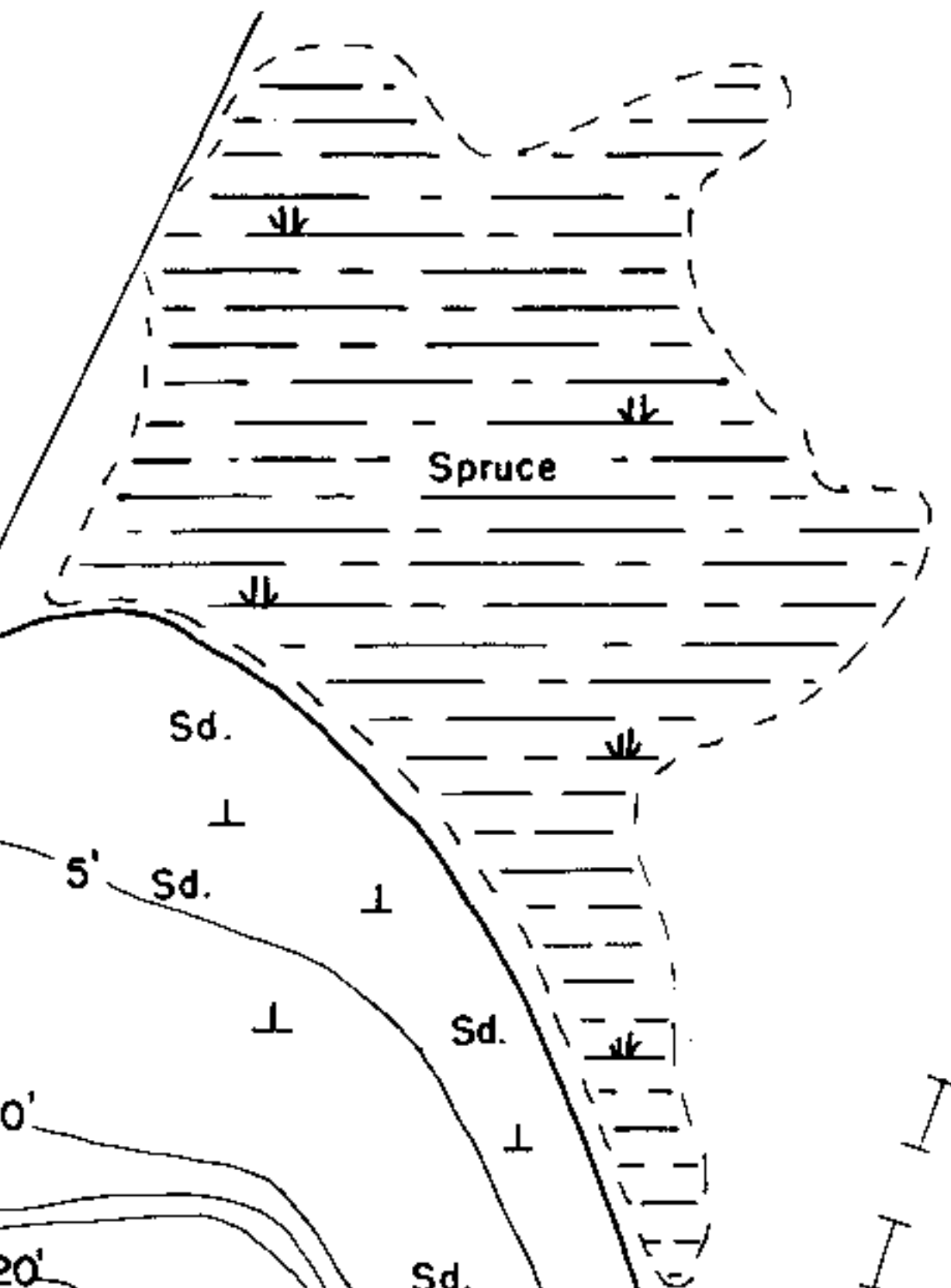

B.M.1683-A is a 2" sq. cut in pump foundation, 16'E. of centerline of access road, 65' N.E. of centerline of triangle of 3 roads, 51' N. of 1683-B, 185' E. of lake on N.E. side of lake.

Assumed elev. 100.00'
Water level 92.91'
Reading taken 11/10/72

EQUIPMENT RECORDING SONAR MAPPED JUNE 1971
MONTH YEAR
LAKE BOTTOM SYMBOLS

- | TOPOGRAPHIC SYMBOLS | | LAKE BOTTOM SYMBOLS | |
|-----------------------|----------------------------|---------------------|-----------------------------|
| (B) Brush | Steep slope | P. Peat | B Boulders |
| (PW) Partially wooded | - - - Indefinite shoreline | Mk. Muck | ⊙ Stumps & Snags |
| (W) Wooded | ⊖ Marsh | C. Clay | ⊙ Rock danger to navigation |
| (C) Cleared | ○ Spring | M. Marl | T Submergent vegetation |
| (P) Pastured | ⊖ Intermittent stream | Sd. Sand | ⊥ Emergent vegetation |
| (A) Agricultural | ⊖ Permanent inlet | St. Silt | ⊖ Floating vegetation |
| B.M. Bench Mark | ⊖ Permanent outlet | Gr. Gravel | ⊖ Brush shelters |
| ■ Dwelling | ⊖ Dam | R. Rubble | |
| □ Resort | D.N.R. State owned land | Bc. Bedrock | |
| ⊖ Camp | | | |



SCALE
◆ Access ◆ Access with Parking ◆ Boat Livery

Drawn by: T. Ginder
Field work by: J. Smith

SPECIES OF FISH	Abundance		
	Abundant	Common	Present
Muskie			X
N. Pike			X
Walleye			X
L.M. Bass			X
S.M. Bass	X		
Panfish	X		
Trout			X
Cisco	X		

WATER AREA 957.49 ACRES
UNDER 3 FT. 8 %
OVER 20 FT. 12 %
MAX. DEPTH 40 FEET.
TOTAL ALK. 36 P.P.M.
VOLUME 12780.80 ACRE FT.
SHORELINE 6.04 MILES

Source: Wisconsin Department of Natural Resources 608-266-2621

Kentuck Lake – Forest and Vilas Counties, Wisconsin DNR Lake Map

Date – Jun 1971 - Historical Lake Map - Not for Navigation

A Public Document - Please Identify the Source when using it.