

LAKE SURVEY MAP

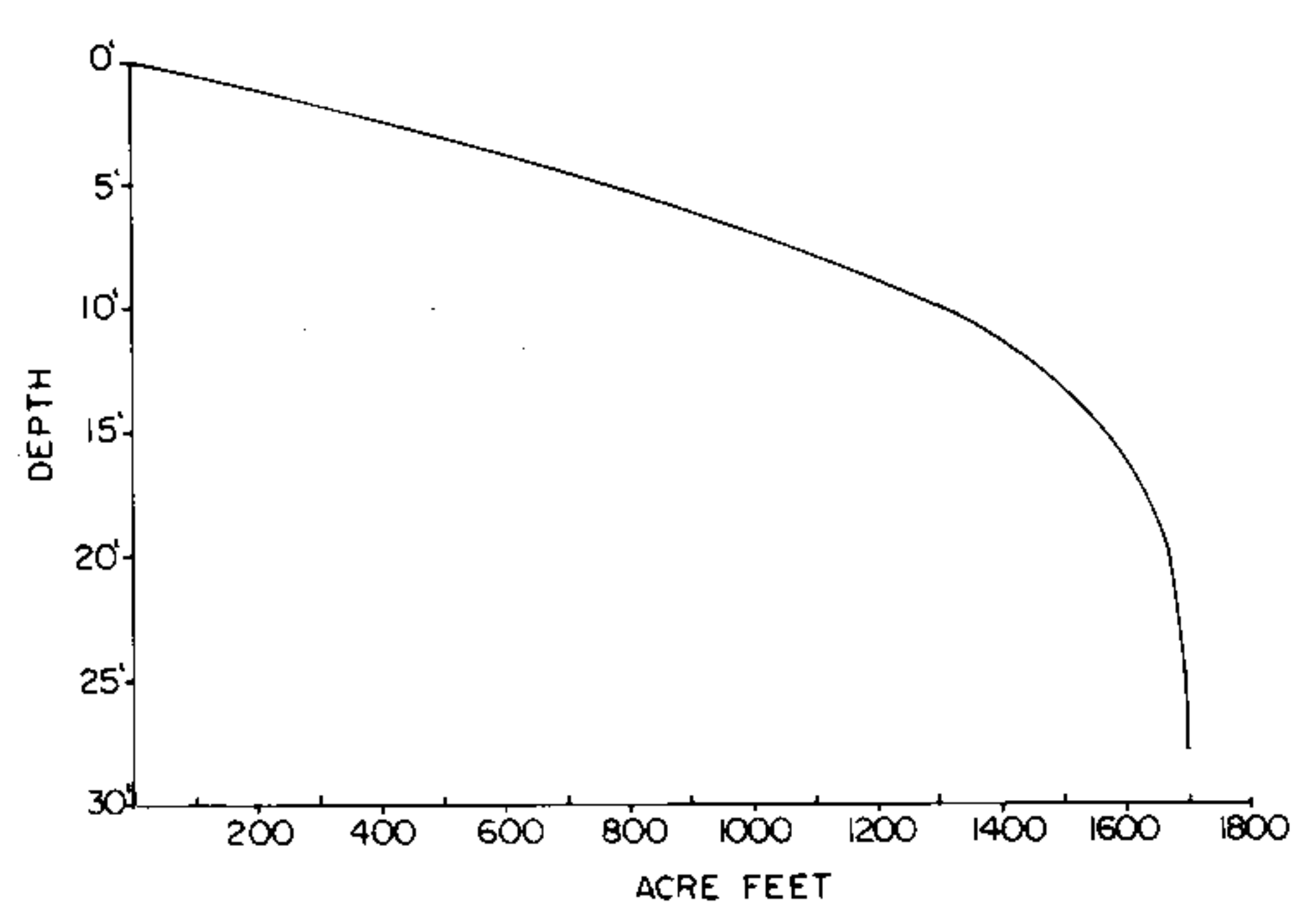
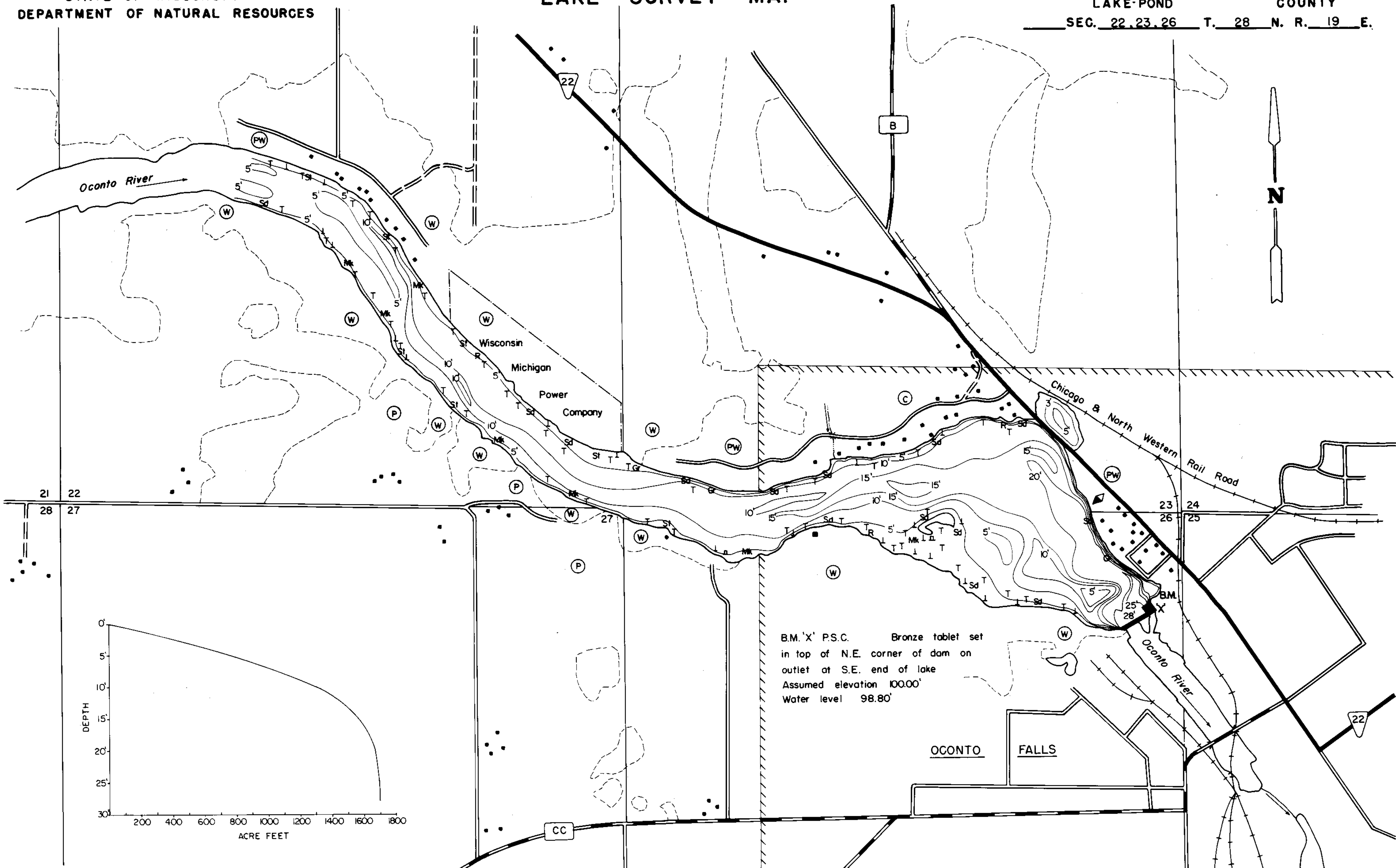

B.M. 'X' P.S.C. Bronze tablet set
in top of N.E. corner of dam on
outlet at S.E. end of lake
Assumed elevation 100.00'
Water level 98.80'

EQUIPMENT RECORDING SONAR MAPPED AUG. 1969
MONTH YEAR
LAKE BOTTOM SYMBOLS

- | | | | |
|--|--|---|--|
| <ul style="list-style-type: none"> (B) Brush (PW) Partially wooded (W) Wooded (C) Cleared (P) Pastured (A) Agricultural B.M. Bench Mark ■ Dwelling □ Resort ⊠ Camp | <ul style="list-style-type: none"> Steep slope - - - Indefinite shoreline Marsh Spring Intermittent stream Permanent inlet Permanent outlet Dam D.N.R. State owned land | <ul style="list-style-type: none"> P. Peat Mk. Muck C. Clay M. Marl Sd. Sand St. Silt Gr. Gravel R. Rubble Bc. Bedrock | <ul style="list-style-type: none"> B Boulders ⊙ Stumps & Snags ⊙ Rock danger to navigation T Submergent vegetation I Emergent vegetation ⊠ Floating vegetation ⊠ Brush shelters |
|--|--|---|--|

600' 0' 600' 1200' 1800' 2400'
SCALE
◆ Access ◆ Access with Parking ◆ Boat Livery
Drawn by: C.Holt
Field work by: J.Smith

SPECIES OF FISH	Abundance		
	Abundant	Common	Present
Muskie			X
N. Pike	X		
Walleye	X		
L. M. Bass	X		
S. M. Bass	X		
Panfish	X		
Trout			

WATER AREA 166.5 ACRES
 UNDER 3 FT. 19 %
 OVER 20 FT. 6 %
 MAX. DEPTH 28 FEET.
 TOTAL ALK. 114 P.P.M.
 VOLUME 1700. ACRE FT.
 MAIN SHORELINE 4.34 MI.
 ISLAND SHORELINE .20 MI.

Source: Wisconsin Department of Natural Resources 608-266-2621
Oconto Falls Lake – Oconto County, Wisconsin DNR Lake Map
Date - Aug 1969 - Historical Lake Map - Not for Navigation
A Public Document - Please Identify the Source when using it.